

11/23/74
JAC

C83 GW621

NW Pontotoc

FORM 9-1642
(1-68)

Well No. _____

WELL SCHEDULE

U. S. DEPT. OF THE INTERIOR GEOLOGICAL SURVEY WATER RESOURCES DIVISION

PUNCHED
MAY 8 1974

MASTER CARD W/TO

Record by JAC Source of data dr. Bowc Date 2-14-74 Map _____

State Miss County PONTOTOC (or town) 58

Latitude: 34 15 58 N Longitude: 08 90 10 1 Sequential number: 1

Lat-Long accuracy: 2 9 3 5 3 5 W SW SE SW

Local well number: C083CC2909S03E Other number: Deville Mfg?

Local use: 064 Owner or name: City of Pontotoc

Owner or name: PONTOTOC Address: Well #5

Ownership: County, Fed Gov, City, Corp or Co, Private, State Agency, Water Dist M

Use of water: (A) Air cond, (B) Bottling, (C) Comm, (D) Dewater, (E) Power, (F) Fire, (G) Dom, (H) Irr, (I) Med, (J) Ind, (K) P S, (L) Rec, (M) Stock, (N) Instit, (O) Unused, (P) Recharge, (Q) Desal-P S, (R) Desal-other, (S) Other P

Use of well: (A) Anode, (B) Drain, (C) Seismic, (D) Heat Res, (E) Obs, (F) Oil gas, (G) Recharge, (H) Test, (I) Unused, (J) Withdraw, (K) Waste, (L) Destroyed W

EATA AVAILABLE: Well data Freq. W/L meas: Field aquifer char.

Eyd. lab. data: _____

Qual. water data; type: _____

Freq. sampling: _____ Pumpage inventory: no yes period: _____

Aperture cards: _____

Log data: See c-105 37

WELL-DESCRIPTION CARD

SAME AS ON MASTER CARD Depth well: 1206 ft Meas. rept accuracy 3

Depth cased: 1137 ft Casing type: _____; Diam. 12.8 in

Finish: (C) porous concrete, (F) gravel w. (perf.), (G) gravel w. (screen), (H) horiz. gallery, (I) open end, (J) perf., (K) screen, (L) sd. pt., (M) shored, (N) open hole, (O) other G

Method Drilled: (A) air rot, (B) bored, (C) cable, (D) dug, (E) hyd jetted, (F) air percuss, (G) reverse, (H) trenching, (I) driven, (J) wash, (K) other H

Date Drilled: 2-14-74 9-7-74 Pump intake setting: _____ ft

Driller: Livingston name Memphis, Tenn. address

Lift (type): (A) air, (B) bucket, (C) cent, (D) jet, (E) multiple, (F) multiple, (G) none, (H) piston, (I) rot, (J) submerg, (K) turb, (L) other T Deep D Shallow

Power (type): (A) diesel, (B) elec, (C) gas, (D) gasoline, (E) hand, (F) gas, (G) wind; H, P. V Trans. or meter no. _____

Descrip. MP _____ ft above below LSD, Alt. MP _____

Alt. LSD: 460 Accuracy: (source) 20 taps

Water Level: _____ ft above below MP; _____ ft above below LSD 274 Accuracy: _____

Date meas: 3-7-74 Yield: _____ gpm 500 Method determined _____

Drawdown: _____ ft Accuracy: _____ Pumping period: _____ hrs

QUALITY OF WATER DATA: Iron _____ ppm Sulfate _____ ppm Chloride _____ ppm Hard. _____ ppm

Sp. Conduct _____ K x 10 6 Temp. _____ °F Date sampled _____

Taste, color, etc. _____

5 lev.
460+

Well No. C83

Well No. 644

Latitude-longitude _____
 d m s d m s

HYDROGEOLOGIC CARD

(SAME AS ON MASTER CARD) Physiographic Province: 03 Section: _____

D Drainage Basin: 15F Subbasin: _____

Topo of well site: (D) depression, stream channel, dunes, flat, hilltop, sink, swamp, (F) offshore, pediment, hillslope, terrace, undulating, valley flat _____

MAJOR AQUIFER: _____ system _____ series K3 aquifer, formation, group G.D. & MS

Lithology: _____ Origin: 2 Aquifer Thickness: _____ ft

Length of well open to: _____ ft 75 Depth to top of: _____ ft _____

MINOR AQUIFER: _____ system _____ series _____ aquifer, formation, group _____

Lithology: _____ Origin: _____ Aquifer Thickness: _____ ft

Length of well open to: _____ ft _____ Depth to top of: _____ ft _____

Intervals Screened: _____
 Depth to consolidated rock: _____ ft _____ Source of data: _____
 Depth to basement: _____ ft _____ Source of data: _____
 Surficial material: _____ Infiltration characteristics: _____
 Coefficient Trans: _____ gpd/ft _____ Coefficient Storage: _____
 Coefficient Perm: _____ gpd/ft²; Spec cap: _____ gpm/ft; Number of geologic cards: _____

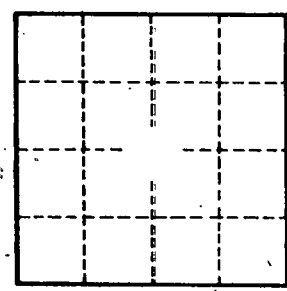
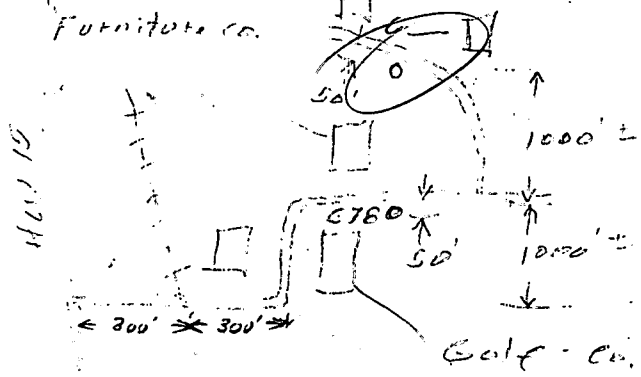

about 1 mile N. of Port Antonio

- 1100-1123 Sand - yellow (European)
- 1123-1206 Gravel, pea size and sand Dark stained (European)
- Screened 1131-1206 (=75')
- (-671 to -746)

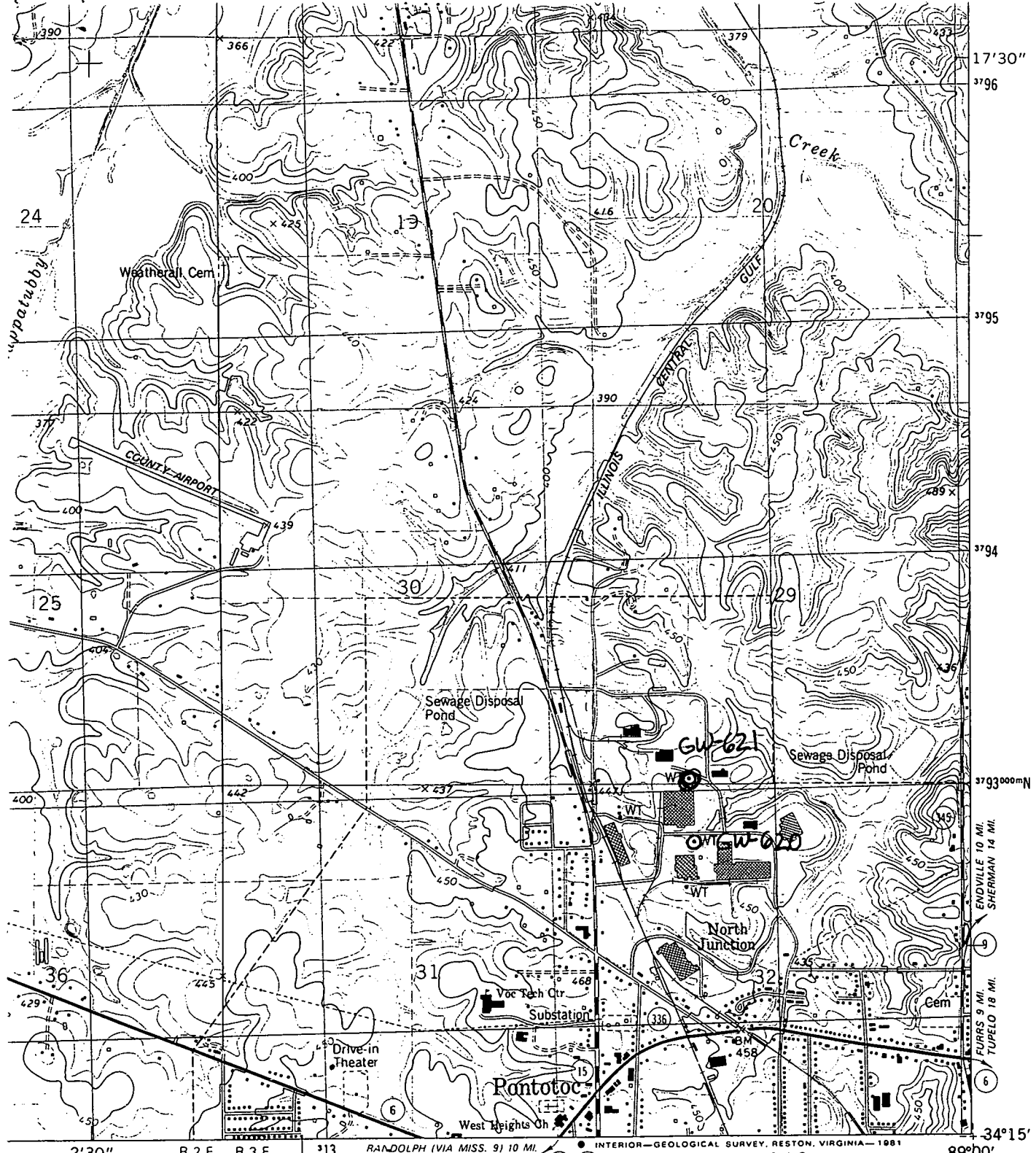

2'30" R 2 E R 3 E 13 RANDOLPH (VIA MISS. 9) 10 MI. BRUCE 30 MI. INTERIOR—GEOLOGICAL SURVEY, RESTON, VIRGINIA—1981 1:50000E 34°15' 89°00'

1 MILE



QUADRANGLE LOCATION

ROAD CLASSIFICATION

- Primary highway, hard surface
- Secondary highway, hard surface
- Interstate Route
- Light-duty road, hard or improved surface
- Unimproved road
- U. S. Route
- State Route

NORTHWEST PONTOTOC, MISS.

SE/4 NEW ALBANY 15' QUADRANGLE
N3415-W8900/7.5

1980

DMA 3152 I SE-SERIES V843

(SOUTHEAST PONTOTOC)
322 MI. NW

PONTOTOC
C83
3-22-74

MISSISSIPPI
 BOARD OF WATER COMMISSIONERS
 416 North State Street
 Jackson, Mississippi 39201

CODED

WATER WELL DRILLERS LOG

3/22/1974 Singer-Layne Central Division Pontotoc
 date well completed film name county well located

LANDOWNER:	description of formations encountered	from	to
City of Pontotoc			
Pontotoc, Mississippi	Clay	12	12
(mailing address)	Sand	15	3
	Lime Rock	30	15
WELL LOCATION:	Shale Rick Stks	120	70
sec. 32 T. 9 N R. 3 E	Shale Brks. Rock	438	248
S S XX	White Clay	600	162
miles of (distance) (direction) (nearest town)	Hard Shale	710	110
	Sandy Shale	780	70
WELL PURPOSE:	Shale	970	190
(home, irrigation, municipal, industrial)	Sandy Shale & Sand	1140	170
WELL COMPLETION DATA:	Sand & Gravel	1190	50
(1) diameter (inches) 12"	Clay Gravel & Rock Stk	1206	16
(2) total depth (feet) 1206'			
(3) static water level (feet) 273 Below top of ground steel			
(4) casing stainless 1124' (material) (depth)			
(size) IF telescope see back			
(5) screen 76' 1038' (length) (depth to top)			
8" stainless steel (size) (material)			
(6) pump 100 500 (HP) (yield-gpm)			
electric (type power)			
(7) electric log no (yes or no)			
(organization running log)			
(8) how well bottom plugged shot			
DRILLERS REMARKS:			

PONTOTOC
~~C83~~
3-22-74

MISSISSIPPI
 BOARD OF WATER COMMISSIONERS
 416 North State Street
 Jackson, Mississippi 39201

CODED

WATER WELL DRILLERS LOG

3/22/74
 date well completed 19

Singer Layne Central Division Pontotoc
 firm name county well located

LANDOWNER:
 City of Pontotoc
 Pontotoc, Mississippi
 (mailing address)

WELL LOCATION:
 sec. 32 T. 9 N. R. 3 E. S. 3
 miles N.W. of Pontotoc
 (distance) (direction) (nearest town)

WELL PURPOSE:
 (home, irrigation, municipal, industrial)

WELL COMPLETION DATA:

(1) diameter (inches) 12"
 (2) total depth (feet) 1206'
 (3) static water level (feet) 273' below top of ground.
 (4) casing S.S. 1124'
 (material) (depth)
 (size) if telescope see back.
 (5) screen 76' 1038'
 (length) (depth to top)
 8" stainless steel
 (size) (material)
 (6) pump 100 500
 (HP) (yield gpm)
 electric
 (type power)
 (7) electric log no
 (yes or no)
 (organization running log)
 (8) how well bottom plugged valve shot

description of formations encountered	depth	
	from	to
Clay	12	12
Sand	15	87
Lime Rock	30	178
Shale Rock Strks	120	276
Shale Brks Rock	438	248
White Clay	600	182
Hard Shale	710	110
Sandy Shale	780	70
Shale	970	190
Sandy Shale & Sand	1140	170
Sand & Gravel	1190	50
Clay Gravel & Rock Stk	1206	116
Shale	1212	6

DRILLERS REMARKS: