

WRD Exp. (GW)  
April 1966

Well No. BZ

# REPLACEMENT SCHEDULE

U. S. DEPT. OF THE INTERIOR

GEOLOGICAL SURVEY

WATER RESOURCES DIVISION

## MASTER CARD

PUNCHED and VERIFIED  
ROLLA COMPUTATION BRANCH

Record by P.E. Grantham Source Floyd Neillville  
of data Gordon Covington Date 9-20-67 Map

State Mississippi County Pike (or town) 57

Latitude: 31 deg 17 min 37 sec N Longitude: 090 degrees 26 min 26 sec W Sequential number: 1

Lat-long accuracy: 2 T. 4 S. R. 8 W. Sec 19, NE 1/4, SW 1/4, SW 1/4

Local well number: B002CC1904N08E Other number: B & M

Local use: SW JR. COLLEGE Owner or name: Southwest Jr. College

Ownership: County, Fed Gov't, City, Corp or Co, Private, State Agency, Water Dist S

Use of Air cond, Bottling, Comm, Dewater, Power, Fire, Dom, Irr, Med, Ind, P S, Rec, water: U

Use of well: Anode, Drain, Seismic, Heat Res, Obs, Oil-gas, Recharge, Test, Unused, Withdraw, Waste, Destroyed U

DATA AVAILABLE: Well data N Freq. W/L meas.: N Field aquifer char. 72

Hyd. lab. data: 73

Qual. water data; type: 74

Freq. sampling: 75 Pumpage inventory: no, period: 76

Aperture cards: 77

Log data: 78 79

## WELL-DESCRIPTION CARD

SAME AS ON MASTER CARD Depth well: 130' ft Meas. 130 accuracy 6

Depth cased: 123 ft Casing type: Plastic; Diam. 4" in

Finish: porous concrete, gravel w. (perf.), gravel w. (screen), horiz. gallery, end, open perf., screen, sd. pt., shored, open hole, other S

Method Drilled: air bored, cable, dug, hyd rot, jetted, air percussion, rotary, reverse trenching, driven, drive wash, other H

Date Drilled: 1966 9:6:6 Pump intake setting: 36 ft 38

Driller: Covington Hardware Co, Summit Miss

Lift (type): air, bucket, cent, jet, multiple, multiple, none, piston, rot, submerg, turb, other S Deep 40 Shallow 40

Power (type): diesel, elec, gas, gasoline, hand, gas, wind; H.P. 1 Trans. or meter no. S

Descrip. MP 41 above below LSD. Alt. MP 42

Alt. LSD: 450 Accuracy: 6 (source) 47

Water Level 48 above below MP; Ft below LSD 49 Accuracy: 52

Date meas: 53 Yield: 20 gpm 54 Method determined 51

Drawdown: 55 Accuracy: 56 Pumping period 57 hrs 58

QUALITY OF WATER DATA: Iron 59 Sulfate 60 Chloride 61 Hard. 62

Sp. Conduct 63 K x 10 64 Temp. 65 Date sampled 66

Taste, color, etc. 67 68 69 70 71 72 73 74 75 76 77 79

Well No.

BZ

Well No. B2

Latitude-longitude \_\_\_\_\_  
d m s N S d m s

HYDROGEOLOGIC CARD

SAME AS ON MASTER CARD Physiographic Province: 03 Section: \_\_\_\_\_

D Drainage Basin: 134 Subbasin: \_\_\_\_\_

Topo of well site: (D) (C) (E) (F) (H) (K) (L) depression, stream channel, dunes, flat, hilltop, sink, swamp  
(O) (P) (S) (T) (U) (V) offshore, pediment, hillside, terrace, undulating, valley flat

MAJOR AQUIFER: system \_\_\_\_\_ series TP aquifer, formation, group CI

Lithology: \_\_\_\_\_ Origin: 2 Aquifer Thickness: \_\_\_\_\_ ft  
Length of well open to: \_\_\_\_\_ ft Depth to top of: \_\_\_\_\_ ft

MINOR AQUIFER: system \_\_\_\_\_ series \_\_\_\_\_ aquifer, formation, group \_\_\_\_\_

Lithology: \_\_\_\_\_ Origin: \_\_\_\_\_ Aquifer Thickness: \_\_\_\_\_ ft  
Length of well open to: \_\_\_\_\_ ft Depth to top of: \_\_\_\_\_ ft

Intervals Screened: \_\_\_\_\_

Depth to consolidated rock: \_\_\_\_\_ ft Source of data: \_\_\_\_\_

Depth to basement: \_\_\_\_\_ ft Source of data: \_\_\_\_\_

Surficial material: \_\_\_\_\_ Infiltration characteristics: \_\_\_\_\_

Coefficient Trans: \_\_\_\_\_ gpd/ft Coefficient Storage: \_\_\_\_\_

Coefficient Perm: \_\_\_\_\_ gpd/ft<sup>2</sup>; Spec cap: \_\_\_\_\_ gpm/ft; Number of geologic cards: \_\_\_\_\_

*1-15-2004  
entire well locations  
now a parking lot  
completely changed  
R&B  
R&B*

GW10465 Drilled in 1971 B104

10,000 Tank

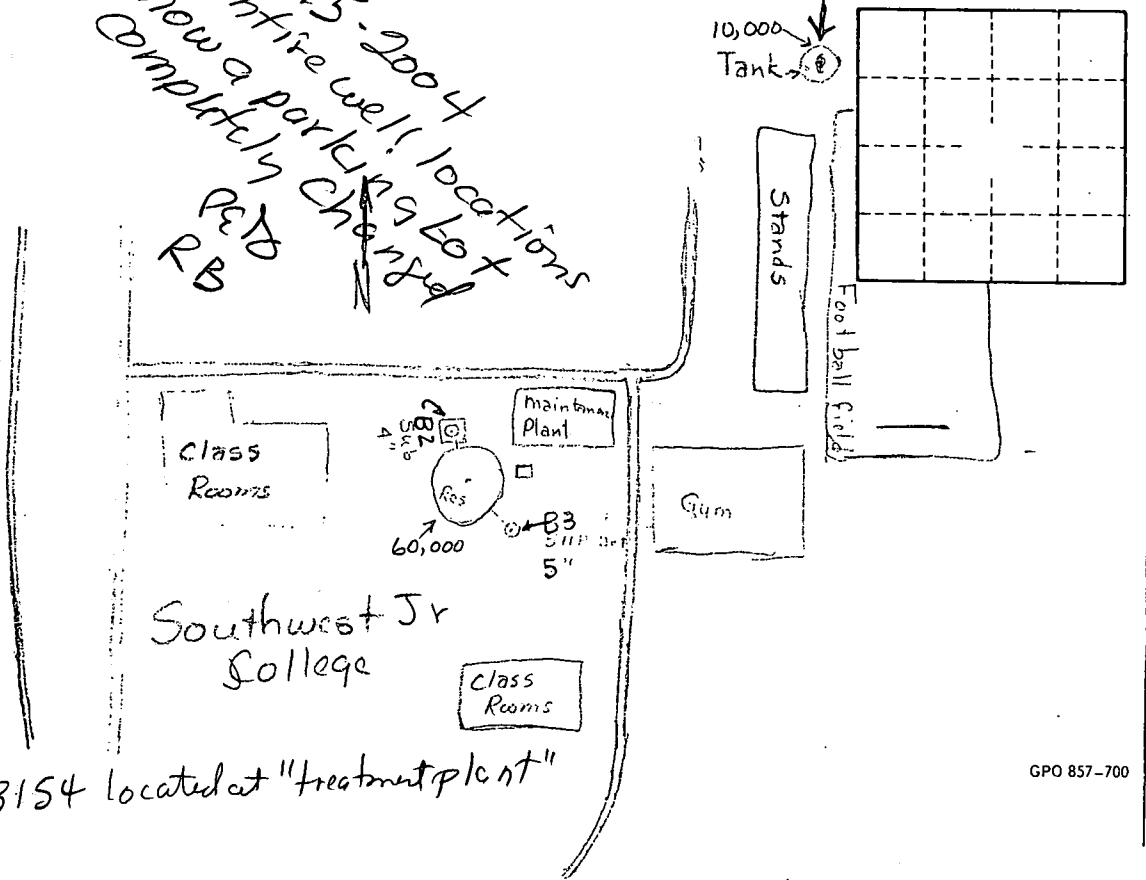

Well No.

B2

Well B154 located at "treatment plant"