

WRD Exp. (GW)
April 1966

Well No. M11

JUL 8 1975

WELL SCHEDULE

E-log #79

U. S. DEPT. OF THE INTERIOR

GEOLOGICAL SURVEY

WATER RESOURCES DIVISION
ROLLA COMPUTATION BRANCH

MASTER CARD

Record by TNS Source of data Dir Date 9/24/65 Map _____

State 28 County (or town) Perry 56

Latitude: 31° 09' 56" N Longitude: 088° 55' 21" W Sequential number: 1

Lat-long accuracy: 2' T. 20 S. R. 9 Sec 5 SW SW

Local well number: M 011 C C 05 02 N 09 W Other number: _____ B & M

Local use: 038079 86525 Owner or name: Town of Beaumont

Owner or name: BEAUMONT Address: _____

Ownership: County, Fed Gov't, City, Corp or Co, Private, State Agency, Water Dist M

Use of water: (A) Air cond, (B) Bottling, (C) Comm, (D) Dewater, (E) Power, (F) Fire, (G) Dom, (H) Irr, (I) Med, (J) Ind, (K) P S, (L) Rec, (M) Stock, (N) Instit, (O) Unused, (P) Repressure, (Q) Recharge, (R) Desal-P S, (S) Desal-other, (T) Other P

Use of well: (A) Anode, (B) Drain, (C) Seismic, (D) Heat Res, (E) Obs, (F) Oil-gas, (G) Recharge, (H) Test, (I) Unused, (J) Withdraw, (K) Waste, (L) Destroyed W

DATA AVAILABLE: Well data Freq. W/L meas.: Field aquifer char.

Hyd. lab. data: _____

Qual. water data; type: USGS 9-16-64

Freq. sampling: _____ Pumpage inventory: yes, no, period: _____

Aperture cards: _____ yes

Log data: D E

WELL-DESCRIPTION CARD

SAME AS ON MASTER CARD Depth well: 666 ft Meas. rept 3

Depth cased; (first perf.) 626 ft Casing type: _____; Diam. 10 3/4, 6 in

Finish: (A) porous concrete, (B) gravel w. concrete, (C) gravel w. (screen), (D) horiz. gallery, (E) open end, (F) perf., (G) screen, (H) sd. pt., (I) shored, (J) open hole, (K) other S

Method Drilled: (A) air rot, (B) bored, (C) cable, (D) dug, (E) hyd rot., (F) jetted, (G) air percuss, (H) reverse, (I) trenching, (J) driven, (K) drive wash, (L) other H

Date Drilled: 11/64 964 Pump intake setting: _____ ft

Driller: Dean Griner

Lift (type): (A) air, (B) bucket, (C) cent, (D) jet, (E) multiple, (F) multiple, (G) none, (H) piston, (I) rot, (J) submerg, (K) turb, (L) other T Deep Shallow

Power (type): (A) diesel, (B) elec, (C) gas, (D) gasoline, (E) hand, (F) gas, (G) wind, (H) H.P., (I) LP, (J) Trans. or meter no. 20 V

Descrip. MP Base of pump 2 ft above LSD, Alt. MP 97

Alt. LSD: 95 Accuracy: OK

Water Level: 37 ft above MP; Ft below LSD +31 Accuracy: _____

Date meas: 976 Yield: 300 gpm Method determined 4

Drawdown: _____ ft Accuracy: _____ Pumping period: _____ hrs 21

QUALITY OF WATER DATA: Iron 1 ppm Sulfate 23 ppm Chloride 244 ppm Hard. 3

Sp. Conduct 1090 K x 10⁶ 5 Temp. 23.5 °F Date sampled 964

Taste, color, etc. Salty pH: 7.8

WELL NO.

M11

12/22/81
 12
 2.3
 26
 24
 + 27.6
 95

W-L A1+ 123

Well No. M11

Latitude-longitude N
S
d m s d m s

HYDROGEOLOGIC CARD

SAME AS ON MASTER CARD Physiographic Province: _____ Section: 03

Drainage Basin: D Subbasin: 130

Topo of well site: (D) depression, stream channel, dunes, flat, hilltop, sink, swamp, (E) (F) (H) (K) (L) (P) (S) (T) (U) (V) offshore, pediment, hillside, terrace, undulating, valley flat F

MAJOR AQUIFER: system _____ series TM aquifer, formation, group MZ

Lithology: _____ Origin: 3 Aquifer Thickness: _____ ft

148 Length of well open to: _____ ft 40 Depth to top of: _____ ft

MINOR AQUIFER: system _____ series _____ aquifer, formation, group _____

Lithology: _____ Origin: _____ Aquifer Thickness: _____ ft

 Length of well open to: _____ ft Depth to top of: _____ ft

Intervals Screened: _____

Depth to consolidated rock: _____ ft _____ Source of data: _____

Depth to basement: _____ ft _____ Source of data: _____

Surficial material: _____ Infiltration characteristics: _____

Coefficient Trans: 200,000 gpd/ft 204 Coefficient Storage: _____

Coefficient Perm: 1350 gpd/ft²; Spec cap: 25 gpm/ft; Number of geologic cards: _____

WL: +35 (1969)
 WL: +30.90 from GL (1-23-70)
 WL: +26. 6/21/79 Sp Cond: 900

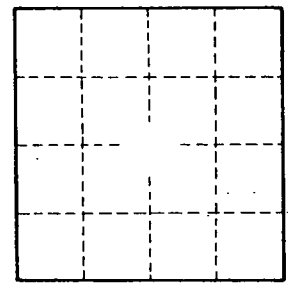
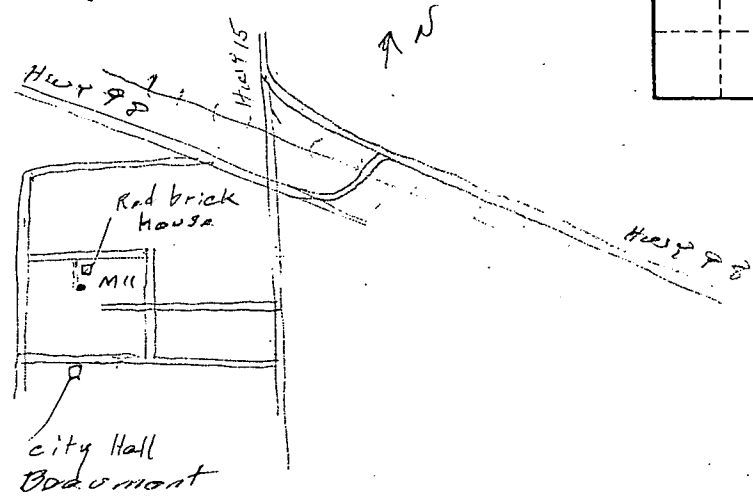

Well No.

M11

