

PANOLA
R 93 T 2
1-7-91

Coded

MISSISSIPPI
 BOARD OF WATER COMMISSIONERS
 416 North State Street
 Jackson, Mississippi 39201

WATER WELL DRILLERS LOG

1-7-91 date well completed
 Lipstick Well Supply Co. Panola firm name
 POPE-COURTLAND W/A county well located

LANDOWNER: Anna Gray
Sec 21 S (Test Well)
Courtland, Ms
 (mailing address)

WELL LOCATION:
 sec 21 T 26 N R 9 E
1 9 S 7 Batswell
 (distance) miles (direction) or (nearest town)

WELL PURPOSE: test
 (home, irrigation, municipal, industrial)

WELL COMPLETION DATA:

(1) diameter (inches) 6 x 4

(2) total depth (feet) 1024

(3) static water level (feet) 190 below above top of ground.

(4) casing Steel 984
 (material) (depth)

6 x 4 If telescope see back.
 (size)

(5) screen 40 984
 (length) (depth to top)

4" S/S
 (size) (material)

(6) pump 10 90
 (HP) (yield gpm)

elec.
 (type power)

(7) electric log (yes or no)

(8) how well bottom plugged plug

RECEIVED
 JUN 19 1992

DRILLERS REMARKS:
 Dept. of Environmental Quality
 Bureau of Land & Water Resources

description of formations encountered	from	to
top soil, clay	0	25
clay then sand	25	45
sand	45	65
sand pea gravel, sand	65	85
sand w/ streaks of clay	85	105
sand	105	125
sand	125	145
sand	145	165
sand w/ little clay	165	185
sand w/ streaks of clay	185	205
clay, rock (218') clay	205	225
s/w little sand		
clay w/ fine streak of sand	225	245
" "	245	265
" "	265	285
" "	285	305
clay then sand at 312'	305	325
sand, then clay w/ streak	325	345
of sand		
clay w/ streaks of sand	345	365
sand w/ streak of clay	365	385
" "	385	405
" "	405	425
sand w/ streaks of clay	425	445
rock at 441'		
mostly sand w/ streaks of clay	445	465
mostly clay w/ little sand	465	485
" "	485	505
mostly sand w/ little clay	505	525
sand	525	545
sand	545	565
mostly clay sand at 565-575	565	585
mostly clay (rock 592)	585	605
clay & sand streak		
mostly clay, rock at 612, clay	605	625
clay	625	645
clay (rock 640)	645	665
clay w/ little sand	665	685
clay	685	705
clay w/ little sand	705	725
clay w/ little sand	725	745

If well telescopes please sketch and show depths.

GROUND LEVEL

745-765 Clay, little sand
 765-785 Clay, rock 781'
 785-805 Clay, rock 795'
 805-825 Clay
 825-845 Clay, few streaks sand
 845-865 "
 865-885 Clay
 885-905 Clay, rock 917, clay
 905-925 Clay w/ little sand
 925-945 rock 917 5' thick
 945-965 Clay w/ little sand
 965-985 "
 985-1005 "
 1005-1025 "
 1025-1045 "
 1045-1065 Clay w/ little sand
 1065-1085 brittle clay
 1085-1105 "
 1105-1125 "
 1125-1145 "
 1145-1165 "
 1165-1185 "
 1185-1205 "
 1205-1225 brittle clay w/ little sand
 1225-1245 " thin sand streak
 1245-1265 sand w/ clay then clay
 1265-1285 clay
 1285-1305 clay w/ little sand
 1305-1325 "
 1325-1345 "
 1345-1365 clay

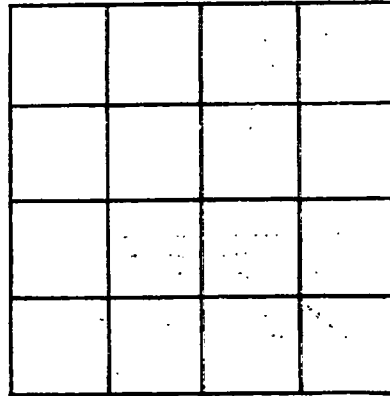

SECTION _____

Please indicate well location X.

ADDITIONAL INFORMATION

If more than one screen, show locations of each on sketch.

RECEIVED
 1952 JUN 10 10 41 AM
 U.S. GEOLOGICAL SURVEY

WATER RESOURCES DIVISION
 WASHINGTON, D.C.

WILCOX DATA SHEET-VERIFICATION CHECKLIST

COUNTY PANOLA

Batesville Quad
U.S.G.S. E-109 # 89

WELL OWNER Pope - Courtland W.A.

CHECKED

U.S.G.S. NO. R-92

11/14/94

B.O.H. NO. 540069-01

11/14/94

OLWR NO. _____

LOCATION:

MAP NW,NW,NW,NE S 28, T 9 S, R 7 W

11/14/94

GPS _____

ELEV. (MSL) 350'

11/14/94

W.L. (L.S.) (1) - 240.65'

11/14/94

(2) - 240.69'

11/14/94

HEAD (MSL) + 109.31'

11/14/94

SCREENED INTERVAL 1,087' - 1,127' (L5) / - 737' - - 777' (MSL)

11/14/94

AQUIFER VERIFIED Lower Wilcox

11/14/94

PREVIOUS W.L. - 240' (1992)

11/14/94

DATA ENTERED _____

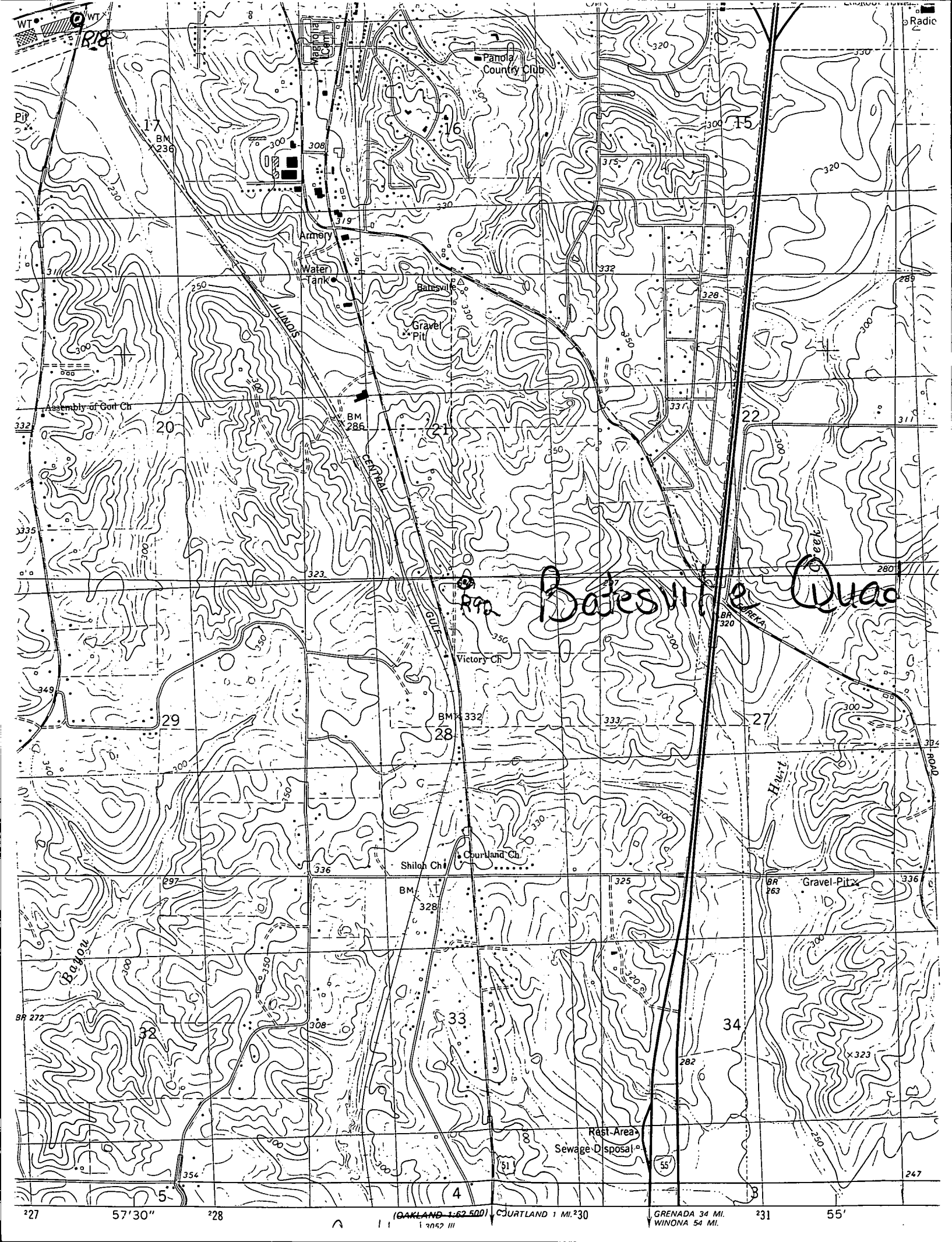

Batesville, Miss. Quad

Lape pipe + screened
pulled casing left.

ROBE-COURTLAND WATER ASSOC.
 1993

LIPE WELL & SUPPLY CO., INC.
 WELL CONSTRUCTION DATA

WELL DATA	STARTED WELL _____ 19 _____ AND COMPLETED <u>OCTOBER</u> _____ 19 <u>93</u>
	TOTAL DEPTH <u>1124</u> ELEVATION <u>350</u> STATIC WATER LEVEL <u>252'</u>
	LENGTH SURFACE CASING <u>22</u> SIZE <u>20'</u> THICKNESS _____
	CEMENTED WITH <u>10</u> SACKS CEMENT TYPE PACKER _____
	LENGTH WELL CASING <u>1070</u> SIZE <u>12 3/4</u> WEIGHT <u>.375</u>
	CEMENTED WITH <u>761</u> SACKS CEMENT TYPE PACKER _____
	INNER CASING LENGTH <u>63'</u> SIZE <u>8 5/8</u> WEIGHT <u>322</u>
	WITH <u>12</u> x <u>8</u> GUIDES LOCATED _____ TYPE SACKOFF <u>8" Left</u>
	LEAD SEAL <u>n/a</u> BACKPRESSURE VALVE <u>Bronze</u> GUIDE <u>8" x 4' with cap</u>
	WELL STRAINER MAKE <u>Houston</u> SIZE <u>8" PS</u> LENGTH <u>30</u> OPENING <u>.030"</u>
	TYPE MATERIAL <u>SS</u> WITH <u>WR</u> CONNECTIONS _____
	SIZE HOLE DRILLED FOR SURFACE CASING <u>75"</u> WITH <u>hole-opener</u>
	SIZE HOLE DRILLED FOR WELL CASING <u>17"</u> WITH <u>3 - cone roller</u>
	SIZE HOLE DRILLED FOR STRAINER <u>26"</u> WITH <u>Grant underreamer</u>
	* YARDS OF GRAVEL USED <u>143 ft 3</u> HOW PLACED <u>tremie</u>
HOW WAS WELL DEVELOPED <u>Surge block with submersible</u>	
NOTES: <u>Cemented by Haliburton from Natchez</u> <u>10-20 Pearl Sand</u>	
RIG USED <u>R-2</u> DRILLER <u>Simmons-Lipe</u>	
PUMP RECORD	SERIAL NUMBER <u>8491</u> MAKE <u>Worthington</u> PIPE FOUNDATION <u>Concrete pyramid</u>
	LENGTH COLUMN <u>325</u> SIZE <u>6</u> x <u>2</u> TYPE <u>QL - 10'</u> LENGTHS _____
	BOWL SIZE <u>10"</u> TYPE <u>M50</u> STAGES <u>10</u> MATERIAL IMPELLER <u>Bronze</u>
	MATERIAL BOWL <u>CI</u> WITH _____ PORTS AND <u>1 1/2</u> SHAF'
	SUCTION SIZE <u>6"</u> LENGTH <u>20</u> SUCTION STRAINER <u>K & K valve</u>
	IS PUMP SEALED HOW <u>No</u> WHERE _____ WITH WHAT _____
	LUBRICATOR TYPE <u>Worthington</u> SIZE _____ VOLTAGE <u>460</u>
	LENGTH OF AIRLINE <u>320'</u> SIZE <u>3/4"</u> TYPE MATERIAL <u>PVC</u>
	AIR RELEASE VALVE TYPE <u>Crisden</u> SIZE <u>2"</u>
	SIZE SURFACE DISCHARGE <u>6"</u> TYPE <u>FLNG</u> DAYTON COUPLING <u>Under installa</u>
	PRESSURE GAUGE _____ SIZE PULLEY _____ SPEED <u>1800</u>
	NOTES: <u>5' on bowl - coated by special coating</u> <u>full diameter - underfiled - 500 gpm @ 448'</u>
	RIG USED TO SET PUMP <u>R-5</u> INSTALLER <u>Dubois</u>
	DATE PUMP INSTALLED <u>5</u> 19 <u>93</u> DATE IN OPERATION <u>10</u> 19 <u>93</u>
	MOTOR
SPEED <u>1800</u> MODEL _____ SERIAL NUMBER _____	
TOP BEARING _____ BOTTOM BEARING _____ RATCHET _____	
STARTER <u>AB-1232x</u> PRESSURE SWITCH <u>BW - 115V</u> FLOAT _____	
<u>DNB25-573</u> T-43 Water <u>100 AMP FUSE</u>	
GEAR	MAKE _____ STYLE _____ SIZE _____ RATIO _____ NO. _____
	SIZE PULLEY _____ TYPE MOTOR FRAME _____
ENGINE	MAKE _____ STYLE _____ HP _____ SERIAL NUMBER _____
	SPEED _____ SIZE PULLEY _____ FOUNDATION _____
	TYPE FUEL TANK _____ MAKE MAG _____ NO. _____
	MAKE STARTER _____ NO. _____ TYPE FUEL _____
	MAKE FLEXIBLE SHAFT _____ SIZE _____ LENGTH _____ BELT LENGTH _____
GENERAL	PURPOSE FOR WHICH THIS WATER IS USED _____
	TEMPERATURE _____ IS WATER CLEAN <u>Yes</u> CAPACITY <u>500 @ 448'</u>
	SAND <u>G</u> HARDNESS _____ PH _____ IRON _____ N.P.C.I. _____