

WRD Exp. (GW)
April 1966

Well No. R 39

WELL SCHEDULE

U. S. DEPT. OF THE INTERIOR

GEOLOGICAL SURVEY

WATER RESOURCES DIVISION

MASTER CARD

Record by E.H. Boswell Source of data owner/telephone Date 11/22/66 Map Sardis Quad

State Miss County 28 (or town) Panola Sequential number: 54

Latitude: 34 deg 18 min 27 sec N Longitude: 089 degrees 57 min 55 sec W

Lat-long accuracy: 4 T. 9 S. R. 7 W. Sec. 17, NW & NW

Local well number: R039BB1709S07W Other number: FORMERLY

Local use: PANOLA MILLS Owner or name: USI INDUSTRIES

Address: Corner of Van Voris and Vance Sts.

Ownership: County, Fed Gov't, City, Corp or Co, Private, State Agency, Water Dist N

Use of water: (A) Air cond, Bottling, Comm, Dewater, Power, Fire, Dom, Irr, Med, Ind P S, Rec, (N) Manufacture

Stock, Instit, Unused, Repressure, Recharge, Desal-P S, Desal-other, Other W

Use of well: (A) Anode, Drain, Seismic, Heat Res, Obs, Oil-gas, Recharge, Test, Unused, Withdraw, Waste, Destroyed W

DATA AVAILABLE: Well data 0 Freq. W/L meas.: 0 Field aquifer char. 0

Hyd. lab. data: None

Qual. water data; type: reported no iron

Freq. sampling: 0 Pumpage inventory: no period: 0

Aperture cards: 0

Log data: Drillers log

WELL-DESCRIPTION CARD

SAME AS ON MASTER CARD Depth well: 190 ft Meas. 190 ft

Depth cased: 73 ft Casing type: Steel Diam. 26 in

Finish: porous concrete, gravel w. screen, gravel, horiz. gallery, open perf., screen, sd. pt., shored, open hole, other G

Method Drilled: air bored, cable, dug, hyd. jetted, air rot., percussion, rotary, reverse trenching, driven, drive wash, other R

Date Drilled: 9-5-5 Pump intake setting: 0 ft

Driller: Carlross Well Supply, Memphis Tenn

Lift (type): air, bucket, cent, jet, multiple, multiple, none, piston, rot, submerg, turb, other 7 Deep 0 Shallow 40

Power (type): diesel, elec, gas, gasoline, hand, gas, wind; H.P. 30 Trans. or meter no. 0

Descrip. MP 0 ft above LSD, Alt. MP 0

Alt. LSD: 220 Accuracy: 5

Water Level 18 ft above below MP; Ft below LSD 18 Accuracy: 0

Date meas: Dec 1955 Yield: 530 @ 13' gpm 530 Method determined 4

Drawdown: see back ft Accuracy: 0 Pumping period: 0 hrs 0

QUALITY OF WATER DATA: Iron 0 ppm Sulfate 0 ppm Chloride 0 ppm Hard. 0 ppm

Sp. Conduct 0 K x 10⁶ Temp. 0 °F Date sampled 0

Taste, color, etc.

FEB 15 1973

PUNCHED

Well No. R 39

Well No. R39

Latitude-longitude N
S
d m s d m s

HYDROGEOLOGIC CARD

SAME AS ON MASTER CARD Province: Coastal Plain 03 Section: East Gulf

D Drainage Basin: LSF Subbasin: 26

Topo of well site: (D) depression, stream channel, dunes, flat, hilltop, sink, swamp, (E) (F) (H) (K) (L) (P) (S) (T) (U) (V) offshore, pediment, hillside, terrace, undulating, valley flat 27

MAJOR AQUIFER: system series TE aquifer, formation, group SS

Lithology: US Origin: 2 Aquifer Thickness: 63 ft

Length of well open to: 116 ft Depth to top of: 74 ft

MINOR AQUIFER: system series aquifer, formation, group Aquifer Thickness: ft

Lithology: Origin: Thickness: ft

Length of well open to: ft Depth to top of: ft

Intervals Screened: 73'6" to 93'4" and 135'9" to 190'8"

Depth to consolidated rock: ft Source of data: 64

Depth to basement: ft Source of data: 69

Surficial material: Infiltration characteristics: 72

Coefficient Trans: gpd/ft 73 Coefficient Storage: 78

Coefficient Perm: gpd/ft²; Spec cap: gpm/ft; Number of geologic cards: 79

*1/3 well jumped most of the time.
Mr. Cutler, plant Supt.*

~ 100,000 gallon elevated storage tank

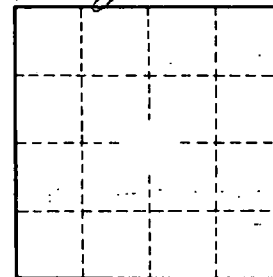
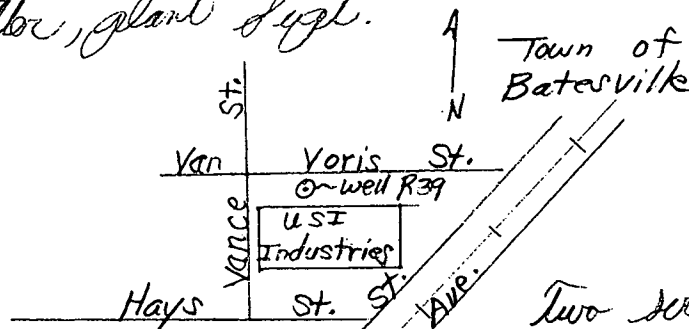

*Two screens -
upper screen first set
2 to 2 1/2 gpm/ft
well deepened
3 1/2 to 4 gpm/ft in lower
(this may be combined)
report no iron.*

*well has failed - pumping sand
11/6/6 EHB*