

FORM 9-1642
(1-68)

Well No. R7

PUNCHED

WELL SCHEDULE

U. S. DEPT. OF THE INTERIOR

GEOLOGICAL SURVEY

WATER RESOURCES DIVISION

MASTER CARD

Record by DEWASSON Source of data obs Date 9/27/60 Map _____
 State JAL County 28 (or town) 54
 Latitude: 34 19 12 N Longitude: 08 9 56 59 Sequential number: 12
 Lat-long accuracy: 30 T 90 R 70 W Sec 8 SE NE
 Local well number: R00070A0809507W Other number: _____ B & M

DEC 9 1974

71815T

Local use: _____ Owner or name: Batesville Ice Plant
 Address: previous name, same owner
Corner of Central and Court Streets

Ownership: (C) County, Fed Gov't, (M) City, Corp or Co, Private, (P) State Agency, Water Dist _____
 (A) (B) (C) (D) (E) (F) (H) (I) (M) (N) (P) (R)

Use of water: (S) Air cond, Bottling, Comm, Dewater, Power, Fire, Dom, Irr, Med, Ind, P S, Rec, _____
 (T) Stock, Instit, Unused, Repressure, Recharge, Desal-P S, Desal-other, Other _____
 (U) (V) (W) (X) (Y) (Z)

Use of well: (A) Anode, Drain, Seismic, Heat Res, Obs, Oil-gas, Recharge, Test, Unused, Withdraw, Waste, Destroyed, _____
 (D) (G) (H) (I) (P) (R) (T) (U) (W) (X) (Z)

DATA AVAILABLE: Well data Freq. W/L meas: Field aquifer char.

Hyd. lab. data: _____

Qual. water data; type: USGS 8/73

Freq. sampling: Pumpage inventory: yes _____ no; period: _____

Aperture cards: _____ yes _____

Log data: _____

WELL-DESCRIPTION CARD

SAME AS ON MASTER CARD Depth well: 125 ft Meas. 3
 Depth cased; (first perf.) 105 ft Casing type: _____; Diam. 6 in

Finish: (C) porous concrete, (F) gravel w. (G) gravel w. (H) horz. gallery, (I) open perf., (P) screen, (S) sd. pt., (T) shored, (W) open hole, (X) other _____
 Method (A) (B) (C) (D) (H) (J) (P) (R) (T) (V) (W) (Z)

Drilled: (A) air bored, (C) cab.e, (D) dug, (H) hyd jetted, (J) air reverse, (P) percuss, (R) rotary, (T) trenching, (V) driven, (W) wash, (Z) other _____

Date Drilled: 952 Pump intake setting: 67 ft

Driller: Paulk Bros

Lift (type): (A) air, (B) bucket, (C) cent, (J) jet, (L) multiple, (M) multiple, (N) none, (P) piston, (R) rot, (S) submerg, (T) turb, (Z) other _____ Deep _____ Shallow _____

Power (type): (nat) diesel, elec, gas, gasoline, hand, gas, wind; (LP) 7/2 Trans. or meter no. U

Descrip. MP _____ ft above _____ below LSD, Alt. MP _____

Alt. LSD: 230 Accuracy: _____

Water Level 22 ft above below MP; Ft below LSD 22 Accuracy: _____

Date meas: 9/27/60 Yield: 80 gpm Method determined _____

Drawdown: _____ ft Accuracy: _____ Pumping period: _____ hrs

QUALITY OF WATER DATA: Iron _____ ppm Sulfate _____ ppm Chloride _____ ppm Hard. _____ ppm

Sp. Conduct 70 K x 10⁶ Temp. 22.0 Date sampled 8-22-73 873

Taste, color, etc. pH = 6.8

Well No.

R7

Well No. _____

Latitude-longitude _____
d m s d m s

9
2
0
3

HYDROGEOLOGIC CARD

SAME AS ON MASTER CARD

Physiographic Province: _____

03

Section: _____

D

Drainage Basin: _____

15F

Subbasin: _____

Topo of well site: (D) depression, stream channel, dunes, flat, hilltop, sink, swamp, (E) (F) (H) (K) (L) (P) (S) (T) (U) (V) offshore, pediment, hillside, terrace, undulating, valley flat: _____

MAJOR AQUIFER:

system

series

TE

aquifer, formation, group

SS

Lithology: _____

5

Origin: _____

2

Aquifer Thickness: _____

45 ft

Length of well open to: _____ ft

20

Depth to top of: _____ ft

8.0

MINOR AQUIFER:

system

series

aquifer, formation, group

Lithology: _____

Origin: _____

Aquifer Thickness: _____

_____ ft

Length of well open to: _____ ft

Depth to top of: _____ ft

Intervals Screened:

Depth to consolidated rock: _____ ft

Source of data: _____

Depth to basement: _____ ft

Source of data: _____

Surficial material: _____

Infiltration characteristics: _____

Coefficient Trans: _____

gpd/ft

Coefficient Storage: _____

Coefficient Perm: _____

gpd/ft²

Spec cap: _____

gpm/ft

Number of geologic cards: _____

Completion data

95' of 8"

15' of 5" (5' overlap)

20' of 5" screen

water levels, 1952

18 feet

well tested @ 200 gpm with water level @ 45'

well pumps 24 hours/day

N

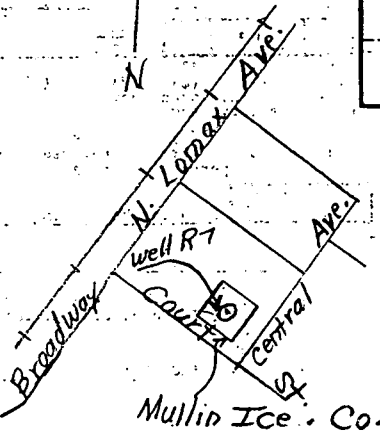

Town of Batesville

Drillers log

0-20' clay

20-40' sand and gravel

40-100' layers of white clay and sand

100-125' medium water bearing sand

Well No. _____

27