

WELL SCHEDULE

U. S. DEPT. OF THE INTERIOR

GEOLOGICAL SURVEY

WATER RESOURCES DIVISION

MASTER CARD BEW

PUNCHED

WL Data

11/14/92

WL Estimated  
0+ +10.00

11/30/88

WL = -10.37

Destroyed

11/30/88

Record by JAC Source of data Files Date \_\_\_\_\_ Map \_\_\_\_\_

State 28 County (or town) PANOLA Sequential number: 54 1

Latitude: 34<sup>deg</sup> 17<sup>min</sup> 33<sup>sec</sup> N Longitude: 090<sup>deg</sup> 04<sup>min</sup> 27<sup>sec</sup> W

Lat-long accuracy: 2<sup>sec</sup> 9<sup>min</sup> 8<sup>sec</sup> R 8<sup>min</sup> 8<sup>sec</sup> R 19<sup>min</sup> NE NE

Local well number: Q006AA1909S08W Other number: #6 B & M

Local use: \_\_\_\_\_ Owner or name: TENN GAS TRANS

Owner or name: TENN GAS TRANS Address: \_\_\_\_\_

Ownership: County, Fed Gov't, City, Corp or Co, Private, State Agency, Water Dist N

Use of water: (A) Air cond, Bottling, Comm, Dewater, Power, Fire, Dom, Irr, Med, Ind, P S, Rec, (S) Stock, (T) Instit, (U) Unused, (V) Repressure, (W) Recharge, (X) Desal-P S, (Y) Desal-other, (Z) Other W

Use of well: (A) Anode, (D) Drain, (G) Seismic, (H) Heat Res, (I) Obs, (J) Oil-gas, (K) Recharge, (L) Test, (M) Unused, (N) Withdraw, (O) Waste, (P) Destroyed U

DATA AVAILABLE: Well data  Freq. W/L meas.:  Field aquifer char.

Hyd. lab. data: \_\_\_\_\_

Qual. water data; type: USGS 11/63

Freq. sampling: 41 Pumpage inventory:  no; period: \_\_\_\_\_

Aperture cards: \_\_\_\_\_

Log data: \_\_\_\_\_

WELL-DESCRIPTION CARD

SAME AS ON MASTER CARD Depth well: 1650 ft Meas. rept accuracy 6

Depth cased: \_\_\_\_\_ ft Casing type: \_\_\_\_\_; Diam. in 16

Finish: (C) porous concrete, (F) gravel w. (perf.), (G) gravel w. (screen), (H) horiz. gallery, (I) open end, (J) other, (K) perf., (L) screen, (M) sd. pt., (N) shored, (O) open hole, (P) other S

Method Drilled: (A) air rot, (B) bored, (C) cable, (D) dug, (E) hyd rot., (F) jetted, (G) air percussion, (H) reverse, (I) trenching, (J) driven, (K) drive wash, (L) other U

Date Drilled: 950 Pump intake setting: \_\_\_\_\_ ft

Driller: OWNER

Lift (type): (A) air, (B) bucket, (C) cent, (D) jet, (E) multiple (cent.), (F) multiple (turb.), (G) none, (H) piston, (I) rot, (J) submerg, (K) turb, (L) other N Deep  Shallow

Power (type): (A) diesel, (B) elec, (C) gas, (D) gasoline, (E) hand, (F) gas, (G) wind; H.P. 20 Trans. or meter no. U

Descrip. MP: plug at pump base 3.0 ft above below LSD, Alt. MP \_\_\_\_\_

Alt. LSD: 176 Accuracy (source) 3

Water Level: +14.55 ft above below MP; Ft below LSD 718 Accuracy: \_\_\_\_\_

Date meas: 7-13-73 Yield: 750 gpm Method determined 61

Drawdown: \_\_\_\_\_ ft Accuracy: \_\_\_\_\_ Pumping period \_\_\_\_\_ hrs

QUALITY OF WATER DATA: Iron \_\_\_\_\_ ppm Sulfate \_\_\_\_\_ ppm Chloride \_\_\_\_\_ ppm Hard. \_\_\_\_\_ ppm

Sp. Conduct 140 K x 10<sup>6</sup> Temp. 65 °F Date sampled 11/13/63 N63

Taste, color, etc. Ph. 6.0

DEC 9 1973  
MT  
+17.0  
MP  
11/7/1979

Well No.

Q6

Well No. Q6

Latitude-longitude N  
S  
d m s d m s

**HYDROGEOLOGIC CARD**

1 1 SAME AS ON MASTER CARD 19 D Physiographic Province: 03 Section: 03  
22 D Drainage Basin: 15F Subbasin: 11W 20 21 23 24 25 26

Topo of well site: (D) depression, stream channel, dunes, flat, hilltop, sink, swamp, (C) (E) (F) (H) (K) (L) (P) (S) (T) (U) (V) offshore, pediment, hillside, terrace, undulating, valley flat 27  

MAJOR AQUIFER: system TE series TE aquifer, formation, group 11W 28 29 30 31

Lithology: S Origin: 2 Aquifer Thickness:   ft 32 33 34

Length of well open to:   ft 35 37 Depth to top of:   ft 38 40 41 43

MINOR AQUIFER: system   series   aquifer, formation, group   44 45 46 47

Lithology:   Origin:   Aquifer Thickness:   ft 48 49 50

Length of well open to:   ft 51 53 Depth to top of:   ft 54 56 57 59

Intervals Screened:

Depth to consolidated rock:   ft 60 63 Source of data:   64

Depth to basement:   ft 65 68 Source of data:   69

Surficial material:   Infiltration characteristics:   70 71 72

Coefficient Trans:   gpd/ft 73 75 Coefficient Storage:   76 78

Coefficient Perm:   gpd/ft<sup>2</sup>; Spec cap:   gpm/ft; Number of geologic cards:   79

7/1973, sound pump removed  
water level 7-13-1973  
+14.55' above lsd  
water temperature = 18.5°C  
specific conductance = 140

Hwy 6 To Batesville →

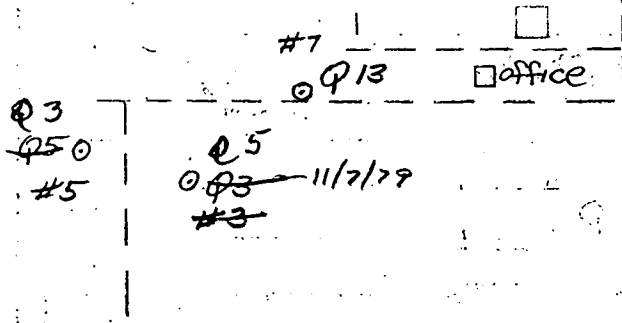
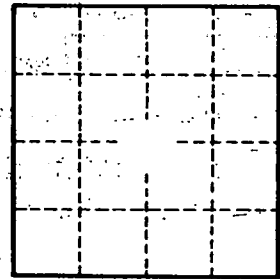

Q13 (1970) is only well in use

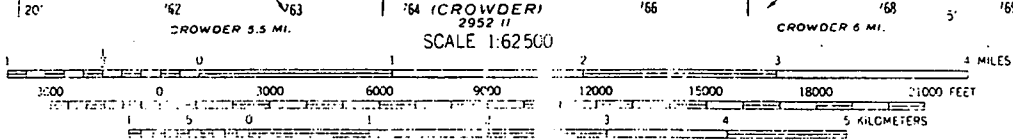
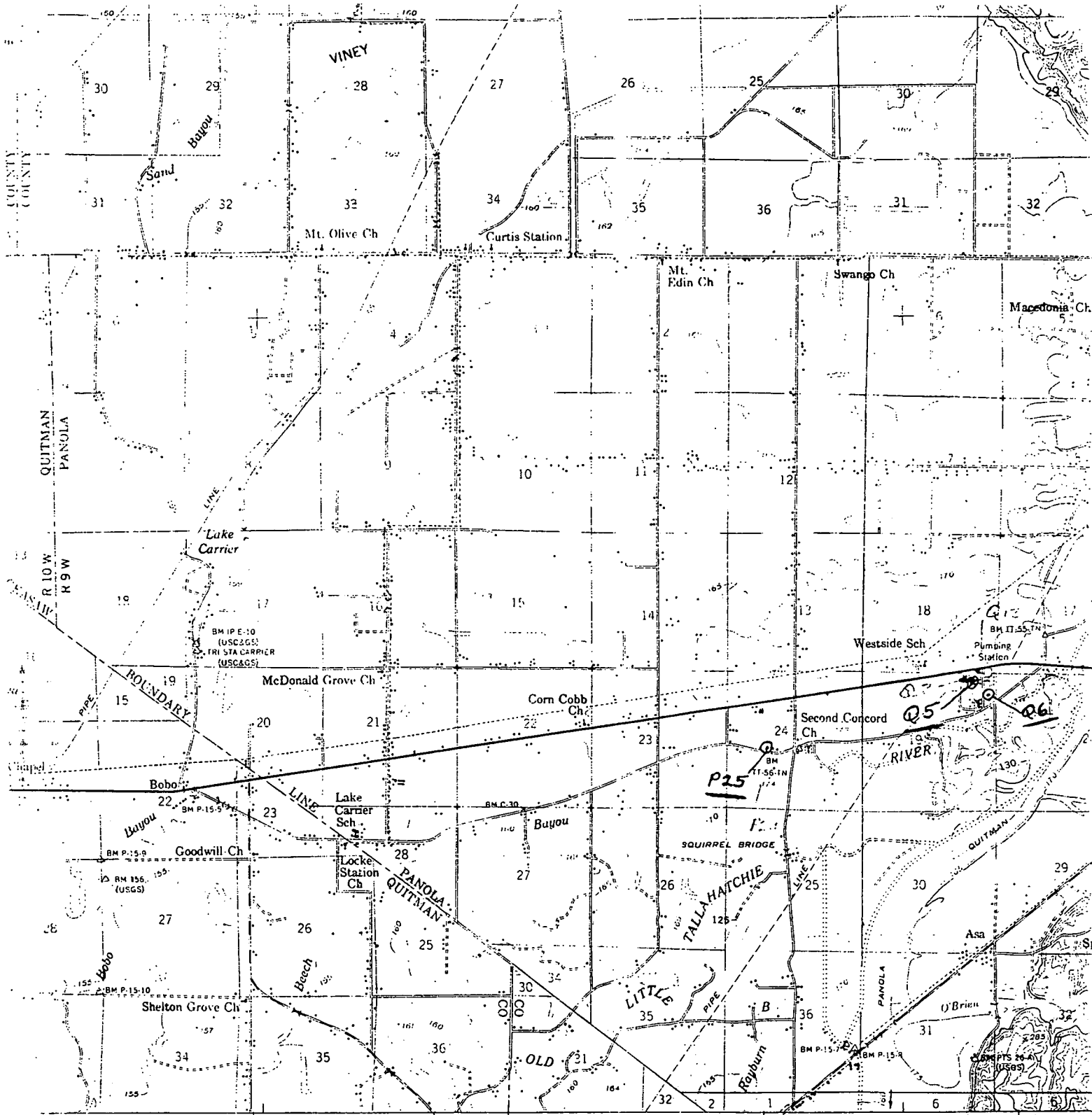

CONTOUR INTERVAL 5 AND 20 FEET  
 DASHED LINES REPRESENT 5 FOOT CONTOURS  
 NATIONAL GEODETIC VERTICAL DATUM OF 1929

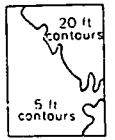

1929 GRID AND 1963 MAGNETIC NORTH  
 DECLINATION AT CENTER OF SHEET

FOR SALE BY U.S. GEOLOGICAL SURVEY, RESTON, VIRGINIA 22092  
 AND MISSISSIPPI RIVER COMMISSION, VICKSBURG, MISSISSIPPI 39180  
 A FOLDER DESCRIBING TOPOGRAPHIC MAPS AND SYMBOLS IS AVAILABLE ON REQUEST