

FORM 9-1642
(1-68)

Well No. Q4

WELL SCHEDULE
GEOLOGICAL SURVEY

E109 #36
WATER RESOURCES DIVISION

U. S. DEPT. OF THE INTERIOR

MASTER CARD

Record by J. A. Callahan Source of data _____ Date 5/22/72 Map _____

State 28 County (or town) Panola 54

Latitude: 34 16 45 N Longitude: 09 00 01 5 Sequential number: 1

Lat-long accuracy: 30 T. 9 S. R. 8 E. Sec 26, SE 1, SE 2, NE 3

Local well number: 0004DAZ609N08W Other number: _____ B & M _____

Local use: 036 Owner or name: FARRISH GRAVEL Address: _____

Ownership: County, Fed Gov't, City, Corp or Co, Private, State Agency, Water Dist _____ N

Use of water: (A) (B) (C) (D) (E) (F) (H) (I) (M) (N) (P) (R) _____ N

Use of well: (A) (D) (G) (H) (I) (P) (R) (T) (U) (W) (X) (Z) _____ W

DATA AVAILABLE: Well data Freq. W/L meas.: Field aquifer char.

Hyd. lab. data: _____

Qual. water data; type: _____

Freq. sampling: _____ Pumpage inventory: yes, no, period: _____

Aperture cards: _____ yes

Log data: _____ E

WELL-DESCRIPTION CARD

SAME AS ON MASTER CARD Depth well: _____ ft 154 Meas. rept _____ accuracy _____ 3

Depth cased: _____ ft 94 Casing type: _____; Diam. 12 in 12

Finish: (C) porous concrete, (F) gravel w. (perf.), (G) gravel w. (screen), (H) horiz. gallery, (I) open end, (P) perf., (S) screen, (T) sd. pt., (W) shored, (X) open hole, (Z) other _____ S

Method: (A) air rot, (B) bored, (C) cable dug, (D) dug, (H) hyd rot., (J) jetted, (P) percussion, (R) rotary, (T) reverse, (U) trenching, (V) driven, (W) drive wash, (Z) other _____ H

Date Drilled: 10/16/68 968 Pump intake setting: _____ ft _____

Driller: Dyer Well Co.

Lift (type): (A) air, (B) bucket, (C) cent., (J) jet, (L) multiple, (M) multiple, (N) none, (P) piston, (R) submerg, (S) turb., (T) other _____ T Deep _____ 0

Power (type): diesel, elec, gas, gasoline, hand, gas, wind, H.P. 25 Trans. or meter no. _____ V

Descrip. MP _____ ft above _____ ft below LSD, Alt. MP _____

Alt. LSD: _____ 265 Accuracy: (source) _____ 4

Water Level _____ ft above _____ ft below MP; _____ ft below LSD _____ 60 Accuracy: _____ D

Date meas: _____ 068 Yield: _____ gpm _____ 350 Method determined _____ 0

Drawdown: _____ ft _____ Accuracy: _____ Pumping period _____ hrs _____

QUALITY OF WATER DATA: Iron _____ ppm Sulfate _____ ppm Chloride _____ ppm Hard. _____

Sp. Conduct _____ 55 K x 10⁶ _____ 1 Temp. _____ °F _____ 170 Date sampled _____ 673

Taste, color, etc. _____

PUNCHED

DEC 9 1974

Well No. Q4

Well No. _____

Latitude-longitude _____
N
S
d m s d m s

BUNCHED

HYDROGEOLOGIC CARD

19 **SAME AS ON MASTER CARD** Province: 03 Section: _____

22 **D** Drainage Basin: 15F Subbasin: _____

Topo of well site: (D) depression, (C) stream channel, (E) dunes, (F) flat, (H) hilltop, (K) sink, (L) swamp, (P) offshore, (S) pediment, (T) hillside, (U) terrace, (V) undulating, (W) valley flat. _____

MAJOR AQUIFER: system _____ series TE aquifer, formation, group SS

Lithology: US Origin: 2 Aquifer Thickness: 262 ft

Length of well open to: 62 ft Depth to top of: 60 ft _____

MINOR AQUIFER: system _____ series _____ aquifer, formation, group _____

Lithology: _____ Origin: _____ Aquifer Thickness: _____ ft

Length of well open to: _____ ft Depth to top of: _____ ft _____

Intervals Screened: _____

Depth to consolidated rock: _____ ft Source of data: _____

Depth to basement: _____ ft Source of data: _____

Surficial material: _____ Infiltration characteristics: _____

Coefficient Trans: _____ gpd/ft Coefficient Storage: _____

Coefficient Perm: _____ gpd/ft²; Spec cap: _____ gpm/ft; Number of geologic cards: _____

*well pumps all day
no way to
measure water level*

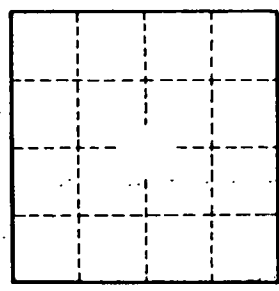
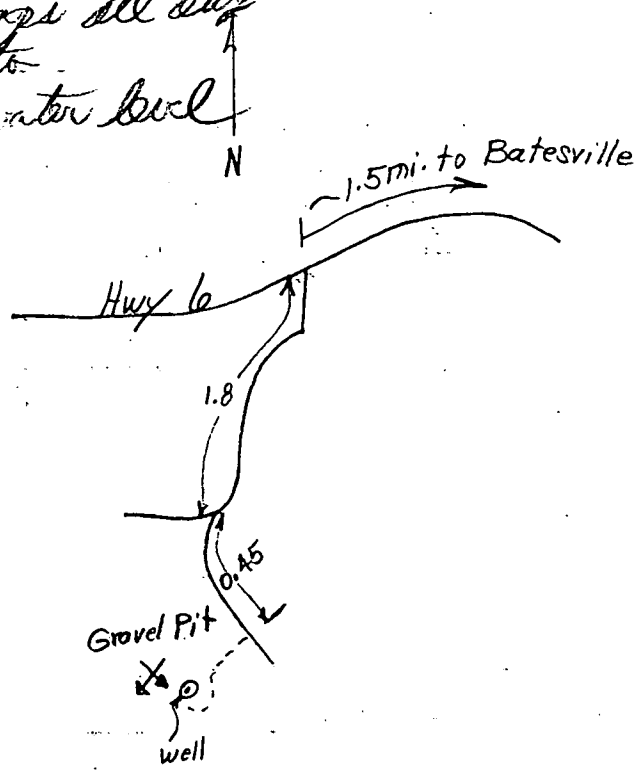

Well No. 04

MISSISSIPPI DEPARTMENT OF NATURAL RESOURCES

Bureau of Land and Water Resources

P. O. Box 10631
 Jackson, Mississippi 39209
 WATER WELL PLUGGING
 DECOMMISSIONING

COUNTY WELL LOCATED <i>ANOCA</i>	
WELL NUMBER	CODED
DATE WELL PLUGGED 11/5/91	

Q 4

PERMIT NUMBER 83-029
NAME OF DRILLING FIRM Not Known

NAME & MAILING ADDRESS OF LANDOWNER Memphis Stone & Gravel Co. P. O. Box 1683 Memphis, TN 38101			
WELL LOCATION	SEC	TOWNSHIP	RANGE
	26	9S	3E
DISTANCE	DIRECTION	NEAREST TOWN	
3 Mi.	SW	Batesville	
OTHER LANDMARK			
WELL PURPOSE: Home, Irrigation, Municipal, Industrial, Fish Pond, etc. Gravel washer makeup water			

NAME OF WELL CONTRACTOR WHO DRILLED THE WELL Not Known		
NAME OF LANDOWNER WHEN WELL WAS DRILLED Farris Gravel Company		
WELL DATA		
Well Depth 90'	Casing Diameter (in.) 6	Casing Length (Ft.)
Type of Casing Steel Pipe	Hole Depth x	Depth to Static Water Level 25
DATE WELL COMPLETED Not Known		

DESCRIBE HOW THE WELL OR HOLE WAS PLUGGED:
 (AMOUNT OF CASING AND/OR SCREEN THAT WAS REMOVED, OR LEFT IN HOLE,
 MATERIAL USED IN PLUGGING, ETC.)

This well was a portion of a plant purchase in 1983. We have no record of when it was drilled. In 1989, the well failed, filled and was not redrilled. In 1991 the top was plugged with bentonite pellets after

RECEIVED
NOV 06 1991

Dept. of Environmental Quality
 Bureau of Land & Water Resources

I CERTIFY THAT THE WELL WAS PLUGGED OR ABANDONED IN ACCORDANCE WITH THE STATE OF MISSISSIPPI REGULATIONS.

William L. Jolley, Jr.
 SIGNATURE

11-4-91
 DATE

Updated 2-28-92 Jolley