

WELL SCHEDULE

E-log #2

U. S. DEPT. OF THE INTERIOR

GEOLOGICAL SURVEY

WATER RESOURCES DIVISION

MASTER CARD

Record by BEW Source of data \_\_\_\_\_ Date 2-16-61 Map \_\_\_\_\_

State 28 County (or town) Panola 54

Latitude: 34° 17' 34" N Longitude: 090° 04' 21" W Sequential number: 1

Lat-long accuracy: 3 T 9 N 8 E Sec 19 NE NE

Local well number: Q003AA1909S08W Other number: #3 B & M

Local use: \_\_\_\_\_ Owner or name: JENN GAS CO Address: \_\_\_\_\_

Ownership: County, Fed Gov't, City, Corp or Co, Private, State Agency, Water Dist N

Use of water: (A) Air cond, Bottling, Comm, Dewater, Power, Fire, Dom, Irr, Med, Ind, P S, Rec, (S) Stock, Instit, Unused, Repressure, Recharge, Desal-P S, Desal-other, Other H

Use of well: (A) Anode, Drain, Seismic, Heat Res, Obs, Oil-gas, Recharge, Test, Unused, Withdraw, Waste, Destroyed. U

DATA AVAILABLE: Well data  Freq. W/L meas.: N Field aquifer char.

Hyd. lab. data:

Qual. water data; type: \_\_\_\_\_

Freq. sampling:  Pumpage inventory:  no. period: \_\_\_\_\_

Aperture cards: \_\_\_\_\_ yes

Log data: E-log 322-2457 E

WELL-DESCRIPTION CARD

SAME AS ON MASTER CARD Depth well: (see back) ft 695 Meas. 6

Depth cased; (first perf.) \_\_\_\_\_ ft \_\_\_\_\_ Casing type: \_\_\_\_\_; Diam. in 10

Finish: porous concrete, gravel w. (perf.), (screen), gravel w. gallery, end, horz. open hole, other N

Method Drilled: (A) air rot, (B) bored, (C) cable, (D) dug, (H) jetted, (J) percussion, (P) air rot., (R) reverse, (T) trenching, (V) driven, (W) drive wash, other H

Date Drilled: 947 Pump intake setting: \_\_\_\_\_ ft \_\_\_\_\_

Driller: C.M. Journey

Lift (type): (A) air, (B) bucket, (C) cent., (J) multiple, (L) multiple, (M) multiple, (N) none, (P) piston, (R) rot., (S) submerg, (T) turb., other N Deep  Shallow

Power (type): diesel, elec, gas, gasoline, hand, gas, wind; H.P. \_\_\_\_\_ Trans. or meter no. \_\_\_\_\_

11/7/79  
 + 7.1  
 MP 3.0  
 + 10.1

Descrip. MP \_\_\_\_\_ above \_\_\_\_\_ ft below LSD, Alt. MP \_\_\_\_\_

Alt. LSD: 175 Accuracy: (source) 5

Water Level \_\_\_\_\_ ft above \_\_\_\_\_ ft below MP; Ft below LSD \_\_\_\_\_ Accuracy: \_\_\_\_\_

Date meag: \_\_\_\_\_ Yield: \_\_\_\_\_ gpm \_\_\_\_\_ Method determined \_\_\_\_\_

Drawdown: \_\_\_\_\_ ft \_\_\_\_\_ Accuracy: \_\_\_\_\_ Pumping period \_\_\_\_\_ hrs \_\_\_\_\_

QUALITY OF WATER DATA: Iron \_\_\_\_\_ ppm \_\_\_\_\_ Sulfate \_\_\_\_\_ ppm \_\_\_\_\_ Chloride \_\_\_\_\_ ppm \_\_\_\_\_ Hard. \_\_\_\_\_ ppm \_\_\_\_\_

Sp. Conduct \_\_\_\_\_ K x 10<sup>6</sup> \_\_\_\_\_ Temp. \_\_\_\_\_ °F \_\_\_\_\_ Date sampled \_\_\_\_\_

Well No. Q3

Well No. \_\_\_\_\_

Latitude-longitude \_\_\_\_\_  
N  
S  
d e s d m s

HYDROGEOLOGIC CARD

1  SAME AS ON MASTER CARD 19 Physiographic Province: \_\_\_\_\_ 20 21 **03** Section: \_\_\_\_\_

22 **E** Drainage Basin: \_\_\_\_\_ 23 25 **15F** Subbasin: \_\_\_\_\_ 26

Topo of well site: (D) depression, stream channel, dunes, flat, hilltop, sink, swamp, (C) (E) (F) (H) (K) (L) (O) (P) (S) (T) (U) (V) offshore, pediment, hillside, terrace, undulating, valley flat \_\_\_\_\_ 27

MAJOR AQUIFER: \_\_\_\_\_ 28 **TE** series \_\_\_\_\_ 29 aquifer, formation, group \_\_\_\_\_ 30 **MW** \_\_\_\_\_ 31

Lithology: \_\_\_\_\_ 32 **US** Origin: \_\_\_\_\_ 33 **2** Aquifer Thickness: \_\_\_\_\_ 34 ft

**150** Length of well open to: \_\_\_\_\_ 35 ft \_\_\_\_\_ 37 Depth to top of: \_\_\_\_\_ 38 ft \_\_\_\_\_ 40 **470** \_\_\_\_\_ 41 \_\_\_\_\_ 43

MINOR AQUIFER: \_\_\_\_\_ 44 \_\_\_\_\_ 45 aquifer, formation, group \_\_\_\_\_ 46 \_\_\_\_\_ 47

Lithology: \_\_\_\_\_ 48 \_\_\_\_\_ 49 Origin: \_\_\_\_\_ 50 \_\_\_\_\_ 51 Aquifer Thickness: \_\_\_\_\_ 52 ft

\_\_\_\_\_ 53 Length of well open to: \_\_\_\_\_ 54 ft \_\_\_\_\_ 56 Depth to top of: \_\_\_\_\_ 57 ft \_\_\_\_\_ 59

Intervals Screened: \_\_\_\_\_

Depth to consolidated rock: \_\_\_\_\_ 60 ft \_\_\_\_\_ 63 Source of data: \_\_\_\_\_ 64

Depth to basement: \_\_\_\_\_ 65 ft \_\_\_\_\_ 68 Source of data: \_\_\_\_\_ 69

Surficial material: \_\_\_\_\_ 70 \_\_\_\_\_ 71 Infiltration characteristics: \_\_\_\_\_ 72

Coefficient Trans: \_\_\_\_\_ 73 gpd/ft \_\_\_\_\_ 75 Coefficient Storage: \_\_\_\_\_ 76 \_\_\_\_\_ 78

Coefficient Perm: \_\_\_\_\_ 79 gpd/ft<sup>2</sup>; Spec cap: \_\_\_\_\_ gpm/ft; Number of geologic cards: \_\_\_\_\_

*7/1973 well pumped dry - unused*

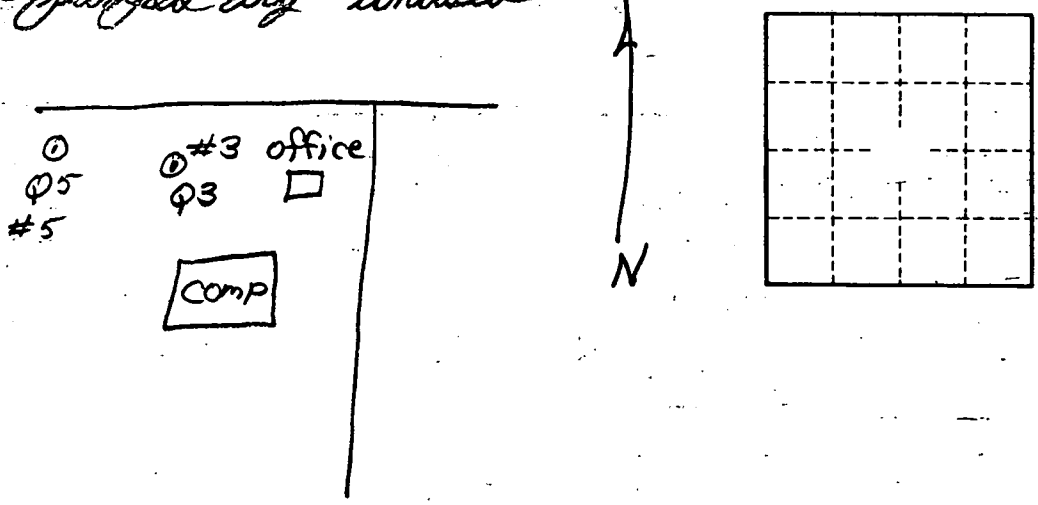

*See well Q6 for location*

*According to log, well is probably not greater than 630'.*