

690

6/78 WTO

Recorded by PEG
Date 7/29/69

U.S. GEOLOGICAL SURVEY
WATER RESOURCES DIVISION
MISSISSIPPI DISTRICT
WELL RECORD

Well No. P25
E-Log No. 39
County Panola
ASA DUND
690

TRANSMITTED FOR ADP

GEN. SITE DATA

Site ID 341719090060202 R=0* T=A* 2=W*

Data reliab. 3=C* Report. agency 4=USGS* Dist. 6=28* 7=28* Co. 8=107*

Lat. 9=341718* Long. 10=0900602* Well No. 12=P025*

Location 13=NE SW s 24 T 09 S R 09 W* Alt. 16=174*

Hyd. Unit (OWDC) 20= Date 21=08/13/1969*

Well use 23=W* Water Use 24=P* Hole depth 27=1182.* Well depth 28=1164.*

WL 30=7.* Date 31=11/07/1979* Source 33=S*

Status 273= Project No. 5=

OWNER

R=158* T=A* Date 159#08/13/1969* Owner No. Well #2

Owner 161=ELC W A

FIELD QW

R=192* T=A* Date 193#11/07/1979* Temp. 196#00010* 197=23.5*

R=192* T=A* Date 193#11/07/1979* Cond. 196#00095* 197=580.*

R=192* T=A* Date 193# / / * pH 196#00400* 197= . . *

CONSTR.

R=58* T=A* 59#1* Date 60=08/13/1969* Remarks

Drlg. 63=064* Name Layne Central Method 65=H* Finish 66=S*

CASING

R=76* T=A* 59#1*

Top csgn. 77# 0.* Bot. csgn. 78=1132.* Diam. 79# 8.*

R=76* T=A* 59#1*

Top csgn 77# 1132.* Bot. csgn. 78=1134.* Diam. 79# 6.*

OPENINGS

R=82* T=A* 59#1* Top 83# 1134.* Bottom 84=1164.*

Type 85=S* Diam. 87=6.* Size 88= . . *

R=82* T=A* 59#1* Top 83# . . * Bottom 84= . . *

Type 85= . . * Diam. 87= . . * Size 88= . . *

YIELD

R= 146* T=A* 147# 1* Q 150=175.* Q/S 272= . . *

134 flows 146 pumped

LIFT
 R=42* T= A * Lift type 43# S * Intake 44= * Power type 45= E *
 Date 38= 08/13/1969 * H.P. 46= 15. *

LOGS
 R=198* T= A * Log 199# D * Top 200= 0. * Bot 201= 11.64. *
 R=198* T= A * Log 199# E * Top 200= 10. * Bot 201= 11.82. *
 R=189* T= A * E Log No. 190# 03.9 * 191= M I S S D I S T *

ANAL.
 R=114* T= A * Year 115# * Type 120= *

AQUIFERS
 R=90* T= A * 256# 1 * Top 91= 11.35. * Bot 92= 11.80. *
 Unit ID 93= 124 WLCXL * Name of Unit
 R=90* T= A * 256# 1 * Top 91= * Bot 92= *
 Unit ID 93= * Name of Unit

HYDRAULICS
 R=98* T= A * 99# 1 * Unit tested 100= * 103= *
 R=105* T= A * 99# 1 * Test No. 106# *
 107= * Transmissivity (gal/d)/ft
 108= * Hydraul. cond. (gal/d)/ft²
 110= * Storage coeff. Boundaries

R=121* T= A * Yr Begin 122# 19.6.9 * Network 258= *

Water Level Data Collection (1):

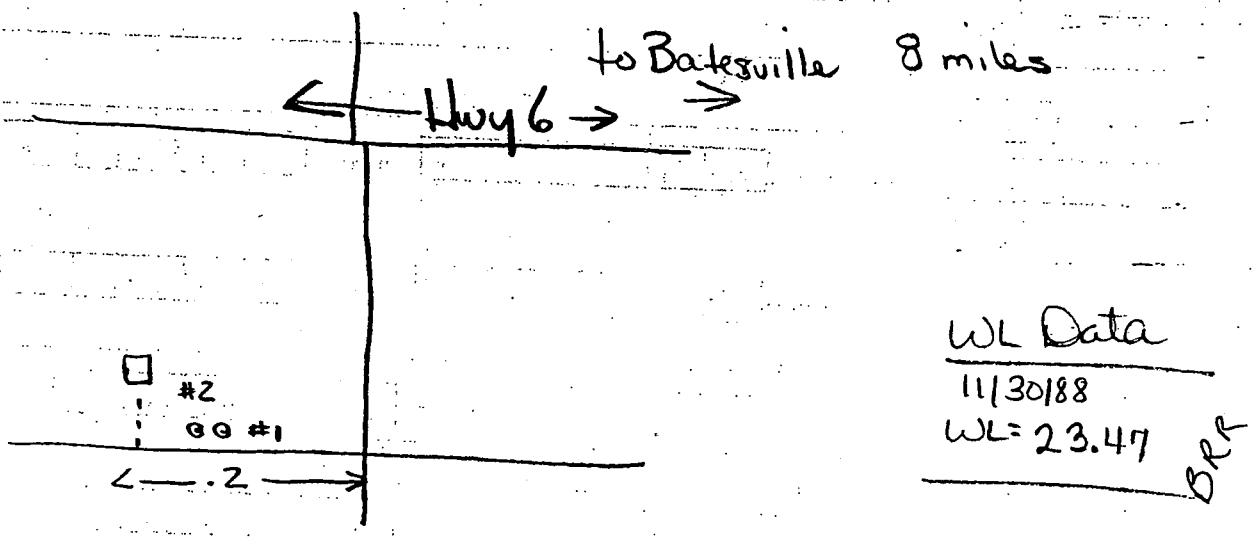

Water level + 8 when drilled

E LOG # 39

PANOLA
P 25
8-13-69
USGS

MISSISSIPPI
BOARD OF WATER COMMISSIONERS
416 North State Street
Jackson, Mississippi 39201

WATER WELL DRILLERS LOG

CODED

August 13 19 69 Layne-Central Company Panola
date well completed firm name county well located

LANDOWNER: Enon-Locke Station & Curtiss Water Association	description of formations encountered	from	to
Batesville, Mississippi (mailing address)	Clay	15	15
<u>WELL LOCATION:</u>	Sand	130	115
sec. <u>24</u> ⁹⁸ T XX R <u>9</u> ^{EX} EX S W	Sand & small gravel	140	10
1 miles West of Tenn. Gas (distance) (direction) (nearest town)	Sandy clay	226	86
<u>WELL PURPOSE:</u> Municipal (home, irrigation, municipal, industrial)	Sand	300	74
<u>WELL COMPLETION DATA:</u>	Sand & shale sts.	356	56
(1) diameter (inches) <u>8"</u>	Shale & sand sts.	400	44
(2) total depth (feet) <u>1168'</u>	Sand & shale	450	50
(3) static water level (feet) <u>8'</u> ^{XXXX} above top of ground.	Sandy shale	575	125
(4) casing <u>Steel</u> , <u>1132'</u> , <u>8"</u> (material) (depth) (size) if telescope see back.	Sand & shale sts.	625	50
(5) screen <u>30'</u> , <u>1134'</u> , <u>6"</u> , <u>stainless steel</u> (length) (depth to top) (size) (material)	Clay	696	71
(6) pump <u>15</u> , <u>175</u> (HP) (yield gpm)	Rocks & clay	730	34
(7) electric log <u>U.S.G.S.</u> (yes or no) Jackson, Miss. (organization running log)	Tough clay	830	100
(8) how well bottom plugged _____	Clay	873	43
<u>DRILLERS REMARKS:</u>	Rock	875	2
	Clay	980	105
	Sandy clay	1081	101
	Sand & clay	1131	50
	Sand	1165	34
	Shale	1168	3
	Sand	1178	10

CODED

APR 29 1969

MISSISSIPPI BOARD OF WATER COMMISSIONERS

WILCOX DATA SHEET-VERIFICATION CHECKLIST

COUNTY PANOLA

Rsa Quad
U.S.G.S. E-105 # 39

WELL OWNER Enon - Locke - Curtis W.A. # 2 CHECKED
U.S.G.S. NO. P-25 11/9/94
B.O.H. NO 540006-02 11/9/94
OLWR NO. MS-GW-7923 11/9/94

LOCATION:

MAP NW, NE, SW S 24, T 95, R 9 W 11/9/94

GPS _____

ELEV. (MSL) 174' 11/9/94

W.L. (L.S.) (1) - 33.73' 11/9/94

(2) - 33.73' 11/9/94

HEAD (MSL) + 140.27' 11/9/94

SCREENED INTERVAL 1,134' - 1,164' (LS) | - 960' - - 990' (MSL) 11/9/94

AQUIFER VERIFIED Lower Wilcox 11/9/94

PREVIOUS W.L. - 28.44' (1988) | - 7' (1979) 11/9/94

DATA ENTERED _____

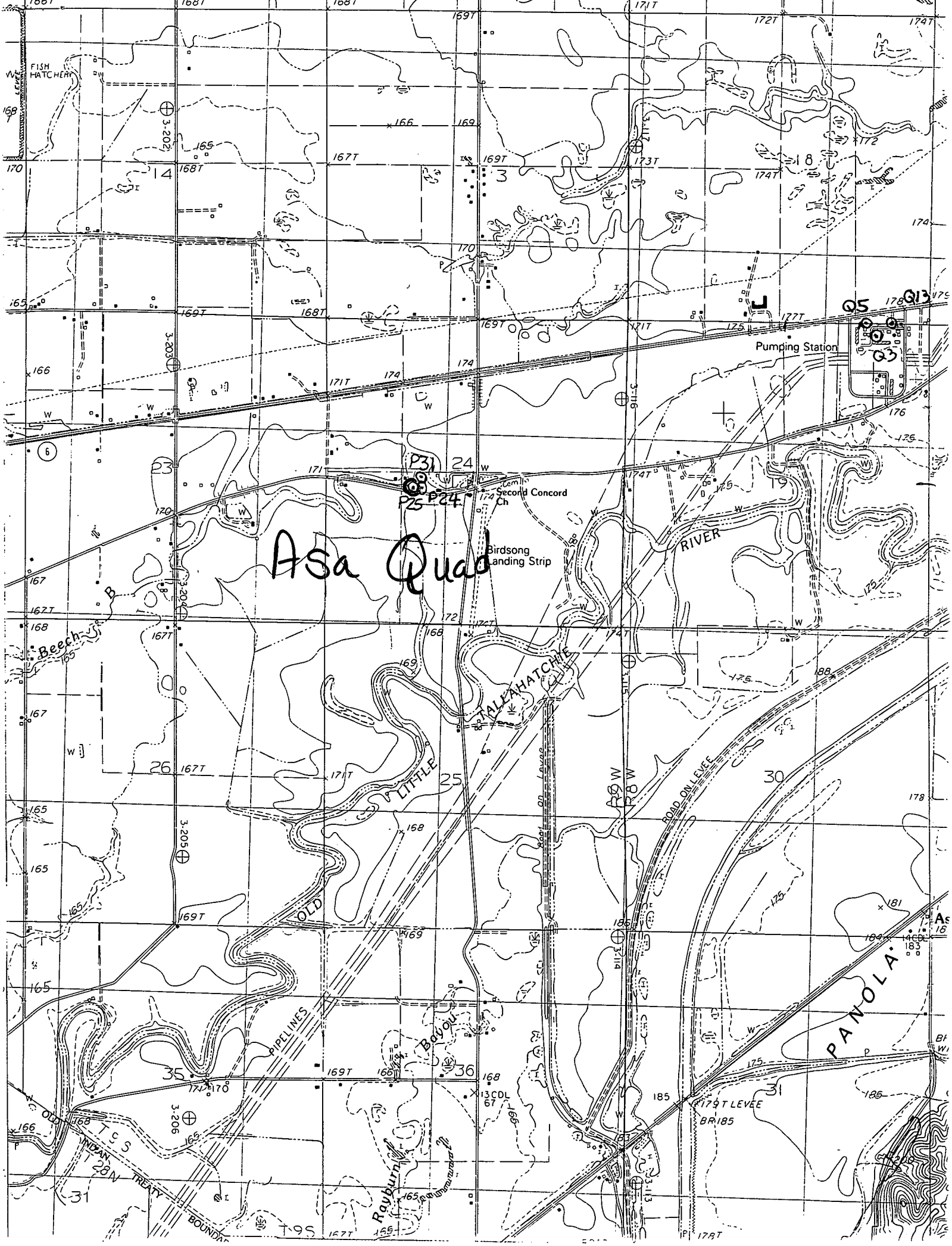

Asa Quad

Pumping Station

Second Concord Ch

Birdsong Landing Strip

TALLAHATCHIE RIVER

LITTLE RIVER

OLD PIPELINES

ROAD ON LEVEE

PANOLA

FISH HATCHERY

Beech

Bovou

Rayburn

T S S

T 28 N

TREATY BOUNDARY

179T LEVEE

BR185

168T

168T

169T

170T

167T

167T

169T

170T

167T

167T

168T

171T

167T

167T

169T

169T

167T

169T

169T

169T

170T

168T

169T

169T

168T

169T

171T

173T

171T

174T

174T

178T

186T

185T

178T

172T

174T

177T

176T

175T

178T

183T

175T

178T

174T

174T

177T

176T

175T

178T

183T

175T

178T

168

170

165

166

167

165

165

166

166

166

169

166

170

167

165

169

166

165

169

169T

169T

170

168

169

169

168

169

172

173T

171T

174T

174T

178T

186T

185T

178T

175

174T

177T

176T

175T

178T

183T

175T

178T

178

174T

177T

176T

175T

178T

183T

175T

178T

174

174T

177T

176T

175T

178T

183T

175T

178T

168

170

165

166

167

165

165

166

166

166

169

166

170

167

165

169

166

165

169

169T

169T

170

168

169

169

168

169

172

173T

171T

174T

174T

178T

186T

185T

178T

175

174T

177T

176T

175T

178T

183T

175T

178T

178

174T

177T

176T

175T

178T

183T

175T

178T

174

174T

177T

176T

175T

178T

183T

175T

178T