

6/78 WTO

Recorded by WTO

Date 9/68 5/80

U.S. GEOLOGICAL SURVEY
WATER RESOURCES DIVISION
MISSISSIPPI DISTRICT
WELL RECORD

TRANSMITTED FOR AWI

Well No. P24
E-Log No. 35
County Panola

Site ID 341719090060201 R=0* T=A* 2=W*

Data reliab. 3=C*^C Report. agency 4=USGS* Dist. 6=28* 7=28* Co. 8=107*

Lat. Long./ 9=341719* 10=0900602* Well No. 12=P024*

Location 13=NE SW S 24 T 09 S R 09 W* Alt. 16=174.*

Hyd. Unit (OWDC) 20= Date 21=01/10/1969*

Well use 23=W* Water Use 24=P* Hole depth 27=1200.* Well depth 28=1164.*

WL 30=-10.* Date 31=01/10/1969* Source 33=D*

Status 273= Project No. 5=

R=158* T=A* Date 159#01/10/1969* Owner No. Well #1

Owner 161=ELC W A

R=192* T=A* Date 193# Temp. 196#00010* 197=

R=192* T=A* Date 193# Cond. 196#00095* 197=

R=192* T=A* Date 193# pH 196#00400* 197=

R=58* T=A* 59#1* Date 60=01/10/1969* Remarks

Drlg. 63=001* Name Ray Lipe Method 65=H* Finish 66=S*

R=76* T=A* 59#1*

Top csng. 77#0.* Bot. csng. 78=1115.* Diam. 79#8.*

R=76* T=A* 59#1*

Top csng. 77#1115.* Bot. csng. 78=1124.* Diam. 79#6.*

R=82* T=A* 59#1* Top 83#1124.* Bottom 84=1164.*

Type 85=S* Diam. 87=6.* Size 88=

R=82* T=A* 59#1* Top 83# Bottom 84=

Type 85= Diam. 87= Size 88=

R=146* T=A* 147#1* Q 150=250.* Q/S 272=

134 flows 146 pumped

GEN. SITE DATA

OWNER

FIELD QW

CONSTR.

CASING

OPENINGS

YIELD

R=42* T= A * Lift type 43# T* Intake 44= * Power type 45= E*

LIFT Date 38= 01/10/1969* H.P. 46= 20.*

R=198* T= A * Log 199# E* Top 200= 10.* Bot 201= 1164.*

R=198* T= A * Log 199# D* Top 200= 0.* Bot 201= 1164.*

R=189* T= A * E Log No. 190# 0.35* 191= M I S S D I S T *

ANAL. R=114* T= A * Year 115# * Type 120= *

R=90* T= A * 256# 1 * Top 91= 1125.* Bot 92= 1200.*

Unit ID 93= 124WLCXL* Name of Unit

R=90* T= A * 256# 1 * Top 91= * Bot 92= *

Unit ID 93= * Name of Unit

R=98* T= A * 99# 1 * Unit tested 100= * 103= *

R=105* T= A * 99# 1 * Test No. 106# *

107= * Transmissivity (gal/d)/ft

108= * Hydraul. cond. (gal/d)/ft²

110= * Storage coeff. Boundaries

R=121* T= * Yr Begin 122# * Network 258= *

Water Level Data Collection (1)

pH = 8.4
Fe = Trace
T. alk = 230
Cl = 33
Hardness = 1
L. Wilcox
1131'-1164'
Flowed
25gpm

pH = 6.1
T. alk = 12
Fe = 6.
hard = 15
Cl = 8

Eng. Myers + Knight
600' (Meridian)
Flowed 35gpm

Panola
 P24
 1-10-69
 M.G.S.
 1-10-1969

~~MISSISSIPPI~~
 Test Hole #2
 MISSISSIPPI
 BOARD OF WATER COMMISSIONERS
 416 North State Street
 Jackson, Mississippi 39201

CODED
 CODED

WATER WELL DRILLERS LOG

1-10-1969 JAMES R. LIPE PANOLA
 date well completed firm name county well located

LANDOWNER: <u>E.L.C. WATER ASSOC.</u>	description of formations encountered	from	to
<u>BATESVILLE MISS</u> (mailing address)			
WELL LOCATION: 24 1/2' 35' 9W sep. T 27' N R 2' E	CLAY	0	40
10 miles W of BATESVILLE (distance) (direction) (nearest town)	SAND	40	110
WELL PURPOSE: <u>COMMUNITY</u> (home, irrigation, municipal, industrial)	CLAY	110	240
WELL COMPLETION DATA:	SAND	240	300
(1) diameter (inches) <u>8</u>	CLAY	300	320
(2) total depth (feet) <u>1164</u>	SAND	320	360
(3) static water level (feet) <u>10'</u> above top of ground.	CLAY	360	400
(4) casing <u>STEEL 115'</u> (material) (depth)	SAND + CLAY	400	420
<u>6</u> if telescope see back. (size)	SAND	420	460
(5) screen <u>40'</u> <u>1124'</u> (length) (depth to top)	CLAY	460	510
<u>6"</u> <u>SS</u> (size) (material)	SAND	510	540
(6) pump <u>20</u> <u>250</u> (HP) (yield gpm)	CLAY	540	562
<u>ELEC.</u> (type power)	SAND	562	620
(7) electric log <u>YES</u> (yes or no)	CLAY HARD	620	1016
<u>MISS. G.S.</u> (organization running log)	SAND	1016	1040
(8) how well bottom plugged <u>PLUG STEEL</u>	CLAY SAND	1040	1124
DRILLERS REMARKS:	SAND - FINE	1124	1164
<u>ADNE</u>			

FEB - 5 1969

MISS. Bd. of
 WATER COMMISSIONERS

WILCOX DATA SHEET-VERIFICATION CHECKLIST

COUNTY PANOLA

Asa Quad
U.S.G.S. E-log# 35

WELL OWNER Enon - Locke - Curtis W.A. #1 CHECKED
U.S.G.S. NO. P-24 11/9/94
B.O.H. NO 540006-01 11/9/94
OLWR NO. MS-GW-7924 11/9/94

LOCATION:

MAP NW, NE, SW S24, T9S, R9W 11/9/94
GPS _____
ELEV. (MSL) 174' 11/9/94
W.L. (L.S.) (1) - 30.58' 11/9/94
(2) - 30.58' 11/9/94
HEAD (MSL) + 143.42' 11/9/94
SCREENED INTERVAL 1,124' - 1,164' (LS) | - 950' - 990' (MSL) 11/9/94
AQUIFER VERIFIED Lower Wilcox 11/9/94
PREVIOUS W.L. +1' (1973) | +10' (1968) 11/9/94
DATA ENTERED _____

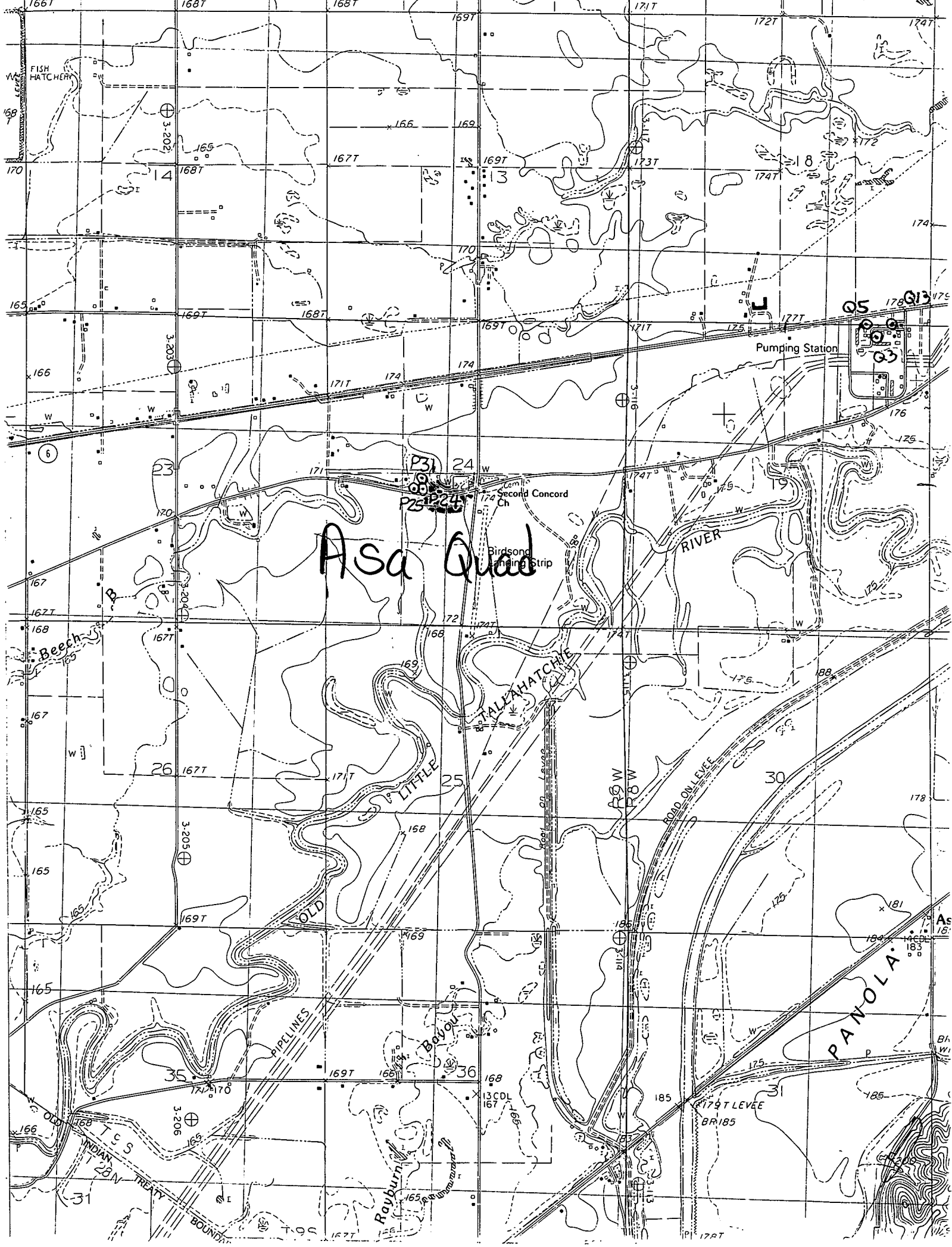

Asa Quad

PANOLA

TALLAHATCHIE

RIVER

Beech

Pumping Station

Second Concord Ch

Birdsong Landing Strip

PIPELINES

179' LEVEE BR 185

INDIAN TREATY BOUNDARY

Bovou

Ravburn