

GW12796

Sardis Dam

WRD Exp. (GW)  
April 1966

KNIGHT - Eng  
231-4281

Well No. \_\_\_\_\_

HI

SITE ID - 342802089493201  
U. S. DEPT. OF THE INTERIOR

WELL SCHEDULE  
GEOLOGICAL SURVEY

E109# 37 70B

WATER RESOURCES DIVISION

PUNCHED

PUNCHED and VERIFIED  
ROLLA COMPUTATION BRANCH

MASTER CARD

Record by PE. Grantham Source of data Engineer Dr. E Log Date 11-20-68 Map Sardis

State Miss County (or town) Panola 28 54

Latitude: 34 28 08 N Longitude: 08 9 49 32 Sequential number: 1

Lat-long accuracy: 2 T. 7 S. R. 6 Sec 15 SE SW SW

Local well number: H001CCL507S06W Other number: \_\_\_\_\_ B & M

Local use: 001037 Owner or name: Union Water Assoc.

Owner or name: UNION WATER Address: \_\_\_\_\_

Ownership: County, Fed Gov't, City, Corp or Co, Private, State Agency, Water Dist N

Use of water: (A) Air cond, (B) Bottling, (C) Comm, (D) Dewater, (E) Power, (F) Fire, (G) Dom, (H) Irr, (I) Med, (J) P S, (K) Rec, (L) Stock, (M) Instit, (N) Unused, (O) Repressure, (P) Desal-P S, (Q) Desal-other P

Use of well: (A) Anode, (B) Drain, (C) Seismic, (D) Heat Res, (E) Obs, (F) Oil-gas, (G) Recharge, (H) Test, (I) Unused, (J) Withdraw, (K) Waste, (L) Destroyed W

DATA AVAILABLE: Well data 70 Freq. W/L meas.: 0 Field aquifer char. 72

Hyd. lab. data: \_\_\_\_\_ 73

Qual. water data; type: USGS 3-11-71 74

Freq. sampling: 0 Pumpage inventory: yes 76 no; period: \_\_\_\_\_

Aperture cards: \_\_\_\_\_ yes 77

Log data: E Log 0-687 78 79

WELL-DESCRIPTION CARD

SAME AS ON MASTER CARD Depth well: \_\_\_\_\_ ft 340 Meas. rept accuracy 3

Depth cased: (first perf.) \_\_\_\_\_ ft 310 Casing type: \_\_\_\_\_; Diam. 8 in 8

Finish: porous concrete, gravel w. gravel w. horiz. open perf., screen, sd. pt., shored, open hole, other S

Method drilled: (A) air bored, (B) cable, (C) dug, (D) hyd jetted, (E) air rot., (F) reverse, (G) trenching, (H) driven, (I) drive wash, (J) other H

Date drilled: 11-68 968 Pump intake setting: 167 ft 167

Driller: Ray Lips Drilling Co Pope Miss

Lift (type): (A) air, (B) bucket, (C) cent, (D) jet, (E) multiple, (F) multiple, (G) none, (H) piston, (I) rot, (J) submerg, (K) turb, (L) other S Deep 40 Shallow \_\_\_\_\_

Power (type): diesel, elec, gas, gasoline, hand, gas, wind; H.P. 10 U Trans. or meter no. \_\_\_\_\_

Descrip. MP 425-5 above ft below LSD. Alt. MP \_\_\_\_\_

Alt. LSD: 420 425 Accuracy: (source) 5

Water Level: \_\_\_\_\_ ft above below MP; Ft below LSD 155 Accuracy: \_\_\_\_\_ 52 D

Date means: N68 Yield: \_\_\_\_\_ gpm 130 Method determined: \_\_\_\_\_ 61

Drawdown: \_\_\_\_\_ ft \_\_\_\_\_ Accuracy: \_\_\_\_\_ Pumping period \_\_\_\_\_ hrs \_\_\_\_\_ 66 68

QUALITY OF WATER DATA: Iron \_\_\_\_\_ ppm \_\_\_\_\_ Sulfate \_\_\_\_\_ ppm \_\_\_\_\_ Chloride \_\_\_\_\_ Hard. \_\_\_\_\_ 72

Sp. Conduct 32 K x 10 0 Temp. 170 Date sampled 3/11/71 371

Taste, color, etc. \_\_\_\_\_

50,1974  
Ymst

WLCata

12/14/79

MP 138.90

420

138.90

2.50

1/5/89

WLC=138.66

Well No. 41

Latitude-longitude \_\_\_\_\_  
d m s N S d m s

HYDROGEOLOGIC CARD

SAME AS ON MASTER CARD Physiographic Province: 03 Section: \_\_\_\_\_

Drainage Basin: D Subbasin: 151F

Topo of well site: (D) depression, stream channel, dunes, flat, hilltop, sink, swamp, (P) offshore, pediment, hillside, terrace, undulating, valley flat

MAJOR AQUIFER: system \_\_\_\_\_ series TE aquifer, formation, group TA

Lithology: US Origin: 2 Aquifer Thickness: \_\_\_\_\_ ft

Length of well open to: 9.8 ft Depth to top of: 30 ft

MINOR AQUIFER: system \_\_\_\_\_ series \_\_\_\_\_ aquifer, formation, group \_\_\_\_\_

Lithology: \_\_\_\_\_ Origin: \_\_\_\_\_ Aquifer Thickness: \_\_\_\_\_ ft

Length of well open to: \_\_\_\_\_ ft Depth to top of: \_\_\_\_\_ ft

Intervals Screened: 310' - 340' 30" x 6" #10

Depth to consolidated rock: \_\_\_\_\_ ft Source of data: \_\_\_\_\_

Depth to basement: \_\_\_\_\_ ft Source of data: \_\_\_\_\_

Surficial material: \_\_\_\_\_ Infiltration characteristics: \_\_\_\_\_

Coefficient Trans: \_\_\_\_\_ gpd/ft Coefficient Storage: \_\_\_\_\_

Coefficient Perm: \_\_\_\_\_ gpd/ft<sup>2</sup>; Spec cap: \_\_\_\_\_ gpm/ft; Number of geologic cards: \_\_\_\_\_

296' of 8" casing  
30' of screen

10,000 gal. pressure storage tank

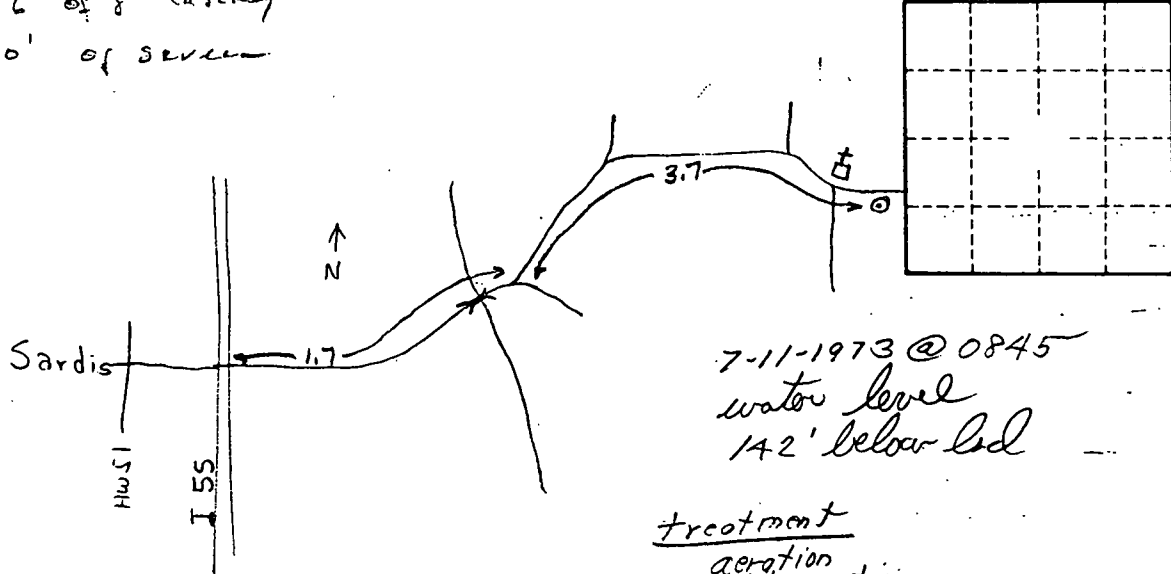

7-11-1973 @ 0845  
water level  
142' below lid

treatment  
aeration  
chlorination  
filtration  
pH

Sand sample from lower Well #1 received by Costless Well &  
60% retained on .0059 screen  
30% passed.  
mucous - stopped trouble



ELOG # 37

PANOLA  
HI  
4-19-69

MISSISSIPPI  
BOARD OF WATER COMMISSIONERS  
416 North State Street  
Jackson, Mississippi 39201

**CODED**

WATER WELL DRILLERS LOG

APRIL 19 1969 LIPE WELL CO. PANOLA  
date well completed firm name county well located

LANDOWNER:	description of formations encountered	from	to
UNION WATER ASS'N. Sardis, Miss (mailing address)			
<b>WELL LOCATION:</b>			
sec. 15 T. 7 N R. 6 E S miles E of Sardis (distance) (direction) (nearest town)			
<b>WELL PURPOSE:</b> Community (home, irrigation, municipal, industrial)			
<b>WELL COMPLETION DATA:</b>			
(1) diameter (inches) 8			
(2) total depth (feet) 340			
(3) static water level (feet) 145 below above top of ground.			
(4) casing Steel, 296' (material), (depth) 8 (size) if telescope see back.			
(5) screen 30' length, 310' depth to top 6" size, S.S. material			
(6) pump 10 HP, 130 yield gpm elec (type power)			
(7) electric log yes (yes or no) USGS (organization running log)			
(8) how well bottom plugged steel plug			
<b>DRILLERS REMARKS:</b>			

**CODED**

**WILCOX DATA SHEET-VERIFICATION CHECKLIST**

COUNTY PANOLA

Sardis Don Quaid  
U.S.G.S. E-log # 37

WELL OWNER	<u>Panola - Union Church W.A. (North well)</u>	<u>CHECKED</u>
U.S.G.S. NO.	<u>H-1</u>	<u>10/31/94</u>
B.O.H. NO	<u>540015-01</u>	<u>10/31/94</u>
OLWR NO.	<u></u>	<u></u>
 LOCATION:		
MAP	<u>SE, SW, SW S 15, T 7 S, R 6 W</u>	<u>10/31/94</u>
GPS	<u>✓</u> <u>lat/long vary from USGS</u>	<u></u>
ELEV. (MSL)	<u>425'</u>	<u>10/31/94</u>
W.L. (L.S.)	(1) <u>✓ - 138.25'</u>	<u>10/31/94</u>
	(2) <u>- 138.23'</u>	<u>10/31/94</u>
HEAD (MSL)	<u>+ 286.75</u>	<u>10/31/94</u>
SCREENED INTERVAL	<u>310' - 340' (LS) / +115' - +85' (MSL)</u>	<u>10/31/94</u>
AQUIFER VERIFIED	<u>Meridian - Upper Wilcox (Tallahatta)*</u>	<u>10/31/94</u>
PREVIOUS W.L.	<u>- 138.66' (1989) / - 155' (1969) / - 142' (1973)</u>	<u>10/31/94</u>
DATA ENTERED	<u></u>	<u></u>

This well is actually in the Tallahatta  
 Either it is not used or something is  
 wrong, W.L. are virtually the same  
 since 1989 + about 4 ft higher than  
 1973. There is also a Sparta well (H-37)  
 drilled in 1972 at the site. H-1 is  
 to the north of H-37. DELETE from



# Sardis Dam Quad



Radio tower  
Compressor Sta  
Substation

Panther Creek

Liberty Cent