

GW-5112

WRD Exp. (GW)  
April 1966

Well No. K7 permitted

WELL SCHEDULE

Elog # 51

U. S. DEPT. OF THE INTERIOR

GEOLOGICAL SURVEY

WATER RESOURCES DIVISION

**PUNCHED**

PUNCHED and VERIFIED  
ROLLA COMPUTATION BRANCH

MASTER CARD

Record by WTR Source of data Bowc Date 6/69 Map BRADLEY 134-C

State 4 28 County Oboltscha 53

Latitude: 33<sup>1</sup>19<sup>2</sup>39<sup>3</sup>N<sup>4</sup> Longitude: 08<sup>5</sup>8<sup>6</sup>58<sup>7</sup>41<sup>8</sup> Sequential number: 1

Lat-long accuracy: 2<sup>9</sup> T. 17<sup>10</sup> S. R. 130<sup>11</sup> W. Sec. 19<sup>12</sup> SE SW NE NW

Local well number: K007A01917N13E Other number: B & M

Local use: 053051 Owner or name: Craig Springs Well Co.

Owner or name: CRAIG SPRINGS WA Address: \_\_\_\_\_

Ownership: (C) County, (F) Fed Gov't, (M) City, Corp or Co, (N) Private, (P) State Agency, (S) Water Dist 67 N

Use of water: (A) Air cond, (B) Bottling, (C) Comm, (D) Dewater, (E) Power, (F) Fire, (G) Dom, (H) Irr, (I) Med, (J) P S, (K) Rec, (L) Stock, (M) Instit, (N) Unused, (O) Repressure, (P) Recharge, (Q) Desal-P S, (R) Desal-other, (S) Other 68 P

Use of well: (A) Anode, (B) Drain, (C) Seismic, (D) Heat Res, (E) Obs, (F) Oil-gas, (G) Recharge, (H) Test, (I) Unused, (J) Withdraw, (K) Waste, (L) Destroyed 69 W

DATA AVAILABLE: Well data  Freq. W/L meas.: 1  Field aquifer char. 72

Hyd. lab. data: \_\_\_\_\_ 73

Qual. water data; type: 3/72 uses 74

Freq. sampling: \_\_\_\_\_  Pumpage inventory: yes 76  no; period: \_\_\_\_\_

Aperture cards: \_\_\_\_\_ yes 77

Log data: \_\_\_\_\_ 78 79  DE

WELL-DESCRIPTION CARD

SAME AS ON MASTER CARD Depth well: 1940 ft Meas. 3 accuracy 24

Depth cased: 1880 ft Casing type: Steel; Diam. 6x3 in 29 30

Finish: (C) porous concrete, (F) gravel w. concrete, (G) gravel w. (screen), (H) horiz. gallery, (I) open end, (J) perf., (K) screen, (L) sd. pt., (M) shored, (N) open hole, (O) other 31 S

Method Drilled: (A) air rot, (B) bored, (C) cable, (D) dug, (E) hyd jetted, (F) air rot., (G) percussion, (H) rotary, (I) reverse, (J) trenching, (K) driven, (L) wash, (M) other 32 A

Date Drilled: 8/66 966 Pump intake setting: \_\_\_\_\_ ft 36 38

Driller: T.M. Parks name address

Lift (type): (A) air, (B) bucket, (C) cent. jet, (D) multiple, (E) multiple, (F) none, (G) piston, (H) rot, (I) submerg, (J) turb, (K) other 39 Deep 40  Shallow

Power (type): diesel, elec, gas, gasoline, hand, gas, wind; H.P. 10 U Trans. or meter no. \_\_\_\_\_

Descrip. MP brother pipe hole on top of casing 330 5/92 2.3 ft above 41 below LSD. Alt. MP \_\_\_\_\_

Alt. LSD: 340 Accuracy: (source) 47 4

Water Level: ft above below MP; ft above below LSD 132 Accuracy: 52 A

Date meas: 8/66 372 Yield: \_\_\_\_\_ gpm 75 Method determined 4 61

Drawdown: ft \_\_\_\_\_ Accuracy: \_\_\_\_\_ hrs \_\_\_\_\_ 66 68

QUALITY OF WATER DATA: Iron \_\_\_\_\_ ppm Sulfate \_\_\_\_\_ ppm Chloride \_\_\_\_\_ ppm Hard. \_\_\_\_\_ ppm

Sp. Conduct 1400 K x 10<sup>6</sup> 5 Temp. °F 290 Date sampled From tank 372 77 79

Taste, color, etc. pH=7.9 uses

WL Data  
11/15/82  
WL=152.44  
182.56

10/19/92  
WL=168.85

9/19/79  
WL=142.30  
197.7

340  
142  
+ 198

Well No.

47

Well No. K7

Latitude-longitude N  
S  
d m s d m s

**HYDROGEOLOGIC CARD**

**SAME AS ON MASTER CARD** **Physiographic Province:** 03 **Section:** \_\_\_\_\_

**Drainage Basin:** D **Subbasin:** 136

**Topo of well site:** (D) depression, stream channel, dunes, flat, hilltop, sink, swamp, (E) offshore, pediment, hillside, terrace, undulating, valley flat

**MAJOR AQUIFER:** system \_\_\_\_\_ series K3 aquifer, formation, group G0

**Lithology:** \_\_\_\_\_ **Origin:** 2 **Aquifer Thickness:** \_\_\_\_\_ ft

**Length of well open to:** \_\_\_\_\_ ft **Depth to top of:** 1830 ft

**MINOR AQUIFER:** system \_\_\_\_\_ series \_\_\_\_\_ aquifer, formation, group \_\_\_\_\_

**Lithology:** \_\_\_\_\_ **Origin:** \_\_\_\_\_ **Aquifer Thickness:** \_\_\_\_\_ ft

**Length of well open to:** \_\_\_\_\_ ft **Depth to top of:** \_\_\_\_\_ ft

**Intervals Screened:** \_\_\_\_\_

**Depth to consolidated rock:** \_\_\_\_\_ ft **Source of data:** \_\_\_\_\_

**Depth to basement:** \_\_\_\_\_ ft **Source of data:** \_\_\_\_\_

**Surficial material:** \_\_\_\_\_ **Infiltration characteristics:** \_\_\_\_\_

**Coefficient Trans:** \_\_\_\_\_ gpd/ft **Coefficient Storage:** \_\_\_\_\_

**Perm:** \_\_\_\_\_ gpd/ft<sup>2</sup>; Spec cap: \_\_\_\_\_ gpm/ft; Number of geologic cards: \_\_\_\_\_

9/19/78 WL, 8/66, 100ft. below 10d by driller  
 1550 Pump off  
 1554 204 - 58.50 = 145.50  
 1558 150 - 4.58 = 145.42  
 1603 150 - 4.60 = 145.40  
 2.13 = 142.30  
 N Hwy 12  
 Sturgis

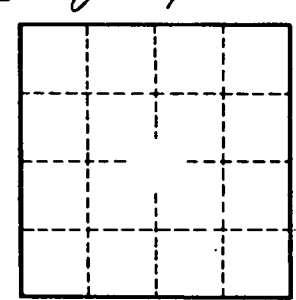
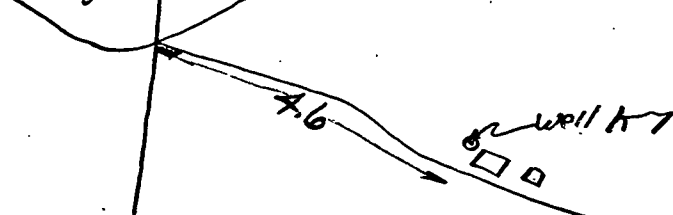

12-4-90  
 MP = 1.0' Air/Pipe  
 Hold = 180'  
 Cut = 10.23'  
 168.77  
 161.23 > SL

Discharge for pumping test possible off off 3" plug in 3" T fitting.

Well No. K7