

GW-733

Control building locked 10/92 Tommy Smith 465-7486  
Jerry Hunt 465-7418

1/81 WTO

Recorded by 1/Cant  
Date 6/28/82

U.S. GEOLOGICAL SURVEY  
WATER RESOURCES DIVISION  
MISSISSIPPI DISTRICT  
WELL RECORD

Well No. J 11 *permitted*  
E-Log No. # 77  
County OK TIBBEHA

TRANSMITTED FOR ADP 11-82

*Sturgis*

Site ID 3.3.2.2/6.0.8.9.0.3.2.9.0.1 R=0\* T=A\* 2=W\*

*STURGIS 193-D*

Data reliab. 3-U Report. agency 4-USGS\* Dist. 6-28\* 7-28\* Co. 8-10.5

Lat. 30  
Long. 9-3.3.2.2/6.1\* 10-0.8.9.0.3.2.9.1\* Well No. 12-J.0.1.1.\*

Location 13-N.W.N.E. S. 0.5 T. 17 W. R. 12 E.\* Alt. 16-428.\*

Hyd. Unit (OWDC) 20- Date 21-0.5.1.12.1.19.82.\*

Well use 23-W\* Water Use 24-P\* Hole depth 27-2260.\* Well depth 28-2250.\*

WL 30-245.\* Date 31-0.7.1.15.1.19.82.\* Source 33-D\*

Status 273- Project No. 5-

*elev 410 1/93*

R=158\* T=A\* Date 159# 0.7.1.15.1.19.82.\* Owner No.

Owner 161# W.A.K.E. F.O.R.R.E.S.T. W.A.\*

R=192\* T=A\* Date 193# Temp. 196#00010\* 197-\*

R=192\* T=A\* Date 193# Cond. 196#00095\* 197-\*

R=192\* T=A\* Date 193# pH 196#00400\* 197-\*

R=58\* T=A\* 59# 1\* Date 60-0.7.1.15.1.19.82.\* Remarks

Drlg. 63-0.5.3.\* Name T.M. PARKS Method 65-H\* Finish 66-G\*

R=76\* T=A\* 59# 1\*

Top csgn. 77# 0.\* Bot. csgn. 78-2100.\* Diam. 79# 10.\*

R=76\* T=A\* 59# 1\*

Top csgn 77# 2060.\* Bot. csgn. 78-2190.\* Diam. 79# 6.\*

R=82\* T=A\* 59# 1\* Top 83# 2190.\* Bottom 84-2250.\*

Type 85-S\* Diam. 87-6.\* Size 88-

R=82\* T=A\* 59# 1\* Top 83# Bottom 84-

Type 85- Diam. 87- Size 88-

R=146\* T=A\* 147# 1\* Q 150-150.\* Q/S 272-

134 flows 146 pumped

GEN SITE DATA

OWNER

FIELD QW

CONSTR.

CASING

OPENINGS

YIELD

LIFT  
 R=42\* T= A \* Lift type 43# T\* Intake 44= \* Power type 45= E\*  
 Date 38= 07/15/1982\* H.P. 46= 25.\*

LOGS  
 R=198\* T= A \* Log 199# E\* Top 200= 42.\* Bot 201= 2258.\*  
 R=198A T= A \* Log 199# D\* Top 200= 0.\* Bot 201= 2260.\*  
 R=189\* T= A \* E Log No. 190# 0.7.7\* 191= M I S S D I S T \*

ANAL.  
 R=114\* T= A \* Year 115# \* 117= \* 120= \*

AQUIFERS  
 R=90\* T= A \* 256# 1 \* Top 91= 2100.\* Bot 92= 2260.\*

Unit ID 93= ZILBORD \* Name of Unit \_\_\_\_\_  
 R=90\* T= A \* 256# 1 \* Top 91= \* Bot 92= \*  
 Unit ID 93= \* Name of Unit \_\_\_\_\_

HYDRAULICS  
 R=98\* T= A \* 99# 1 \* Unit tested 100= \* 103= \*

R=105\* T= A \* 99# 1 \* Test No. 106# \*  
 107= \* Transmissivity (gal/d)/ft \_\_\_\_\_  
 108= \* Hydraul. cond. (gal/d)/ft<sup>2</sup> \_\_\_\_\_  
 110= \* Storage coeff. Boundaries \_\_\_\_\_

R=121\* T= \* Yr Begin 122# \* Network 258# \*

12-4-90 Water Level Data Collection (1)

MP = 2.5'  
 Hold = 270'  
 Cont = 8.82' } 258.68'

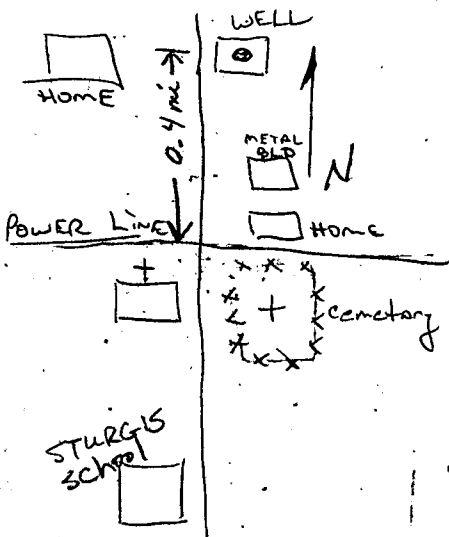

Description of formations encountered	From	To
topsoil	0	100
clay w/limestone	100	640
sandy shale, limestone	640	870
limestone w/chalk	870	1040
hard limestone w/shales	1040	1370
shale w/fine sand & limestone	1370	1510
hard limestone w/shale	1510	1570
shale, fine sand & limestone	1570	1820
pink gumbo	1820	1860
Sandy (fine)	1860	1930
gumbo w/shale	1930	1990
sandy shale	1990	2020
pink gumbo	2020	2050
fine sand	2050	2080
tough gumbo	2080	2090
fine sand w/gravel	2090	2150
fine gravel	2150	2175
good coarse gravel and sand	2175	2260
TOTAL DEPTH...		2260'

HWY 12 → TO STARKVILLE.

OKTIBBEHA

J11

7-15-82

Log # 77

MISSISSIPPI  
BOARD OF WATER COMMISSIONERS  
416 North State Street  
Jackson, Mississippi 39201

WATER WELL DRILLERS LOG

July 15 19 82 T.M. Parks Drlg. Co. Oktibbeha  
date well completed firm name county well located

LANDOWNER: Wake Forest Water Association, Inc.	description of formations encountered	from	to
Rt. 1 Sturgis, MS 39769 (mailing address)	topsoil	0	100
	clay w/limestone	100	640
	sandy shale, limestone	640	870
	limestone w/chalk	870	1040
	hard limestone w/shales	1040	1370
	shale w/fine sand & limestone	1370	1510
	hard limestone w/shale	1510	1570
	shale, fine sand & limestone	1570	1820
	pink gumbo	1820	1860
	Sandy (fine) gumbo w/shale	1860	1930
	sandy shale	1930	1990
	pink gumbo	1990	2020
	fine sand	2020	2050
	tough gumbo	2050	2080
	fine sand w/gravel	2080	2090
	fine gravel	2090	2150
	good coarse gravel and sand	2150	2175
		2175	2260
	TOTAL DEPTH...		
		2260'	

LANDOWNER: Wake Forest  
Water Association, Inc.  
Rt. 1 Sturgis, MS 39769  
(mailing address)

WELL LOCATION:  
sec. 5 T 17 N R 12 E  
3 miles North of Maben  
(distance) (direction) (nearest town)

WELL PURPOSE: City  
(home, irrigation, municipal, industrial)

WELL COMPLETION DATA:  
(1) diameter (inches) 13 3/4"  
(2) total depth (feet) 2260'  
(3) static water level (feet) 245 below  
top of ground.  
(4) casing steel 2100'  
(material) (depth)  
10 3/4" telescope see back.  
(size)  
(5) screen 62' 2190'  
(length) (depth to top)  
6" stainless steel  
(size) (material)  
(6) pump 25 150  
(HP) (yield gpm)  
3 phase  
(type power)  
(7) electric log yes  
(yes or no)  
MGS  
(organization running log)  
(8) how well bottom plugged BPV

DRILLERS REMARKS:

DEPT. OF NATURAL RESOURCES  
BUREAU OF LAND & WATER RESOURCES

JUL 19 1982

RECEIVED

④

If well telescopes please sketch and show depths.

GROUND LEVEL

SECTION \_\_\_\_\_

Please indicate well location X.

ADDITIONAL INFORMATION

If more than one screen, show locations of each on sketch.

# Sturgis Quad

