

FILE COPY

E-log #60

PUNCHED

MASTER CARD Q

E-log Bowc 9/73

Record by GJD

Source of data driller

Date 5-1-73 Map

State 28

County (or town) OKTIBBEHA

53

Latitude: 33 deg 20 min 37 sec N

Longitude: 089 degrees 02 min 56 sec W

Sequential number: 1

Lat-long accuracy: 2 sec

17 S, 12 W, Sec 16, NW 1/4, NE 1/4, NW 1/4

Local well number: 1010AB1617N12E

Other number: B & M

Local use: 053060

Owner or name: Town of Sturgis

Owner or name: STURGIS

Address:

Ownership: County, Fed Gov't, City, Corp or Co, Private, State Agency, Water Dist M

Use of water: Air cond, Bottling, Comm, Dewater, Power, Fire, Dom, Irr, Med, Ind, P S, Rec, P

Stock, Instit, Unused, Repressure, Recharge, Desal-P S, Desal-other, Other W

Use of well: Anode, Drain, Seismic, Heat Res, Obs, Oil-gas, Recharge, Test, Unused, Withdraw, Waste, Destroyed. W

DATA AVAILABLE: Well data 70 Freq. W/L meas.: 71 Field aquifer char. 72

Hyd. lab. data: 73

Qual. water data; type: 74

Freq. sampling: 75 Pumpage inventory: 76 yes no; period: 77 yes

Aperture cards: 78

Log data: E-log: 50-1465 ft. TD. 2200' DE

WELL-DESCRIPTION CARD

SAME AS ON MASTER CARD

Depth well: 2160 ft Meas. 3

Depth cased: (first perf.) 2100 ft

Casing type: 8x4 in

Diam. 8x4 in

Finish: porous concrete, gravel w. concrete, gravel w. (perfl.), gravel w. (screen), gravel w. (gallery), gravel w. (open end), gravel w. (open hole), gravel w. (other) S

Method Drilled: (A) air rot, (B) bored, (C) cable, (D) dug, (E) hyd jetted, (F) air rot., (G) reverse percuss, (H) air percuss, (I) reverse percuss, (J) driven, (K) drive wash, (L) other 7

Date Drilled: 5-1-73

973

Pump intake setting: 30 ft

Driller: T.M. Parks

Lift (type): (A) air, (B) bucket, (C) cent, (D) jet, (E) multiple, (F) multiple, (G) none, (H) piston, (I) rot, (J) submerg, (K) turb, (L) other T Deep 40 Shallow

Power (type): diesel, elec, gas, gasoline, hand, LP, gas, wind, H.P. 25 Y Trans. or meter no. 40

Descrip. MP top of 2" vent pipe at 3.2 ft. below LSD; Alt. MP 325

Alt. LSD: 330 Accuracy: (source) topo 5

Water Level: 150 ft above below MP; Ft below LSD 150 Accuracy: D

Date meas: 973 Yield: 150 gpm Method determined 61

Drawdown: 62 ft Accuracy: 63 Pumping period 64 hrs 65

QUALITY OF WATER DATA: Iron 66 ppm Sulfate 67 ppm Chloride 68 ppm Hard. 69 ppm

Sp. Conduct 70 K x 10⁶ Temp. 71 °F Date sampled 72

Taste, color, etc.

Contact Island James 465-8707

8/11/87 160' head 3.5 MP 7.73 148.77

10/2/78 W.L.: 137.60 195 44.25 150.25 3.2 147.05

Well No. J 10

HYDROGEOLOGIC CARD

STATE AS ON MASTER CARD Physiographic Province: _____ 03 Section: _____
 Drainage Basin: D 136 Subbasin: _____

Topo of well site: (D) (C) (E) (F) (H) (K) (L) depression, stream channel, dunes, flat, hilltop, sink, swamp
 (Ø) (P) (S) (T) (U) (V) offshore, pediment, hillside, terrace, undulating, valley flat

MAJOR AQUIFER: _____ system _____ series K3 _____ aquifer, formation, group GØ
 Lithology: _____ UG Origin: _____ 2 Aquifer Thickness: 70+ ft

Length of well open to: _____ ft 60 Depth to top of: 2100 ft

MINOR AQUIFER: _____ system _____ series _____ aquifer, formation, group _____
 Lithology: _____ Origin: _____ Aquifer Thickness: _____ ft

Length of well open to: _____ ft _____ Depth to top of: _____ ft

Intervals Screened:
 Depth to consolidated rock: _____ ft _____ Source of data: _____
 Depth to basement: _____ ft _____ Source of data: _____
 Surficial material: _____ Infiltration characteristics: _____
 Coefficient Trans: _____ gpd/ft _____ Coefficient Storage: _____
 Coefficient Perm: _____ gpd/ft²; Spec cap: _____ gpm/ft; Number of geologic cards: _____

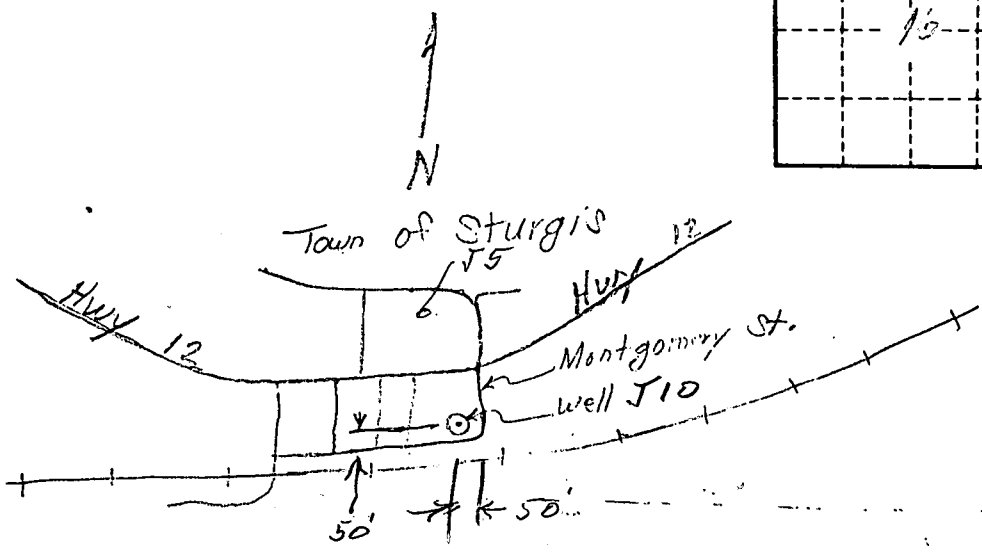
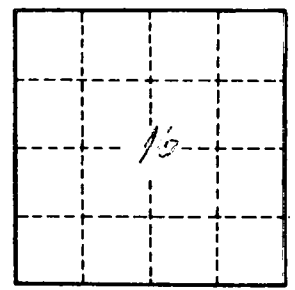

Well No. J10

FORM NO. 9-1904-E
Revised September 1980

OKti bbeha
Gordo

U.S. DEPT. OF INTERIOR
GEOLOGICAL SURVEY
WATER RESOURCES DIVISION
WATER-LEVEL DATA

FILE COPY

WELL NO. J10
MP HEIGHT _____

owner: Sturgis

Site Ident. No.
R = 234 * T = A *

DATE	WATER LEVEL (BELOW LSD)	STATUS	METHOD	HOLD	CUT	DEPTH BELOW MP	REMARKS	DATE PUNCHED	DATE ENTERED
235 # 10/02/1978 *	237 = 137.60 *	238 = *	239 = *						
235 # / / / *	237 = . . . *	238 = *	239 = *						
235 # 10/15/1982 *	237 = 147.05 *	238 = *	239 = *						
235 # / / / *	237 = . . . *	238 = *	239 = *						
235 # / / / *	237 = . . . *	238 = *	239 = *						
235 # / / / *	237 = . . . *	238 = *	239 = *						
235 # / / / *	237 = . . . *	238 = *	239 = *						
235 # / / / *	237 = . . . *	238 = *	239 = *						
235 # / / / *	237 = . . . *	238 = *	239 = *						
235 # / / / *	237 = . . . *	238 = *	239 = *						
235 # / / / *	237 = . . . *	238 = *	239 = *						
235 # / / / *	237 = . . . *	238 = *	239 = *						
235 # / / / *	237 = . . . *	238 = *	239 = *						
235 # / / / *	237 = . . . *	238 = *	239 = *						
235 # / / / *	237 = . . . *	238 = *	239 = *						
235 # / / / *	237 = . . . *	238 = *	239 = *						
235 # / / / *	237 = . . . *	238 = *	239 = *						
235 # / / / *	237 = . . . *	238 = *	239 = *						
235 # / / / *	237 = . . . *	238 = *	239 = *						
235 # / / / *	237 = . . . *	238 = *	239 = *						
235 # / / / *	237 = . . . *	238 = *	239 = *						
235 # / / / *	237 = . . . *	238 = *	239 = *						
235 # / / / *	237 = . . . *	238 = *	239 = *						
235 # / / / *	237 = . . . *	238 = *	239 = *						

MEASURING POINT
R = 320 * T = A D M *
add, delete, modify

Method of Measurement
239 = A B C E G H L M N R S T V Z
airline, analog, calibrated, estimated, pressure, calibrated, geophysical, manometer, non-reported, steel, electric, calibrated, other
airline gage pressure gage logs recording tape tape electric tape

M.P. Begin Date 321 # / / / / / *
M.P. End Date 322 = / / / / / *
M.P. Height 323 = . . . *
M.P. Remark 324 =

Site Status
238 = D E F G H I J N O P R S T V W X Z
dry, recently, flowing, nearby, nearby, injector, injector, discon- obstruction, pumping, recently, nearby, nearby, foreign, well, affected by, other
flowing flowing recently flowing or site monitor measuring pumped pumping recently matter destroyed surface pumping on water water site

OKTIBBEHA
J10
Flag # 60
9-73

MISSISSIPPI
 BOARD OF WATER COMMISSIONERS
 416 North State Street
 Jackson, Mississippi 39201

CODED

SEP 17 1973

MISS. BD. OF
 WATER COMM.

WATER WELL DRILLERS LOG

19 T.M. Parks Drilling Octibbeha
 firm name county well located

date well completed

firm name

county well located

LANDOWNER: <u>Sturges Miss</u> <u>Town of Sturges</u>	description of formations encountered	from	to
(mailing address)	Blue Shale + Clay	0	583
WELL LOCATION:	Blue w/ shale + clays	583	1290
sec. <u>16</u> T. <u>17</u> N. R. <u>12</u> E. S. W.	Sandy shale	1290	1300
(distance) _____ miles _____ of _____ (direction) _____ (nearest town)	same w/ more sandy shale	1300	1350
WELL PURPOSE: <u>Municipal</u> (home, irrigation, municipal, industrial)	Clays shale w/ rock	1350	1608
WELL COMPLETION DATA:	Firm Blk formation	1608	1700
(1) diameter (inches) <u>8 5/8</u>	Little sand w/ shale, clay	1700	1750
(2) total depth (feet) <u>2200</u>	shale w/ sand & clays	1750	1820
(3) static water level (feet) <u>150</u> below/above top of ground.	Firm formation sandy	1820	1900
(4) casing <u>Steel</u> , <u>2000</u> (material) (depth)	Sandy shale	1900	2008
(size) _____ If telescope see back.	Sand w/ small gravel shale	2008	2100
(5) screen <u>60'</u> , <u>2100'</u> (length) (depth to top)	good gravel w/ shale	2100	2200
(size) <u>4"</u> , <u>Stainless</u> (material)	2201	2201	
(6) pump <u>25</u> , <u>150</u> (HP) (yield gpm)			
(type power) <u>3P</u>			
(7) electric log <u>yes</u> (yes or no)			
(organization running log) <u>N.S.</u>			
(8) how well bottom plugged <u>BPV</u>			
DRILLERS REMARKS:			

①

If well telescopes please sketch and show depths.

GROUND LEVEL

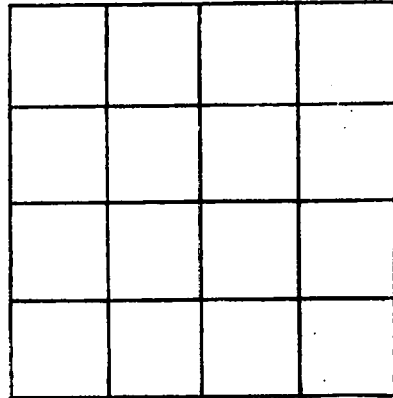

SECTION _____

Please indicate well location X.

ADDITIONAL INFORMATION

If more than one screen, show locations of each on sketch.

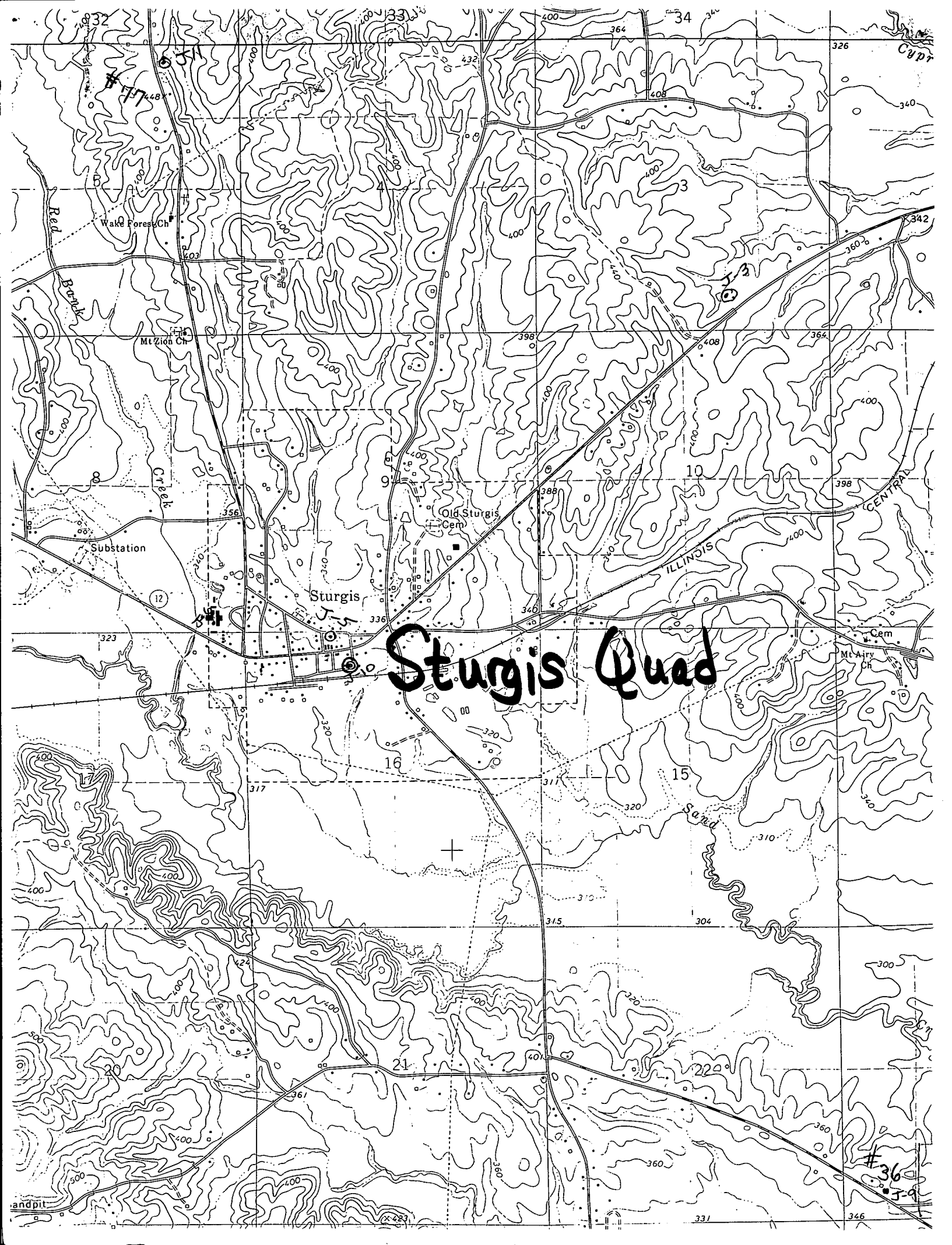

Sturgis Quad

#36
J-9