

9-185
(October 1950)

UNITED STATES
DEPARTMENT OF THE INTERIOR
GEOLOGICAL SURVEY
WATER RESOURCES DIVISION

367
154
213
378
154
224

WELL SCHEDULE

Date Sept. 21, 1955 Field No. _____
Record by E.H. Brownell Office No. JA J3
Source of data Mr. Echols

1. Location: State Miss County Oktibbeha
Map County
SW 1/4 SE 1/4 sec. 3 T 17 N R 12 E
2. Owner: Jim Eskridge Address Rt 4, Starkville
Tenant _____ Address Phone 1093 M2
Driller Herman Echols Address N. of town

3. Topography low hill top
4. Elevation 378 ft. above msl (224) 367 (alt. 5/1/64)
1978 BSW
5. Type: Dug (drilled), driven, bored, cased, _____ 9/1955
6. Depth: Rept. 1384 ft. Meas. _____ ft.
7. Casing: Diam. 4 in., to 2 1/2 in., Type (10' lap)
Depth _____ ft., Finish 60' perf. pipe

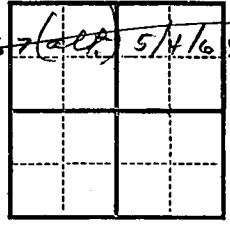

8. Chief Aquifer Eutaw From _____ ft. to _____ ft.
9/20/78 BSW
Others 186 - 4.50 - 179.50

9. Water level 154.9 ft. rept. Sept 21 1955 above top
180 200 below
4" csq which is 1.0 ft. above surface
below

10. Pump: Type Cylinder Capacity 285 G. # Nr.
Power: Kind elec Horsepower 1
11. Yield: Flow _____ G. M., Pump _____ G. M., Meas., Rept. Est.
Drawdown _____ ft. after _____ hours pumping _____ G. M.

12. Use: Dom. Stock, PS., RR., Ind., Irr., Obs.
Adequacy, permanence _____

13. Quality _____ Temp not avail.
Taste, odor, color _____ Sample Yes 20905
Unfit for S.C.

14. Remarks: (Log, Analyses, etc.) 3/8", 60 to each joint

UNITED STATES
DEPARTMENT OF THE INTERIOR
GEOLOGICAL SURVEY
WATER RESOURCES DIVISION

0-650 Soapstone (Black clay)

650-1000 struck tight; stiff clay like zone

1000-1100 Chalk, hard drilling

1100-1321 sand, hard

1321-1384 (not given - shale?)

1384- sand - stopped in sand @ 1384

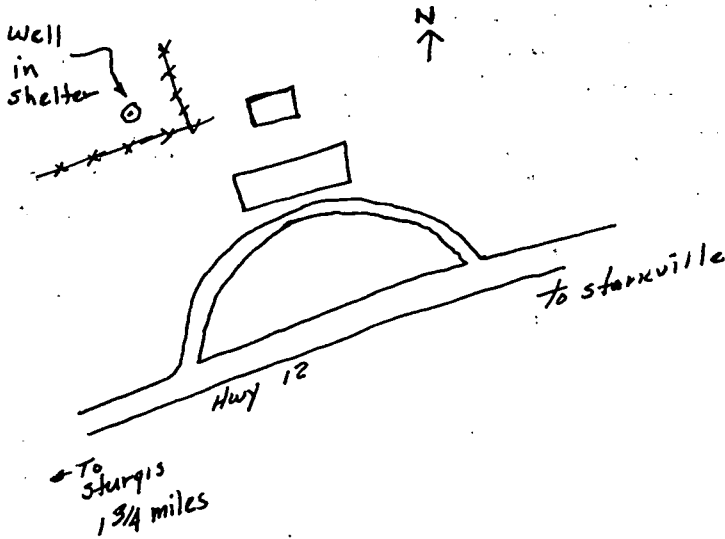

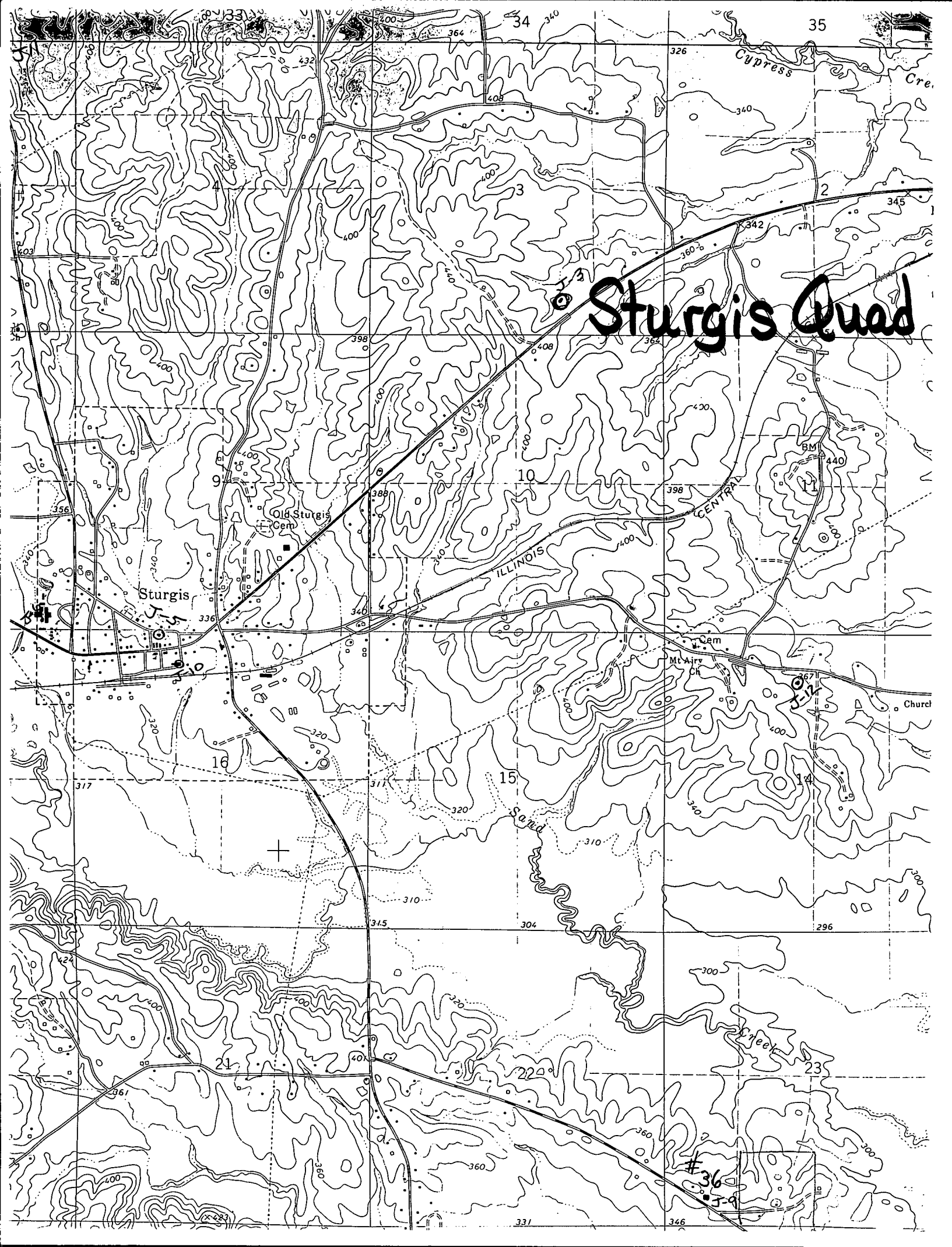

Sturgis Quad

Sturgis

Old Sturgis
Cem

Mt Aire
Cem

Church

#36
J-9