

328
123
205

check old.

9-185
(October 1950)

140
1706
122.94

UNITED STATES
DEPARTMENT OF THE INTERIOR
GEOLOGICAL SURVEY
WATER RESOURCES DIVISION

located

WELL SCHEDULE

Date: SEPT 25, 1950 Field No. 615
Record by: [Signature] Office No. 626
Source of data: Driller

1. Location: State Miss. County Whitehall
Map 18
N/W 1/4 N/W 1/4 sec. 9 T 19 S R 14

2. Owner: CITY STARKVILLE Address Import
Tenant _____ Address _____
Driller ECHEOLS Address Calum

3. Topography 328 5/11/54
4. Elevation 310 ft. above (alt.)
below

5. Type: Dug, drilled, driven, bored, jetted 19.57
6. Depth: Rept. 900 ft. Meas. _____ ft.

7. Casing: Diam. 4 in., to _____ in., Type Iron
Depth 230 ft., Finish PERF. 2" FINISH 88'

8. Chief Aquifer _____ From _____ ft. to _____ ft.
Others 122.94 5/11/54

9. Water level 130 ft. rept. _____ 19 _____ above
below
top of casing which is 27 ft. above
below surface

10. Pump: Type Sub Capacity 15 G. M.
Power: Kind _____ Horsepower 1

11. Yield: Flow _____ G. M., Pump _____ G. M., Meas., Rept. Est.
Drawdown _____ ft. after _____ hours pumping _____ G. M.

12. Use: Dom., Stock, PS., RR., Ind., Irr., Obs. _____
Adequacy permanence _____

13. Quality _____ Temp _____ °F.
Taste, odor, color _____ Sample Yes
No
Unfit for _____

14. Remarks: (Log, Analyses, etc.) _____

UNITED STATES
 DEPARTMENT OF THE INTERIOR
 GEOLOGICAL SURVEY
 WATER RESOURCES DIVISION

(6-100) 1020

Notes from memory (B. J. ...)
 Field No. 1963 DEW

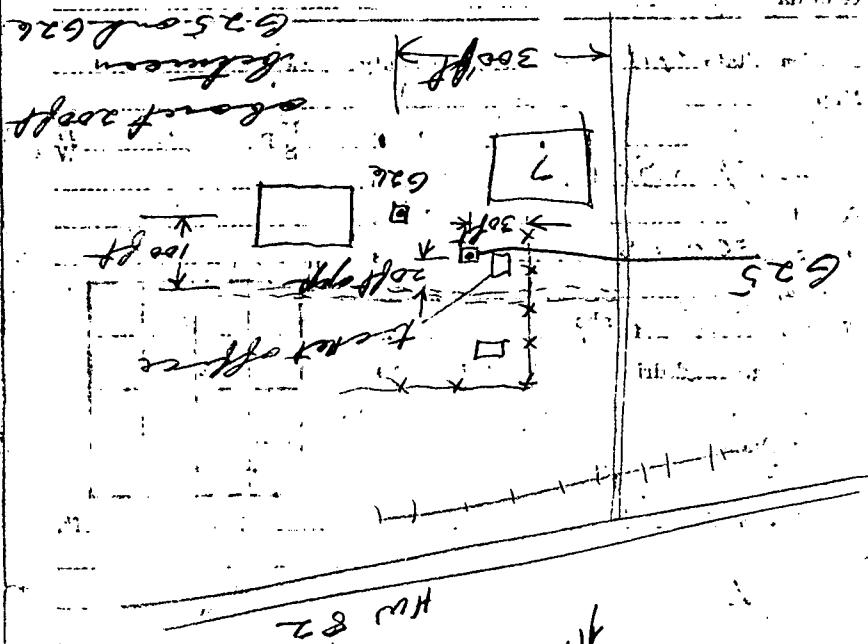

9 30' 4" Top corner
 6 25' 9" Bottom corner
 84.5 ft 135 ft per side
 This should not be an assumption
 before pump was installed.

