

MISCELLANEOUS QW DATA

R=192	T=A	738#1	193# / / *	195# *	196#00010	197# *
			Date of Measurement	Aquifer Sampled	Par. Code	Value
R=192	T=A	738#2	193# / / *	195# *	196#00095	197# *
			Date of Measurement	Aquifer Sampled	Par. Code	Value
R=192	T=A	738#3	193# 03 / 11 / 01 / 11 918181 *	195# 21111601AD1 *	196#00400	197# 81 401 * pH
			Date of Measurement	Aquifer Sampled	Par. Code	Value

MISCELLANEOUS LOGS DATA

R=198	T=A	739#1	199# E *	200# 1401 ↓ *	201# 1402 ↓ *
			Log Type	Req. Depth	End Depth
R=198	T=A	739#1	199# D *	200# 101 ↓ *	201# 14101 ↓ *
			Log Type	Req. Depth	End Depth

444 gpm 53' dd

MISCELLANEOUS NETWORK DATA

R=114	T=A	730#1	706# *	115# 9 *	116# 9 *
			Network Type	Req. Year	End Year
R=121	T=A	730#1	120# *	117# *	118# *
			Analysis	Agency Source	Freq.

MISCELLANEOUS REMARKS DATA

R=183	T=A	311#1	184# / / *	185# *
			Date of Remarks	Remarks

DISCHARGE DATA

R=146	T=A	147#1	148# 03 / 03 / 11 918181 *	703# 7	150# 14414 ↓ *	272# *
			Date of Measurement	Par. Code	Value	Value

GEOHYDROLOGIC DATA

R=90	T=A	721#1	91# 1219 ↓ *	92# 11 9181 ↓ *	93# 2111601AD1 *
			Depth Top	Depth Bot.	Unit Id

HYDRAULIC DATA

R=98	T=A	790#1	100# *	103# *
			Unit Tested	Value

Color = 20 pcunits
444 gpm 53' dd

Ask for Tim Supervisor

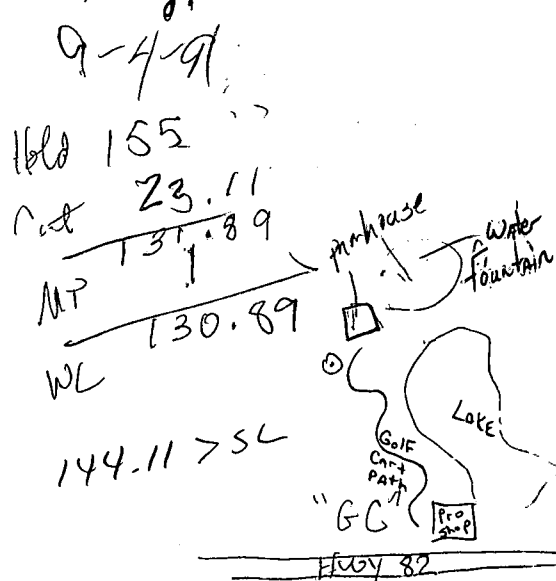

FORMATIONS ENCOUNTERED	FROM	TO	FORMATIONS (Continued)	FROM	TO
Limerock	0	5	Blue Clay	549	637
Blue Clay	5	325	Rock 1'		637
Rock 2"		325	Sand	638	658
Blue Clay	325	460	Rock 4"		658
Blue Clay, Fine Black Sand	460	486	Blue Clay & Sand Strks	658	720
Rock 8"		486	Rock 3"		720
Sand	487	506	Blue Clay & Sand Strks	720	955
Sand & Clay Streaks	506	544	Blue Clay	955	990
Rock 4"		544	Blue Clay & Sand Strks	990	1028
Blue Clay	544	548	Hard Shale Rock	1028	1032
Rock 1'		548	IF MORE SPACE IS NEEDED, USE BACK (over)		

ADDITIONAL INFORMATION

Pink Gumbo	1032 - 1055
Sand, few Sand Strks	1055 - 1111
Pink Gumbo	1111 - 1120
Sand, few Clay Strks	1120 - 1193
Pink Gumbo	1193 - 1410

MISSISSIPPI DEPARTMENT OF NATURAL RESOURCES
Bureau of Land and Water Resources

P.O. Box 10631
Jackson, Mississippi 39209
WATER WELL DRILLERS LOG

COUNTY WELL LOCATED <u>OkTibbeha</u>	
WELL NUMBER <u>Golf Course</u>	CODED <input checked="" type="checkbox"/>
<u>B D60</u>	
DATE WELL COMPLETED <u>03 March 1988</u>	

PERMIT NUMBER
NAME OF DRILLING FIRM <u>Herndon Well & Supply</u>
<u>Shannon, MS</u>

NAME & MAILING ADDRESS OF LANDOWNER <u>Mississippi State University</u> <u>Mississippi State, MS</u>			
WELL LOCATION: SEC	TOWNSHIP	RANGE	
<u>28</u>	<u>19</u>	<u>N</u>	<u>15</u>
DISTANCE DIRECTION NEAREST TOWN <u>3</u> Miles <u>East</u> of <u>Starkville</u>			
OTHER LANDMARK <u>MSU - 18 hole Golf Course</u>			
WELL PURPOSE: Home, Irrigation, Municipal, Industrial, Fish Pond, etc. <u>Irrigation</u>			

PUMP DATA		
PUMP TYPE (Circle One): <u>hp-30</u> Submersible, <u>Turbine</u> , Jet, Flowing Well, Other (Describe)		
POWER TYPE (Circle One): <u>Electric</u> , Tractor, Diesel, Gasoline, Butane, Other (Describe)		
Pump Capacity (GPM)	No. of Stages	Setting Depth
<u>444</u>	<u>4</u>	<u>210</u> FT.
PUMP TEST		
Well yielded <u>444</u> GPM with a drawdown of <u>53</u> ft. after <u>24</u> hours of pumping		

WELL DATA		
Well Depth <u>1190'</u>	Casing Diameter (In.) <u>10"</u>	Casing Length (Ft.) <u>1133'</u>
Type of Casing <u>Steel</u>	Hole Depth <u>1410'</u>	Depth to Static Water Level <u>123'</u>
TYPE OF COMPLETION: (Circle One or More): <u>Gravel Packed</u> , <u>Underreamer</u> , Telescoped, Natural Development, Open Hole, Other (Describe)		
Top of Lap Pipe or Reduction in Casing <u>1075 FEET</u> IF TELESCOPED OR MORE THAN ONE SCREEN: USE BACK PAGE		

LOG DATA	
TYPE OF LOG RUN (Circle One): <u>Electric</u> , No Log Run, Gamma Ray, Density, Sonic, Neutron, Other (Describe)	
Name of Organization Running Log <u>Herndon Well & Supply, Inc.</u>	

SCREEN DATA		
Diameter - Inches <u>6"</u>	Length - Feet <u>51'</u>	Slot Size - Inches <u>.020</u>
Screen Type <u>SS Ribbed</u>		Depth to Bottom - Feet <u>1190'</u>

GEOLOGIC DATA (Office Use Only)			
Surface Elev.	Depth to Top	Thickness	Depth to Top
Subs. SWL	Depth to Top	Thickness	Depth to Top
Driller's Remarks <u>JUN 20 1988</u>			
Department of Natural Resources Bureau of Land & Water Resources			

DESCRIPTION OF FORMATIONS ENCOUNTERED	FROM	TO	FORMATIONS (Continued)	FROM	TO
Limerock	0	5	Blue Clay	549	637
Blue Clay	5	325	Rock 1'		637
Rock 2"		325	Sand	638	658
Blue Clay	325	460	Rock 4"		658
Blue Clay, Fine Black Sand	460	486	Blue Clay & Sand Strks	658	720
Rock 8"		486	Rock 3"		720
Sand	487	506	Blue Clay & Sand Strks	720	955
Sand & Clay Streaks	506	544	Blue Clay	955	990
Rock 4"		544	Blue Clay & Sand Strks	990	1028
Blue Clay	544	548	Hard Shale Rock	1028	1032
Rock 1'		548	IF MORE SPACE IS NEEDED, USE BACK (over)		

If well telescopes please sketch and show depths.

GROUND LEVEL

	X		

SECTION 28

Please indicate well location X.

ADDITIONAL INFORMATION

Pink Gumbo	1032 - 1055
Sand, few Sand Strks	1055 - 1111
Pink Gumbo	1111 - 1120
Sand, few Clay Strks	1120 - 1193
Pink Gumbo	1193 - 1410

If more than one screen, show location of each on sketch.

Artesia Quad

3707000mN

I-55 (VIA U.S. 82) 65 MI.
STARKVILLE (JUNC. U.S. 82 & MISS. 12) 3.7 MI.

32

3704

T 19 N

T 18 N

27' 30"

3703

3702

