

FILE COPY WELL SCHEDULE

Well No. D46

Elog # 57

U. S. DEPT. OF THE INTERIOR

GEOLOGICAL SURVEY

WATER RESOURCES DIVISION

MASTER CARD

Record by JD - Bo Source of data Obs d. l. l. c. Date 7/27/71 Map West Point Quad

State MISS. County 28 (or town) OKTIBBEHA 53

Latitude: 33⁴⁸31⁴⁸48¹¹ N, 08⁸⁴44³⁶ W Longitude: 08⁸⁴44³⁶ Sequential number: 1

Lat-long accuracy: 2 T, 19 S, R, 15 Sec 8, SE NE NE

Local well number: D046AA0819N15E Other number: _____ B & M

Local use: 021057 Owner or name: _____

Owner or name: MHOON FARM WA Address: Osborn

Ownership: County, Fed Gov't, City, Corp or Co, Private, State Agency, Water Dist N

Use of Air cond, Bottling, Comm, Dewater, Power, Fire, Dom, Irr, Med, Ind, P S, Rec, water: _____

Use of (S) (T) (U) (V) (W) (X) (Y) (Z) Stock, Instit, Unused, Repressure, Recharge, Desal-P S, Desal-other, Other P

Use of (A) (D) (G) (H) (I) (J) (K) (L) (M) (N) (O) (P) (Q) (R) (S) (T) (U) (V) (W) (X) (Y) (Z) well: _____ W

DATA AVAILABLE: Well data Freq. W/L meas: Field aquifer char.

Hyd. lab. data: _____

Qual. water data; type: USGS 3/72

Freq. sampling: 0 Pumpage inventory: yes no period: _____

Aperture cards: _____ yes no

Log data: Elog 502' - 1234' DE

WELL-DESCRIPTION CARD

SAME AS ON MASTER CARD Depth well: 1200 ft Meas. 3 rept _____ accuracy _____

Depth cased: 1130 ft Casing type: _____; Diam. 8x4 in 8

Finish: porous gravel w. gravel w. horiz. open perf., screen, sd. pt., shored, open hole, other S

Method (A) (B) (C) (D) (H) (J) (P) (R) (T) (V) (W) (Z) Drilled: air bored, cable, dug, hyd jetted, air reverse trenching, driven, drive wash, other H

Date 7/71 Drilled: 971 Pump intake setting: _____ ft _____

Driller: HERNDON - Homan name _____ address _____

Lift (A) (B) (C) (J) (M) (N) (P) (R) (S) (T) (Z) Deep Shallow (type): air, bucket, cent, jet, multiple, multiple, none, piston, rot, submerg, turb, other S

Power (type): diesel, elec, gas, gasoline, hand, gas, wind; H.P. 15 Trans. or meter no. U

Descrip. MP brother pits on top of casing 2.7 ft above below LSD, Alt. MP _____

Alt. LSD: 300 Accuracy: topo 20' 4

Water Level: 126.7 ft above below MP; Ft below LSD 12 Accuracy: _____ A

Date meas: 372 Yield: _____ gpm _____ Method determined _____

Drawdown: _____ ft _____ Accuracy: _____ Pumping period _____ hrs _____

QUALITY OF WATER DATA: Iron _____ Sulfate _____ Chloride _____ Hard. _____

Sp. Conduct 190 K x 10⁶ 2 Temp. 27.5 °F Date sampled 372

Taste, color, etc. PH = 7.7

PUNCHED and VERIFIED
ROLLA COMPUTATION BRANCH

Well No. D46

171
165.00
1.15
163.85
2.7
161.15
contact: owner
Charlie Jenkins
323-4710

178
138.59
130/82
160
9.13
150.87
2.7
148.17
312
148
142

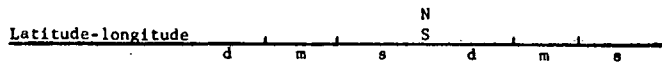

HYDROGEOLOGIC CARD

SAME AS ON MASTER CARD
 Physiographic Province: _____ Section: **03**
 Drainage Basin: **D** Subbasin: **13E**

Topo of well site: (D) depression, stream channel, dunes, flat, hilltop, sink, swamp, (E) (F) (H) (K) (L) (M) (N) (O) (P) (S) (T) (U) (V) offshore, pediment, hillside, terrace, undulating, valley flat

MAJOR AQUIFER: system _____ series **K3** aquifer, formation, group **GΦ**

Lithology: _____ Origin: **2** Aquifer Thickness: **80** ft

Length of well open to: **88** ft Depth to top of: **1112** ft

MINOR AQUIFER: system _____ series _____ aquifer, formation, group _____

Lithology: _____ Origin: _____ Aquifer Thickness: _____ ft

Length of well open to: _____ ft Depth to top of: _____ ft

Intervals Screened: **50' of 4" 15 slot**

Depth to consolidated rock: _____ ft Source of data: _____

Depth to basement: _____ ft Source of data: _____

Surficial material: _____ Infiltration characteristics: _____

Coefficient Trans: _____ gpd/ft Coefficient Storage: _____

Coefficient Perm: _____ gpd/ft²; Spec cap: _____ gpm/ft; Number of geologic cards: _____

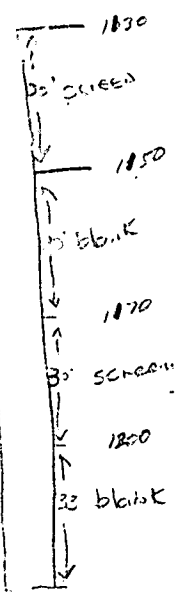

Can run pumping test using surficial method of measuring Q.

5,500 gal. pressure storage tank.

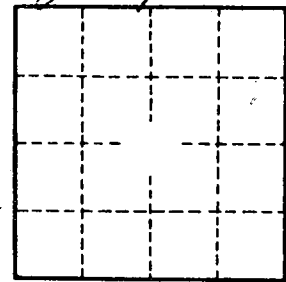
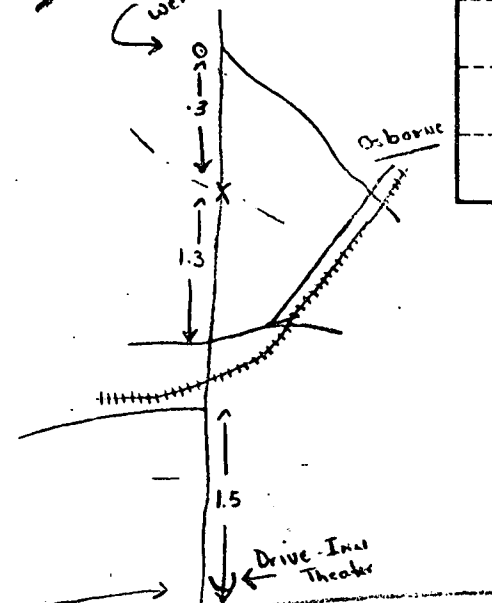

Well No. _____

STARKVILLE

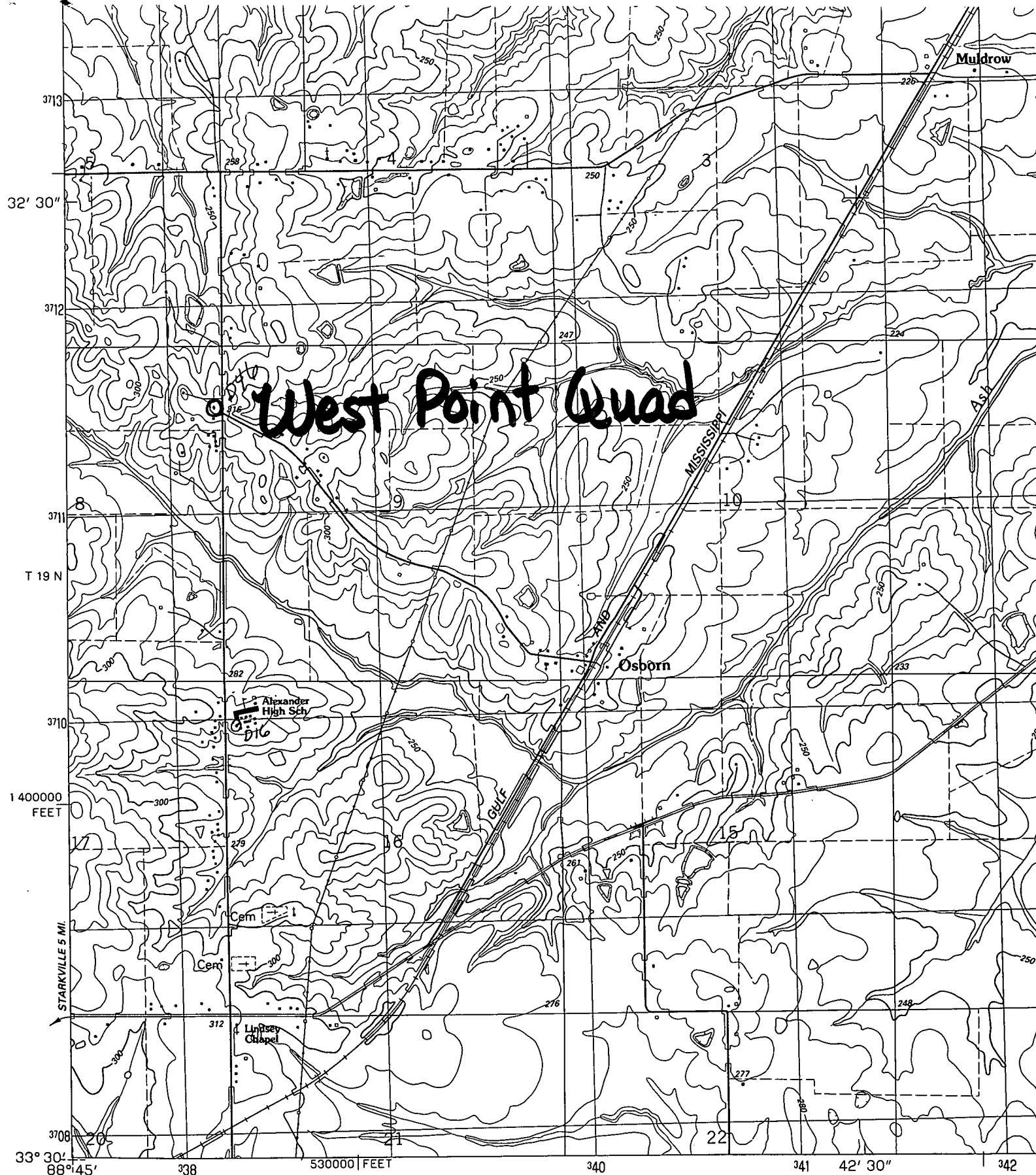

32' 30"

3712

3711

T 19 N

3710

1400000 FEET

STARKVILLE 5 MI.

3708

33° 30' 45"

338

530000 FEET

340

341

42' 30"

342

Produced by the United States Geological Survey
 Control by USGS and NOS/NOAA
 Topography by photogrammetric methods from aerial photographs taken 1955. Revised from aerial photographs taken 1984
 Field checked 1986. Map edited 1987
 Projection and 10,000-foot grid ticks: Mississippi coordinate system, east zone (transverse Mercator)
 1000-meter Universal Transverse Mercator grid, zone 16
 1927 North American Datum
 To place on the predicted North American Datum 1983

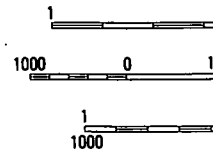
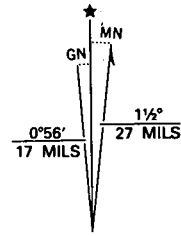

UTM GRID AND 1987 MAGNETIC NORTH

(VILLE)
J W NE

C