

9-185
(October 1950)

UNITED STATES
DEPARTMENT OF THE INTERIOR
GEOLOGICAL SURVEY
WATER RESOURCES DIVISION

282
84
198

LOG # 17

WELL SCHEDULE

Date 4/16, 1959 Field No. D16
Record by B. J. Wagoner Office No. D42
Source of data Driller

1. Location: State Texas County Artikaha
Map NW 1/4 NW 1/4 sec. 16 T. 19 N. R. 15 E. W.

2. Owner: ROCKY HILL SCHOOL Address S. THURKVILLE
Tenant ALEXANDER JR. Address
Driller ROBERT RATLIFF Address GRENADA

3. Topography Low hill

4. Elevation 270 ft. above topo below M

5. Type: Dug, drilled, driven, bored, jetted 4/16/59

6. Depth: Rept. 880 ft. Meas. 880 ft.

7. Casing: Diam. 4 in., to 30 in., Type SLIP
Depth 1066 ft., Finish 1066

8. Chief Aquifer EUTAW to 880 From 1066 ft. to 1066 ft.
Others R9

9. Water level 89 ft. rept. 10.59 above below
which is 10.59 ft. above below surface

10. Pump: Type _____ Capacity _____ G. M.
Power: Kind ELE Horsepower _____

11. Yield: Flow _____ G. M., Pump 96 G. M., Meas. Rept. Est. _____
Drawdown _____ ft. after _____ hours pumping _____ G. M.

12. Use: Dom., Stock, PS, RR., Ind., Irr., Obs. _____
Adequacy, permanence _____

13. Quality _____ Temp 72 °F.
Taste, odor, color _____ Sample Yes No

14. Remarks: (Log, Analyses, etc.) ELE LOG TO 880' 4/16/59
SAMPLES

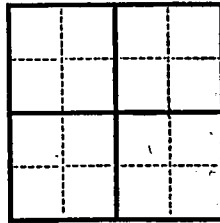

UNITED STATES
 DEPARTMENT OF THE INTERIOR
 GEOLOGICAL SURVEY
 WATER RESOURCES DIVISION

October 1950

WELL SCHEDULE

Date: _____
 Record No. _____
 Office No. _____
 Field No. _____
 This info furnished by Mr. KATLER
 by telephone 11-15-62
 Yield 96 gpm
 Screen setting 30' 1066-1096
 Water level 89' below Lsd

| | |
|---------|--------------------|
| 852-875 | sandy shale |
| 804-852 | clay - sandy shale |
| 732-804 | sandy shale |
| 709-732 | shale |
| 685-709 | " " |
| 675-685 | sandy shale |
| 647-675 | sandy shale |
| 570-649 | sandy shale |
| 559-570 | clay |
| 559-550 | rock |
| 0-559 | clay |

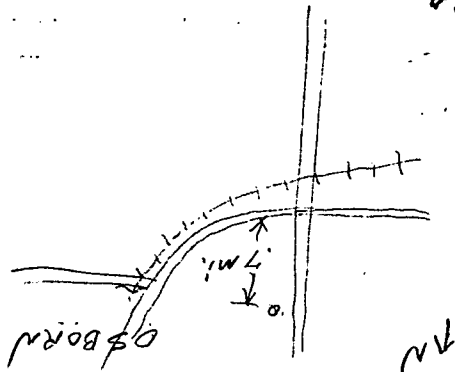

10/14/1951
8/182

Robert Kelly

4" Ophelia Rock Hole School
Screen 936 bottom 20' 55
"018

Bottom of Screen 1140
20' of Screen "012

Pleasant Grove School

Above info must
be in error, see
back of schedule.

BE

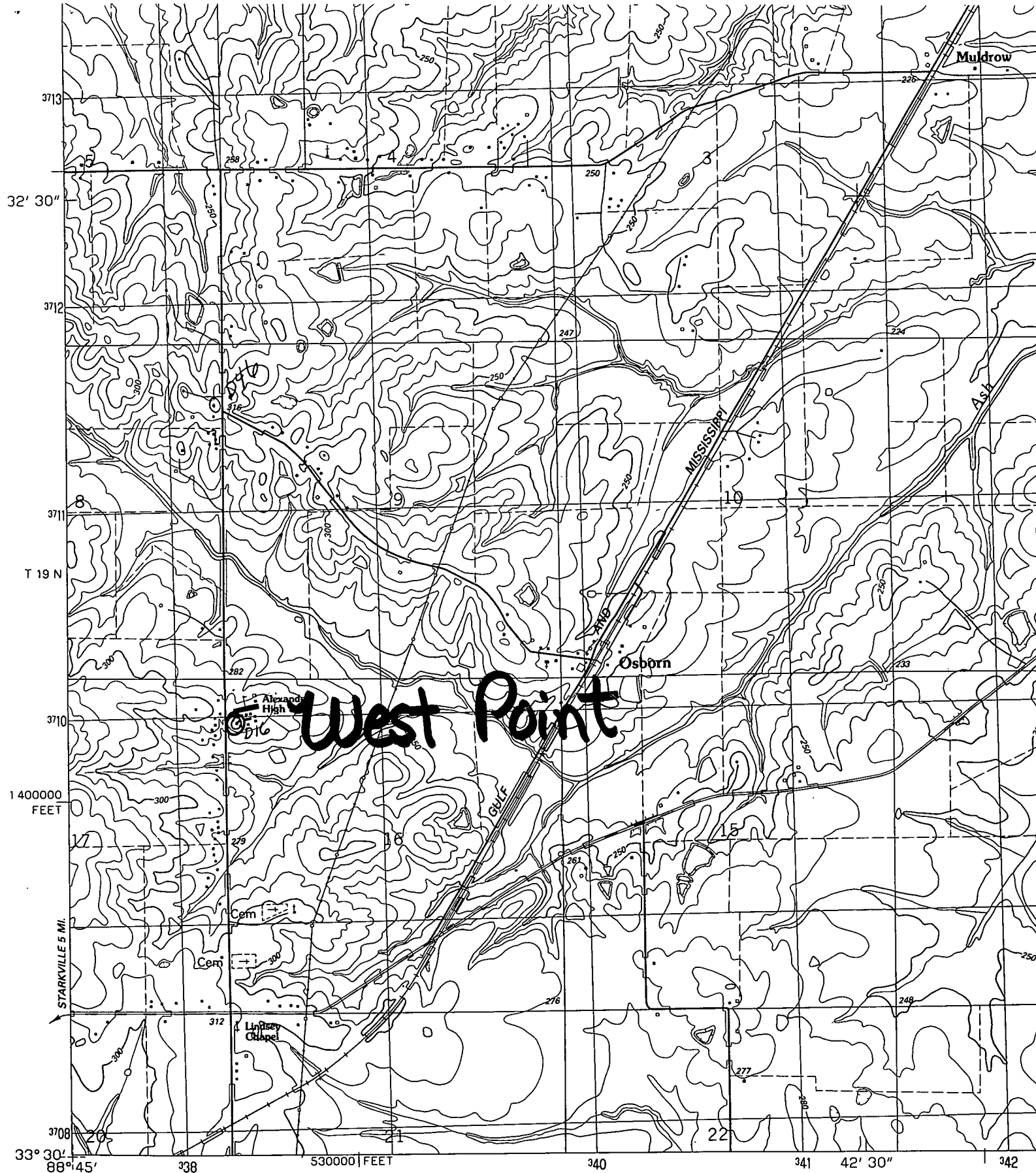

(VILLE)
J/W NE

Produced by the United States Geological Survey

Control by USGS and NOS/NOAA

Topography by photogrammetric methods from aerial photographs taken 1955. Revised from aerial photographs taken 1984

Field checked 1986. Map edited 1987

Projection and 10,000-foot grid ticks: Mississippi coordinate system, east zone (transverse Mercator)

1000-meter Universal Transverse Mercator grid, zone 16

1927 North American Datum

To place on the predicted North American Datum 1983

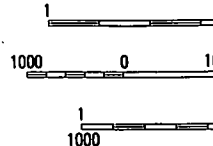
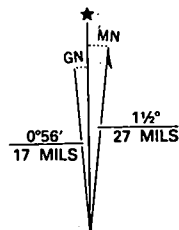

UTM GRID AND 1987 MAGNETIC NORTH