

9-185- July 1935 Revised

Have plat sheet but no log.

FOSTER #10

UNITED STATES DEPARTMENT OF THE INTERIOR GEOLOGICAL SURVEY WATER RESOURCES BRANCH

also 1320' well

WELL SCHEDULE

Date May 15, 1940 Field No. 517 Record by J. M. Carter Office No. 611 Source of data C-17

1. Location: State Mississippi County Oktobee Map Oktobee County SE 1/4 NE 1/4 sec. 34 T 15 N R 14 E

2. Owner: The Borden Co. Address Starbuck, Miss. Tenant Address Driller Layne Central Address Memphis, Tenn.

3. Topography Hill side 4. Elevation 367.49 ft. above m.s. 5. Type: Dug, drilled, driven, bored, jetted 1926 6. Depth: Rept. 1450 ft. Meas. 7. Casing: Diam. 13 20 in.; to 10 in., Type Steel Depth 1450 ft., Finish 84 Screen

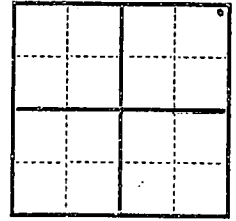

8. Chief Aquifer Tuscaloosa From ft. to ft. Others

9. Water level 158.24 ft. meas. 5/15 1940 above floor below surface of pump house which is at ft. surface

10. Pump: Type Layne Vert. Cent. Capacity 8" G. M. 522 Power: Kind Electric Horsepower

11. Yield: Flow — G. M., Pump 500 G. M., Meas. (Rept) Est. Drawdown ft. after 1000 hours pumping G. M.

12. Use: Dom., Stock, PS., RR., Irr., Obs. Major use for cooling Adequacy, permanence 13. Quality Good Temp °F.

Taste, odor, color must be tasted before using in 30129 Sample Yes Unfit for Given Elgin decentralizing system (Elgin I Treatment)

14. Remarks: (Log, Analyses, etc.) Runs 1-6 hrs daily Average 4 hrs day Use about average of SAMPLES See test concentration in winter.

1348 plat sheet

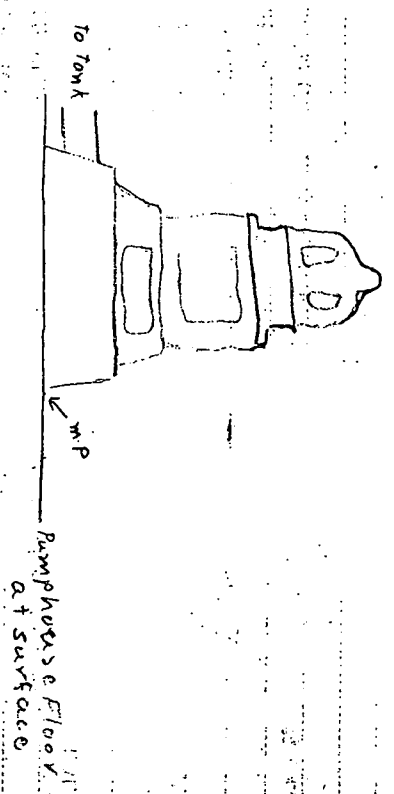

Well Montgomery
 (32)

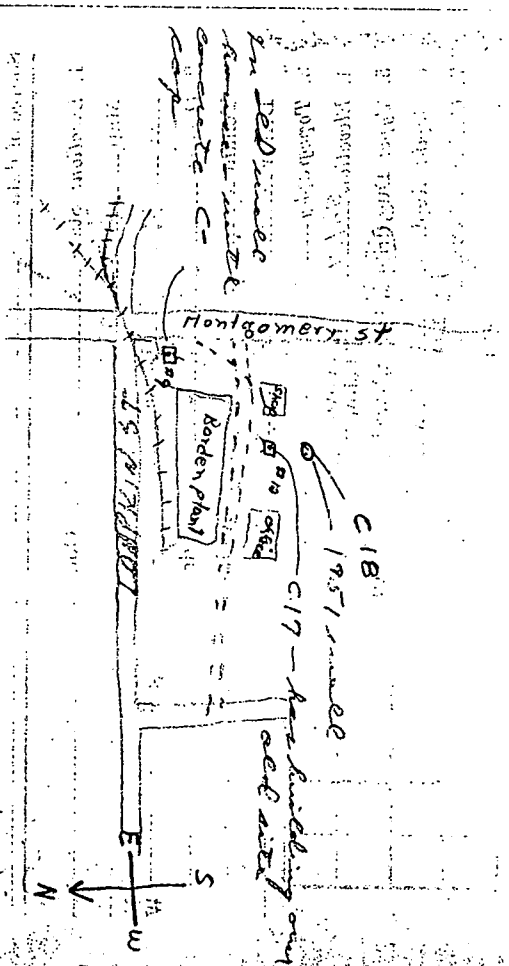

in 1951 tunnel
 Korden plan
 copy