

6563711
Tom Cox
Phila.
2 copies
11/2
50 x 89
P/11

WRD Exp. (GW)
April 1966

Recoded
11/24/76
JAC.

Well No.

H19

WELL SCHEDULE

E/og# 25

U. S. DEPT. OF THE INTERIOR

GEOLOGICAL SURVEY

WATER RESOURCES DIVISION

MASTER CARD

Record by RE. Grantham Source of data Drq + E Log Date 10-29-68 Map _____

State Mississippi County 28 (or town) Neshoba 5:0

Latitude: 32 47 45 N Longitude: 088 59 35 Sequential number: 1

Lat-long accuracy: 2 T. 11 S, R. 13 W, Sec. 17, NE NE SW

Local well number: H019AC1711N13E Other number: _____ B & M

Local use: 145025 371 27 Owner or name: EastSide Wtr. Assoc.

Owner or name: CENTRAL WATER Address: _____

Ownership: County, Fed Gov't, City, Corp or Co, Private, State Agency, Water Dist N

Use of water: (A) Air cond, Bottling, Comm, Dewater, Power, Fire, Dom, Irr, Med, Ind, P S, Rec, (S) Stock, Instit, Unused, Repressure, Recharge, Desal-P S, Desal-other, Other P

Use of well: (A) Anode, Drain, Seismic, Heat Res, Obs, Oil-gas, Recharge, Test, Unused, Withdraw, Waste, Destroyed W

DATA AVAILABLE: Well data Freq. W/L meas.: Field aquifer char. Z

Hyd. lab. data: _____

Qual. water data; type: Conductance

Freq. sampling: _____ Pumpage inventory: yes, no, period: _____

Aperture cards: _____ yes

Log data: 10-692 DE

WL data
00/00/70
WL = 248.
121188
WL = 251.52

WELL-DESCRIPTION CARD

SAME AS ON MASTER CARD Depth well: 677 ft Meas. 3

Depth cased: (first perf.) 617 ft Casing type: _____; Diam. 10x6 in 1.0

Finish: porous concrete, gravel w. (perf.), gravel w. (screen), horiz. gallery, end, open perf., screen, sd. pt., shored, open hole, other G

Method Drilled: (A) air rot, (B) bored, cable, dug, rot., (C) jetted, (D) percussion, (E) air, (F) reverse, (G) trenching, (H) driven, (I) wash, (J) other H

Date Drilled: 969 Pump intake setting: _____ ft 320

Driller: Coman Drlg Co Sebastopol

Lift (type): (A) air, (B) bucket, (C) cent, (D) jet, (E) multiple, (F) multiple, (G) none, (H) piston, (I) rot, (J) submerg, (K) turb, (L) other T Deep Shallow

Power (type): diesel, elec, gas, gasoline, hand, gas, wind; H.P. 40 Trans. or meter no. _____

Descrip. MP _____ above ft below LSD. Alt. MP _____

Alt. LSD: 615 615 Accuracy: (source) Topo 4

Water Level: _____ above below MP; _____ above below LSD. 248 Accuracy: _____ D

Date meas.: _____ Yield: _____ gpm 377 Method determined 4

Drawdown: _____ ft 5 Accuracy: _____ 6 Pumping period _____ hr 1

QUALITY OF WATER DATA: Iron _____ ppm Sulfate _____ ppm Chloride _____ ppm Hard. _____

Sp. Conduct 95 K x 10⁶ 1 Temp. 78 °F 26 Date sampled 869

Taste, color, etc. _____

WELL NO. H19

Well No. H19

Latitude-longitude N
S
d m s d m s

HYDROGEOLOGIC CARD

SAME AS ON MASTER CARD Physiographic Province: 03 Section: _____

D Drainage Basin: 137 Subbasin: _____

Topo of well site: (D) depression, stream channel, dunes, flat, hilltop, sink, swamp, (P) offshore, pediment, hillside, terrace, undulating, valley flat

MAJOR AQUIFER: TE aquifer, formation, group LW

Lithology: US Origin: 2 Aquifer Thickness: 74± ft

Length of well open to: .025 ft Depth to top of: 60.3 ft

MINOR AQUIFER: _____ aquifer, formation, group _____

Lithology: _____ Origin: _____ Aquifer Thickness: _____ ft

Length of well open to: _____ ft Depth to top of: _____ ft

Intervals Screened: 60' x 6" ss .025

Depth to consolidated rock: _____ ft Source of data: _____

Depth to basement: _____ ft Source of data: _____

Surficial material: _____ Infiltration characteristics: _____

Coefficient Trans: 217 gpd/ft Coefficient Storage: _____

Coefficient Perm: _____ gpd/ft²; Spec cap: .27 gpm/ft; Number of geologic cards: _____

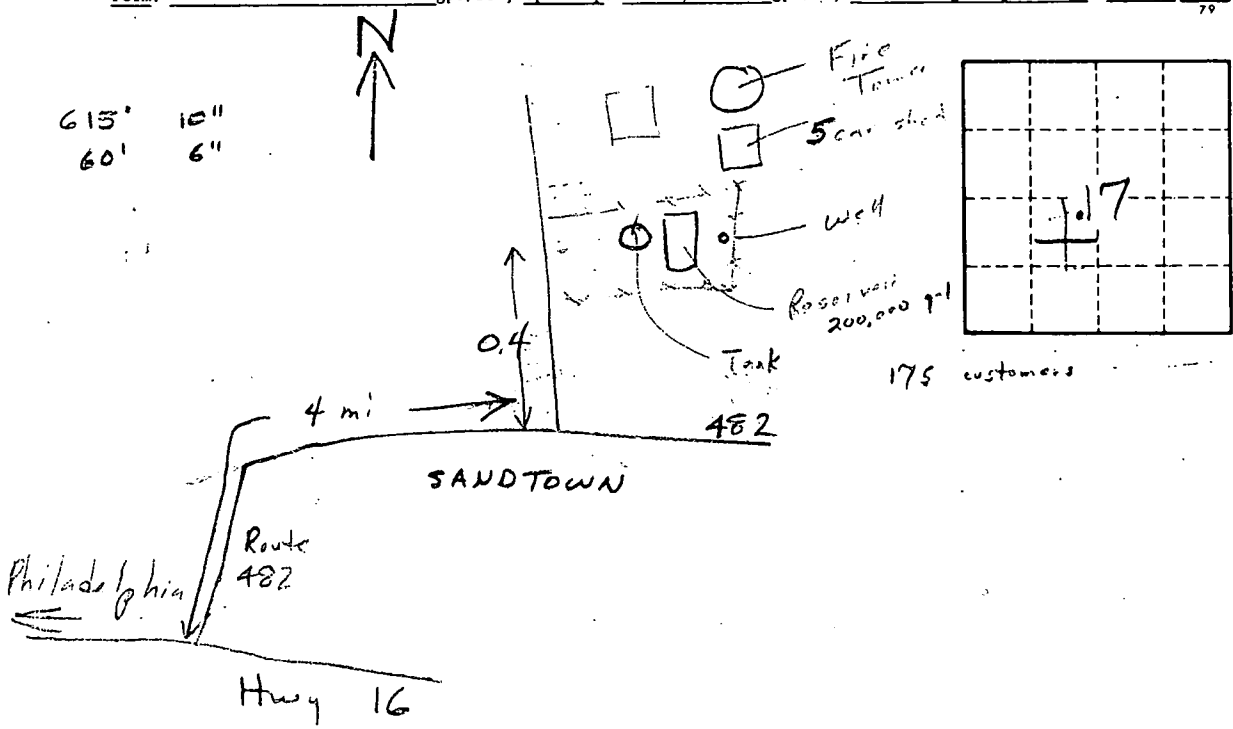

Well No. H19

