

WRD Exp. (GW)
April 1966

Well No. E1

WELL SCHEDULE E1 log # 26

U. S. DEPT. OF THE INTERIOR GEOLOGICAL SURVEY WATER RESOURCES DIVISION

MASTER CARD

Record by C. Jessup Source of data MSGS Date 9-1-67 Map County
 State Miss. County 28 (or town) Montgomery Sequential number: 49
 Latitude: 33^{deg} 33^{7 min} 27^N Longitude: 08^{12 degrees} 9^{15 min} 35²¹^W Sequential number: 1
 Lat-long accuracy: 2²⁰ T. 20^N S. 7^E Sec. 32 NW 1 SE 1
 Local well number: F0018D3220NOTE Other number: B & M
 Local use: 093026 Owner or name: C. R. Stoker
 Owner or name: C R STOKER Address: _____
 Ownership: County, Fed Gov't, City, Corp or Co, Private, State Agency, Water Dist P
 Use of water: (A) Air cond, (B) Bottling, (C) Comm, (D) Dewater, (E) Fire, (F) Dom, (G) Irr, (H) Med, (I) P S, (J) Rec, (K) Stock, (L) Instit, (M) Unused, (N) Reppure, (O) Recharge, (P) Desal-P S, (Q) Desal-other, (R) Other H
 Use of well: (A) Anode, (B) Drain, (C) Seismic, (D) Heat Res, (E) Obs, (F) Oil-gas, (G) Recharge, (H) Test, (I) Unused, (J) Withdraw, (K) Waste, (L) Destroyed. W
 DATA AVAILABLE: Well data Freq. W/L meas.: Field aquifer char.
 Hyd. lab. data: _____
 Qual. water data; type: _____
 Freq. sampling: _____ Pumpage inventory: yes no, period: _____
 Aperture cards: _____ yes
 Log data: E log 190-642 # DE

WELL-DESCRIPTION CARD

SAME AS ON MASTER CARD Depth well: 674 ft Meas. rept 3 accuracy
 Depth cased: 654 ft Casing type: _____; Diam. 4x2 in 4
 Finish: (C) porous concrete, (F) gravel w. (perf.), (G) gravel w. (screen), (H) horiz. gallery, (I) open end, (J) percuss., (K) screen, (L) sd. pt., (M) Shored, (N) open hole, (O) other S
 Method Drilled: (A) air rot., (B) bored, (C) cable, (D) dug, (E) hyd jetted, (F) air rot., (G) reverse percuss., (H) rotary, (I) trenching, (J) driven, (K) wash, (L) other H
 Date Drilled: 8-9-67 9-6-7 Pump intake setting: _____ ft 36 38
 Driller: Braswell Drilling Co.
 Lift (type): (A) air, (B) bucket, (C) cent, (D) jet, (E) multiple, (F) multiple, (G) none, (H) piston, (I) rot, (J) submerg, (K) curb, (L) other S Deep Shallow
 Power (type): (A) diesel, (B) elec, (C) gas, (D) gasoline, (E) hand, (F) gas, (G) wind; H₂P. 1 S Trans. or meter no. _____
 Descrip. MP _____ ft above _____ below LSD, Alt. MP _____
 Alt. LSD: 400' 400 Accuracy: Topo. 4
 Water Level: 80 ft above _____ below MP; 80 ft above _____ below LSD Accuracy: _____ 52 D
 Date meas: 8-6-7 Yield: _____ gpm _____ Method determined _____ 61
 Drawdown: _____ ft _____ Accuracy: _____ Pumping period _____ hrs _____ 68
 QUALITY OF WATER DATA: Iron _____ ppm _____ Sulfate _____ ppm _____ Chloride _____ ppm _____ Hard. _____ 72
 Sp. Conduct _____ K x 10⁶ _____ Temp. _____ °F _____ Date sampled _____ 77 79
 Taste, color, etc. treated for hardness

PUNCHED and VERIFIED
FOLIO COMPUTATION ERROR

Well No.

Well No. E1

Latitude-longitude N
S
d m s d m s

HYDROGEOLOGIC CARD

SAME AS ON MASTER CARD Physiographic Province: _____ 03 Section: _____

D Drainage Basin: _____ 15K Subbasin: _____

Topo of well site: (D) depression, stream channel, dunes, flat, hilltop, sink, swamp, (E) offshore, pediment, hillside, terrace, undulating, valley flat

MAJOR AQUIFER: _____ system _____ series TE _____ aquifer, formation, group TW

Lithology: _____ **Origin:** 2 **Aquifer Thickness:** 84 ft

Length of well open to: _____ ft 20 **Depth to top of:** _____ ft 590

MINOR AQUIFER: _____ system _____ series _____ aquifer, formation, group _____

Lithology: _____ **Origin:** _____ **Aquifer Thickness:** _____ ft

Length of well open to: _____ ft _____ **Depth to top of:** _____ ft _____

Intervals Screened: 2'

Depth to consolidated rock: _____ ft _____ **Source of data:** _____

Depth to basement: _____ ft _____ **Source of data:** _____

Surficial material: _____ **Infiltration characteristics:** _____

Coefficient Trans: _____ gpd/ft _____ **Coefficient Storage:** _____

Coefficient Perm: _____ gpd/ft²; **Spec cap:** _____ gpm/ft; **Number of geologic cards:** _____

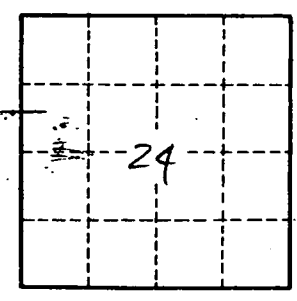
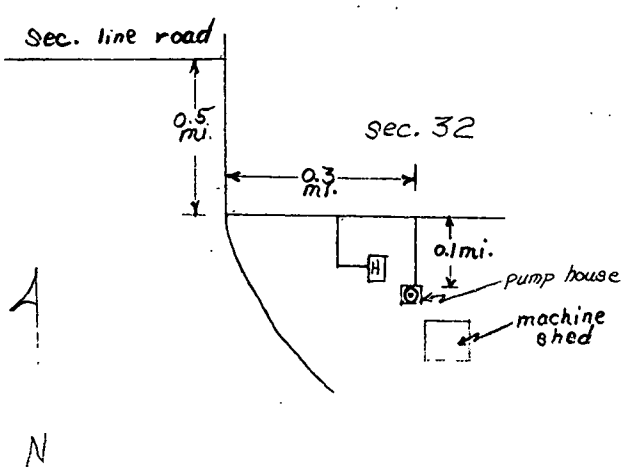

Well No.

E1