

WELL SCHEDULE

U. S. DEPT. OF THE INTERIOR

GEOLOGICAL SURVEY

WATER RESOURCES DIVISION

MASTER CARD

Record by BEW Source of data Ezell Wtr Syst Date 11/60 Map _____

State 28 County (or town) MONTGOMERY 49

Latitude: 33⁴⁸ 38⁷ 06⁹ N Longitude: 08¹² 94¹³ 25¹⁸ Sequential number: 2

Lat-long accuracy: 30 T. 21 S. R. 6 W. Sec 31 SW SW

Local well number: A017CC3121N06E Other number: _____ B & M

Local use: 002 22 Owner or name: Town of Duck Hill

Owner or name: DUCK HILL Address: _____

Ownership: (C) County, Fed Gov't, City, Corp or Co, Private, State Agency, Water Dist M

Use of water: (A) Air cond, Bottling, Comm, Dewater, Power, Fire, Dom, Irr, Med, Ind, P S, Rec, (S) Stock, (T) Instit, (U) Unused, (V) Repressure, (W) Recharge, (X) Desal-P S, (Y) Desal-other, (Z) Other U

Use of well: (A) Anode, (D) Drain, (G) Seismic, (H) Heat Res, (I) Obs, (J) Oil-gas, (K) Recharge, (L) Test, (M) Unused, (N) Withdraw, (O) Waste, (P) Destroyed U

DATA AVAILABLE: Well data Freq. W/L meas.: Field aquifer char.

Hyd. lab. data: _____

Qual. water data; type: USGS 2/72

Freq. sampling: Pumpage inventory: no; period: _____

Aperture cards: _____ yes

Log data: _____

PUNCHED and VERIFIED
ROLLA COMPUTATION BRANCH

WELL-DESCRIPTION CARD

SAME AS ON MASTER CARD Depth well: 650 ft Meas. rept 3

Depth cased: (first perf.) 610 ft Casing type: _____; Diam. 6x4 in 6

Finish: (C) concrete, (F) porous gravel w. (perf.), (G) gravel w. (screen), (H) horiz. gallery, (I) open end, (J) perf., (K) screen, (L) sd. pt., (M) shored, (N) open hole, (O) other 5

Method: (A) air bored, (B) cable, (C) dug, (D) hyd jetted, (E) rot., (F) percussion, (G) rotary, (H) air reverse, (I) trenching, (J) drive, (K) wash, (L) other H

Date Drilled: 957 Pump intake setting: 40 ft

Driller: Robert Rathoff

Lift (type): (A) air, (B) bucket, (C) cent, (D) jet, (E) multiple, (F) multiple, (G) none, (H) piston, (I) rot, (J) submerg, (K) turb, (L) other T Deep Shallow

Power (type): (A) diesel, (B) elec, (C) gas, (D) gasoline, (E) hand, (F) gas, (G) wind; H.P. 3 Trans. or meter no. T

Descrip. MP Hole in N. side of pump base 1.94 above LSD, Alt. MP _____

Alt. LSD: 250 Accuracy: (source) T

Water Level 23.7 ft above 22 MP; below 22 LSD Accuracy: _____

Date meas: 1/21/72 Yield: 72 gpm Method determined 4

Drawdown: 37 ft Accuracy: 0 Pumping period: _____ hrs 2

QUALITY OF WATER DATA: Iron _____ ppm Sulfate _____ ppm Chloride _____ ppm Hard. _____ ppm

Sp. Conduct 640 K x 10⁶ 4 Temp. °F 220 Date sampled 272

Taste, color, etc. pH = 8.5

Well No.

A17

DROGEOLOGIC CARD

NAME AS ON MASTER CARD: Physiographic Province: 03 Section: _____

Drainage Basin: D 156 Subbasin: _____

Site: (D) depression, stream channel, dunes, flat, hilltop, sink, swamp, (E) (F) (H) (K) (L) (M) (N) (P) (S) (T) (U) (V) _____

OR
 IFR: _____ system _____ series TE Ackerman aquifer, formation, group LW

Hology: _____ Origin: S 2 Aquifer Thickness: _____ ft

Length of well open to: _____ ft 40 Depth to top of: _____ ft

OR
 IFR: _____ system _____ series _____ aquifer, formation, group _____

Hology: _____ Origin: _____ Aquifer Thickness: _____ ft

Length of well open to: _____ ft _____ Depth to top of: _____ ft

Intervals covered: 610-650 ft 40' x 4"

Depth to consolidated rock: _____ ft _____ Source of data: _____

Depth to cement: _____ ft _____ Source of data: _____

Material: _____ Infiltration characteristics: _____

Efficient storage: 2,500 gpd/ft 2.52 Coefficient Storage: _____

Efficient storage: _____ gpd/ft²; Spec cap: 2.2 gpm/ft; Number of geologic cards: _____

Water Level
7 20 ft. below 1st

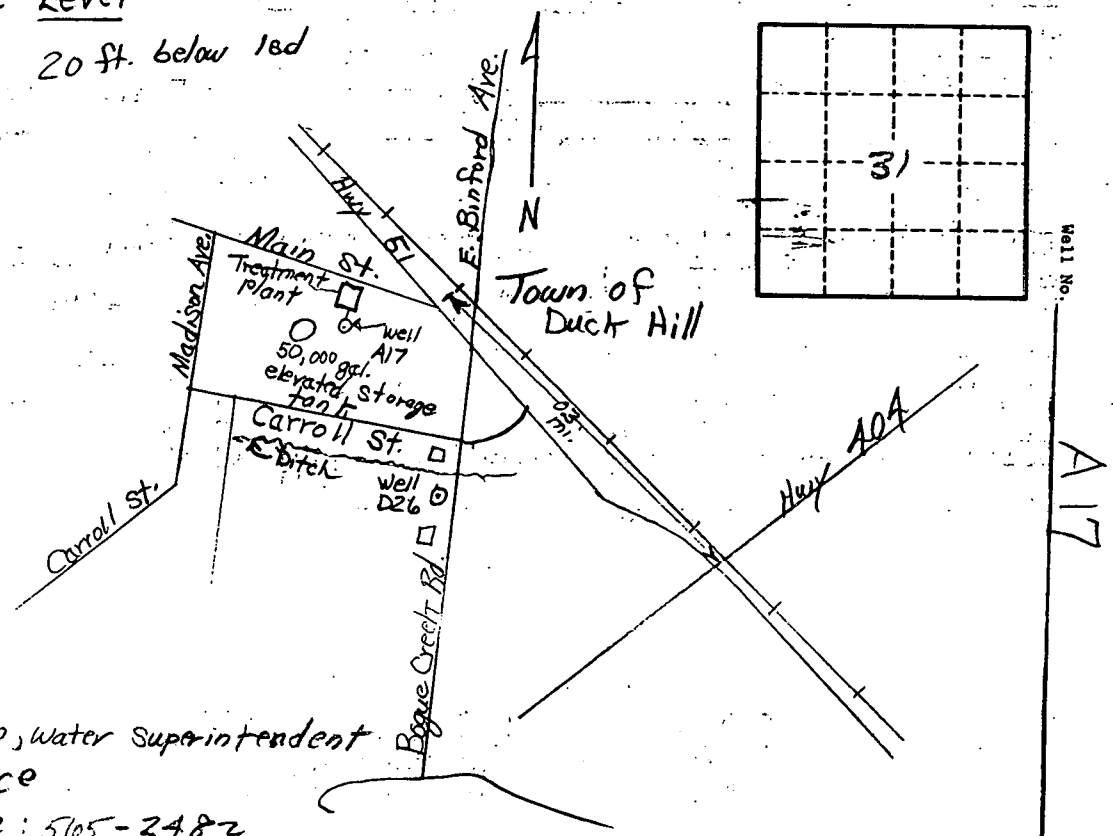

Person, Water Superintendent
 Office
 Phone: 565-2482