

9-185  
(October 1950)

UNITED STATES  
DEPARTMENT OF THE INTERIOR  
GEOLOGICAL SURVEY  
WATER RESOURCES DIVISION

E-105 #7

Mr. George Adams

WELL SCHEDULE

Date 8/28, 1957 Field No. \_\_\_\_\_  
Record by B. E. WILSON Office No. Q-28  
Source of data DRILLER'S OBSERVATION

1. Location: State MISS. County Monroe

Map \_\_\_\_\_  
NW 1/4 SW 1/4 sec. 29 T 15 N R 18 E W

2. Owner: AMERICAN POTASH CHEMICAL CO Address Hamilton, Miss.  
Tenant: Chemical Co. Address \_\_\_\_\_  
Driller: LAYNE CENTRAL DRILLING Address MEMPHIS

3. Topography VALLEY

4. Elevation \_\_\_\_\_ ft. above \_\_\_\_\_ ft. below

5. Type: Dug, drilled, driven, bored, jetted Aug. 1957

6. Depth: Rept. 607 ft. Meas. 423 ft.

7. Casing: Diam. 1 1/2 in., to \_\_\_\_\_ in., Type \_\_\_\_\_

Depth \_\_\_\_\_ ft., Finish 10" SHUTTER #8

8. Chief Aquifer TUSCALOOSA From 376 ft. to 423 ft.

Others \_\_\_\_\_

9. Water level \_\_\_\_\_ ft. reft. \_\_\_\_\_ 19 \_\_\_\_\_ above \_\_\_\_\_ below  
meas. \_\_\_\_\_ which is \_\_\_\_\_ ft. above surface  
below surface

10. Pump: Type Turbine Capacity 1,000 G. M.

Power: Kind Electric Horsepower \_\_\_\_\_

11. Yield: Flow \_\_\_\_\_ G. M., Pump 1120 G. M. Meas. 1963 Rept. Est. \_\_\_\_\_

Drawdown \_\_\_\_\_ ft. after \_\_\_\_\_ hours pumping \_\_\_\_\_ G. M.

12. Use: Dom., Stock, PS., RR., Ind Irr., Obs. \_\_\_\_\_  
Adequacy, permanence \_\_\_\_\_

13. Quality \_\_\_\_\_ Temp. 64 °F. 10/13/63

Taste, odor, color \_\_\_\_\_ Sample Yes \_\_\_\_\_ No 5/12/64

Unfit for Electric log of test hole

14. Remarks: (Log, Analyses, etc.) Test hole drilled to full feet. Log on back of sheet. Natural flow, about 600 gpm. Shovel wall construction. 2 AMPES

(over)

DEPARTMENT OF THE INTERIOR

Geological Survey

WELL LOG  
 Drilled by \_\_\_\_\_  
 Location \_\_\_\_\_  
 Date \_\_\_\_\_  
 Name of Company \_\_\_\_\_  
 Address \_\_\_\_\_  
 Driller \_\_\_\_\_  
 Address \_\_\_\_\_  
 Date \_\_\_\_\_

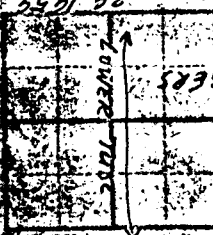

Depth (ft)	Description
0-10	TOUGH CLAY
10-20	SAND & CLAY STRATIGERS
20-30	HARD CLAY
30-40	GRAVEL
40-50	COARSE SAND
50-60	HARD CLAY
60-70	HARD CLAY
70-80	HARD CLAY
80-90	HARD CLAY
90-100	HARD CLAY
100-110	HARD CLAY
110-120	HARD CLAY
120-130	HARD CLAY
130-140	HARD CLAY
140-150	HARD CLAY
150-160	HARD CLAY
160-170	HARD CLAY
170-180	HARD CLAY
180-190	HARD CLAY
190-200	HARD CLAY
200-210	HARD CLAY
210-220	HARD CLAY
220-230	HARD CLAY
230-240	HARD CLAY
240-250	HARD CLAY
250-260	HARD CLAY
260-270	HARD CLAY
270-280	HARD CLAY
280-290	HARD CLAY
290-300	HARD CLAY
300-310	HARD CLAY
310-320	HARD CLAY
320-330	HARD CLAY
330-340	HARD CLAY
340-350	HARD CLAY
350-360	HARD CLAY
360-370	HARD CLAY
370-380	HARD CLAY
380-390	HARD CLAY
390-400	HARD CLAY
400-410	HARD CLAY
410-420	HARD CLAY
420-430	HARD CLAY
430-440	HARD CLAY
440-450	HARD CLAY
450-460	HARD CLAY
460-470	HARD CLAY
470-480	HARD CLAY
480-490	HARD CLAY
490-500	HARD CLAY

SEE WELL LOG FOR LOCATION

