

9-185
(October 1950)

UNITED STATES
DEPARTMENT OF THE INTERIOR
GEOLOGICAL SURVEY
WATER RESOURCES DIVISION

Log #37

WELL SCHEDULE

Date 8/28, 1962 Field No. P-22
Record by P.E. Grantham Office No. _____
Source of data Drkr. & Obser.

1. Location: State Miss County Monroe

Map NE NW 1/4 NW 1/4 sec. 3 T 15 N R 7

2. Owner: Thompson Chemical Address Aberdeen
~~Tenant~~ Co (Monroe Mfg. Co.) Address _____
Driller Carlson Well Supply Address Memphis

3. Topography Prairie

4. Elevation 218 ft. above mead Bas 1

5. Type: Dug drilled driven, bored, jetted 1962

6. Depth: Rept. 216 ft. Meas. _____ ft.

7. Casing: Diam. _____ in., to _____ in., Type _____
Depth _____ ft., Finish 40' slotted pipe

8. Chief Aquifer Eutaw From _____ ft. to _____ ft.
Others _____

9. Water level _____ ft. rept. _____ 19 _____ above below
_____ ft. meas. _____ which is _____ ft. above below surface

10. Pump: Type Turbine (Temporary) Capacity _____ G. M.
Power: Kind Gas engine Horsepower _____

11. Yield: Flow _____ G. M., Pump _____ G. M., Meas., Rept. Est. _____
Drawdown 11 ft. after _____ hours pumping 100 G. M.

12. Use: Dom., Stock, PS., RR., Ind., Irr., Obs.
Adequacy, permanence +

13. Quality _____ Temp _____ °F.
Taste, odor, color _____ Sample Yes _____ No _____
Unfit for _____

14. Remarks: (Log, Analyses, etc.) Mud Res 18.5 @ 92°F - 3/4" screen wrapped, perforated pipe set along side casing for measuring water level - while pumping well

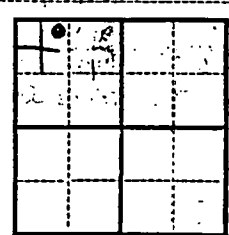

P-22

4/5/78	89.99
10/16/78	96.67
5/15/79	96.43
4/24/80	87.76
3/11/81	102.27
4/9/82	100.83
11/19/82	98.78
4/25/84	86.80
4/24/85	86.47
4/2/86	93.17
10/28/87	105.28

UNITED STATES
 DEPARTMENT OF THE INTERIOR
 GEOLOGICAL SURVEY
 WATER RESOURCES DIVISION

Tombigbee
 SD

1" = 400'

- 0-15 Top clay
- 15-20 Fine Sd
- 20-24 clay Rock
- 24-48 Blue Sh (not to hard, sd Strks)
- 48-58 Sh
- 58-70 Fine Sd Grey
- 70-93 Sd then Strks Blq nite
- 93-115 Sd then Strks sh
- 115-159 Sd
- 159-182 Sd (real poss)
- 182-195 Sd
- 195-6" Rock
- 195 6"-206 thin Rocks
- 206-216 Strks Sd clay

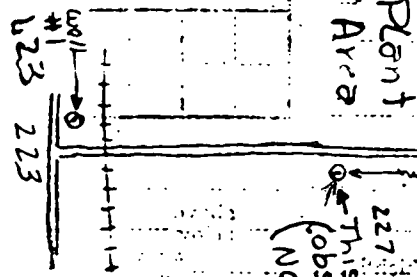

Abeydena = Hwy #58

MESHAN

Goedo

This well = P22
 (observation well)
 NO pump

#2 Well P23
 L27 replace P23

well #3
 P24
 215

COKER

PENN.

Proposed well locations
 1956-1957
 1958-1959
 1960-1961
 1962-1963
 1964-1965
 1966-1967
 1968-1969
 1970-1971
 1972-1973
 1974-1975
 1976-1977
 1978-1979
 1980-1981
 1982-1983
 1984-1985
 1986-1987
 1988-1989
 1990-1991
 1992-1993
 1994-1995
 1996-1997
 1998-1999
 2000-2001
 2002-2003
 2004-2005
 2006-2007
 2008-2009
 2010-2011
 2012-2013
 2014-2015
 2016-2017
 2018-2019
 2020-2021
 2022-2023
 2024-2025

Observation Well

County Manassas

Well No. P22

Owner's Name Conoco Oil Co (was Haverhill)

Location Abandon
(town)
1 mi SW on State Highway 25
(miles and direction from center of town)

Other description Inside metal building see sketch.

Depth 216 Diameter 6 Date drilled _____

Formation Sandstone

Elev. of lsd 210 Recorder Records not on well

M.P. top of 6" casing at 2.40 ft above below lsd. Date 1981

M.P. _____ at _____ ft above below lsd. Date _____

M.P. _____ at _____ ft above below lsd. Date _____

Special _____

Water Level 105.33 (11/82)

Sketch of location

Sketch of well head

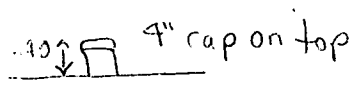
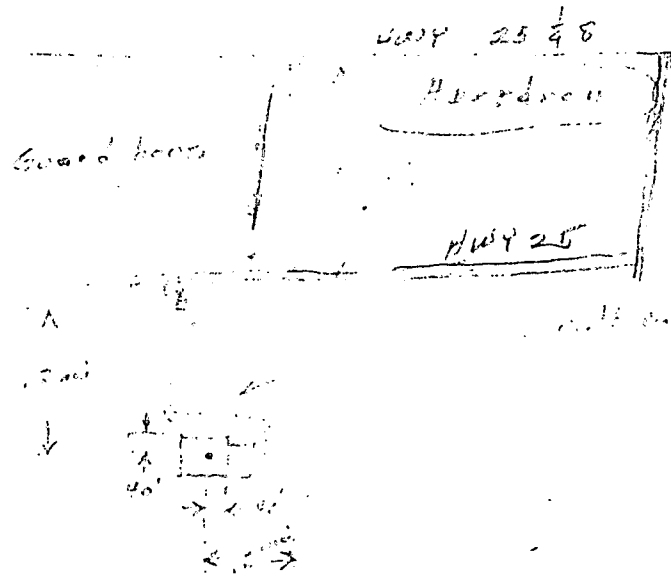

Well in dryer bldg. near middle of Bldg near floor level.

105.33 3/11/81

102 67

Observation Well

County Monroe

FILE COPY

Well No. 122

Owner's Name Canada oil co (Mrs. Maurice May Co)

Location Aberdeen
(town)

1 mi SW on State Highway 25
(miles and direction from center of town)

Other description Building on sketch.

Depth 216 Diameter _____ Date drilled _____

Formation Furze

Elev. of lsd 210 Recorder _____ Type _____ No. _____

M.P. Top of 4" casing at 40 ft above lsd. Date 1981

M.P. _____ at _____ ft above lsd. Date _____

M.P. _____ at _____ ft above lsd. Date _____

Special _____

Water Level _____

Sketch of location

Sketch of well head

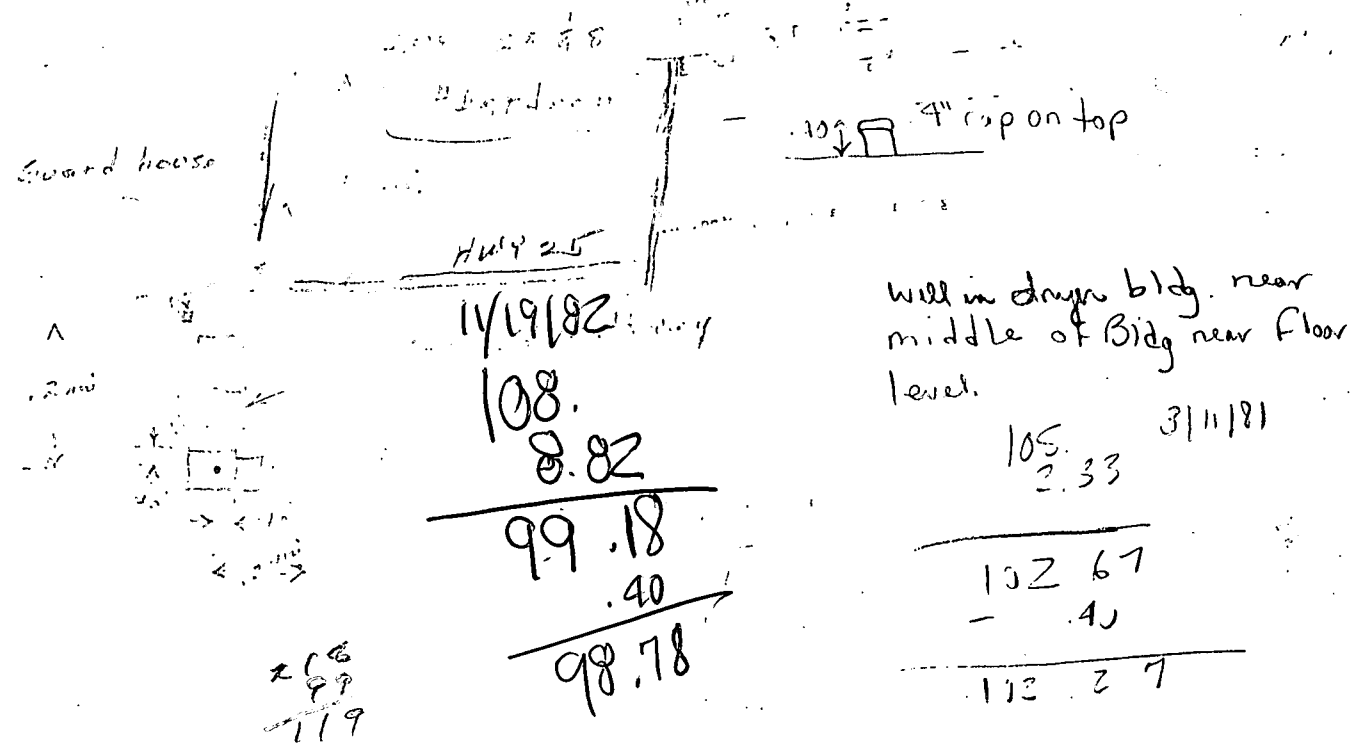

FORM NO. 9-1904-E

Revised September 1980

FILE COPY

Monroe County

U.S. DEPT. OF INTERIOR
GEOLOGICAL SURVEY
WATER RESOURCES DIVISION
WATER-LEVEL DATA

WELL NO. P22
MP HEIGHT _____

owner: Conoco Chem. Co.

Site Ident. No. 5 _____

R = 234 *

T = A *

DATE	WATER LEVEL (BELOW LSD)	STATUS	METHOD	HOLD	CUT	DEPTH BELOW MP	REMARKS	DATE PUNCHED	DATE ENTERED
235 # 04/05/1978 *	237 = 89.99 *	238 = *	239 - *						
235 # / / / *	237 = *	238 = *	239 = *						
235 # 10/16/1978 *	237 = 96.67 *	238 = *	239 = *						
235 # 05/15/1979 *	237 = 96.43 *	238 = *	239 = *						
235 # 04/24/1980 *	237 = 87.76 *	238 = *	239 = *						
235 # / / / *	237 = *	238 = *	239 = *						
235 # 03/11/1981 *	237 = 102.27 *	238 = *	239 = *						
235 # 04/09/1982 *	237 = 100.83 *	238 = *	239 = *						
235 # 11/19/1982 *	237 = 98.78 *	238 = *	239 = *						
235 # 04/25/1984 *	237 = 86.80 *	238 = *	239 = *						
235 # 04/24/1985 *	237 = 86.47 *	238 = *	239 = *						
235 # 04/02/1986 *	237 = 95.17 *	238 = *	239 = *						
235 # 10/28/1987 *	237 = 105.28 *	238 = *	239 = *						
235 # / / / *	237 = *	238 = *	239 = *						
235 # / / / *	237 = *	238 = *	239 = *						
235 # / / / *	237 = *	238 = *	239 = *						
235 # / / / *	237 = *	238 = *	239 = *						
235 # / / / *	237 = *	238 = *	239 = *						
235 # / / / *	237 = *	238 = *	239 = *						
235 # / / / *	237 = *	238 = *	239 = *						
235 # / / / *	237 = *	238 = *	239 = *						
235 # / / / *	237 = *	238 = *	239 = *						
235 # / / / *	237 = *	238 = *	239 = *						
235 # / / / *	237 = *	238 = *	239 = *						
235 # / / / *	237 = *	238 = *	239 = *						
235 # / / / *	237 = *	238 = *	239 = *						
235 # / / / *	237 = *	238 = *	239 = *						

MEASURING POINT

R = 320 * T = A D M *
add, delete, modify

M.P. Begin Date	321 #	/	/	/	*
M.P. End Date	322 =	/	/	/	*
M.P. Height	323 =	.	.	.	*
M.P. Remark	324 =				

Method of Measurement

239 = A B C E G H L M N R S T V Z
airline, analog, calibrated, estimated, pressure, calibrated, geophysical, manometer, non-reported, steel, electric, calibrated, other
airline gage pressure gage logs recording gage, tape tape electric tape

Site Status

238 = D E F G H I J N O P R S T V W X Z
dry, recently, flowing, nearby, nearby, injector, injector, discon- obstruction, pumping, recently, nearby, nearby, foreign, well, affected by, other
flowing flowing recently flowing or site monitor measuring, pumped pumping recently matter destroyed surface pumping on water water site

