

9-185
(October 1950)

UNITED STATES
DEPARTMENT OF THE INTERIOR
GEOLOGICAL SURVEY
WATER RESOURCES DIVISION

704
733
209
99

WELL SCHEDULE

Date AUG. 28, 19 56 Field No. 7
Record by SHOWS-HITT Office No. 285
Source of data MRS E.M. KING

1. Location: State MISS County MONROE
Map MONROE CO. HIGHWAY
NW NW 1/4 NE 1/4 sec. 14 T 15 N R 7

2. Owner: E. KING Address RT. 4, ABERDEEN
Tenant _____ Address _____
Driller REEVES Address AMORY

3. Topography FLAT

4. Elevation 200 ft. above
below

5. Type: Dug, drilled, driven, bored, jetted 19 53

6. Depth: Rept. 150± ft. Meas. _____ ft.

7. Casing: Diam. 3 in., to _____ in., Type _____
Depth 50 ft., Finish _____

8. Chief Aquifer _____ From _____ ft. to _____ ft.
Others _____

9. Water level 30± ft. ^{rept} _{meas.} 19 56 above
below
which is _____ ft. above
below surface

10. Pump: Type JET Capacity _____ G. M.
Power: Kind ELEC. Horsepower 1/3

11. Yield: Flow _____ G. M., Pump _____ G. M., Meas., Rept. Est.
Drawdown _____ ft. after _____ hours pumping _____ G. M.

12. Use: Dom. Stock, PS., RR., Ind., Irr., Obs.
Adequacy, permanence _____

13. Quality HARD Temp _____ °F.
Taste, odor, color _____ Sample Yes
No
Unfit for _____

14. Remarks: (Log, Analyses, etc.) _____

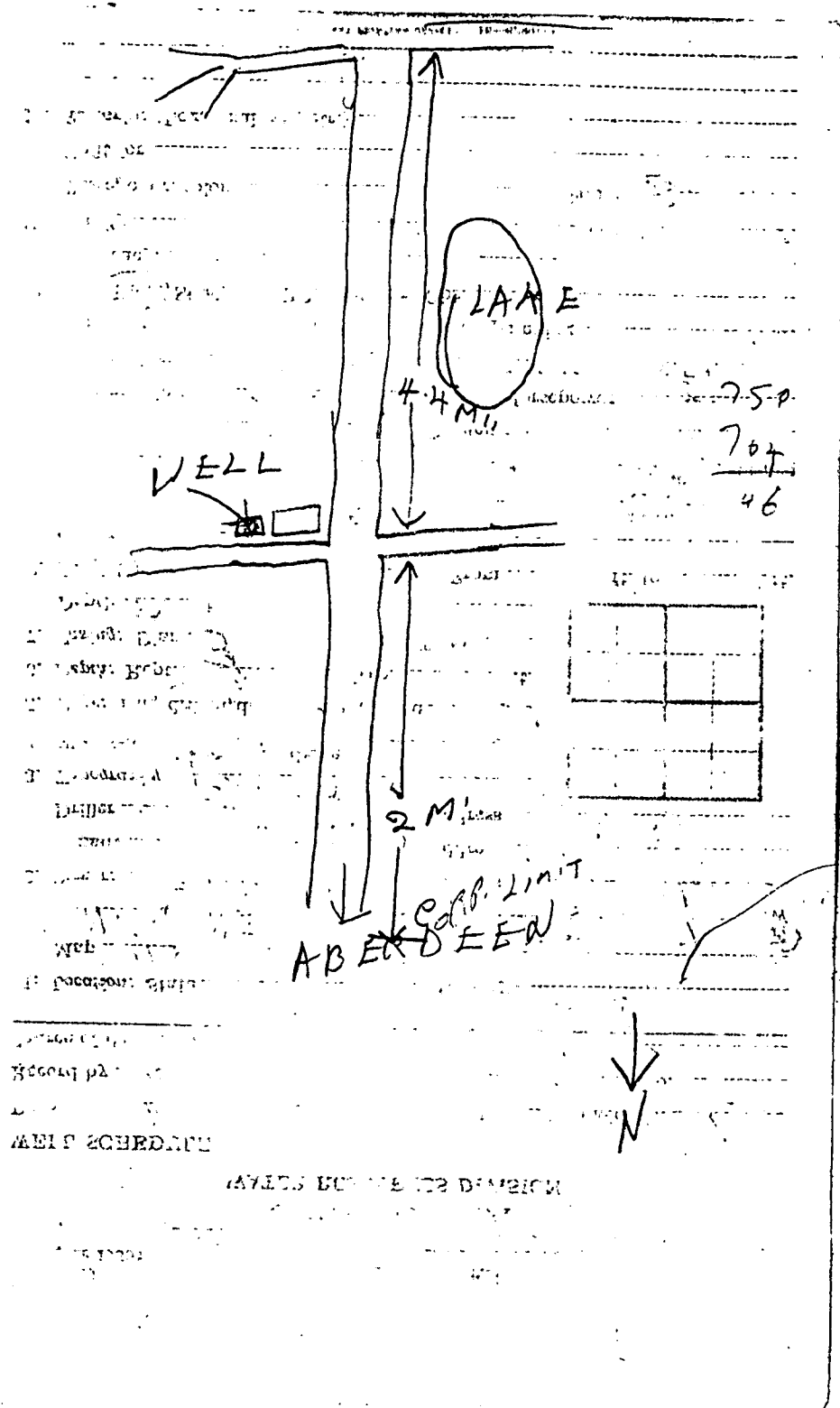



Aberdeen Quad

Sewage Disposal Pond

Sewage Disposal Pond

James

East Aberdeen

ABERDEEN

James Creek Ch

Gaging Station

CENTRAL

NORTHERN

BURLINGTON

Gravel Pit

Crossroads Ch 1

COMMERCE

10

35

51

36

2

86

12

91

90

13

189

300

200

200

200

200

200

200

200

220

220

220

220

220

220

220

220

220

220

220

220

220

220

220

220

220

220

220

220

220

230

230

230

230

230

230

230

230

230

230

230

230

230

230

230

230

230

230

230

230

230

240

240

240

240

240

240

240

240

240

240

240

240

240

240

240

240

240

240

240

240

240

250

250

250

250

250

250

250

250

250

250

250

250

250

250

250

250

250

250

250

250

250

260

260

260

260

260

260

260

260

260

260

260

260

260

260

260

260

260

260

260

260

260

270

270

270

270

270

270

270

270

270

270

270

270

270

270

270

270

270

270

270

270

270

280

280

280

280

280

280

280

280

280

280

280

280

280

280

280

280

280

280

280

280

280

290

290

290

290

290

290

290

290

290

290

290

290

290

290

290

290

290

290

290

290

290

300

300

300

300

300

300

300

300

300

300

300

300

300

300

300

300

300

300

300

300

300

310

310

310

310

310

310

310

310

310

310

310

310

310

310

310

310

310

310

310

310

310

320

320

320

320

320

320

320

320

320

320

320

320

320

320

320

320

320

320

320

320

320

330

330

330

330

330

330

330

330

330

330

330

330

330

330

330

330

330

330

330

330

330

340

340

340

340

340

340

340

340

340

340

340

340

340

340

340

340

340

340

340

340

340

350

350

350

350

350

350

350

350

350

350

350

350

350

350

350

350

350

350

350

350

350

360

360

360

360

360

360

360

360

360

360

360