

6/78 WTO

Recorded by 05W
Date 12/1/78

U.S. GEOLOGICAL SURVEY
WATER RESOURCES DIVISION
MISSISSIPPI DISTRICT
WELL RECORD

FILE COPY TRANSMITTED FOR ADP

Well No. 063
E-Log No. _____
County Monroe

Site ID 334331088412101 R=0* T=A* 2=W*

Data reliab. 3=C Report. agency 4=USGS* Dist. 6=28* 7=28* Co. 8=095*

Lat. _____ Long. 9=334331* 10=0884121* Well No. 12=0063*

Location 13=SWSE S 32 T 15 S R 06 E* Alt. 16=240.*

Hyd. Unit (OWDC) 20= Date 21=0410511967*

Well use 23=W* Water Use 24=H* Hole depth 27=340.* Well depth 28=340.*

WL 30=103.* Date 31=1210111978* Source 33=S*

Status 273= Project No. 5= 11/30/8

R=158* T=A* Date 159#0410511967* Owner No. WL=106.23

OWNER Owner 161=JAMES R. RUFINE* 115.00
TAPE TOO MUDDY TO MEASURE

FIELD ON R=192* T=A* Date 193# Temp. 196#00010* 197=

R=192* T=A* Date 193# Cond. 196#00095* 197=

R=192* T=A* Date 193# pH 196#00400* 197=

CONSTR. R=58* T=A* 59#1* Date 60=0410511967* Remarks _____

Drlg. 63= Name Hendon Method 65=H* Finish 66=X*

R=76* T=A* 59#1*

Top csng. 77#0.* Bot. csng. 78=23.* Diam. 79#5.*

R=76* T=A* 59#1*

Top csng. 77# Bot. csng. 78= Diam. 79#

R=82* T=A* 59#1* Top 83#23.* Bottom 84=340.*

Type 85=X* Diam. 87=5.* Size 88=

R=82* T=A* 59#1* Top 83# Bottom 84=

Type 85= Diam. 87= Size 88=

YIELD R= T=A* 147#1* Q 150= Q/S 272=

134 flows 146 pumped

LIFT
 R=42* T= A * Lift type 43# * Intake 44= * Power type 45= *
 Date 38= / / H.P. 46= *

LOGS
 R=198* T= A * Log 199# 1 * Top 200= 0. * Bot 201= 340. *
 R=198* T= A * Log 199# * Top 200= * Bot 201= *
 R=189* T= A * E Log No. 190# * 191= M I S S D I S T *

ANAL.
 R=114* T= A * Year 115# * Type 120# *

AQUIFERS
 R=90* T= A * 256# 1 * Top 91= 220. * Bot 92= 340. *
 Unit ID 93= 211.E.U.T.W. * Name of Unit _____
 R=90* T= A * 256# 1 * Top 91= * Bot 92= *
 Unit ID 93= * Name of Unit _____

HYDRAULICS
 R=98* T= A * 99# 1 * Unit tested 100= * 103= *
 R=105* T= A * 99# 1 * Test No. 106# *
 107= * Transmissivity (gal/d)/ft _____
 108= * Hydraul. cond. (gal/d)/ft² _____
 110= * Storage coeff. Boundaries _____

R=121* T= * Yr Begin 122# * Network 258= *

Water Level Data Collection (1)

0-20 clay
 20-220 blue clay
 220-340 sand
 bottom

Monroe
 063
 4-67

MISSISSIPPI
 BOARD OF WATER COMMISSIONERS
 416 North State Street
 Jackson, Mississippi 39201

WATER WELL DRILLERS LOG
 Herndon-Homan Well & Supply, Inc.
 P. O. Box 42

4-5 1977
 date well completed

SHANNON, MISSISSIPPI 38868

Monroe
 county well located

LANDOWNER:	description of formations encountered	from	to
Richard Rowe	Clay (black)	0	20
Prairie Mississippi (mailing address)	Blue Clay	20	220
	Sand	220	340
	Gravel	340	
WELL LOCATION:			
sec. 32 T 15 N R 6 E			
5 miles SSW of Prairie			
WELL PURPOSE: Home			
WELL COMPLETION DATA:			
(1) diameter (inches) 5"			
(2) total depth (feet) 340'			
(3) static water level (feet) _____ below/above top of ground.			
(4) casing Steel 22'6" (material) (depth)			
5 (size) If telescope see back.			
(5) screen NONE (length) (depth to top)			
(6) pump By others (HP) (yield gpm)			
(7) electric log no (yes or no)			
(8) how well bottom plugged open			
DRILLERS REMARKS:			

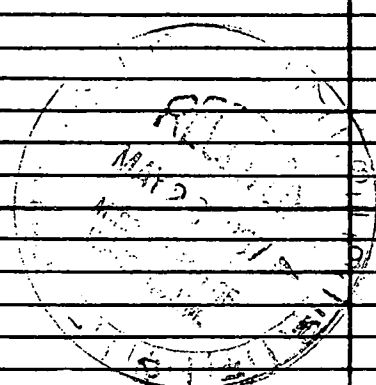

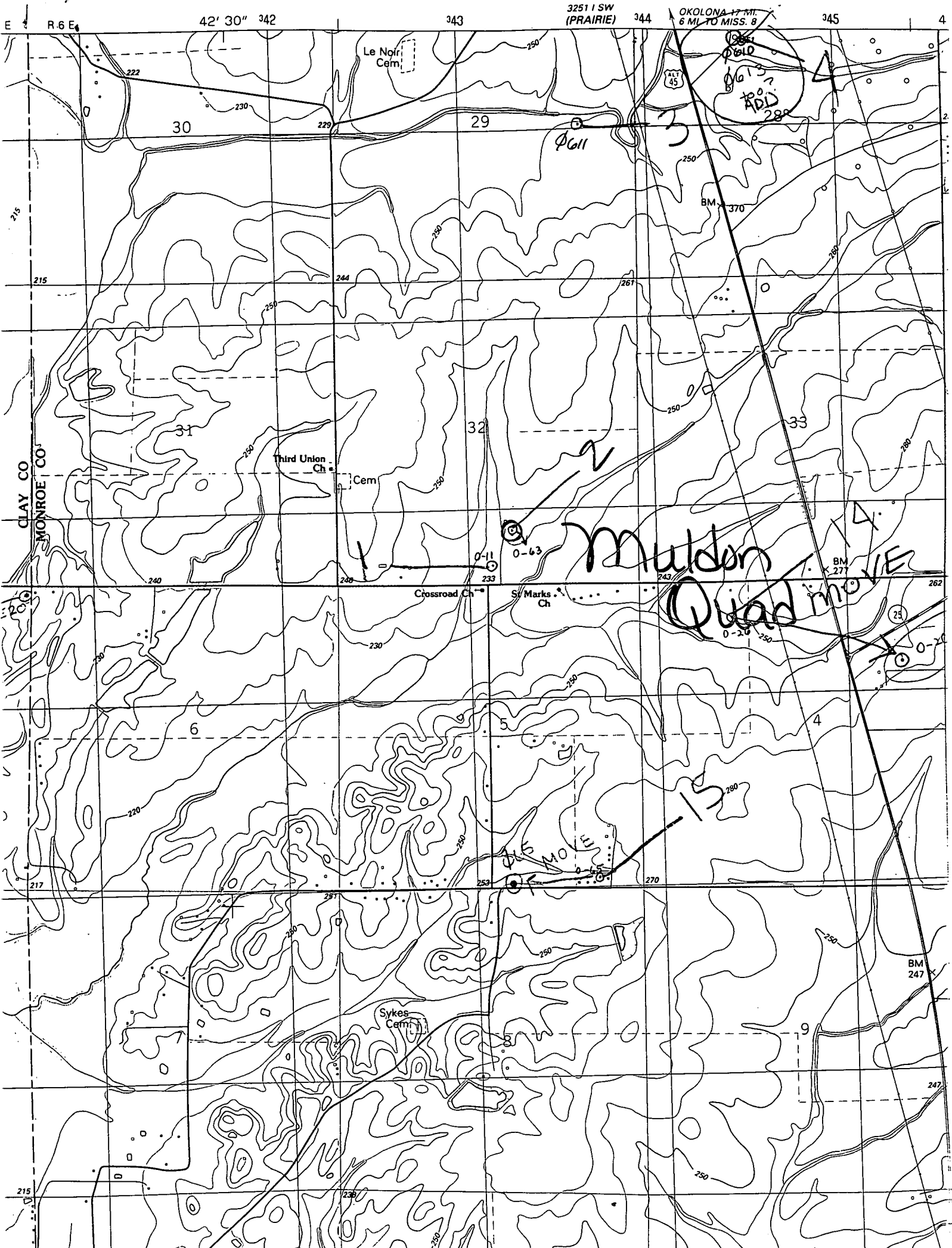

E R.6 E₄

42' 30" 342

343

3251 / SW (PRAIRIE)

344

OKOLONA 17 MI. 6 MI. TO MISS. 8

345

4

215

215

CLAY CO
MONROE CO

217

215

30

29

31

32

33

6

5

4

9

Le Noir Cem.

Third Union Ch. Cem.

Crossroad Ch.

St. Marks Ch.

Sykes Cem.

Call

Muldon Quad

15

ADL

0-20

0-11

0-63

BM 277

262

BM 247

247

BM 370

262

BM 247

247