

Prairie

FORM 9-1642 (1-68)

Well No. 049

WELL SCHEDULE

PUNCHED JUL 13 1973

U. S. DEPT. OF THE INTERIOR

GEOLOGICAL SURVEY

WATER RESOURCES DIVISION

MASTER CARD

Record by JCM Source of data BOWC Date 6-73 Map _____

State 28 County (or town) Monroe 48

Latitude: 33 45 14 N Longitude: 088 430 0 Sequential number: 1

Lat-long accuracy: 2 150 R 6 W Sec 19 SW SW SW B & M

Local well number: 0049CC1915506E Other number: _____

Local use: 021 Owner or name: _____

Owner or name: PARSON Address: Aberdeen

Ownership: County, Fed Gov't, City, Corp or Co, Private, State Agency, Water Dist P

Use of water: (A) Air cond, Bottling, Comm, Dewater, Power, Fire, Dom, Irr, Med, Ind, P S, Rec, (S) Stock, Inscit, Unused, Reprressure, Recharge, Desal-P S, Desal-other, Other H

Use of well: (A) Anode, Drain, Seismic, Heat Res, Obs, Oil-gas, Recharge, Test, Unused, Withdraw, Waste, Destroyed. W

DATA AVAILABLE: Well data Freq. W/L meas.: Field aquifer char.

Hyd. lab. data: _____

Qual. water data: type: _____

Freq. sampling: _____ Pumpage inventory: yes no period: _____

Core cards: _____ yes

Log data: D

WELL-DESCRIPTION CARD

SAME AS ON MASTER CARD Depth well: 360 Meas. 3

Depth cased: (first perf.) _____ ft 21 Casing type: Steel accuracy _____

Finish: porous concrete, gravel w. (perf.), (screen), gallery, end, (C) gravel w. (H) horiz. open perf., screen, sd. pt., shored, open hole, other X

Method Drilled: (A) air bored, cable, dug, hyd jetted, air reverse trenching, driven, drive wash, (B) rot, (C) rot., (D) percussion, rotary, (J) other H

Date Drilled: 973 Pump intake setting: _____ ft _____

Driller: Homan address _____

Lift (type): (A) air, bucket, cent, jet, multiple, (cent.), (B) multiple, (C) multiple, (cent.), (D) none, piston, rot, submerg, turb, other S Deep Shallow

Power (type): diesel, gas, gasoline, hand, gas, wind; H.P. 1/2 Trans. or meter no. S

Descrip. MP _____ ft above below LSD, Alt. MP _____

Alt. LSD: 240 Accuracy: (source) _____

Water Level: _____ ft above below MP; _____ below LSD 75 Accuracy: _____

Date meas: 573 Yield: _____ gpm 5 Method determined _____

Drawdown: _____ ft _____ Accuracy: _____ Pumping period _____ hrs _____

QUALITY OF WATER DATA: Iron _____ ppm _____ Sulfate _____ ppm _____ Chloride _____ ppm _____ Hard. _____ ppm _____

Sp. Conduct _____ K x 10⁶ _____ Temp. _____ °F _____ Date sampled _____

Taste, color, etc. _____

Well No.

049

Well No. _____

PUNCHED

Latitude-longitude _____
d m s d m s

HYDROGEOLOGIC CARD

SAME AS ON MASTER CARD Physiographic Province: _____ Section: _____
20 21

Drainage Basin: **D** Subbasin: **13E** _____
22 23 25 26

Topo of well site: (D) depression, stream channel, dunes, flat, hilltop, sink, swamp, (E) (F) (H) (K) (L) (P) (S) (T) (U) (V) offshore, pediment, hillside, terrace, undulating, valley flat _____
27

MAJOR AQUIFER: system _____ series **K3** aquifer, formation, group **EZ**
28 29 30 31

Lithology: _____ Origin: **6** Aquifer Thickness: **140** ft
32 33 34

Length of well open to: _____ ft **140** Depth to top of: _____ ft **220**
35 36 37 38 39 40 41 42

MINOR AQUIFER: system _____ series _____ aquifer, formation, group _____
44 45 46 47

Lithology: _____ Origin: _____ Aquifer Thickness: _____ ft
48 49 50

Length of well open to: _____ ft _____ Depth to top of: _____ ft _____
51 52 53 54 55 56 57 58 59

Intervals Screened: **NONE**

Depth to consolidated rock: _____ ft _____ Source of data: _____
60 61 62 63 64

Depth to basement: _____ ft _____ Source of data: _____
65 66 67 68 69

Surficial material: _____ Infiltration characteristics: _____
70 71 72

Coefficient Trans: _____ gpd/ft _____ Coefficient Storage: _____
73 74 75 76 77 78

Coefficient Perm: _____ gpd/ft²; Spec cap: _____ gpm/ft; Number of geologic cards: _____
79

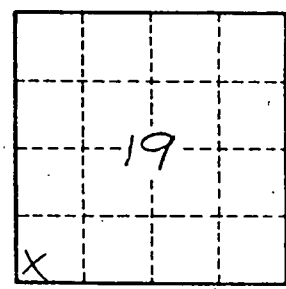

Well No. _____

049

MONROE
 049
 5-22-73

MISSISSIPPI
 BOARD OF WATER COMMISSIONERS
 416 North State Street
 Jackson, Mississippi 39201

CODED

WATER WELL DRILLERS LOG

5-22-73 1973 Herman Homan Well & Supply, Inc.
 date well completed P. No. 46

Monroe
 county well located

LANDOWNER: Robert Clayton
 description of formations encountered

from	to
0	16
16	220
220	360
360	

WELL LOCATION:
 sec. 17 T. 15 N. R. 6 E.
 3 miles SW of Prairie
 (distance) (direction) (nearest town)

WELL PURPOSE: Home
 (home, irrigation, municipal, industrial)

- WELL COMPLETION DATA:
- (1) diameter (inches) 5"
 - (2) total depth (feet) 360'
 - (3) static water level (feet) 75' below top of ground
 - (4) casing steel, 21' (depth), 5" (size) If telescope see back.
 - (5) screen 18' (length), (depth to top) (size) (material)
 - (6) pump 1/2 (HP), 5 (yield gpm) electric (type power)
 - (7) electric log no (yes or no)
 - (8) how well bottom plugged open

CODED

DRILLERS REMARKS:

JUN 14 1973

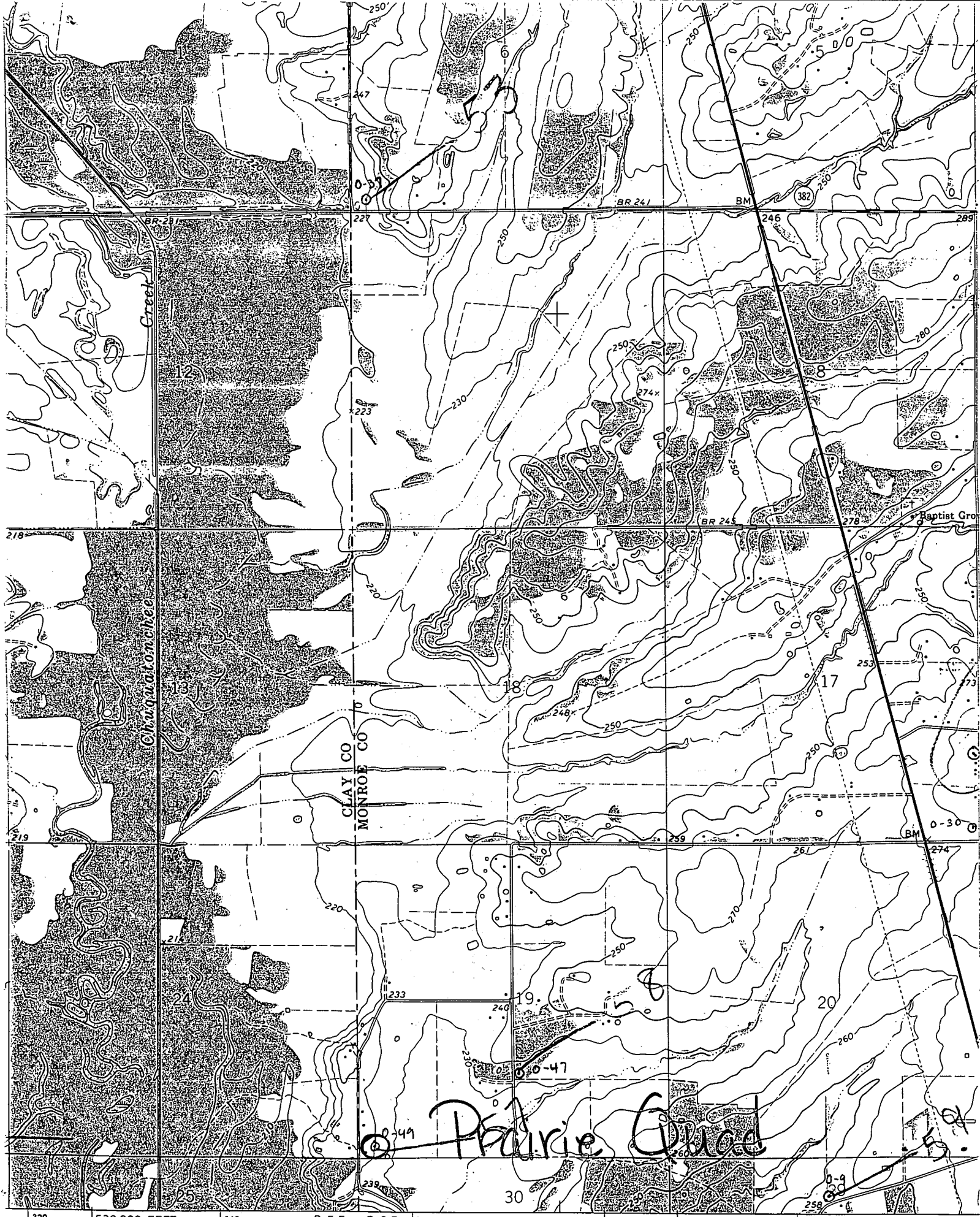

Published by the Geological Survey

Survey methods from aerial

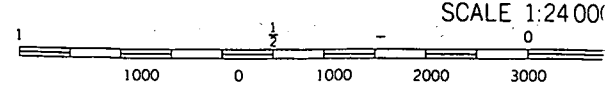

(WEST POINT 1:62 3251 II)

SCALE 1:24000