

Prairie

FORM 9-1642 (1-68)

Well No. 047

WELL SCHEDULE

U. S. DEPT. OF THE INTERIOR

GEOLOGICAL SURVEY

WATER RESOURCES DIVISION

PUNCHED

JUL 13 1973

MASTER CARD

Record by JCM Source of data BOWC Date 6-73 Map _____

State 28 County (or town) Monroe 48

Latitude: 33^{deg} 45^{min} 27^{sec} N Longitude: 088^{deg} 42^{min} 35^{sec} W Sequential number: 1

Lat-Long accuracy: 2⁰ T 15⁰ R 6⁰ E Sec 19^{SW} 15^{SW} 1^{NW} 5^{SE}

Local well number: 047 B 19 S 06 E Other well number: _____ B & M

Local use: 027 Owner or name: JESSIE EWING Address: Prairie

Ownership: County, Fed Gov't, City, Corp or Co, Private, State Agency, Water Dist _____ A

Use of water: (A) Air cond, Bottling, (B) Comm, Dewater, Power, Fire, Dom, Irr, Med, Ind, P S, Rec, (C) Stock, (D) Instit, (E) Unused, (F) Repressure, (G) Recharge, (H) Desal-P S, (I) Desal-other, (J) Other _____ H

Use of well: (A) Anode, (B) Drain, (C) Seismic, (D) Heat Res, (E) Obs, (F) Oil-gas, (G) Recharge, (H) Test, (I) Unused, (J) Withdraw, (K) Waste, (L) Destroyed _____ W

DATA AVAILABLE: Well data Freq. W/L meas.: Field aquifer char.

Hyd. lab. data: _____

Qual. water data; type: _____

Freq. sampling: _____ Pumpage inventory: yes no period: _____

Log data: _____ D

WELL-DESCRIPTION CARD

SAME AS ON MASTER CARD Depth well: _____ ft 405 Meas. 3

Depth cased: (first perf.) _____ ft 42 Casing type: Steel ; Diam. _____ in 4

Finish: (A) porous concrete, (B) gravel w. (perf.), (C) gravel w. (screen), (D) horiz. gallery, (E) open end, (F) perf., (G) screen, (H) sd. pt., (I) shored, (J) open hole, (K) other _____ X

Method: (A) air rot, (B) bored, (C) cable, (D) dug, (E) hyd jetted, (F) air percuss, (G) rotary, (H) reverse, (I) trenching, (J) driven, (K) wash, (L) other _____ H

Date Drilled: 9.7.2 Pump intake setting: _____ ft _____

Driller: J. W. Webb name _____ address _____

Lift (type): (A) air, (B) bucket, (C) cent, (D) jet, (E) multiple, (F) multiple, (G) none, (H) piston, (I) rot, (J) submerg, (K) turb, (L) other _____ S Deep Shallow

Power (type): (A) diesel, (B) elec, (C) gas, (D) gasoline, (E) hand, (F) gas, (G) wind, (H) H.P. _____ 1/2 S Trans. or meter no. _____

Descrip. MP _____ ft above _____ ft below LSD, Alt. MP _____

Alt. LSD: _____ 235 Accuracy: (source) _____

Water Level: _____ ft above _____ ft below MP; _____ ft below LSD 60 Accuracy: _____

Date meas: _____ N. 7.2 Yield: _____ gpm 8 Method determined _____

Drawdown: _____ ft _____ Accuracy: _____ Pumping period _____ hrs _____

QUALITY OF WATER DATA: Iron _____ ppm _____ Sulfate _____ ppm _____ Chloride _____ ppm _____ Hard. _____ ppm _____

Sp. Conduct _____ K x 10 _____ Temp. _____ °F _____ Date sampled _____

Taste, color, etc. _____

Well No. 047

Well No. _____

Latitude-longitude _____
N
S
d m s d m s

HYDROGEOLOGIC CARD

SAME AS ON MASTER-CARD

Physiographic Province: _____

Section: 03

Drainage Basin: D

Subbasin: 13E

Top of well site: (D) (C) (E) (P) (H) (K) (L) depression, stream channel, dunes, flat, hilltop, sink, swamp.
(O) (P) (S) (T) (U) (V) offshore, pediment, hillside, terrace, undulating, valley flat

MAJOR AQUIFER: system _____ series IC3 aquifer, formation, group E2

Lithology: _____ Origin: 6 Aquifer Thickness: 185 ft
Length of well open to: _____ ft 185 Depth to top of: _____ ft 220

MINOR AQUIFER: system _____ series _____ aquifer, formation, group _____

Lithology: _____ Origin: _____ Aquifer Thickness: _____ ft
Length of well open to: _____ ft _____ Depth to top of: _____ ft _____

Intervals Screened: NONE

Depth to consolidated rock: _____ ft _____ Source of data: _____

Depth to basement: _____ ft _____ Source of data: _____

Surficial material: _____ Infiltration characteristics: _____

Coefficient Trans: _____ gpd/ft _____ Coefficient Storage: _____

Coefficient Perm: _____ gpd/ft²; Spec cap: _____ gpm/ft; Number of geologic cards: _____

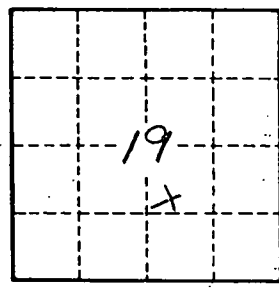

Well No. 047

MONROE
Ø 47
11-15-72

MISSISSIPPI
BOARD OF WATER COMMISSIONERS
416 North State Street
Jackson, Mississippi 39201
CODED
WATER WELL DRILLERS LOG

Nov 15 1972 J. W. Webb & Sons Monroe
date well completed firm name county well located

LANDOWNER: <u>Jessie Ewing</u>	description of formations encountered	from	to
<u>PRairie, Miss</u> (mailing address)	<u>topsoil, red & white clay</u>	0	30
	<u>blue marl</u>	30	220
	<u>blue gray sand</u>	220	405
WELL LOCATION: sec. <u>19</u> T. <u>15</u> N. R. <u>6</u> E <u>10</u> miles <u>South</u> of <u>PRairie</u> (distance) (direction) (nearest town)			
WELL PURPOSE: <u>home</u> (home, irrigation, municipal, industrial)			
WELL COMPLETION DATA:			
(1) diameter (inches) <u>4"</u>			
(2) total depth (feet) <u>405 ft</u>			
(3) static water level (feet) <u>60</u> ^{below} above top of ground.			
(4) casing <u>steel</u> , <u>4 1/2 ft</u> , (material) (depth) <u>4"</u> (size) if telescope see back.			
(5) screen _____ (length) (depth to top) (size) (material)			
(6) pump <u>1/2 tub</u> <u>8</u> (HP) (yield gpm) <u>ELECT</u> (type power)			
(7) electric log <u>NO</u> (yes or no) (organization running log)			
(8) how well bottom plugged <u>open</u> <u>hole</u>			
DRILLERS REMARKS: _____			

CODED

JUN 11 1972

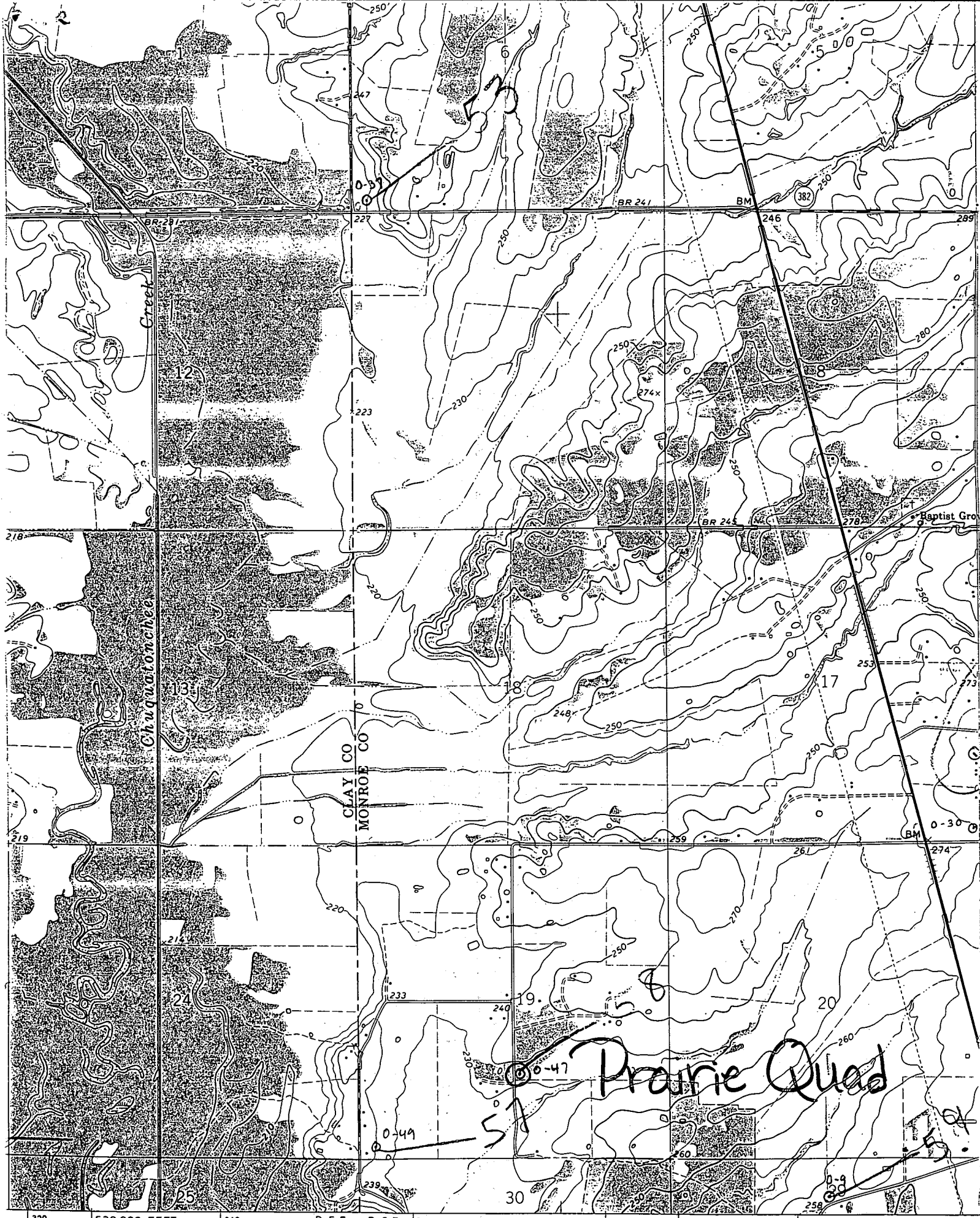

Published by the Geological Survey

Methods from aerial

