

FILE COPY

WELL SCHEDULE

PUNCHED

U. S. DEPT. OF THE INTERIOR

GEOLOGICAL SURVEY

WATER RESOURCES DIVISION

MASTER CARD

MAR 11 1973

Record by J.S. Source of data ROWC Date 11/69 Map _____

State 28 County (or town) Monroe 48

Latitude: 33^{deg} 43^{min} 15^{sec} N Longitude: 08^{deg} 84^{min} 14^{sec} W Sequential number: 1

Lat-long accuracy: 3 T. 16 R. 6 W. Sec. 54 SW. SE NW

Local well number: 0026 Other number: _____

Local use: 021 Owner or name: TENANT LISA COSGERS

Owner or name: EARL SANDERIS Address: Rt #1, Yricic.

Ownership: County, Fed Gov't, City, Corp or Co, Private, State Agency, Water Dist P

Use of water: (A) Air cond, Bottling, Comm, Dewater, Power, Fire, Dom, Irr, Med, Ind, P S, Rec, (S) (T) (U) (V) (W) (X) (Y) (Z)

Use of well: (A) Anode, Drain, Seismic, Heat Res, Obs, Oil-gas, Recharge, Test, Unused, Withdraw, Waste, Destroyed. (D) (G) (H) (I) (J) (K) (L) (M) (N) (O) (P) (Q) (R) (S) (T) (U) (V) (W) (X) (Y) (Z)

DATA AVAILABLE: Well data Freq. W/L meas: Field aquifer char.

Hyd. lab. data: _____

Qual. water data; type: _____

Freq. sampling: _____ Pumpage inventory: yes no; period: _____

Aperture cards: _____

Log data: _____

WELL-DESCRIPTION CARD

SAME AS ON MASTER CARD Depth well: 100 ft Meas. rept. accuracy 3

Depth cased; (first perf.) 21 ft Casing type: Steel; Diam. 5 in

Finish: porous concrete, gravel w. screen, gravel w. horiz. gallery, open perf., screen, sd. pt., shored, open hole, other X

Method Drilled: (A) air rot, (B) bored, (C) cable, (D) dug, (E) hyd rot., (F) jetted, (G) air percussion, (H) rotary, (I) reverse, (J) trenching, (K) driven, (L) drive wash, (M) other H

Date Drilled: 9:6:9 Pump intake setting: _____ ft

Driller: _____ name _____ address _____

Lift (type): (A) air, (B) bucket, (C) cent, jet, (D) multiple, (E) multiple, (F) none, (G) piston, (H) rot, (I) submerg, (J) turb, (K) other 39 Deep 40 Shallow

Power (type): (A) diesel, (B) elec, (C) gas, (D) gasoline, (E) hand, (F) gas, (G) wind; H.P. _____ Trans. or meter no. _____

Descrip. MP _____ ft above LSD, Alt. MP _____

Alt. LSD: 265 Accuracy: (source) _____

Water Level 70 ft above MP; Ft below LSD 70 Accuracy: _____

Date meas: 8:6:9 Yield: _____ gpm Method determined _____

Drawdown: _____ ft Accuracy: _____ Pumping period _____ hrs

QUALITY OF WATER DATA: Iron _____ ppm Sulfate _____ ppm Chloride _____ ppm Hard. _____ ppm

Sp. Conduct _____ K x 10⁶ Temp. _____ °F Date sampled _____

Taste, color, etc. _____

8/20/87
120.00
6.00
114.00
MP = 1.00

113.00
WELL HARD TO MEASURE

do not use
W/L
11/29/82
H = 150.00
MWD = 105.45
MP = 144.55
144.05

4/1/78
W/L = 137.35

5/19/88
Well had been worked on; found pump had a jet been installed. No screen hole for measuring flow.

Well No. 26

Well No. Ø 26

CEMONTA

Latitude-longitude d m s d m s

HYDROGEOLOGIC CARD

SAME AS ON MASTER CARD

Physiographic Province: _____

Section: 03

Drainage Basin: D

Subbasin: 131E

Topo of well site: (D) depression, stream channel, dunes, flat, hilltop, sink, swamp, (Ø) offshore, pediment, hillside, terrace, undulating, valley flat

MAJOR AQUIFER:

system

series

K3

aquifer, formation, group

EZ

Lithology: _____

US

Origin: _____

6

Aquifer Thickness: _____

140 ft

Length of well open to: _____ ft

Depth to top of: _____ ft

260

MINOR AQUIFER:

system

series

aquifer, formation, group

Lithology: _____

Origin: _____

Aquifer Thickness: _____

_____ ft

Length of well open to: _____ ft

Depth to top of: _____ ft

Intervals Screened:

Depth to consolidated rock: _____ ft

Source of data: _____

Depth to basement: _____ ft

Source of data: _____

Surficial material: _____

Infiltration characteristics: _____

Coefficient Trans: _____

gpd/ft

Coefficient Storage: _____

Perm: _____

gpd/ft²

Spec cap: _____

gpm/ft

Number of geologic cards: _____

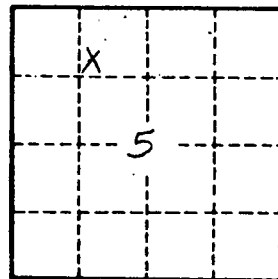
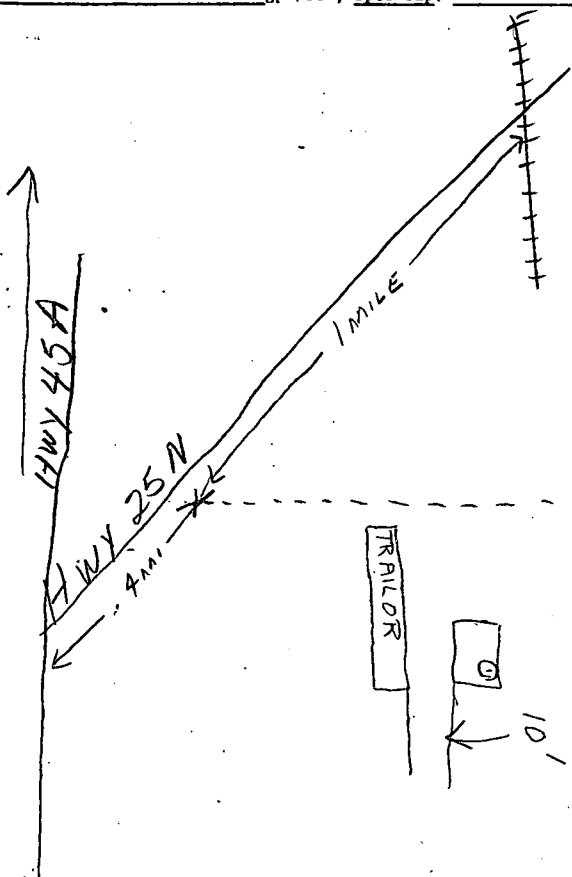

Well No. Ø 26

48,3

CODED

Monroe
26
8-69

MISSISSIPPI
 BOARD OF WATER COMMISSIONERS
 416 North State Street
 Jackson, Mississippi 39201

WATER WELL DRILLERS LOG

8-12 1969 Glendon Home Well Supply Madison
 date well completed firm name county well located

LANDOWNER: Earl Sanders
Route 1
Shairie, Miss
 (mailing address)

description of formations encountered	from	to
<u>Surface sand & clay</u>	<u>0</u>	<u>18</u>
<u>Blue clay</u>	<u>18</u>	<u>200</u>
<u>Sand</u>	<u>200</u>	<u>400</u>
<u>Bottom</u>	<u>400</u>	

WELL LOCATION:
 sec 5 T 16 N R 6 E
1 1/2 miles SW of Malden
 (distance) (direction) (nearest town)

WELL PURPOSE: Home
 (home, irrigation, municipal, industrial)

WELL COMPLETION DATA:

(1) diameter (inches) 5"

(2) total depth (feet) 400 ft

(3) static water level (feet) 20 below top of ground.

(4) casing Steel 21'2"
 (material) (depth)

5" If telescope see back.
 (size)

(5) screen no (length) (depth to top)

(size) (material)

(6) pump no (HP) (yield gpm)

(type power)

(7) electric log no (yes or no)

(organization running log)

(8) how well bottom plugged open

DRILLERS REMARKS:

SEP 4 1969
 MISS. BD. OF WATER COMMISSIONERS

