

9-185
(October 1950)

UNITED STATES
DEPARTMENT OF THE INTERIOR
GEOLOGICAL SURVEY
WATER RESOURCES DIVISION

WELL SCHEDULE

Date AUG 17, 1956 Field No. 91
Record by SHOVS - HITT Office No. M-12
Source of data K. L. WARE

1. Location: State MISS. County MONROE
Map MONROE CO, HIGHWAY

SE NE 1/4 SE 1/4 sec. 31 - T 14 N R 17 E

2. Owner: K. L. WARE Address HAMILTON, LA
Tenant _____ Address _____
Driller LANCER Address FERRIS, LA

3. Topography FLAT ^{REWORKED} BY WILLIAMS

4. Elevation 215 ft. above
below

5. Type: Dug, drilled driven, bored, jetted. 1924

6. Depth: Rept. 240 ft. Meas. _____ ft.

7. Casing: Diam. 3 in., to 2 in., Type _____
Depth 180 ft., Finish OPEN

8. Chief Aquifer RE From _____ ft. to _____ ft.
Others _____

9. Water level 9 ft. ^{rept.} 1956 ^{above} below
meas. which is _____ ft. ^{above} below surface

10. Pump: Type FLOWING Capacity _____ G. M.
Power: Kind PRESSURE Horsepower _____

11. Yield: Flow 16.0 G. M., Pump 14.5 G. M., Meas., Rept. Est. _____
Drawdown _____ ft. after _____ hours pumping _____ G. M.

12. Use: Dom. Stock, PS., RR., Ind., Irr., Obs. _____
Adequacy, permanence _____

13. Quality MINERAL, Iron, CONTENTS Temp 64 °F.
Taste, odor, color _____ Sample Yes
No

Unfit for HOUSEHOLD USE
14. Remarks: (Log, Analyses, etc.) _____

RAN 90 GAL. PER MIN.

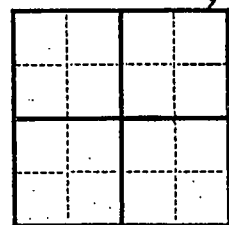

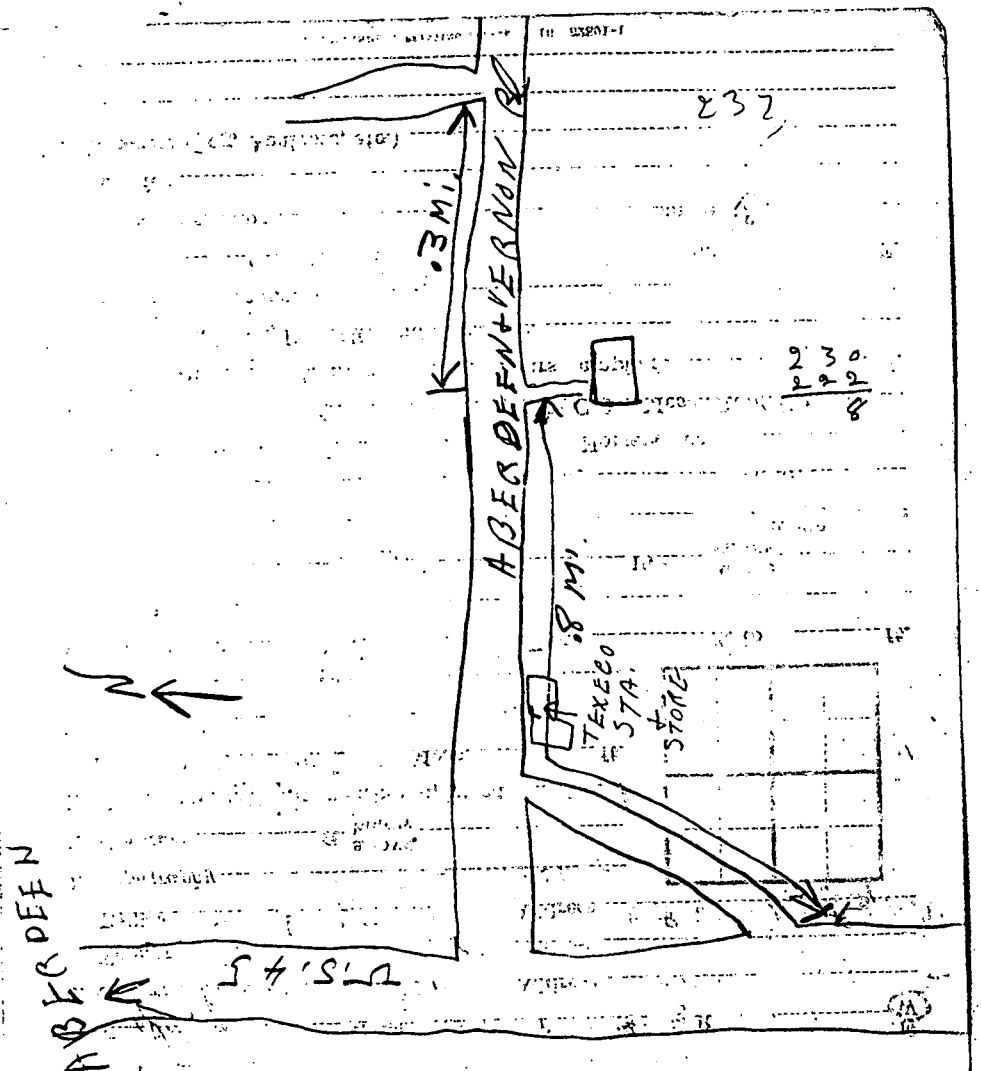

A B C D E F N
 545
 A B C D E F N + V E R N O N
 .3 mi.
 .8 mi.
 TEXERO STA.
 STONE
 237

$$\begin{array}{r} 230 \\ 292 \\ \hline 8 \end{array}$$

MYLES RESEARCH DIVISION
 BUREAU OF RESEARCH

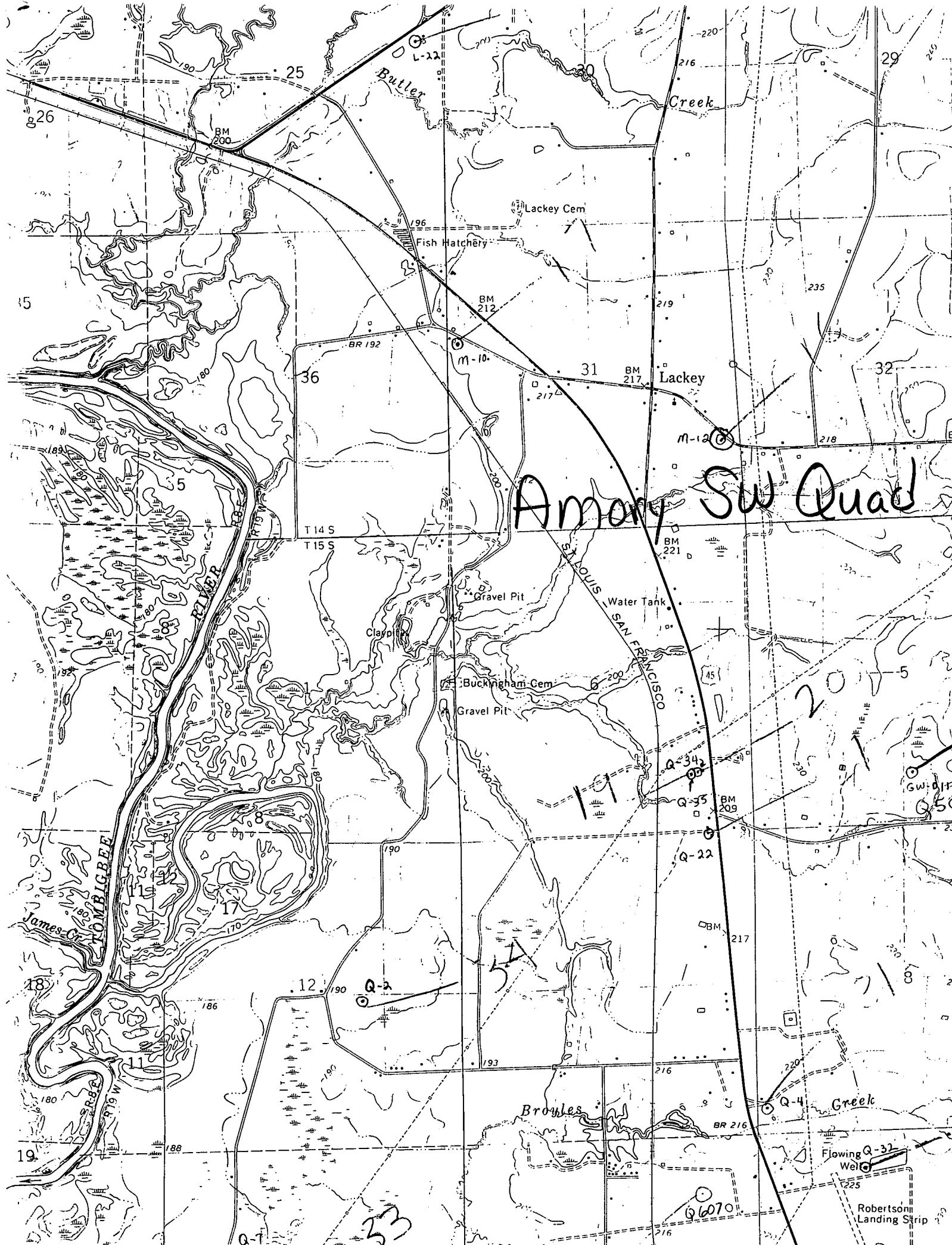

Amory SW Quad

Butler Creek

Creek

ST. LOUIS-SAN FRANCISCO

TOMBIGBEE RIVER

JAMES-CRAWFORD RIVER

Browles Creek

Q-4 Creek

Flowing Q-32 Well

Robertson Landing Strip

T 14 S

T 15 S

36

31

32

12

20

33

Q-670

Q-50

GW-013

BR 216

BR 192

M-12

M-10

26

15

18

19

29

32

5

18

19

Q-7

Q-22

Q-35

Q-34

Q-22

Q-22

Q-22

Q-22

Q-22

Q-22

Q-22

Q-22

Q-22

Q-22

Q-22

Q-22

Q-22

Q-22

Q-22

Q-22

Q-22

Q-22

Q-22

Q-22

Q-22

Q-22

Q-22

Q-22

Q-22

Q-22

Q-22

Q-22

Q-22

Q-22

Q-22

Q-22

Q-22

Q-22

Q-22

Q-22

Q-22

Q-22

Q-22

Q-22

Q-22

Q-22

Q-22

Q-22

Q-22

Q-22

Q-22

Q-22

Q-22

Q-22

Q-22

Q-22

Q-22

Q-22

Q-22

Q-22

Q-22

Q-22

Q-22

Q-22

Q-22

Q-22

Q-22

Q-22

Q-22

Q-22

Q-22

Q-22

Q-22

Q-7

Q-22

Q-22

Q-22

Q-22

Q-22

Q-22

Q-22

Q-22

Q-22

Q-22

Q-22

Q-22

Q-22

Q-22

Q-22

Q-22

Q-22

Q-22

Q-22

Q-22

Q-22

Q-22

Q-22

Q-22

Q-22

Q-22

Q-22

Q-22

Q-22

Q-22

Q-22

Q-22

Q-22

Q-22

Q-22

Q-22

Q-22

Q-22

Q-22

Q-22

Q-22

Q-22

Q-22

Q-22

Q-22

Q-22

Q-22

Q-22

Q-22

Q-22

Q-22

Q-22

Q-22

Q-22

Q-22

Q-22

Q-22

Q-22

Q-22

Q-22

Q-22

Q-22

Q-22

Q-22

Q-22

Q-22

Q-22

Q-22

Q-22

Q-22

Q-22

Q-22

Q-22

Q-22

Q-22

Q-22

Q-22

Q-22

Q-22

Q-22

Q-22

Q-22

Q-22

Q-22

Q-22

Q-22

Q-22

Q-22

Q-22

Q-22

Q-22

Q-22

Q-22

Q-22

Q-22

Q-22

Q-22

Q-22

Q-7

Q-22

Q-22

Q-22

Q-22

Q-22

Q-22

Q-22

Q-22

Q-22

Q-22

Q-22

Q-22

Q-22

Q-22

Q-22

Q-22

Q-22

Q-22

Q-22

Q-22

Q-22

Q-22

Q-22

Q-22

Q-22

Q-22

Q-22

Q-22

Q-22

Q-22

Q-22

Q-22

Q-22

Q-22

Q-22

Q-22

Q-22

Q-22

Q-22

Q-22

Q-22

Q-22

Q-22

Q-22

Q-22

Q-22

Q-22

Q-22

Q-22

Q-22

Q-22

Q-22

Q-22

Q-22

Q-22

Q-22

Q-22

Q-22

Q-22

Q-22

Q-22

Q-22

Q-22

Q-22

Q-22

Q-22

Q-22

Q-22

Q-22

Q-22

Q-22

Q-22

Q-22

Q-22

Q-22

Q-22

Q-22

Q-22

Q-22

Q-22

Q-22

Q-22

Q-22

Q-22

Q-22

Q-22

Q-22

Q-22

Q-22

Q-22

Q-22

Q-22

Q-22

Q-22

Q-22

Q-22

Q-22

Q-22

Q-7

Q-22

Q-22

Q-22

Q-22

Q-22

Q-22

Q-22

Q-22

Q-22

Q-22

Q-22

Q-22

Q-22

Q-22