

9-185  
(October 1950)

UNITED STATES  
DEPARTMENT OF THE INTERIOR  
GEOLOGICAL SURVEY  
WATER RESOURCES DIVISION

WELL SCHEDULE

Date AUG. 29, 1956 Field No. 35  
Record by SHOLES-HITT Office No. MB  
Source of data A.A. MORGAN

1. Location: State MISS County MONROE  
Map MONROE to HINDAL

Nw Nw 1/4 Nw 1/4 sec 18 T 14 N R 8 E

2. Owner: MRS. A.A. MORGAN Address ABERDEEN, AR

Tenant \_\_\_\_\_ Address \_\_\_\_\_

Driller WILL REYES Address AMOOT

3. Topography: FLAT

4. Elevation \_\_\_\_\_ ft. above \_\_\_\_\_ ft. below

5. Type: Dug, drilled, driven, bored, jetted \_\_\_\_\_ 1949

6. Depth: Rept. 150 ft. Meas. \_\_\_\_\_ ft.

7. Casing: Diam. 4 in., to \_\_\_\_\_ in. Type \_\_\_\_\_

Depth 72 ft., Finish OPEN

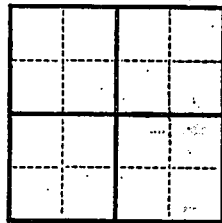

8. Chief Aquifer Ke From \_\_\_\_\_ ft. to \_\_\_\_\_ ft.

Others \_\_\_\_\_

9. Water level: 9.5 ft. rept. 19.56 above below ft. meas. which is \_\_\_\_\_ ft. above surface below

10. Pump: Type JET Capacity \_\_\_\_\_ G. M.

Power: Kind ELEC. Horsepower \_\_\_\_\_

11. Yield: Flow \_\_\_\_\_ G. M., Pump \_\_\_\_\_ G. M., Meas., Rept. Est.

Drawdown \_\_\_\_\_ ft. after \_\_\_\_\_ hours pumping \_\_\_\_\_ G. M.

12. Use: Dom., Stock PS., RR., Ind., Irr., Obs. \_\_\_\_\_

Adequacy, permanence \_\_\_\_\_

13. Quality MINERAL Temp \_\_\_\_\_ °F.

Taste, odor, color \_\_\_\_\_ Sample Yes No

Unfit for \_\_\_\_\_

14. Remarks: (Log, Analyses, etc.) \_\_\_\_\_

240

17. Remarks: (For your use only)

DATE

TIME

18. Name

Address

19. State

County

Section

Township

Range

Meridian

Section

Block

Lot

Sublot

Other

Remarks

Notes

Drawings

Photographs

Other

Remarks

Notes

Drawings

Photographs

Other

Remarks

Notes

Drawings

Photographs

Other

Remarks

Notes

Drawings

Photographs

Other

Remarks

Notes

Drawings

Photographs

Other

Remarks

Notes

Drawings

Photographs

Other

Remarks

Notes

Drawings

Photographs

Other

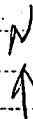

NO. 22

DATE

WELL

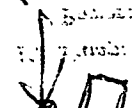

ST. 4

9 m. Am

6.5 S. 4

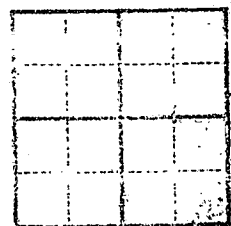

8.5 S. 8

U.S. 45

U.S. 45

ABERDEEN

WELL SCHEDULE

MINERAL INVESTIGATION DIVISION

U.S. GEOLOGICAL SURVEY

DEPARTMENT OF THE INTERIOR

WASHINGTON, D.C.

1920

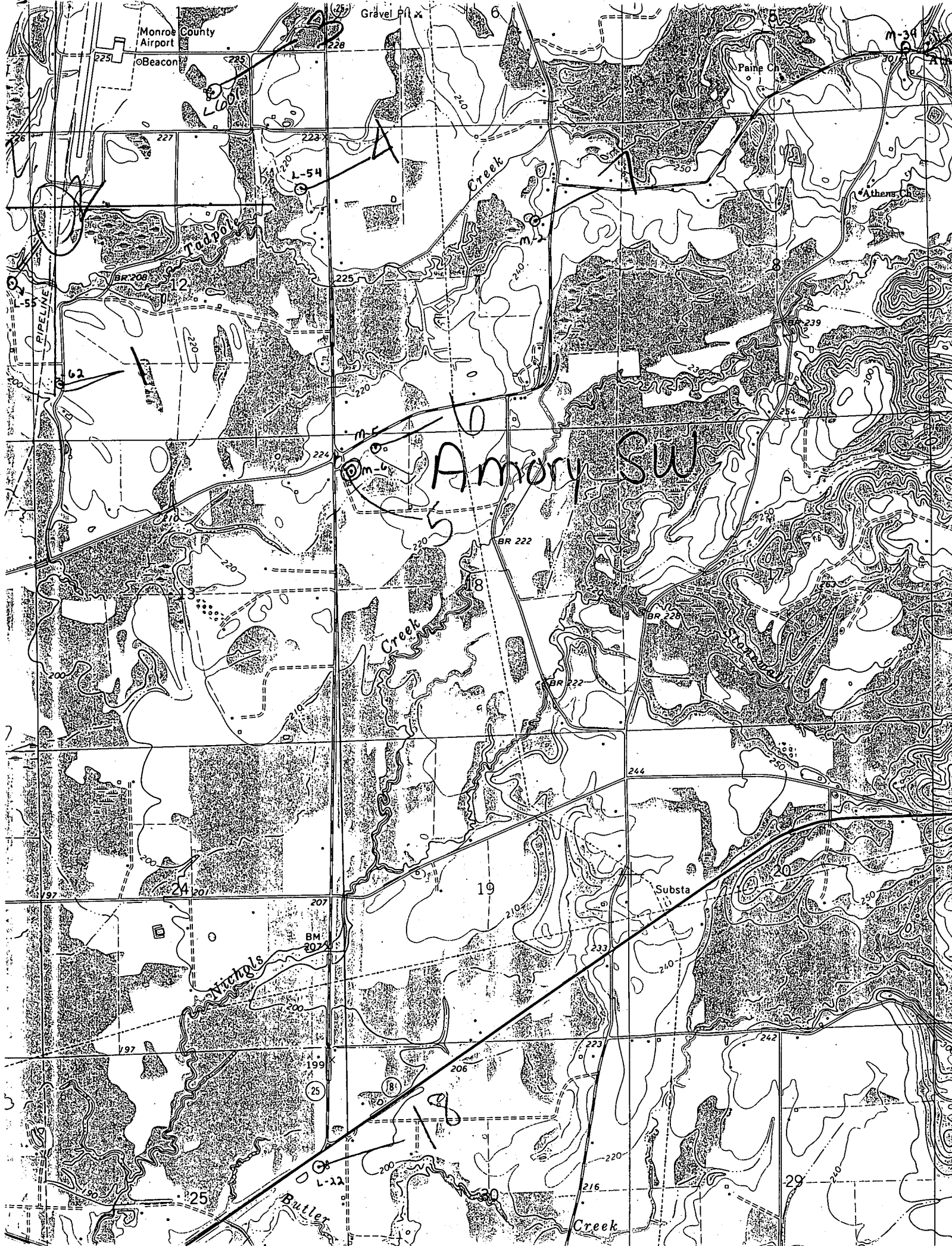

Monroe County  
Beacon

Gravel Pit

Paine Co

Athens Co

Amory SW

Substa

Nichols

Butler Creek

Creek

