

Observation Well

Aberdeen
PUNCHED

FORM 9-1642
(1-68)

P+A

Well No. L 73

III 0-2 1975

WELL SCHEDULE

E-log #102

U. S. DEPT. OF THE INTERIOR

GEOLOGICAL SURVEY

WATER RESOURCES DIVISION

MASTER CARD

WL Data
11/15/82
WL = 30.02
8/22/1987
27.52

Record by GJD Source of data Dr. E-log Date 4-10-75 Map ABERDEEN QUAD 1:24,000

State 28 County (or town) MONROE 48

Latitude: 33 49 10 N Longitude: 08 83 11 W

Lat-long accuracy: 3 T 14 R 7 W, Sec 36, SE & NW

Local well number: 4 07 30 B3 61 4S 07 E Other number: _____

Local use: 102 Owner or name: Bertron Hollowell, owner of land Address: phone 369-2377

Owner or name: USCE TTM AA Address: _____

Ownership: County, Fed Gov't, City, Corp or Co, Private, State Agency, Water Dist F

Use of water: (A) (B) (C) (D) (E) (F) (H) (I) (M) (N) (P) (R) U

Use of well: (A) (D) (G) (H) (I) (P) (R) (T) (U) (W) (X) (Z) Z Well destroyed 7/91

DATA AVAILABLE: Well data Freq. W/L meas.: Field aquifer char.

Hyd. lab. data:

Qual. water data; type: USGS 6/75

Freq. sampling: Pumpage inventory:

Aperture cards:

Log data: E-log 12-201

WELL-DESCRIPTION CARD

SAME AS ON MASTER CARD

Depth well: measured 4-22-75 ft 177 Meas. rept. 0

Depth cased; (first perf.) ft 167 Casing type: PVC; Diam. in 4

Finish: (C) porous concrete, (F) gravel w. (G) gravel w. (H) horiz. open (I) screen, (J) gallery, (K) end, (L) other S

Method Drilled: (A) air rot, (B) bored, (C) cable, (D) dug, (E) hyd jetted, (F) air rot., (G) percusson, (H) rotary, (I) reverse, (J) trenching, (K) driven, (L) drive wash, (M) other H

Date Drilled: 4-10-75 975 Pump intake setting: _____ ft _____

Driller: USCE, MOBILE, ALA.

Lift (type): (A) air, (B) bucket, (C) cent., (D) jet, (E) multiple, (F) multiple, (G) none, (H) piston, (I) rot., (J) submerg, (K) turb., (L) other W Deep Shallow

Power (type): (A) diesel, (B) elec, (C) gas, (D) gasoline, (E) hand, (F) gas, (G) wind, (H) H.P., (I) LP, (J) Trans. or meter no.

Descrip. MP Top of casing, 572 ft above below LSD, Alt. MP _____

Alt. LSD: 200 Accuracy: (source) 10' contour interval 4

Water Level 14.38 ft above below MP; Ft. below LSD 17 Accuracy: 4

Date mea: 4-22-75 475 Yield: _____ gpm Method determined _____

Drawdown: _____ ft Accuracy: _____ Pumping period _____ hrs _____

QUALITY OF WATER DATA: Iron _____ Sulfate _____ Chloride _____ Hard. _____

Sp. Conduct 160 K x 10⁶ 2 Temp. °F 18.5 Date sampled 6-10-75 675

Taste, color, etc. pH = 7.6

OCT 16 1975

OCT 16 1975
PUNCHED

Z Well destroyed 7/91

Well No.

L 73

HYDROGEOLOGIC CARD

SAME AS ON MASTER CARD Physiographic Province: 03 Section: _____

D Drainage Basin: 13K Subbasin: _____

Topo-of well site: (D) depression, stream channel, dunes, flat, hilltop, sink, swamp, (P) offshore, pediment, hillside, terrace, undulating, valley flat. 13K

MAJOR AQUIFER: system _____ series K3 aquifer, formation, group EZ

Lithology: U.S Origin: 6 Aquifer Thickness: _____ ft

Length of well open to: 1.5 ft Depth to top of: 1.0 ft 169

MINOR AQUIFER: system _____ series _____ aquifer, formation, group _____

Lithology: _____ Origin: _____ Aquifer Thickness: _____ ft

Length of well open to: _____ ft Depth to top of: _____ ft

Intervals Screened: 167-177' = 10' of 4" with .020" openings

Depth to consolidated rock: _____ ft Source of data: _____

Depth to basement: _____ ft Source of data: _____

Surficial material: _____ Infiltration characteristics: _____

Coefficient Trans: _____ gpd/ft Coefficient Storage: _____

Coefficient Perm: _____ gpd/ft²; Spec cap: _____ gpm/ft; Number of geologic cards: _____

Water level, 5-8-75 @ 1235
14.11' below 1st

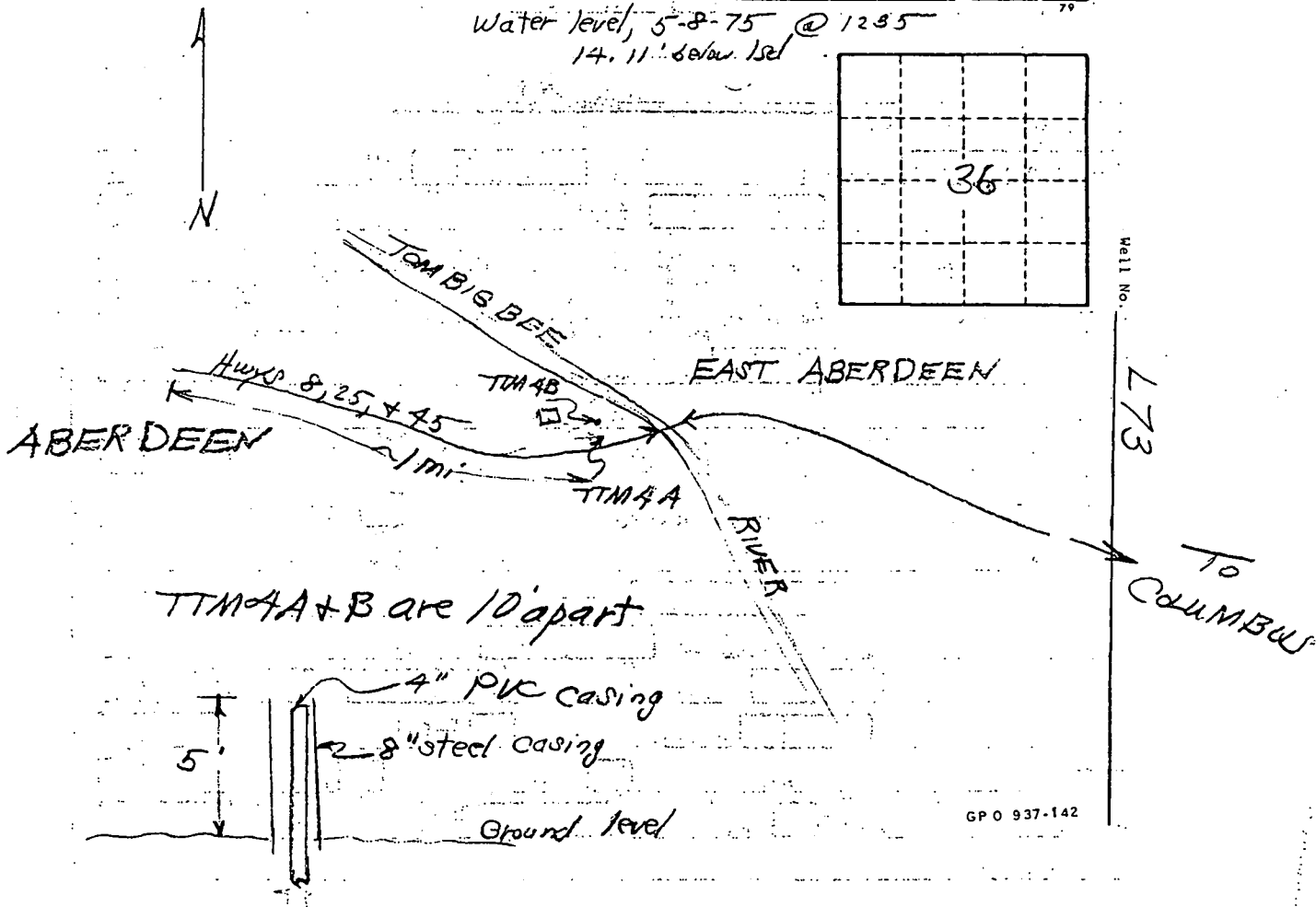

L-73

MISSISSIPPI DEPARTMENT OF ENVIRONMENTAL QUALITY
Bureau of Land and Water Resources

P.O. Box 10631
Jackson, Mississippi 39289-0631
WATER WELL PLUGGING
DECOMMISSIONING

| | |
|---------------------|--------------|
| COUNTY WELL LOCATED | MONROE |
| WELL NUMBER | 77M 4A |
| CODED | CLA |
| DATE WELL PLUGGED | 20 JULY 1991 |

| |
|-----------------------|
| PERMIT NUMBER |
| NAME OF DRILLING FIRM |

| |
|---|
| NAME & MAILING ADDRESS OF LANDOWNER |
| US ARMY CORPS OF ENG. DIST. MOBILE |
| P.O. BOX 2258 |
| MOBILE AL 36628 |
| WELL LOCATION SEC TOWNSHIP RANGE |
| NW 53 16 T 14 S R 07 E |
| DISTANCE DIRECTION NEAREST TOWN |
| OTHER LANDMARK |
| WELL PURPOSE: Home, Irrigation, Municipal, Industrial, Fish Pond, etc |
| GROUND WATER STUDY |

| | | |
|--|--------------------------|---|
| NAME OF WELL CONTRACTOR WHO DRILLED THE WELL | | |
| NAME OF LANDOWNER WHEN WELL WAS DRILLED | | |
| WELL DATA | | |
| Well Depth 177' | Casing Diameter (In.) 4" | Casing Length (Ft.) |
| Type of Casing PUC | Hole Depth | Depth to Static Water Level NOT TAKEN SEE BELOW |
| DATE WELL COMPLETED | | |

| |
|---|
| DESCRIBE HOW THE WELL OR HOLE WAS PLUGGED (AMOUNT OF CASING AND/OR SCREEN THAT WAS REMOVED, OR LEFT IN HOLE. MATERIAL USED IN PLUGGING, ETC.) |
| PORTLAND CEMENT MIX 1 BAG CEMENT TO 5.5 GALLONS WATER |
| PUMPED 16.2 C.F. GROUT IN WELL |
| WELL HAS HAD TRACH-PORFING ETC. DUMPED AROUND AREA AND |
| DOZER PUSHED 6" PROTECTOR PIPE AND GUARD POST DOWN - BROKE |
| RISER PIPE BELOW GROUND LEVEL AND SOME DEBRIS IN WELL |
| NOT ABLE TO WASH OUT. |

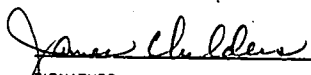
| | |
|---|-----------------|
| I CERTIFY THAT THE WELL WAS PLUGGED OR ABANDONED IN ACCORDANCE WITH THE STATE OF MISSISSIPPI REGULATIONS. | |
|  SIGNATURE | 7/20/91 DATE |

ITY
0631
ING
ING

ft.)
vel

ft

