

Aberdeen

Abert. 10/11

paA

FORM 9-1642 (1-68)

Well No. L 65

WELL SCHEDULE  
GEOLOGICAL SURVEY

(E log 86) **PUNCHED**  
WATER RESOURCES DIVISION

U. S. DEPT. OF THE INTERIOR

NOV 21 1972

MASTER CARD

WA Data  
11/16/82  
WL = 9.09  
8/19/1987  
WL = 5.62

Record by BEW & JUB Source of data Drill. logs Date 8/14/72 Map Aberdeen

State 28 County (or town) 48

Latitude: 33 51 22 N Longitude: 088 30 52 Sequential number: 1

Lat-long accuracy: 20 T 14 N 19 E Sec 10 NW t. SE t. SE t.

Local well number: 1065D1074S19W Other number: 8 & M

Local use: 086 Owner or name: USCEN 104A Address: \_\_\_\_\_

Ownership: County, Fed Gov't, City, Corp or Co, Private, State Agency, Water Dist F

Use of water: (A) Air cond, Bottling, Comm, Dewater, Power, Fire, Dom, Irr, Med, Ind, P S, Rec, (S) Stock, Instic, Unused, Repressure, Recharge, Desal-P S, Desal-other, Other U

Use of well: (A) Anode, Drain, Seismic, Heat Res, Obs, Oil-gas, Recharge, Test, Unused, Withdraw, Waste, Destroyed. U *Z Well destroyed 12/80*

DATA AVAILABLE: Well data  Freq. W/L meas.:  Field aquifer char.

Hyd. lab. data: \_\_\_\_\_

Qual. water data; type: C

Freq. sampling: \_\_\_\_\_ Pumpage inventory: \_\_\_\_\_

Aperture cards: \_\_\_\_\_

Log data: (E log 86) DE

WELL-DESCRIPTION CARD

SAME AS ON MASTER CARD Depth well: 146 ft Meas. rept 55 accuracy 1

Depth cased; (first perf.) ft 50 Casing type: PVC; Diam. in 4

Finish: (C) porous concrete, (F) gravel w. (perf.), (G) gravel w. (screen), (H) horiz. gallery, (P) open end, (S) perf., (T) screen, (W) sd. pt., (X) shored, (Z) other S

Method Drilled: (A) air rot, (B) bored, (C) cable, (D) dug, (H) hyd rot., (J) jetted, (P) air percussion, (R) reverse, (T) trenching, (V) driven, (W) drive wash, (Z) other J

Date Drilled: 9.7.2 Pump intake setting: \_\_\_\_\_ ft

Driller: \_\_\_\_\_

Lift (type): (A) air, (B) bucket, (C) cent., (J) jet, (L) multiple, (M) multiple, (N) none, (P) piston, (R) rot., (S) submerg, (T) turb., (Z) other  Deep  Shallow 40

Power (type): diesel, elec, gas, gasoline, hand, gas, wind; H.P.  Trans. or meter no. \_\_\_\_\_

Descrip. MP \_\_\_\_\_ ft above \_\_\_\_\_ ft below LSD, Alt. MP \_\_\_\_\_

Alt. LSD: 194 Accuracy: ± 2'

Water Level: 10.10 ft above \_\_\_\_\_ ft below MP \_\_\_\_\_ ft below LSD 110 Accuracy: \_\_\_\_\_

Date meas: 0.7.2 Yield: \_\_\_\_\_ gpm Method determined \_\_\_\_\_

Drawdown: \_\_\_\_\_ ft Accuracy: \_\_\_\_\_ Pumping period \_\_\_\_\_ hrs

QUALITY OF WATER DATA: Iron \_\_\_\_\_ ppm Sulfate \_\_\_\_\_ ppm Chloride \_\_\_\_\_ ppm Hard. \_\_\_\_\_ ppm

Sp. Conduct \_\_\_\_\_ K x 10<sup>6</sup> Temp. 158 Date sampled N 7 2

Taste, color, etc. \_\_\_\_\_

Well No.

Well No. \_\_\_\_\_

Latitude-longitude \_\_\_\_\_  
d m s d m s

HYDROGEOLOGIC CARD

RECORDED  
INDEXED  
STARS VON

MASTER CARD Physiographic Province: \_\_\_\_\_ Section: \_\_\_\_\_

Drainage Basin: D 13L Subbasin: \_\_\_\_\_

Topo of well site: (D) (C) (E) (F) (H) (K) (L) \_\_\_\_\_  
(O) (P) (S) (T) (U) (V) \_\_\_\_\_  
offshore, pediment, hillside, terrace, undulating, valley flat \_\_\_\_\_

MAJOR AQUIFER: \_\_\_\_\_ system \_\_\_\_\_ series K3 \_\_\_\_\_ aquifer, formation, group EZ

Lithology: \_\_\_\_\_ Origin: 6S \_\_\_\_\_ Aquifer Thickness: \_\_\_\_\_ ft

Length of well open to: \_\_\_\_\_ ft \_\_\_\_\_ Depth to top of: \_\_\_\_\_ ft \_\_\_\_\_

MINOR AQUIFER: \_\_\_\_\_ system \_\_\_\_\_ series \_\_\_\_\_ aquifer, formation, group \_\_\_\_\_

Lithology: \_\_\_\_\_ Origin: \_\_\_\_\_ Aquifer Thickness: \_\_\_\_\_ ft

Length of well open to: \_\_\_\_\_ ft \_\_\_\_\_ Depth to top of: \_\_\_\_\_ ft \_\_\_\_\_

Intervals Screened:

Depth to consolidated rock: \_\_\_\_\_ ft \_\_\_\_\_ Source of data: \_\_\_\_\_

Depth to basement: \_\_\_\_\_ ft \_\_\_\_\_ Source of data: \_\_\_\_\_

Surficial material: \_\_\_\_\_ Infiltration characteristics: \_\_\_\_\_

Coefficient Trans: \_\_\_\_\_ gpd/ft \_\_\_\_\_ Coefficient Storage: \_\_\_\_\_

Coefficient Perm: \_\_\_\_\_ gpd/ft<sup>2</sup>; Spec cap: \_\_\_\_\_ gpm/ft; Number of geologic cards: \_\_\_\_\_

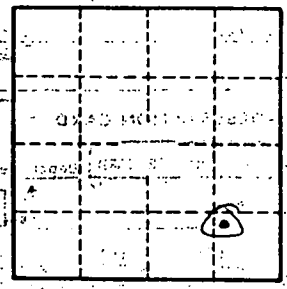
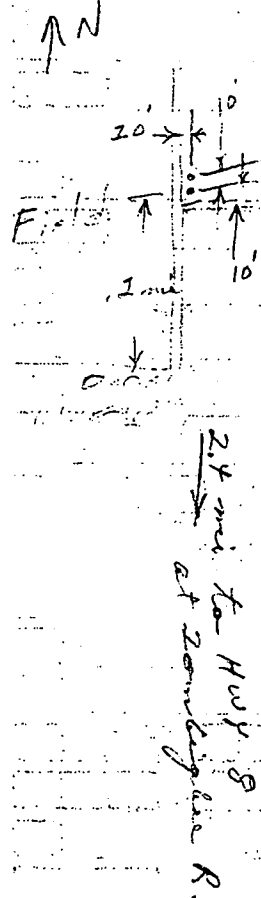

0-11 clay & sand  
11-28 sand  
28-30 clay  
30-60 clay & sand  
60-80 quartzite rock / sand  
80-130 Rock & clay -  
hard & soft seams

L-65

MISSISSIPPI DEPARTMENT OF ENVIRONMENTAL QUALITY  
Bureau of Land and Water Resources

P.O. Box 10631  
Jackson, Mississippi 39289-0631

WATER WELL PLUGGING  
DECOMMISSIONING

COUNTY WELL LOCATED MONROE	
WELL NUMBER 104A	CODED
DATE WELL PLUGGED 12-5-90	

PERMIT NUMBER
NAME OF DRILLING FIRM

NAME & MAILING ADDRESS OF LANDOWNER U.S. ARMY CORPS OF ENG. DIST. MOBILE P.O. Box 2288 MOBILE AL 36628			
WELL LOCATION	SEC	TOWNSHIP	RANGE
SESES 10 T 14 S R 19 W			
DISTANCE	DIRECTION	NEAREST TOWN	
OTHER LANDMARK			
WELL PURPOSE Home, Irrigation, Municipal, Industrial, Fish Pond, etc GROUND WATER STUDY			

NAME OF WELL CONTRACTOR WHO DRILLED THE WELL		
NAME OF LANDOWNER WHEN WELL WAS DRILLED		
WELL DATA		
Well Depth 55'	Casing Diameter (In.) 4"	Casing Length (Ft.)
Type of Casing PVC	Hole Depth	Depth to Static Water Level 2.7' TOP OF PIPE
DATE WELL COMPLETED		

DESCRIBE HOW THE WELL OR HOLE WAS PLUGGED (AMOUNT OF CASING AND/OR SCREEN THAT WAS REMOVED, OR LEFT IN HOLE. MATERIAL USED IN PLUGGING, ETC.)
PORTLAND CEMENT MIX 1 BAG CEMENT TO 5.5 GALLONS WATER
PUMPED 4.8 C.F. GROUT MIX IN WELL - WELL SCREEN AND RISER
PIPE LEFT IN HOLE - CUT RISER PIPE FLUSH WITH GROUND -
NO GUARD POST OR PROTECTOR PIPE

I CERTIFY THAT THE WELL WAS PLUGGED OR ABANDONED IN ACCORDANCE WITH THE STATE OF MISSISSIPPI REGULATIONS	
<u>James Childers</u> SIGNATURE	12-5-90 DATE

TY  
631  
NG  
NG

1 530 OC  
FEET  
3

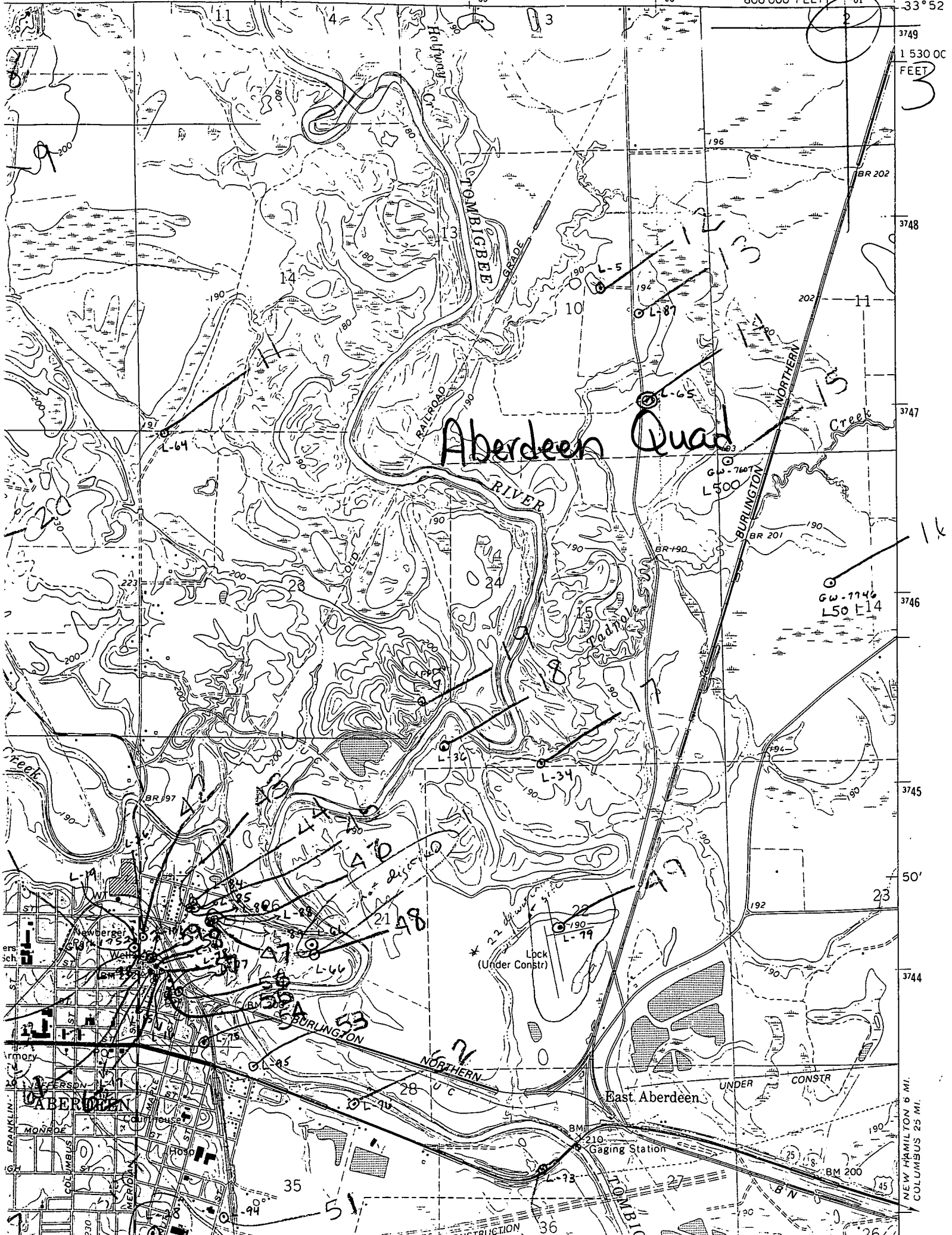

Aberdeen Quad

TOMBIGBEE RIVER

NORTHERN BURLINGTON

Lock (Under Constr)

East Aberdeen

ABERDEEN

MONROE

COLUMBUS

FRANKLIN

VERMONT

NEW HAMILTON 6 MI.  
COLUMBUS 25 MI.