

9-185
(October 1950)

UNITED STATES
DEPARTMENT OF THE INTERIOR
GEOLOGICAL SURVEY
WATER RESOURCES DIVISION

WELL SCHEDULE

Date AUG. 15, 1954 Field No. 54
Record by SMOVS - HITT Office No. MA 1193
Source of data RICHARD VAUGHN L 22

1. Location: State MISS County MONROE
Map MONROE CO. HIGHWAY

NE NW 1/4 SE 1/4 sec. 25 - T 14 N R 1193

2. Owner: MAHLON VAUGHN Address FACE ROFFEN
Tenant _____ Address _____
Driller _____ Address _____

3. Topography FLAT

4. Elevation 202 ft. above
below

5. Type: Dug drilled driven, bored, jetted 1920?

6. Depth: Rept. 350 ft. Meas. _____ ft.

7. Casing: Diam. 4 in., to _____ in., Type _____
Depth _____ ft., Finish _____

8. Chief Aquifer Rtg From _____ ft. to _____ ft.
Others _____

9. Water level 3.9 ft. rept. 19 54 above
3.0 ft. meas. below
11/30/78 which is _____ ft. above surface
8.52 below surface

10. Pump: Type _____ Capacity _____ G. M.
Power: Kind _____ Horsepower _____

11. Yield: Flow 1 GAL - 7.5 G. M., Pump 7.5 G. M., Meas., Rept. Est.
Drawdown _____ ft. after _____ hours pumping _____ G. M.

12. Use: Dom., Stock, PS., RR., Ind., Irr., Obs. _____
Adequacy, permanence _____

13. Quality IRON CONTN Temp 66 °F.
Taste, odor, color _____ Sample Yes
Unfit for _____

14. Remarks: (Log, Analyses, etc.) _____

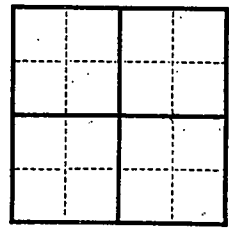

IT (continued from previous page)

REF: 102

Investigation of

of the

of the

of the

of the

of the

of the

of the

of the

of the

of the

of the

of the

of the

of the

of the

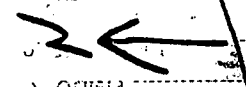
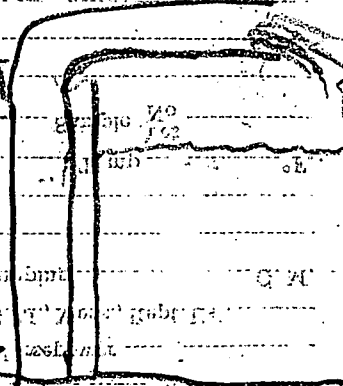

MISSISSIPPI

MISSISSIPPI

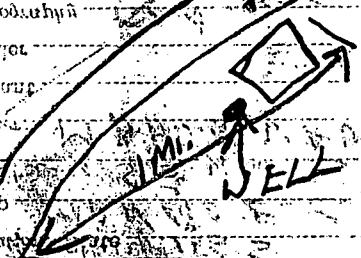

BERDELL ← U.S.A.

Section of the

MISSISSIPPI DIVISION

MEMPHIS OFFICE

FEDERAL BUREAU OF INVESTIGATION

MEMPHIS, TENNESSEE

3251 / SE (ABERDEEN) 2.7 MI.

T. 14 S
T. 15 S

3741

T14 S
T15 S

BM 221

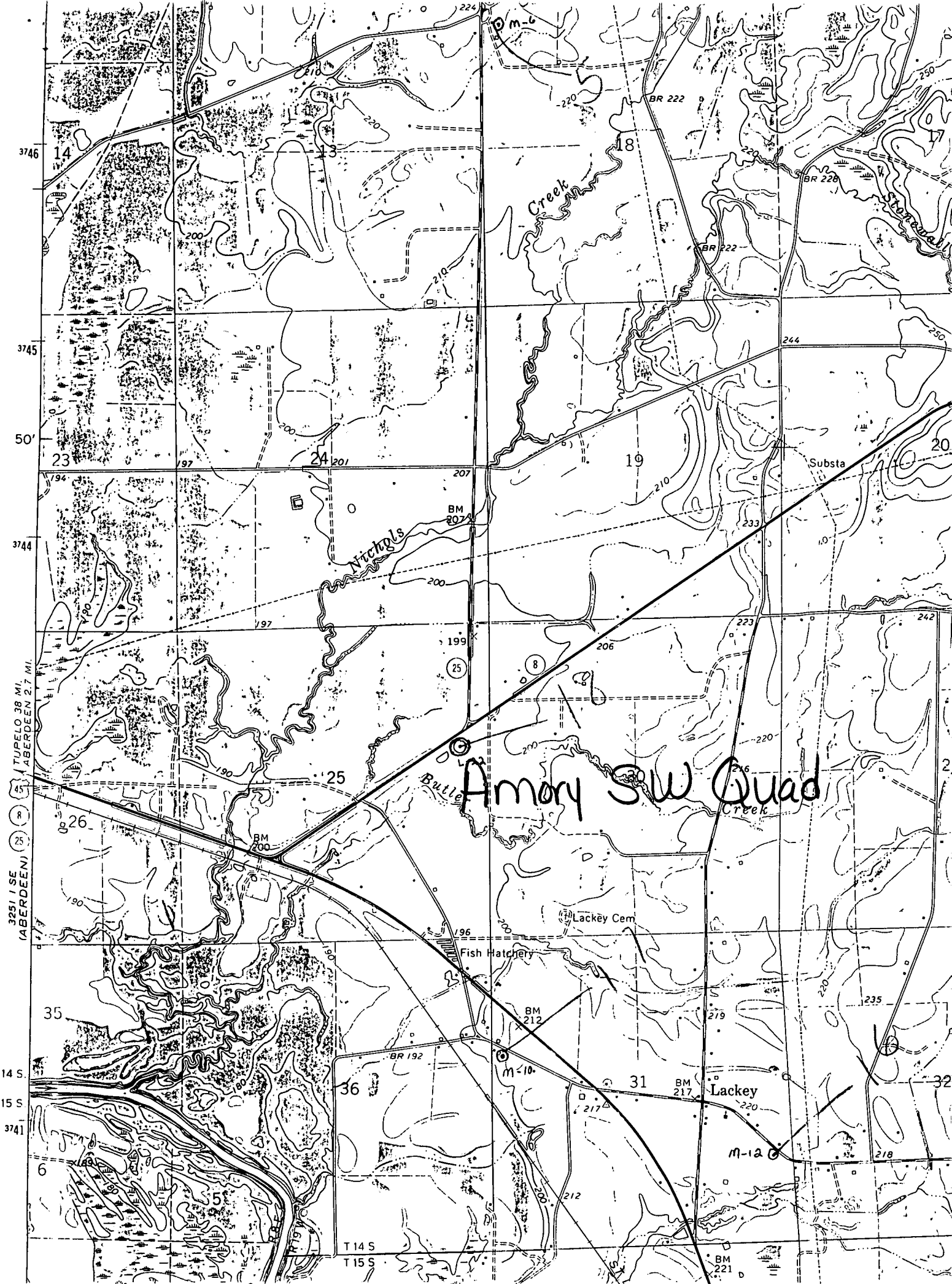

Amory SW Quad

Creek

Nichols

Butte

Creek

Lackey Cem

Fish Hatchery

Lackey

14

18

23

24

19

20

26

35

36

31

32

6

5

4

3

2

1

10

9

8

7

6

5

4

3

2

1

3746

3745

3744

3743

3742

3741

m-6

BR 222

BR 228

BR 222

244

Substa

BM 207

199

25

8

206

223

242

BM 200

196

BM 212

BR 192

m-10

BM 217

217

m-12

218

BM 221