

9-185  
(October 1950)

UNITED STATES  
DEPARTMENT OF THE INTERIOR  
GEOLOGICAL SURVEY  
WATER RESOURCES DIVISION

240  
- 72  
---  
168

WELL SCHEDULE

Date Aug. 29, 19 56 Field No. 16  
Record by SHOWS-HITT Office No. 212  
Source of data H. E. NASON

1. Location: State MISS County MONROE  
Map MONROE CO. HIGHWAY  
NW NW 1/4 NE 1/4 sec. 39 T 14 N R 7 W  
2. Owner: H. E. NASON Address ABERDEEN, MISS  
Tenant \_\_\_\_\_ Address \_\_\_\_\_  
Driller: REEVES Address AMORT

3. Topography \_\_\_\_\_  
4. Elevation 240 ft. above Sea  
below \_\_\_\_\_  
5. Type: Dug (drilled) driven, bored, jetted \_\_\_\_\_ 19 53  
6. Depth: Rept. 250 ft. Meas. \_\_\_\_\_ ft.  
7. Casing: Diam. 4 in., to \_\_\_\_\_ in., Type \_\_\_\_\_  
Depth 250 ft., Finish STRAINER

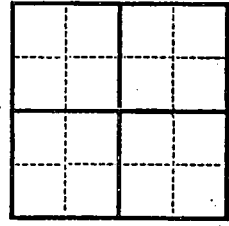

8. Chief Aquifer \_\_\_\_\_ From \_\_\_\_\_ ft. to \_\_\_\_\_ ft.  
Others \_\_\_\_\_  
9. Water level 30 ft. (rept. meas.) 19 56 above (below) ft. above (below) surface  
which is \_\_\_\_\_ ft. above (below) surface  
10. Pump: Type SUBMERGIBLE Capacity \_\_\_\_\_ G. M.  
Power: Kind ELEC. Horsepower ?  
11. Yield: Flow \_\_\_\_\_ G. M., Pump \_\_\_\_\_ G. M., Meas., Rept. Est. \_\_\_\_\_  
Drawdown \_\_\_\_\_ ft. after \_\_\_\_\_ hours pumping \_\_\_\_\_ G. M.  
12. Use: (Dom., Stock) PS., RR., Ind., Irr., Obs. \_\_\_\_\_  
Adequacy, permanence \_\_\_\_\_  
13. Quality GOOD - SOFT Temp \_\_\_\_\_ °F.  
Taste, odor, color \_\_\_\_\_ Sample (Yes NO)  
Unfit for \_\_\_\_\_

14. Remarks: (Log, Analyses, etc.) 75-12.32

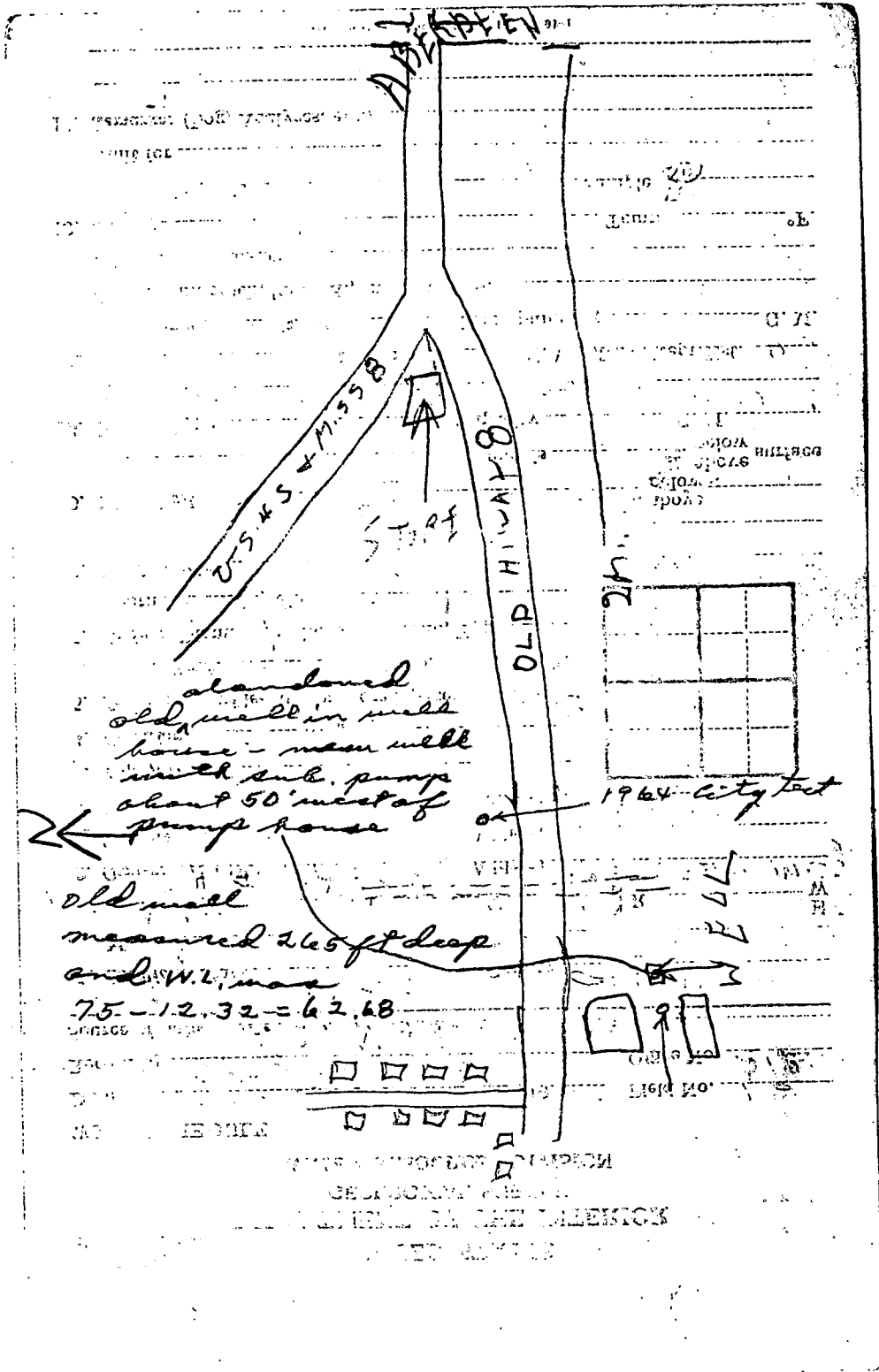

abandoned  
old well in well  
house - near well  
with sub. pump  
about 50' west of  
pump house

old well  
measured 265 ft deep  
and W.L. was  
75 - 12.32 = 62.68

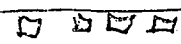
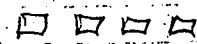
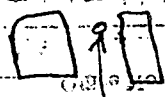
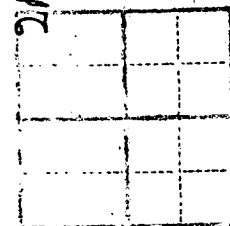

UNITED STATES GEOLOGICAL SURVEY  
WATER RESOURCES DIVISION  
BIRMINGHAM, ALABAMA

