

Observation Well

FORM 9-1642 (1-68)

Well No. H 17

PUNCHED

WELL SCHEDULE

E-109 # 103

JUL 02 1975

U. S. DEPT. OF THE INTERIOR

GEOLOGICAL SURVEY

WATER RESOURCES DIVISION

1:24, 000 16 1975

MASTER CARD

Water Level Data 11/14/75 = 13.92

Record by GJD, Source of data E-109, Date 5-8-75, State 28, County MONROE, Latitude 33 54 45 N, Longitude 08 83 12 W, Local well number H 0 1 7 D C 2 2 1 3 S 1 9 W, Local use 103, Owner or name USCE TTM 5A, Address Amory, MS

Ownership: County, Fed Gov't, City, Corp or Co, Private, State Agency, Water Dist F

Use of water: Air cond, Bottling, Comm, Dewater, Power, Fire, Dom, Irr, Med, Ind, P S, Rec U

Stock, Instit, Unused, Repressure, Recharge, Desal-P S, Desal-other, Other U

Use of well: Anode, Drain, Seismic, Heat Res, Obs, Oil gas, Recharge, Test, Unused, Withdraw, Waste, Destroyed O

DATA AVAILABLE: Well data, Freq. W/L meas., Field aquifer char.

Hyd. lab. data:

Qual. water data; type: USBS 6/75

Freq. sampling: Pumpage inventory: no, period:

Aperture cards: yes

Log data: E-109: 7-131 ft. D/E

WELL-DESCRIPTION CARD

SAME AS ON MASTER CARD, Depth well: 90 ft, Meas. rept accuracy

Depth cased; (first perf.) 80 ft, Casing type: PVC, Diam. in

Finish: porous concrete, gravel w. gravel w. horiz. open perf., screen, sd. pt., shored, open hole, other P

Method Drilled: air bored, cable, dug, hyd jetted, air reverse trenching, driven, drive rot, rot, percussion, rotary, other H

Date Drilled: 5-8-75, 9 7 5, Pump intake setting: ft

Driller: US CORPS OF ENGINEERS, MOBILE, ALA.

Lift (type): air, bucket, cent, jet, multiple, multiple, none, piston, rot, submerg, turb, other N Deep Shallow

Power (type): diesel, elec, gas, gasoline, hand, gas, wind; H.P., Trans. or meter no.

Descrip. MP top of 4" PVC casing, 5.0 ft above below LSD, Alt. MP

Alt. LSD: 2.00 Accuracy: (source) 10' contour interval 4

Water Level 17.61 ft above below MP; Ft above below LSD 10 Accuracy: A

Date meas: 5-14-75, 5 7 5, Yield: gpm, Method determined

Drawdown: ft, Accuracy: Pumping period hrs

QUALITY OF WATER DATA: Iron, Sulfate, Chloride, Hard.

Sp. Conduct 130 K x 10^6, Temp. 18.5, Date sampled 6-11-75, 6 7 5

Taste, color, etc. pH = 8.4

Latitude-longitude _____
 d m s d m s

HYDROGEOLOGIC CARD

SAME AS ON MASTER CARD Physiographic 0:3 Section: _____
 Province: _____
D Drainage Basin: 134 Subbasin: _____
 (D) (C) (E) (F) (H) (K) (L)
 Topo. of depression, stream channel, dunes, flat, hilltop, sink, swamp,
 well site: (P) (S) (T) (U) (V) _____
 offshore, pediment, hillside, terrace, undulating, valley flat _____
 MAJOR K3 E2
 AQUIFER: _____ system _____ series _____ aquifer, formation, group _____
 Lithology: _____ Origin: _____ 6 Aquifer Thickness: _____ ft
 Length of well open to: _____ ft _____ Depth to top of: _____ ft _____
 MINOR _____
 AQUIFER: _____ system _____ series _____ aquifer, formation, group _____
 Lithology: _____ Origin: _____ Aquifer Thickness: _____ ft
 Length of well open to: _____ ft _____ Depth to top of: _____ ft _____
 Intervals Screened:
 Depth to consolidated rock: _____ ft _____ Source of data: _____
 Depth to basement: _____ ft _____ Source of data: _____
 Surficial material: _____ Infiltration characteristics: _____
 Coefficient Trans: _____ gpd/ft _____ Coefficient Storage: _____
 Coefficient Perm: _____ gpd/ft²; Spec cap: _____ gpm/ft; Number of geologic cards: _____

Owner lives in house close to well.
 G. R. Earnest
 Rt. 1
 Box 253
 Amory, MS
 Phone 256-7766

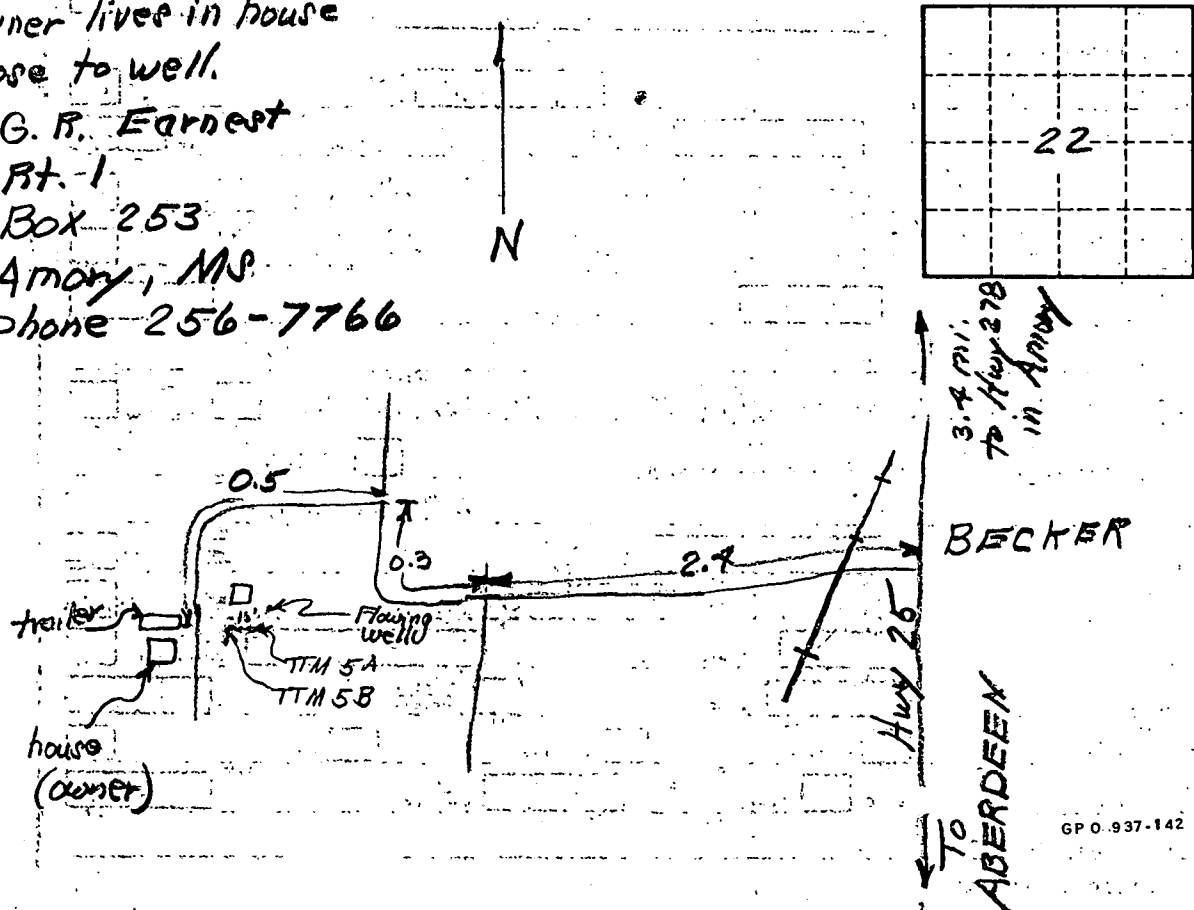

Well No. _____

H17