

9-185
(October 1950)

UNITED STATES
DEPARTMENT OF THE INTERIOR
GEOLOGICAL SURVEY
WATER RESOURCES DIVISION

WELL SCHEDULE

Date AUG. 30, 19 50 Field No. A7
Record by SHOWS - HITT Office No. 67
Source of data Mrs. J. E. DILWORTH

1. Location: State MISS County MANROE
Map MANROE Co. HIGHWAY
SE NW 1/4 NE 1/4 sec. 13 T 13 N 8 W
2. Owner: Mrs. J. E. DILWORTH Address AMORY, RT. 1,
Tenant _____ Address _____
Driller WILL REEVES Address _____

3. Topography FLAT
4. Elevation 235 ft. above
below
5. Type: Dug, drilled, driven, bored, jetted _____ 19 40
6. Depth: Rept. 280 ± ft. Meas. _____ ft.
7. Casing: Diam. 3 in., to _____ in., Type _____
Depth _____ ft., Finish OPEN

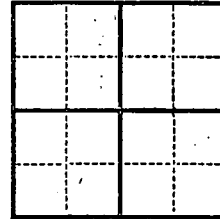

8. Chief Aquifer _____ From _____ ft. to _____ ft.
Others _____

9. Water level _____ ft. rept. _____ 19 _____ above
meas. _____ below
which is _____ ft. above
below surface

10. Pump: Type FLOWING Capacity _____ G. M.
Power: Kind PRESSURE Horsepower _____

11. Yield: Flow _____ G. M., Pump _____ G. M., Meas., Rept. Est.
Drawdown _____ ft. after _____ hours pumping _____ G. M.

12. Use: Dom. Stock, PS., RR., Ind., Irr., Obs. _____
Adequacy, permanence _____

13. Quality MINERAL - RED Temp _____ °F.
Taste, odor, color _____ Sample Yes
No

14. Remarks: (Log, Analyses, etc.) _____

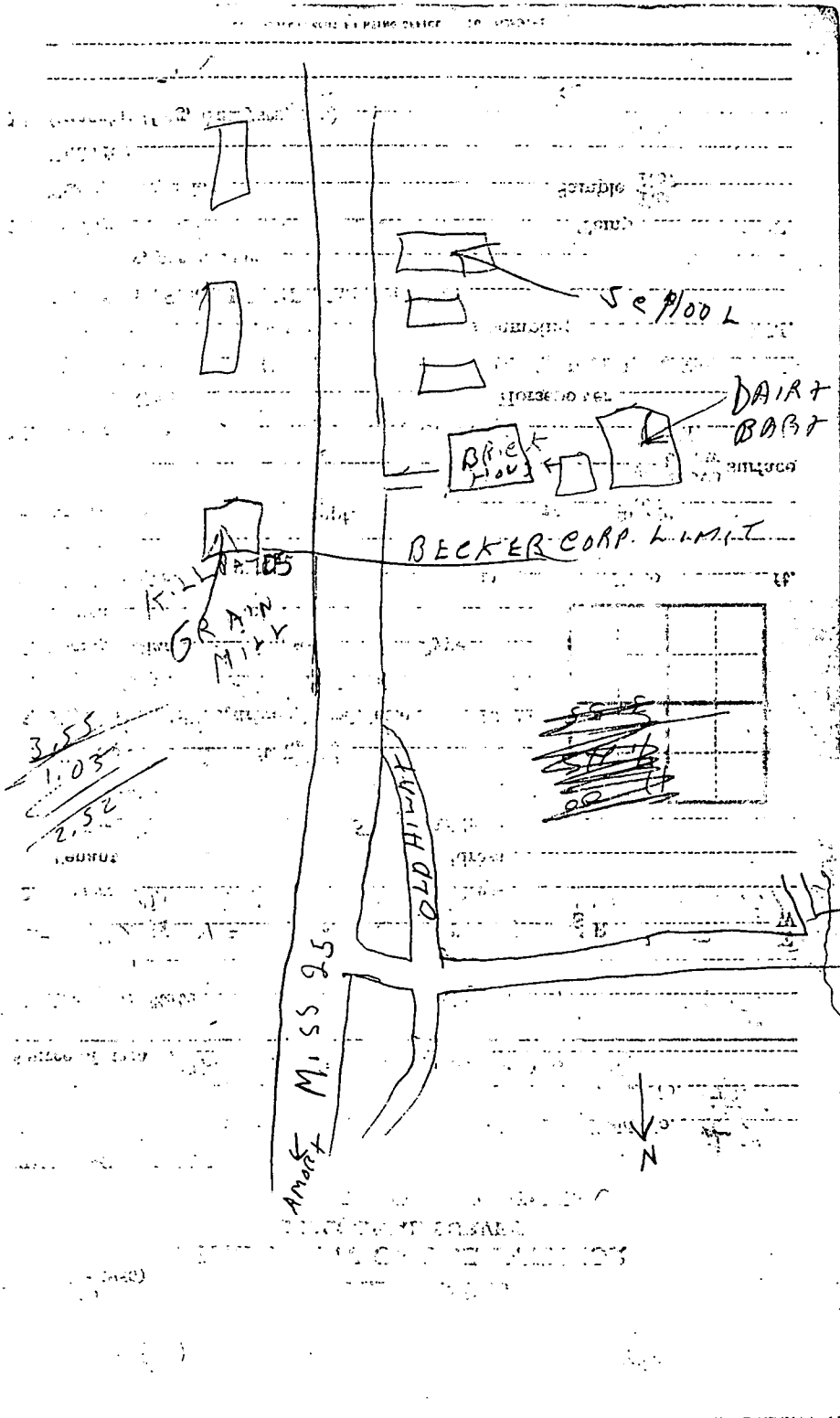

57°30"
3758
3757
3251 N.E. (WREN)
3755
3754
55'
3753
26

Gregory's Chapel

Amory Quad

Becker

Weaver Creek

Creek

Branch

Greenbrier Cem

Calvary Ch

Greenbrier
NORTHERN

11

14

23

26

13

25

40

18

25

17

20

29

G-1

BM 237

BM 235

H-12

H-14

O-20

288

30

246

203

270

280

288

290

250

251

250

250

250

250

250

250

250

250

250

250

250

250

227

220

250

250

250

250

250

250

250

250

250

250

250

250

250

250

250

250

250

250

250

210

226

230

230

230

230

230

230

230

230

230

230

230

230

230

230

230

230

230

230

230

210

210

210

210

210

210

210

210

210

210

210

210

210

210

210

210

210

210

210

210

210

210

220

220

220

220

220

220

220

220

220

220

220

220

220

220

220

220

220

220

220

220

207

220

220

220

220

220

220

220

220

220

220

220

220

220

220

220

220

220

220

220

220

200

220

220

220

220

220

220

220

220

220

220

220

220

220

220

220

220

220

220

220

220

200

220

220

220

220

220

220

220

220

220

220

220

220

220

220

220

220

220

220

220

220

200

220

220

220

220

220

220

220

220

220

220

220

220

220

220

220

220

220

220

220

220