

F 13

WELL SCHEDULE

PUNCHED

U. S. DEPT. OF THE INTERIOR

GEOLOGICAL SURVEY

WATER RESOURCES DIVISION

MASTER CARD

Water Level Data

1 1987

WL = 123.75

Record by J.S. Source of data Bowc Date 3/70 Map MAR 11 1973

State 28 County (or town) Monroe 48

Latitude: 33° 59' 01" N Longitude: 088° 40' 02" W Sequential number: 1

Lat-long accuracy: 3 T. 13 S. R. 66 E. Sec. 8 T. NE E. NE

Local well number: F013AA0413506E Other number: _____

Local use: 021 Owner or name: J. B. HOWELL Address: Rt 1, Okolona

Ownership: County, Fed Gov't, City, Corp or Co, Private, State Agency, Water Dist. P

Use of water: Air cond, Bottling, Comm, Dewater, Power, Fire, Dom, Irr, Med, Ind, P S, Rec, Stock, Instit, Unused, Repressure, Recharge, Desal-P S, Desal-other, Other H

Use of well: Anode, Drain, Seismic, Heat Res, Obs, Oil-gas, Recharge, Test, Unused, Withdraw, Waste, Destroyed. W

DATA AVAILABLE: Well data Freq. W/L meas.: Field aquifer char.

Hyd. lab. data: _____

Qual. water data: type: _____

Freq. sampling: _____ Pumpage inventory: yes no. period: _____

Aperture cards: _____

Log data: D

WELL-DESCRIPTION CARD

10/29/78 WL = 122.90

SAME AS ON MASTER CARD Depth well: 340 ft Meas. rept accuracy 3

Depth cased: 23 ft Casing type: Steel Diam. in 5

Finish: porous concrete, gravel v. concrete, (perfl.), (screen), gravel v. (screen), gallery, and, horiz. open perf., (T) screen, sd. pt., shored, other X

Method: air bored, cable, dug, rot., hyd jetted, air percussion, rotary, reverse trenching, driven, drive wash, other H

Date Drilled: 9:70 Pump intake setting: _____ ft

Driller: _____ name address

Lift (type): air, bucket, cent, jet, multiple, (cent.), multiple, (turb.), none, piston, rot, submerg, turb, other Deep Shallow

Power (type): diesel, elec, gas, gasoline, hand, gas, wind, E.P. Trans. or meter no. _____

Descrip. MP ELU would be 305 ft above LSD, Alt. MP 295 is right ft below LSD

Alt. LSD: 295 Accuracy: _____

Water Level 105 ft above below MP; Ft 105 LSD Accuracy: _____

Date meas: 2:70 Yield: _____ gpm Method determined _____

Drawdown: _____ ft Accuracy: _____ Pumping period _____ hrs

QUALITY OF WATER DATA: Iron _____ Sulfate _____ Chloride _____ Hard. _____

Sp. Conduct _____ K x 10⁶ Temp. _____ °F Date sampled _____

Taste, color, etc. _____

Well No.

13

Well No. F 13

PUNCHED

Latitude-longitude N
S

HYDROGEOLOGIC CARD

SEE 45 ON MASTER CARD Physiographic Province: _____ Section: 03

D Drainage Basin: 132 Subbasin: _____

Topo of well site: (D) depression, stream channel, dunes, flat, hilltop, sink, swamp, (E) offshore, pediment, hillside, terrace, undulating, valley flat

MAJOR AQUIFER: _____ system _____ series K3 _____ aquifer, formation, group EZ

Lithology: _____ Origin: 6 Aquifer Thickness: 140 ft

Length of well open to: _____ ft _____ Depth to top of: _____ ft 200

MINOR AQUIFER: _____ system _____ series _____ aquifer, formation, group _____

Lithology: _____ Origin: _____ Aquifer Thickness: _____ ft

Length of well open to: _____ ft _____ Depth to top of: _____ ft _____

Intervals Screened: _____

Depth to consolidated rock: _____ ft _____ Source of data: _____

Depth to basement: _____ ft _____ Source of data: _____

Surficial material: _____ Infiltration characteristics: _____

Coefficient Trans: _____ gpd/ft _____ Coefficient Storage: _____

Coefficient Perm: _____ gpd/ft²; Spec cap: _____ gpm/ft; Number of geologic cards: _____

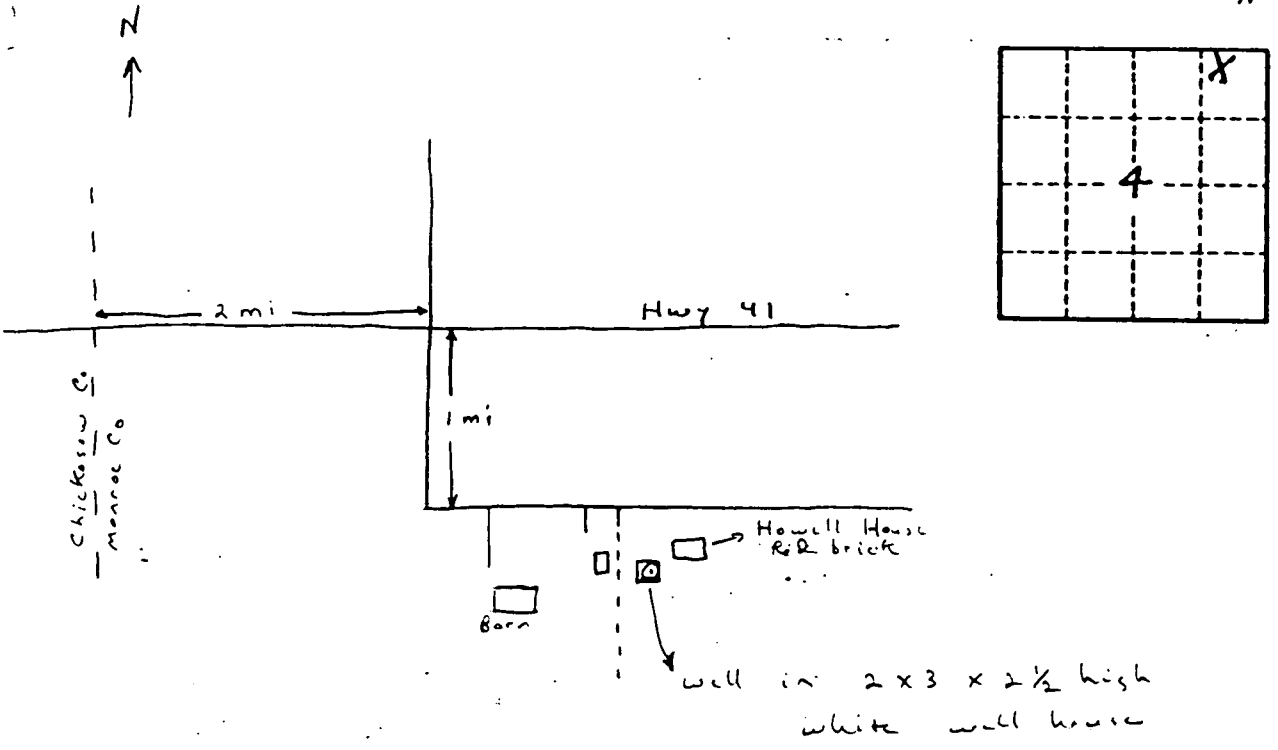

Well No. F 13