

add del  
11/24/76

FORM 9-1642  
(1-68)

Well No. D 22

WELL SCHEDULE  
GEOLOGICAL SURVEY

E log #67 **PUNCHED**  
WATER RESOURCES DIVISION

U. S. DEPT. OF THE INTERIOR

MAR 11 1973

MASTER CARD

Record by Q Source of data Bowc Obs: driller Date 4-14-72 Map 4.8

State MISS County (or town) MONROGE

Latitude: 34° 03' 59" N Longitude: 080° 23' 48" W Sequential number: 1

Lat-long accuracy: 20' T 12" S R 90' Sec 6 NW SW SE NW

Local well number: D022CB0612309E Other number: B & H

Local use: 021067 Owner or name: SMITHVILLE Address: \_\_\_\_\_

Ownership: County, Fed Gov't, City, Corp or Co, Private, State Agency, Water Dist M

Use of water: (A) Air cond, (B) Bottling, (C) Comm, (D) Dewater, (E) Power, (F) Fire, (G) Irr, (H) Med, (I) P S, (J) Rec, (K) Stock, (L) Inscit, (M) Unused, (N) Repressure, (O) Recharge, (P) Desal-P, (Q) Desal-other, (R) Other P

Use of well: (A) Anode, (B) Drain, (C) Seismic, (D) Heat Res, (E) Obs, (F) Oil-gas, (G) Recharge, (H) Test, (I) Unused, (J) Withdraw, (K) Waste, (L) Destroyed W

DATA AVAILABLE: Well data  Freq. W/L meas.:  Field aquifer char.

Hyd. lab. data:

Qual. water data: type: \_\_\_\_\_

Freq. sampling:  Pumpage inventory:  yes no period: \_\_\_\_\_

Aperture cards:  yes

Log data: Elog 4-235 DE

WELL-DESCRIPTION CARD

SAME AS ON MASTER CARD

Depth well: 119.8 ft Meas. rept accuracy 3

Depth cased: (first perf.) 115.8 ft Casing type: \_\_\_\_\_; Diam. 8x4 in 8

Finish: (C) porous concrete, (F) gravel w. (perf.), (G) (screen), (H) horiz. gallery, (I) open end, (J) open hole, (K) other S

Method Drilled: (A) air rot, (B) bored, (C) cable, (D) dug, (E) hyd jetted, (F) air rot., (G) percussion, (H) rotary, (I) reverse, (J) trenching, (K) driven, (L) drive wash, (M) other H

Date Drilled: 4-14-72 972 Pump intake setting: \_\_\_\_\_ ft 36 38

Driller: HERNDON DRLC Co. SHANNON MISS.

Lift (type): (A) air, (B) bucket, (C) cent, (D) jet, (E) multiple, (F) multiple, (G) none, (H) piston, (I) rot, (J) submerg, (K) turb, (L) other T Deep  Shallow

Power (type): (A) diesel, (B) elec, (C) gas, (D) gasoline, (E) hand, (F) gas, (G) wind, (H) H.P. 7 1/2 U Trans. or meter no. \_\_\_\_\_

Descrip. MP 5 ft above below LSD, Alt. MP

Alt. LSD: 26.0 Accuracy: topo 4

Water Level 33.2/19/79 ft above below MP; Ft above below LSD 7.5 Accuracy: \_\_\_\_\_ D

Date meas: 8.7.2 Yield: \_\_\_\_\_ gpm 150 Method determined \_\_\_\_\_

Drawdown: \_\_\_\_\_ ft Accuracy: \_\_\_\_\_ Pumping period \_\_\_\_\_ hrs \_\_\_\_\_

QUALITY OF WATER DATA: Iron \_\_\_\_\_ ppm Sulfate \_\_\_\_\_ ppm Chloride \_\_\_\_\_ ppm Hard. \_\_\_\_\_ ppm

Sp. Conduct \_\_\_\_\_ K x 10 \_\_\_\_\_ Temp. \_\_\_\_\_ °F Date sampled \_\_\_\_\_

Taste, color, etc. \_\_\_\_\_

1992  
21.0

Well No.

Well No. \_\_\_\_\_

Latitude-longitude \_\_\_\_\_  
d m s d m s

**PHYSIOLOGIC CARD**

18 SAME AS ON MASTER CARD

19 Physiographic Province: \_\_\_\_\_

20 03 21

Section: \_\_\_\_\_

22 D

Drainage Basin: \_\_\_\_\_

23 138 24

Subbasin: \_\_\_\_\_

25 MAR 1 1952

26 (D) (C) (E) (F) (H) (K) (L)  
Topo of depression, stream channel, dunes, flat, hilltop, sink, swamp,  
well site: \_\_\_\_\_

(0) (P) (S) (T) (U) (V)  
offshore, pediment, hillside, terrace, undulating, valley flat \_\_\_\_\_

27 MAJOR

AQUIFER: \_\_\_\_\_

system \_\_\_\_\_

series \_\_\_\_\_

28 K3 29

aquifer, formation, group \_\_\_\_\_

30 60 31

Lithology: \_\_\_\_\_

32 6 33

Origin: \_\_\_\_\_

34 Z

Aquifer

Thickness: \_\_\_\_\_

120 ft

35 120 36

Length of well open to: \_\_\_\_\_

ft 37 40

Depth to top of: \_\_\_\_\_

ft 38 70 39

40 MINOR

AQUIFER: \_\_\_\_\_

system \_\_\_\_\_

series \_\_\_\_\_

41 \_\_\_\_\_ 42

aquifer, formation, group \_\_\_\_\_

43 \_\_\_\_\_ 44

Lithology: \_\_\_\_\_

45 \_\_\_\_\_ 46

Origin: \_\_\_\_\_

47 \_\_\_\_\_

Aquifer

Thickness: \_\_\_\_\_

ft

48 \_\_\_\_\_ 49

Length of well open to: \_\_\_\_\_

ft 50 \_\_\_\_\_ 51

Depth to top of: \_\_\_\_\_

ft 52 \_\_\_\_\_ 53

54 Intervals

Screened: \_\_\_\_\_

55 Depth to

consolidated rock: \_\_\_\_\_

ft \_\_\_\_\_ 56

Source of data: \_\_\_\_\_

64 \_\_\_\_\_

57 Depth to

basement: \_\_\_\_\_

ft \_\_\_\_\_ 58

Source of data: \_\_\_\_\_

69 \_\_\_\_\_

59 Surficial

material: \_\_\_\_\_

60 \_\_\_\_\_ 61

Infiltration

characteristics: \_\_\_\_\_

73 \_\_\_\_\_

62 Coefficient

Trans: \_\_\_\_\_

gpd/ft \_\_\_\_\_ 63

Coefficient

Storage: \_\_\_\_\_

76 \_\_\_\_\_ 77

64 Coefficient

Perm: \_\_\_\_\_

gpd/ft<sup>2</sup>; Spec cap: \_\_\_\_\_

gpm/ft; Number of geologic cards: \_\_\_\_\_

79

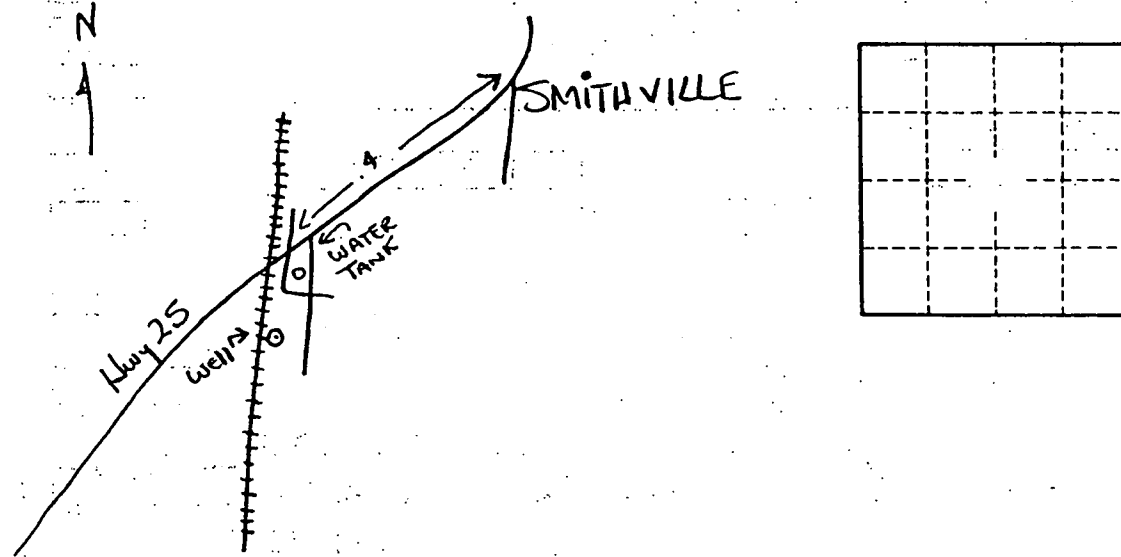

Well No. \_\_\_\_\_