

9-185  
(October 1950)

UNITED STATES  
DEPARTMENT OF THE INTERIOR  
GEOLOGICAL SURVEY  
WATER RESOURCES DIVISION

WELL SCHEDULE

Date JULY 19, 1961 Field No. \_\_\_\_\_  
Record by B. E. ELISON Office No. D5  
Source of data F. C. DUNCAN, TOWN MARSHAL

1: Location: State MISS County MONROE

Map SE 1/4 NW 1/4 sec. 6 T 12 N R 9

2: Owner TOWN OF SMITHVILLE Address SMITHVILLE, MISS.

Tenant \_\_\_\_\_ Address \_\_\_\_\_

Driller LYNNE-CONCRETE Address MEMPHIS, TENN.

3: Topography PLAINE

4: Elevation 260 ft. above \_\_\_\_\_  
\_\_\_\_\_ ft. below \_\_\_\_\_

5: Type: Dug  drilled  driven, bored, jetted \_\_\_\_\_ 1961

6: Depth: Rept. 179 ft. Meas. \_\_\_\_\_ ft.

7: Casing: Diam. 8 in., to \_\_\_\_\_ in., Type \_\_\_\_\_  
Depth 153 ft., Finish 6" X 20' 2" SUE

8: Chief Aquifer KTG ? From \_\_\_\_\_ ft. to \_\_\_\_\_ ft.  
Others 16-505 1099 412364

9: Water level \_\_\_\_\_ ft. rept. \_\_\_\_\_ 1961 above \_\_\_\_\_  
\_\_\_\_\_ below \_\_\_\_\_  
\_\_\_\_\_ which is \_\_\_\_\_ ft. above surface  
\_\_\_\_\_ below surface

10: Pump: Type TURBINE Capacity \_\_\_\_\_ G. M.

Power: Kind ELEC. Horsepower 829/314

11: Yield: Flow \_\_\_\_\_ G. M., Pump 100 G. M. Meas. Rept. Est. \_\_\_\_\_

Drawdown \_\_\_\_\_ ft. after \_\_\_\_\_ hours pumping \_\_\_\_\_ G. M.

12: Use: Dom., Stock  PS, RR., Ind., Irr., Obs. \_\_\_\_\_

Adequacy, permanence PLENTY

13: Quality FILTERED FOR Fe Temp \_\_\_\_\_ °F.

Taste, odor, color \_\_\_\_\_ Sample  Yes 10-12-62  
 No

Unfit for \_\_\_\_\_

14: Remarks: (Log, Analyses, etc.) \_\_\_\_\_

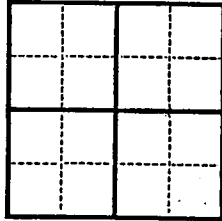

UNITED STATES  
 DEPARTMENT OF THE INTERIOR  
 GEOLOGICAL SURVEY  
 WATER RESOURCES DIVISION

16-125  
 (October 1950)

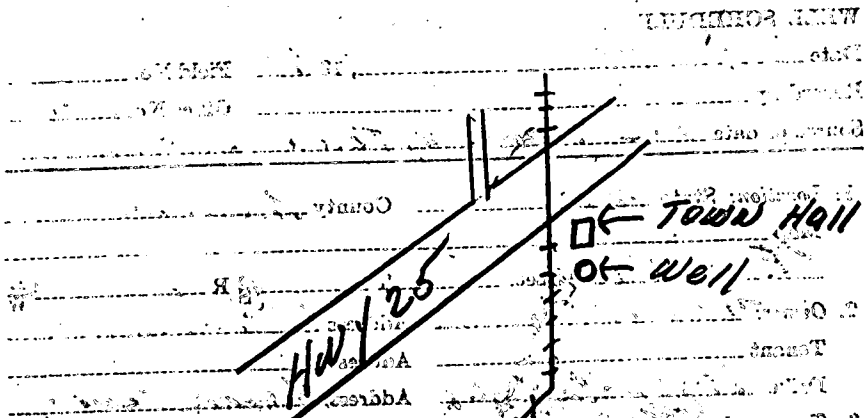

|     |     |     |
|-----|-----|-----|
| 13  | 13  | 13  |
| 18  | 18  | 18  |
| 46  | 46  | 46  |
| 50  | 50  | 50  |
| 84  | 84  | 84  |
| 136 | 136 | 136 |
| 138 | 138 | 138 |
| 161 | 161 | 161 |
| 179 | 179 | 179 |
| 184 | 184 | 184 |

Silty clay  
 sand & gravel  
 clay and silt  
 sand  
 clay  
 sand  
 Rock  
 coarse sand & shells  
 hard cement  
 sand  
 hard coarse sand & shells  
 rock

22

18

Monroe Co.

265

# Smithville

260  
EXISTG.  
GRAVEL  
(TYPICAL)

EXISTG.  
PAVED  
(TYPICAL)

Well #1

D05

Well #2

D22

260

6

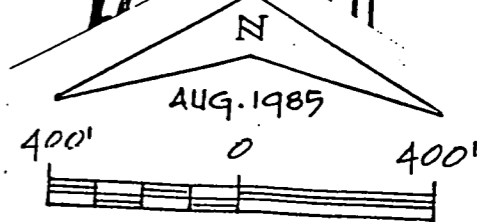

SMITHVILLE STREETS

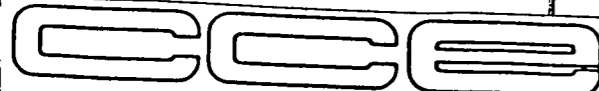

COOK COGIN ENGINEERS, INC.  
703 CROSSOVER RD.-TUPELO, MS. 38801

Well #3

D31

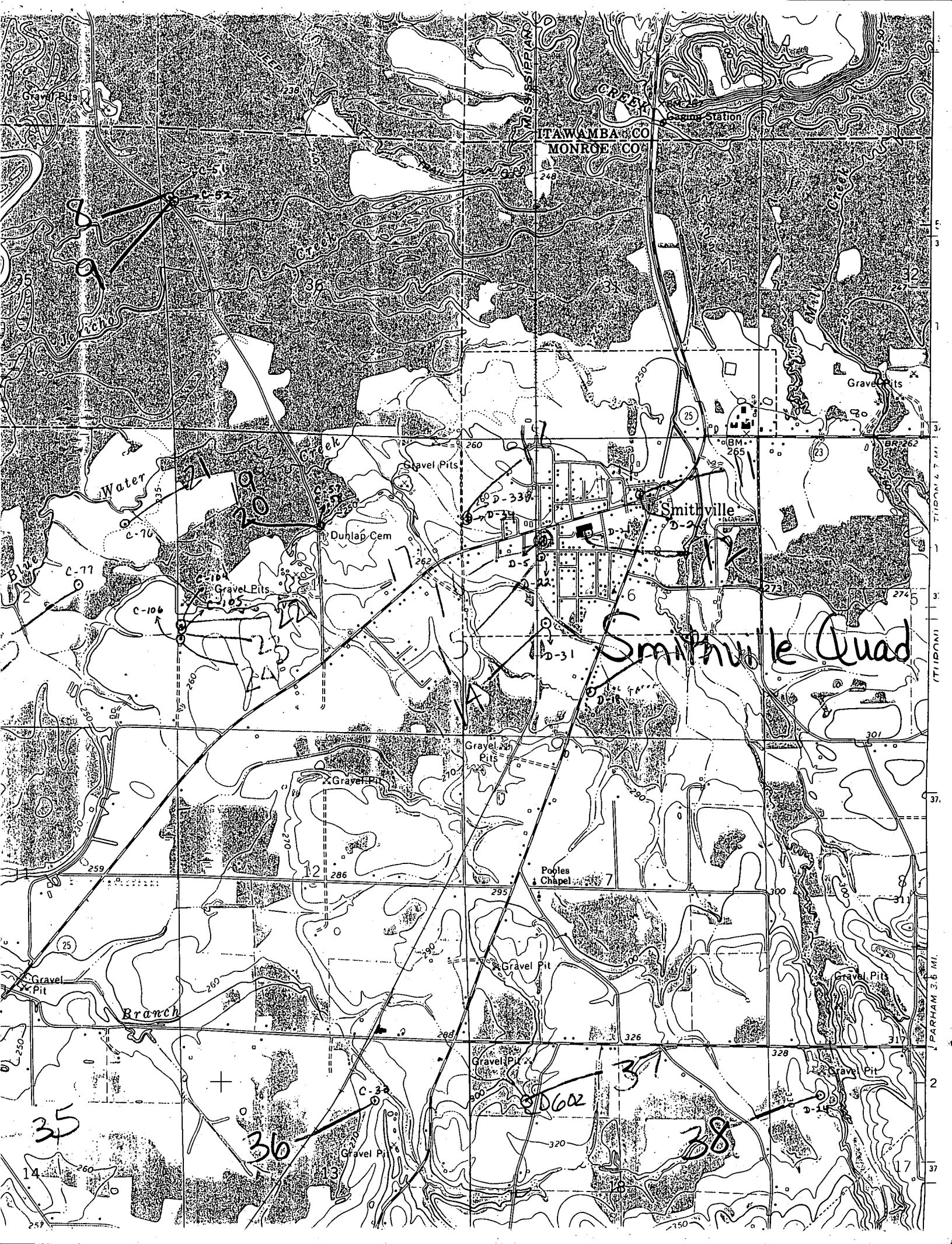

ITAWAMBA CO  
MONROE CO

Smithville Quad

T19N  
R7E  
PARHAM 3.6 MI.