

#3A? new  
✓ J  
2116

Coded By \_\_\_\_\_  
Checked By \_\_\_\_\_  
Entered By \_\_\_\_\_  
Date \_\_\_\_\_

U.S. GEOLOGICAL SURVEY  
WATER RESOURCES DIVISION  
MISSISSIPPI DISTRICT

E-Log No. 173  
County MONROE  
Agency \_\_\_\_\_

Well No. \_\_\_\_\_

WELL RECORD ✓

9/5/91  
51.00  
-10.12  
40.88  
-2.15 mp  
38.73

Agency Code U S G S Site Id 13359220882949011 Project No. 54

Station Name 124 G 116 AMORY Latitude 9 33 59 22 Longitude 10 0 18 8 29 49

Lat/Long Ac. 11 S T M Dist 6=28 State 7=28 County 8=09 51 Land Net 13 01 E D E S I 2 1 6 T I 1 2 S R I 1 9 W

Location Map 14= AMORY Altitude 16=244 Met/Meas 235 Accuracy 17= A L M Hydrologic Unit 18= 15 20= 0316011011

Agency Use 803= A I O Date Inventoried 711 04 124 119901 Station Type J Data Type 804=

Instru. 805= Remarks \_\_\_\_\_ Relia. 3= C L M U 2= W X

Date of Construction 21 10 112 119901 Well Use 23= W Water Use 24= P Primary Aquifer 714= 211 GORD Hole Depth 27= 3811

Well Depth 29= 3581 Water Level 30= 1411 11 Water Level Date 31= 10 112 119901 Method 34= Status 37= Source 33= D

CONSTRUCTION DATA  
Construction Date 60 10 112 119901 Contractor Name Herndon Method 65= H Finish 66= G

CONSTRUCTION CASING DATA  
Top/Casing Bot/Casing Diameter  
R=76 T=A 725#1 59#1 77 11 01 78 3100 79 12

Top/Casing Bot/Casing Diameter  
R=76 T=A 725#2 59#1 77 235 78 12916 79 18

CONSTRUCTION OPENINGS DATA  
Top/Depth Bot/Depth Diameter Type Length Width  
R=82 T=A 726#1 59#1 83 2916 84 358 87 18 85 S 89 88 025

Top/Depth Bot/Depth Diameter Type Length Width  
R=82 T=A 726#2 59#1 83 84 87 85 89 88

CONSTRUCTION LIFT DATA  
Lift Type 43= T Date 38 10 112 119901 Intake 44 113101

Power H.P. 45= E 46= 40 Serial No. 49=

MISCELLANEOUS OWNER DATA  
Date of Ownership 159 10 112 119901 Owner Name 161= AMORY

MISCELLANEOUS OTHER ID DATA  
E-Log No. 190 172 Assigner 191= M I S S I D I S T

MISCELLANEOUS QM DATA

R=192	T=A	738#1	Date of Measurement 1934     /     /         *	Aquifer Sampled 195#                 *	Temp 196#00010	Value 197#
R=192	T=A	738#2	Date of Measurement 1934     /     /         *	Aquifer Sampled 195#                 *	Sp Cond 196#00095	Value 197#
R=192	T=A	738#3	Date of Measurement 1934     /     /         *	Aquifer Sampled 195#                 *	pH 196#00400	Value 197#

MISCELLANEOUS LOGS DATA

R=198	T=A	739#1	Log Type 199#E *	Beg. Depth 200#   40   *	End Depth 201#   35     *
R=198	T=A	739#1	Log Type 199#D *	Beg. Depth 200#     10   *	End Depth 201#   38     *

MISCELLANEOUS NETWORK DATA

706 = WL, QW, WD \*

R=114	T=A	730#1	Beg. Year 115#   9     *	End Year 116#   9     *	Agency Source 120=A   117#         *	Freq. 118#     *
R=121	T=A	730#2	Beg. Year 115#   9     *	End Year 116#   9     *	Agency Source 117#         *	Freq. 118#     *

MISCELLANEOUS REMARKS DATA

R=183	T=A	311#1	Date of Remarks 184#     /     /         *	Remarks 185#                 *
-------	-----	-------	---	-----------------------------------

DISCHARGE DATA

R=146	T=A	Pump/Flow 147#1	Date 148#   10   /   12   /   19   90   *	Type 703# P	Discharge 150#   11   2     *	Sp. Capacity 272#   10       *
-------	-----	--------------------	--	----------------	----------------------------------	-----------------------------------

GEOHYDROLOGIC DATA

R=90	T=A	721#1	Depth Top 91#   300     *	Depth Bot. 92#   360     *	Unit Id 93#   211   60   RD   *	304=P
------	-----	-------	------------------------------	-------------------------------	------------------------------------	-------

HYDRAULIC DATA

R=98	T=A	790#1	Unit Tested 100#                 *	103#                 *
------	-----	-------	---------------------------------------	------------------------

$112.5 / 69.5 = 10.25 \text{ gpm/ft} @ (1 \text{ hrs})$

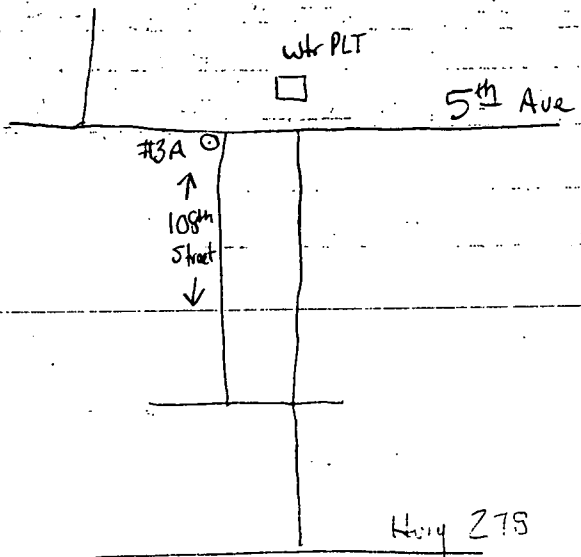

DESCRIPTION OF FORMATIONS ENCOUNTERED	FROM	TO
Clay & Gravel	0	15
Sand	15	45
Clay w/Sand Streaks	45	230
Sand	230	257
Clay	257	265
Rock		265
Clay	265	300
Gravel	300	360
Clay	360	370
Pink Clayw/Sand Strks	370	387

MISSISSIPPI DEPARTMENT OF ENVIRONMENTAL QUALITY  
Bureau of Land and Water Resources

P. O. Box 10631  
Jackson, MS 39289-0631  
WATER WELL DRILLERS LOG

COUNTY WELL LOCATED  
**Monroe**

WELL NUMBER **3A** COCEP

DATE WELL COMPLETED  
**12 Oct 1990**

PERMIT NUMBER

NAME OF DRILLING FIRM  
**Herndon Well & Supply**

**Shannon, MS**

NAME & MAILING ADDRESS OF LANDOWNER  
**City of Amory**

**Water Dept**

**Amory, MS**

WELL LOCATION: SEC 26 TOWNSHIP 12 RANGE 19 **W**

DISTANCE Inside city limits DIRECTION of NEAREST TOWN

OTHER LANDMARK  
**Municipal**

WELL PURPOSE: Home, Irrigation, Municipal, Industrial, Fish Pond, etc.

**PUMP DATA**

PUMP TYPE (Circle One): **40 HP**  
Submersible, Turbine, Jet, Flowing Well,  
Other (Describe)

POWER TYPE (Circle One):  
Electric, Tractor, Diesel, Gasoline, Butane,  
Other (Describe) \_\_\_\_\_ H/P \_\_\_\_\_

Pump Capacity (GPM) 712.5 No. of Stages \_\_\_\_\_ Setting Depth 130 FT.

PUMP TEST  
Well yielded 712.50 GPM with  
a drawdown of 69.48 ft.  
after 7 hours of pumping

**WELL DATA**

Well Depth <b>358'</b>	Casing Diameter (In.) <b>12"</b>	Casing Length (Ft.) <b>300'</b>
Type of Casing <b>Steel</b>	Hole Depth <b>381'</b>	Depth to Static Water Level <b>41.12</b>

TYPE OF COMPLETION: (Circle One or More):  
Gravel Packed, Underreamed, Telescoped,  
Natural Development, Open Hole, Other

Top of Lap Pipe or Reduction in Casing  
**235 FEET** IF TELESCOPED OR MORE THAN ONE SCREEN: USE BACK PAGE

**LOG DATA**

TYPE OF LOG RUN (Circle One): **No Log Run**,  
Electric, Gamma Ray, Density, Sonic, Neutron,  
Other (Describe)

Name of Organization Running Log  
**Herndon Well & Supply, Inc.**

**SCREEN DATA**

Diameter - Inches <b>8"</b>	Length - Feet <b>62'3"</b>	Slot Size - Inches <b>.025</b>
Screen Type <b>SS Ribbed</b>	Depth to Bottom - Feet <b>358'</b>	

**GEOLOGIC DATA (Office Use Only)**

Surface Elev.	Geologic Unit	Unit Thickness	Depth to Top
Subs. SWL	Date	Analysis	Aquifer Test

Driller's Remarks  
**358 / 216**

DESCRIPTION OF FORMATIONS ENCOUNTERED	FROM	TO
Clay & Gravel	0	15
Sand	15	45
Clay w/Sand Streaks	45	230
Sand	230	257
Clay	257	265
Rock		265
Clay	265	300
Gravel	300	360
Clay	360	370
Pink Clayw/Sand Strks	370	381

FORMATIONS (Continued)	FROM	TO

**RECEIVED**  
**DEC 21 1990**  
Department of Natural Resources  
Bureau of Land & Water Resources

IF MORE SPACE IS NEEDED, USE BACK



GEOLOGICAL SURVEY

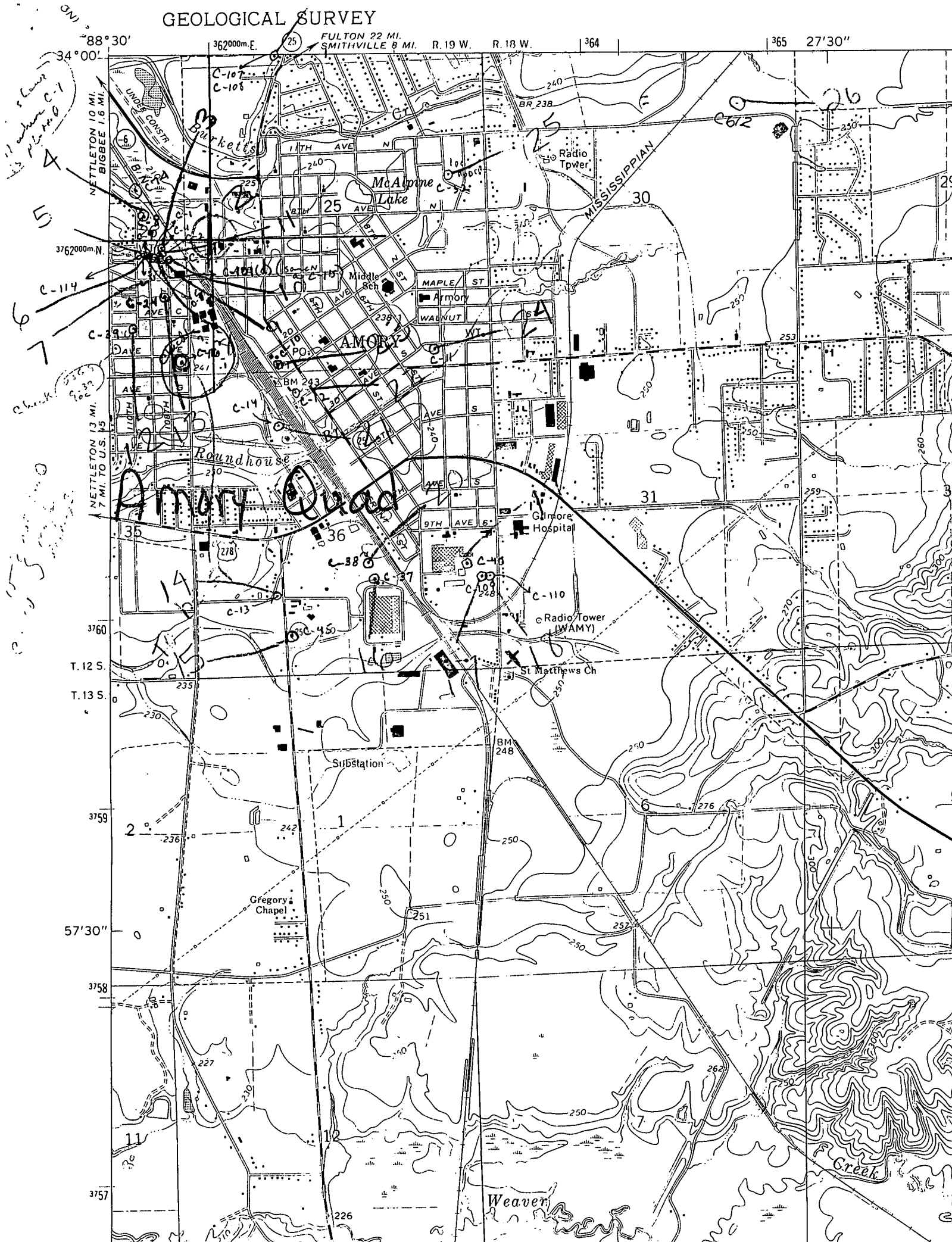

**APPLICATION FOR PERMIT TO DIVERT OR WITHDRAW WATER FROM THE PUBLIC WATERS OF THE STATE OF MISSISSIPPI**

**RECEIVED**

DEPARTMENT OF ENVIRONMENTAL QUALITY, OFFICE OF LAND AND WATER RESOURCES  
 P.O. BOX 10631, JACKSON, MS 39289-0631; (601) 961-5202

This box is for office use only.

8-12-97 AGN.

DEC 03 1996  
 Dept. of Environmental Quality  
 Office of Land & Water Resources  
 FORM WRP-9 (REV. 9/94)

Issued: <u>5-12-87</u>	Expires: <u>8-12-2007</u>	Fee Paid: <u>X</u>	Permit No. _____
Lat. <u>33-59-23</u>	Long. <u>88-30-20</u>	Elev. <u>230</u>	USGS No. _____
Quad. <u>WREN</u>	ASCS Farm No. _____	STAC. _____	MSDOH No. _____
Aquifer: <u>GORD</u>	Tract No. _____	_____	Basin No. _____
Remarks: _____	_____	_____	Dam Inv. No. _____

THIS APPLICATION IS FOR (Circle one): NEW PERMIT RENEWAL PERMIT NO. GW02263

THIS APPLICATION IS FOR (Circle one): GROUNDWATER - COMPLETE A,B,E  
SURFACE WATER - COMPLETE A,C,D,E

BENEFICIAL USE (Circle one or more): 1) Public Supply - Municipal, Rural Water, or Private Water 2) Irrigation  
 3) Industrial 4) Fish Culture 5) Recreation 6) Institutional (eg. Church, School) 7) Commercial (eg. Hotel, Casino, Restaurant)  
 8) Fire Protection 9) Livestock 10) Flood Protection 11) Other: \_\_\_\_\_

**SECTION A** (to be completed by ALL APPLICANTS)

LANDOWNER: CITY OF AMORY 64-6000077  
 (Name) (SSN or Tax ID No.)  
P.O. BOX 266  
 (Address)  
AMORY MS 38821 (601) 256-5633  
 (City) (State & Zip) (Telephone No.)

APPLICANT, AGENT, OR LESSEE (if different from Landowner):

\_\_\_\_\_  
 (Name) (SSN or Tax ID No.)  
 \_\_\_\_\_  
 (Address)  
 \_\_\_\_\_  
 (City) (State & Zip) (Telephone)

*MAP SENT*

Location of diversion/withdrawal point (A suitable map with location marked must accompany this application):

NE 1/4 of the SW 1/4 of Section 26, Township 12S, Range 19W, County MONROE

Does the land to which this application pertains have any source(s) of water other than that for which you are now applying (circle one)? YES NO If yes, describe the nature and amount of any additional supply and, if applicable, list permit number. \_\_\_\_\_

**SECTION B** (to be completed for GROUNDWATER SOURCE)

- AQUIFER: GORDO MISSISSIPPI DEPARTMENT OF HEALTH NO.: 48-0002-7
- Proposed work will begin on \_\_\_\_\_, 19\_\_\_\_, and will be completed by \_\_\_\_\_, 19\_\_\_\_.  
 If well has already been drilled, when was well completed (date)? AUGUST, 1990. Under whose name was well originally drilled (if known)? \_\_\_\_\_
- Description of proposed or completed well:
  - DEPTH OF WELL: 375' feet. DRILLER: \_\_\_\_\_
  - SURFACE CASING: Length 300 feet; Diameter 12" inches; Type STEEL
  - SCREEN: Length 50' feet; Diameter 8" inches; Type S.S. WIRE WOUND
  - PUMP: Type VERTICAL TURBINE; Capacity 600 gallons per minute; Setting depth 160' feet
  - POWER UNIT: Type \_\_\_\_\_; Size \_\_\_\_\_ horsepower
- PERMITTED VOLUME:
  - \_\_\_\_\_ acre-feet per year at a maximum rate of \_\_\_\_\_ gallons per minute
  - 0.43 0.30 million gallons per day at a maximum rate of 600 gallons per minute

**(CONTINUED ON BACK)**

*BB*  
1-16-97

**SECTION C** (to be completed for **SURFACE WATER SOURCE**)

1. Source of water is from \_\_\_\_\_ which drains into \_\_\_\_\_  
which drains into \_\_\_\_\_  
(major stream or river)
2. Discription of pump/diversion works:  
Pump (size & type): \_\_\_\_\_ Power Unit (size & type): \_\_\_\_\_  
Lift: \_\_\_\_\_ feet Maximum capacity: \_\_\_\_\_ gallons per minute
3. \_\_\_\_\_ acre-feet per year at a maximum rate of \_\_\_\_\_ gallons per minute

**SECTION D** (to be completed for **SURFACE WATER IMPOUNDMENTS {DAMS}** on continuously flowing streams)

1. Name of storage reservoir: \_\_\_\_\_ Dam Height: \_\_\_\_\_ feet
2. Surface area at normal pool: \_\_\_\_\_ Storage capacity at normal pool: \_\_\_\_\_ acre-feet

**SECTION E WATER USE DATA (ALL APPLICATIONS - complete section related to beneficial use)**

1. **IRRIGATION:** List the number of acres of each crop to be irrigated: Rice \_\_\_\_\_; Cotton \_\_\_\_\_; Oats \_\_\_\_\_; Corn \_\_\_\_\_; Soybeans \_\_\_\_\_; Pasture \_\_\_\_\_; Truck \_\_\_\_\_; Wheat \_\_\_\_\_; Grain Sorgum \_\_\_\_\_; Other (specify) \_\_\_\_\_ Acres \_\_\_\_\_  
**A. Method of Irrigation (circle one) - Center Pivot Flood Furrow**  
**B. Land Condition (circle one) - Precision Land Formed Smoothed**  
**C. ASCS Farm No. \_\_\_\_\_ Tract No. \_\_\_\_\_**
2. **FISH CULTURE:** Explain how water will be used: \_\_\_\_\_  
How often will reservoir (s) be emptied and refilled? \_\_\_\_\_
3. **MUNICIPAL, WATER ASSOCIATION, or PRIVATE WATER SYSTEM**  
Chose "a" or "b". (a) The number of people served is \_\_\_\_\_ or (b) The number of connections is 3,945  
What is the estimated average daily consumption during periods of maximum use at the end of each five-year period during the next twenty (20) years?  

<u>2.32</u>	<u>2000</u>	<u>2.43</u>	<u>2050</u>	<u>2.54</u>	<u>2010</u>	<u>2.65</u>	<u>2015</u>
(Volume)	(Year)	(Volume)	(Year)	(Volume)	(Year)	(Volume)	(Year)
4. **INDUSTRIAL :** If the water is to be released into a watercourse, indicate the amount released each year \_\_\_\_\_;  
Rate of release \_\_\_\_\_; NPDES Permit No. \_\_\_\_\_  
Explain any changes in quality of water to be released: \_\_\_\_\_  
Explain how water will be used: \_\_\_\_\_  
How much groundwater will be used for once-through non-contact cooling? \_\_\_\_\_
5. **RECREATION:** Explain how water will be used: \_\_\_\_\_
6. **OTHER USE:** Explain in detail (if needed, attach another page): \_\_\_\_\_
7. **REMARKS:** \_\_\_\_\_

List below the person to be contacted for additional information if required.

JERRY COOPER  
(Name)  
P.O. BOX 266  
(Address)  
AMORY, MS 38821  
(City, State, Zip)  
(601)256-5633  
(Telephone)

The accompanying map is hereby declared a part of this application. For irrigation and fish culture use, an ASCS photograph is required. The **TEN DOLLAR (\$10.00) permit fee** is enclosed herewith.

*Jerry H Cooper*  
(Signature)

Subscribed and sworn to before me this 8th day of NOVEMBER, 19 96, at MONROE County of MISSISSIPPI

My commission expires JUNE 19, 2000; *Ray H. Brown* RAY. H. BROWN Notary Public.

RECEIVED  
MAR 18 1986

For Office Use Only:	
County:	Monroe
Priority Date:	3-18-86
Permit No:	MS-GW-00263
Quad Map:	Wren
Water Management Dist:	
Hydrologic River Basin:	03160101

Department of Land and Water Resources  
**APPLICATION FOR PERMIT TO DIVERT OR WITHDRAW  
 FOR THE BENEFICIAL USE OF THE PUBLIC WATERS OF THE STATE OF MISSISSIPPI**

Pursuant to the laws of the State of Mississippi, namely §51-3-5 (1), as amended, I, the landowner, \_\_\_\_\_

\_\_\_\_\_  
 City of Amory, Mississippi (Name) 64-6000077 (S/S or Tax ID No.)  
 P.O. Box 6 (Address) Amory (City or Town) MS 38821 (State and Zip)

( 601 ) 256-5635 (Telephone Number), do hereby make application for permission to use: (circle one)

surface water ground water for the following beneficial use: (circle one or more)

municipal; irrigation; recreation; livestock water; fish culture; industrial;

Other \_\_\_\_\_ (Specify)

1. Name & Address of agent or applicant if different from landowner.

\_\_\_\_\_  
 (Name) (S/S or Tax ID No.) (Address)  
 \_\_\_\_\_ (City or Town) (State and Zip) (Telephone Number)

2. Location of point of diversion/withdrawal (include location map with application)

NE ¼ of SW ¼ of Section 26, Township 12 S, Range 19 W, County Monroe

3. Volume of water diverted/withdrawn:

(1) \_\_\_\_\_ acre feet per year, diverted/withdrawn at a maximum rate of \_\_\_\_\_ gallons per minute; or

(2) 0.43 million gallons per day, diverted/withdrawn at a maximum rate of 600 gallons per minute.

4. Construction of proposed work will begin June 1, 19 86

5. Estimated date of completion September 1, 19 86

6. Water will be used from ~~from~~ every day to ~~to~~ each year

7. Description of lands on which water will be used:

(a) Copy legal description of property upon which water is to be used (may be copied word for word from your deed).

Attach separate sheet if necessary see vicinity map and site sketch

(b) Has the above described land any water right or source of water supply other than that herein applied for?

(Water Rights Number(s) \_\_\_\_\_) Describe the nature and amount of any additional supply \_\_\_\_\_

**SECTION A** (to be completed if source of water is from surface supply)

1. Source of supply is \_\_\_\_\_ which drains into \_\_\_\_\_  
\_\_\_\_\_ which drains into \_\_\_\_\_

2. Description of diversion works:

(a) Water obtained directly from stream: \_\_\_\_\_ (Name)

Pump \_\_\_\_\_ Power Unit \_\_\_\_\_  
(Size and type) (Size and type)

Lift \_\_\_\_\_ ft. Maximum capacity \_\_\_\_\_ gpm

(b) Storage reservoir \_\_\_\_\_ (Name)

Height of dam \_\_\_\_\_ feet. Surface area at normal pool \_\_\_\_\_ acres

Storage capacity at normal pool \_\_\_\_\_ acre feet



**SECTION B** (to be completed if source of water is from underground supply)

1. Source of supply: Gordo aquifer(s)
2. Description of water well:
  - (a) **Proposed Well Data:**  
Estimated depth to be drilled 375 feet
  - (b) **Proposed Screen Data:**  
 (1) Estimated Length 50 ft. (2) Estimated Diameter 8 inches  
 (3) Proposed Type S.S. wire wound (4) Proposed slot size 0.030 inches
  - (c) **Proposed Casing Data:**  
 (1) Estimated Length 300 ft. (2) Estimated Diameter 12 inches  
 (3) Proposed Type Steel
  - (d) **Proposed Pump Data:**  
 (1) Estimated Type & Size 10" Vertical Turbine (2) Estimated Capacity 600 gpm  
 (3) Estimated No. of Stages 5 (4) Estimated Setting Depth 160 ft.  
 Well Driller unkown - bids to be received April 15, 1986  
 (Name of Company)

**WATER USE DATA**

1. IRRIGATION use: (a) Show number of acres to be irrigated by 40-acre blocks:

TOWN-SHIP	RANGE	SEC.	NE¼				NW¼				SW¼				SE¼				TOTALS
			NE¼	NW¼	SW¼	SE¼	NE¼	NW¼	SW¼	SE¼	NE¼	NW¼	SW¼	SE¼	NE¼	NW¼	SW¼	SE¼	

- (b) List the acres to be irrigated: Rice \_\_\_\_\_; Cotton \_\_\_\_\_; Corn \_\_\_\_\_; Pasture \_\_\_\_\_; Truck \_\_\_\_\_; Other crops ( \_\_\_\_\_ ) \_\_\_\_\_ acres.
2. If for MUNICIPAL use: (a) Present population \_\_\_\_\_, (based on 19\_\_\_\_ Census)  
 (b) Estimated average daily consumption during periods of maximum use at the end of each five-year period in next twenty years:  
2.00 19 85 ; 2.10 19 90 ; 2.21 1995 ; 2.32 ~~199~~ 2000
3. If for INDUSTRIAL use: (a) If water is to be released into a watercourse, indicate: Amount released each year \_\_\_\_\_; rate of release \_\_\_\_\_; location of release point in reference to diversion point \_\_\_\_\_ (show location on map)  
 (b) Explain any change in quality of water to be released: \_\_\_\_\_
4. If for RECREATIONAL use: Explain how water will be used \_\_\_\_\_
5. If for FISH CULTURE use: (a) Explain in detail how water will be used \_\_\_\_\_  
 (b) Number of times reservoir will be emptied and filled annually: \_\_\_\_\_
6. If for ANY OTHER use: (a) Explain in detail \_\_\_\_\_

REMARKS \_\_\_\_\_  
 \_\_\_\_\_  
 \_\_\_\_\_

List below the name and address of person to be contacted for additional information, if required.  
Billie Wright  
 (Name)  
P.O. Box 6  
 (Address)  
Amory, MS 38821

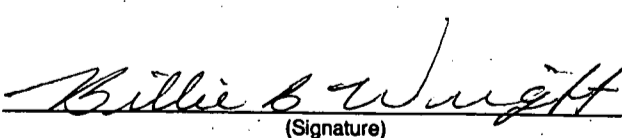
The accompanying map is hereby declared a part of this application. Ten dollar (\$10.00) fee herewith enclosed.  
  
 (Signature)

Subscribed and sworn to before me this 13th day of March 19, 86, at AMORY  
 County of MONROE, Mississippi. My commission expires September 22, 1988  
Ann L. Halbert Notary Public

App1.

COMPUTER INPUT DATA FORM FOR GROUNDWATER

Permit No. MS-GW-02263

Status Code NO 4

County Code 095 (Madroe)

Water Management District \_\_\_\_\_

Date Notice Sent \_\_\_\_\_

Hydrologic River Basin 03160101

Notice Returned \_\_\_\_\_, Delivered \_\_\_\_\_  
(date) (date)

Date Renewal Notice Sent \_\_\_\_\_

Date Application Rec'd 3/16/86

Date Renewal Application Rec'd. \_\_\_\_\_

Date Original Permit Issued 5/12/87

Date Renewal Permit Issued \_\_\_\_\_

Date Original Permit Expires 5/12/97

Date Renewal Permit Expires \_\_\_\_\_

Well No. \_\_\_\_\_

Date Use Verified \_\_\_\_\_ by \_\_\_\_\_

Applicant/User \_\_\_\_\_

Landowner/Permittee City of Amory

Address \_\_\_\_\_

Address P.O. Box 6

Amory, MS 38821

Phone No. ( ) \_\_\_\_\_

Phone No. ( ) 256-5635

S/S or Tax ID No. \_\_\_\_\_

S/S or Tax ID No. 64-600077

Amount of water permitted 0.43 ~~MGD~~ MGD @ maximum rate of 600 gpm

Beneficial Use for MU (municipal)

Location: NE 1/4, SW 1/4, Section 26, Township 12 S, Range 19 W

Latitude: 33 59 23 : Longitude: 88 30 20 : Quadrangle: Wren

Well Data:

Date Drilled 8/86

Initial depth to static water level \_\_\_\_\_ ft.

Surface elevation 240 ft.

Date initial depth measured \_\_\_\_\_

Depth 375 ft.

Initial yield \_\_\_\_\_ gpm

Casing diameter 12 inches

Casing length 300 ft.

\_\_\_\_\_ inches

\_\_\_\_\_ ft.

\_\_\_\_\_ inches

\_\_\_\_\_ ft.

Type of casing ST

Type of Completion \_\_\_\_\_

Screen Data:

Screen Diameter 8 inches Length 50 ft. Depth to bottom 350 ft.

\_\_\_\_\_ inches \_\_\_\_\_ ft. \_\_\_\_\_ ft.

\_\_\_\_\_ inches \_\_\_\_\_ ft. \_\_\_\_\_ ft.

Screen Type SSW Slot size 0.030"

Pump Data:

Geologic Data:

Type & size of pump TP

Geologic Unit GORD (Gorda Aquifer)

Pump capacity 600 gpm

Subsequent depth to Static Water Level \_\_\_\_\_

No. of stages 5

Date Subsequent Depth Measured \_\_\_\_\_

Setting Depth 160 ft.

Geophysical log \_\_\_\_\_

Water analysis \_\_\_\_\_

Aquifer test \_\_\_\_\_

Thickness of sand unit \_\_\_\_\_ ft.

Depth to top of unit \_\_\_\_\_ ft.

Well Driller Name \_\_\_\_\_