

Same as C-101

Destroyed

Amory

335926

0882949

Wkd Exp. (GW)  
April 1966

Well No. 115

WELL SCHEDULE

**PUNCHED**

U. S. DEPT. OF THE INTERIOR

GEOLOGICAL SURVEY

WATER RESOURCES DIVISION

MASTER CARD BE 10-30-67

Record by E. K. ... Source of data

Date 7-23-54 Map

MAR 11 1973

State Miss County Monroe (or town) Amory

Latitude: 33° 59' 30" N Longitude: 088° 30' 00" W Sequential number: 1

Local well number: C195AD2612519W Other number: B & M

Local use: Town of Amory Owner or name: Town of Amory

Ownership: County, Fed Gov't, City, Corp or Co, Private, State Agency, Water Dist

Use of water: Unused

Use of well: Oil-gas

DATA AVAILABLE: Well data  Freq. W/L meas.:  Field aquifer char.

Hyd. lab. data:

Qual. water data; type:

Freq. sampling:  Pumpage inventory:

Aperture cards:

Log data: Amory Log

WELL-DESCRIPTION CARD

SAME AS ON MASTER CARD Depth well: 300 ft Meas. 6

Depth cased: 240 ft Casing type: steel Diam. 8 in

Finish: open perf.

Method: rot.

Date Drilled: 8-4-55

Driller: ...

Lift: multiple

Power: gasoline

Descrip. MP: top of Recorder

Alt. LSD: 235

Water Level: 9.32

Date meas: 8-4-55

Drawdown: ...

QUALITY OF WATER DATA: Iron ... Sulfate ... Chloride ... Hard. ...

Sp. Conduct: ... Temp. ...

Taste, color, etc.

TRANSMITTED FOR ADP.

Well No.

PUNCHED

Well No. C 101

Latitude-longitude 33 59 30 <sup>N</sup> 088 30 00 <sup>W</sup>  
d m s d m s

HYDROGEOLOGIC CARD

SAME AS MASTER CARD  Physiographic Province: 03 Section: \_\_\_\_\_

D Drainage Basin: 134 Subbasin: \_\_\_\_\_

Topo of well site: (D) depression, stream channel, dunes, (E) flat, (H) hilltop, sink, swamp, (K) (L) offshore, pediment, hillside, terrace, undulating, valley flat F

MAJOR AQUIFER: \_\_\_\_\_ system \_\_\_\_\_ series K3 \_\_\_\_\_ aquifer, formation, group G0

Lithology: Drum Origin: 3 Aquifer Thickness: \_\_\_\_\_ ft

Length of well open to: \_\_\_\_\_ ft Depth to top of: \_\_\_\_\_ ft

MINOR AQUIFER: \_\_\_\_\_ system \_\_\_\_\_ series \_\_\_\_\_ aquifer, formation, group \_\_\_\_\_

Lithology: \_\_\_\_\_ Origin: \_\_\_\_\_ Aquifer Thickness: \_\_\_\_\_ ft

Length of well open to: \_\_\_\_\_ ft Depth to top of: \_\_\_\_\_ ft

Intervals Screened: \_\_\_\_\_

Depth to consolidated rock: \_\_\_\_\_ ft Source of data: \_\_\_\_\_

Depth to basement: \_\_\_\_\_ ft Source of data: \_\_\_\_\_

Surficial material: \_\_\_\_\_ Infiltration characteristics: \_\_\_\_\_

Coefficient Trans: 11000 gpd/ft 114 Coefficient Storage: .0004 405

Coefficient Perm: 1,000 gpd/ft<sup>2</sup>; Spec cap: \_\_\_\_\_ gpm/ft; Number of geologic cards: \_\_\_\_\_

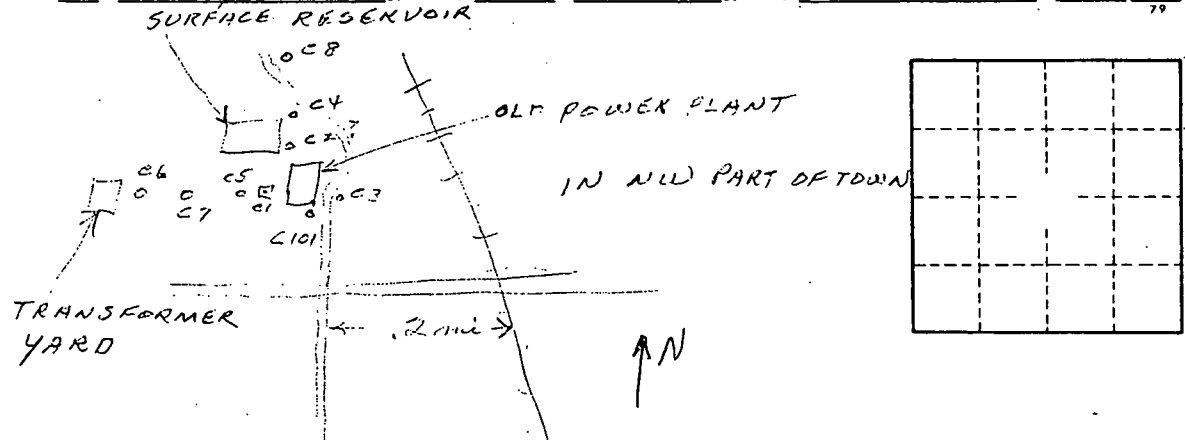

C101 is 20 feet south of SE corner of power plant.

Not in use 1955

Well No. C 101

GEOLOGICAL SURVEY

88° 30'

362000m.E.

FULTON 22 MI. SMITHVILLE 8 MI. R. 19 W. R. 18 W.

364

365 27' 30"

Handwritten notes:  
5. Check  
1. 2. 3. 4. 5. 6. 7.  
C-108  
C-114  
C-214  
C-10  
C-14  
C-13  
C-38  
C-37  
C-40  
C-110  
D.S. 9.39  
202.0  
P.L. 10.0

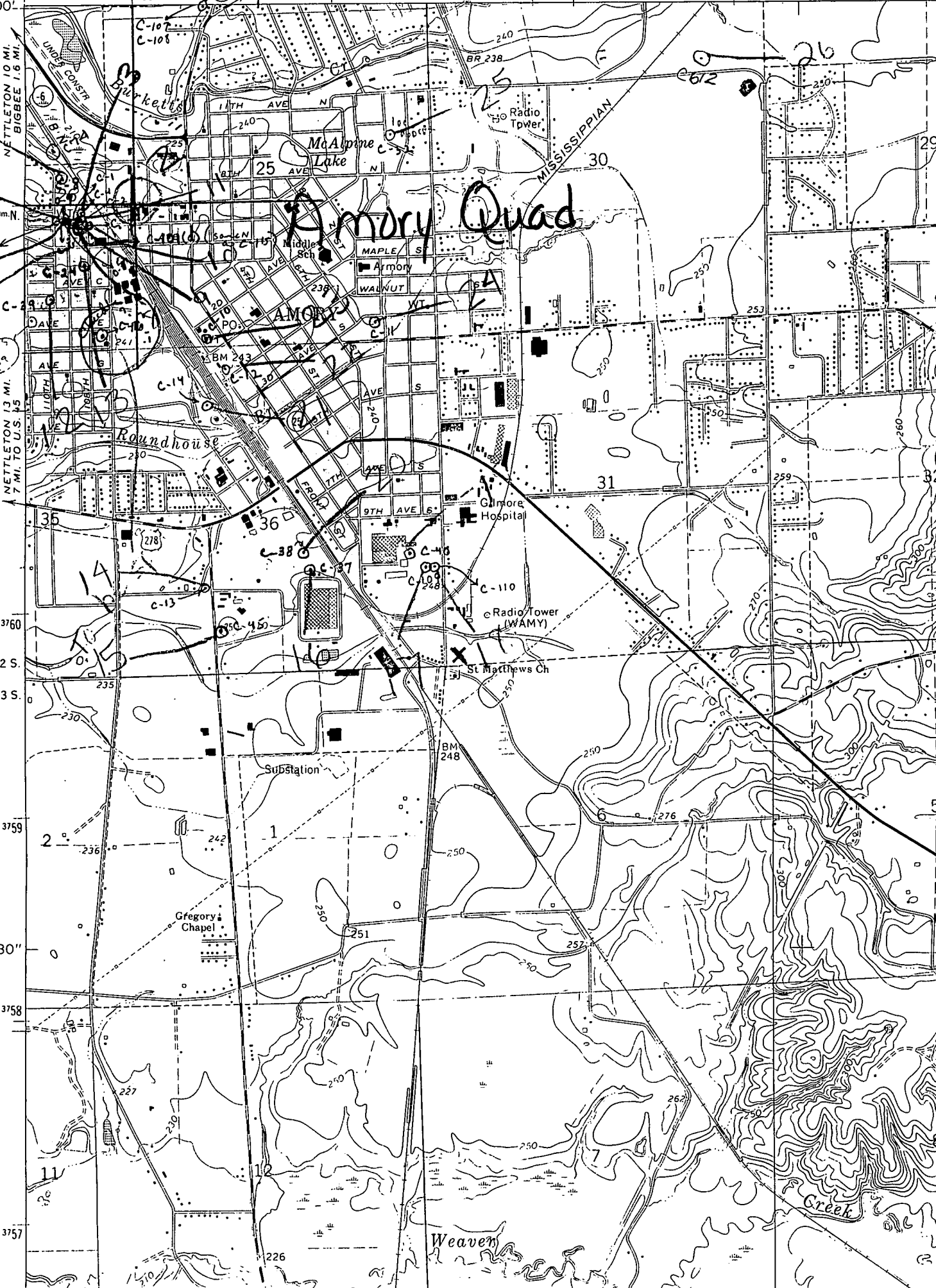

Amory Quad

T. 12 S.

T. 13 S.

57' 30"

3758

3757

Creek

Weaver