

9-185-July 1935
Revised

Analysis
UNITED STATES *Not in 7, 234, 355*
DEPARTMENT OF THE INTERIOR *S.W.P.C.*
GEOLOGICAL SURVEY
WATER RESOURCES BRANCH A-6

WELL SCHEDULE

Date *July 15, 1940* Well No. *7 WSP 14 576*
Field No. *14 576*
Record by *V. W. Foster* Office No. *C10*
Source of data *Mr. Russell Miller (Supt of water works)*

1. Location: State *Miss* County *Monroe*
Map *Monroe County (at City Hall)*

1/4 1/4 sec. T N R E
S R W

2. Owner: *City of Monroe* Address _____
Tenant _____ Address _____

Driller *Mr. Reich* Address *Deceased*

3. Topography *Valley of Tombigbee Riv*

4. Elevation _____ ft. above _____ ft. below

5. Type: Dug, drilled, driven, bored, jetted _____ 1909

6. Depth: Rept. *565 467* ft. Meas. _____ ft.

7. Casing: Diam. *8 6* in., to _____ in., Type _____
Depth *565* ft., Finish *Screen*

8. Chief Aquifer *Tuscaloosa* From *240* ft. to _____ ft.
Others *20, 170, 240-373*

9. Water level *0.83* ft. *meas.* *July 15 1940* above *Top of* _____
outlet elbow which is *1.7* ft. above *below* surface

10. Pump: Type *Natural flow* Capacity _____ G. M.
Power: Kind _____ Horsepower _____

11. Yield: Flow *1* G. M., Pump _____ G. M., Meas., Rept. Est. _____
Drawdown _____ ft. after _____ hours pumping _____ G. M.

12. Use: Dom., Stock, PS., RR., Ind., Irr., Obs. *Aband.*
Adequacy, permanence _____

13. Quality _____ Temp _____ °F.

Taste, odor, color _____ Sample Yes _____ No _____
Unfit for _____

14. Remarks: (Log, Analyses, etc.) *measurement taken at*
outlet about 100' west of well head

6099m, 14
+ 8 when drilled

UNITED STATES DEPARTMENT OF THE INTERIOR
 GEOLOGICAL SURVEY
 WATER RESOURCES BRANCH

WELL SCHEDULE

Date _____
 Record by _____
 Source of data _____
 Location State _____
 Name _____
 3. Owner *Mr. Miller & Water Superintendent says*
 4. Tenant _____
 5. Address _____

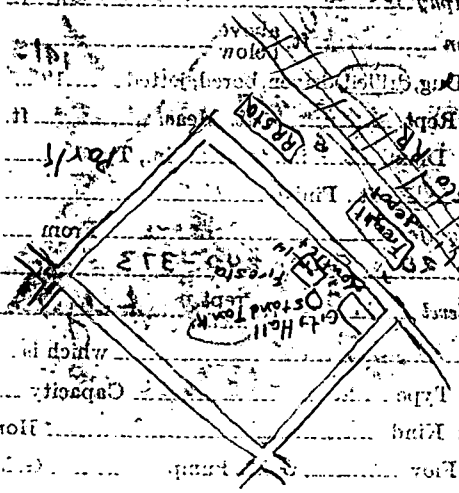
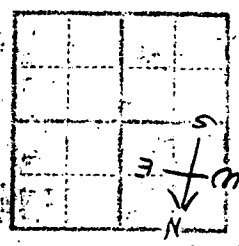

6. Driller _____
 7. Proprietor _____
 8. Location _____
 9. Type of well _____
 10. Depth, feet _____
 11. Capacity _____
 12. Power kind _____
 13. Yield, feet _____
 14. Use, domestic, stock, fire, industrial, irrigation _____
 15. Quantity _____
 16. Temperature _____
 17. Unit for _____
 18. _____

