

480002-02

GW97360

882953 Amory
335933

Amory

FORM 9-1642
(1-68)

Well No. 08

WELL SCHEDULE

U. S. DEPT. OF THE INTERIOR GEOLOGICAL SURVEY WATER RESOURCES DIVISION

PUNCHED

✓
NOV 14 1972

MASTER CARD

Record by MSmith Source of data files Date 7/70 Map County

State 28 County (or town) Monroe 48

Latitude: 33° 59' 30" N Longitude: 088° 29' 45" W Sequential number: 1

Lat-long accuracy: 3 T. 120 S. R. 190 Sec 26 SW. NE SE

Local well number: C008AD2617S19W Other number: B & M

Local use: 064 Owner or name: City of Amory

Owner or name: AMORY Address: _____

Ownership: (C) County, Fed Gov't, City, Corp or Co, Private, State Agency, Water Dist M

Use of water: (A) Air cond, Bottling, Comm, Dewater, Power, Fire, Dom, Irr, Med, Ind, P S, Rec, (S) Stock, Instit, Unused, Reprasure, Recharge, Desal-P S, Desal-other, Other P

Use of well: (A) Anode, Drain, Seismic, Heat Res, Obs, Oil-gas, Recharge, Test, Unused, Withdraw, Waste, Destroyed W

DATA AVAILABLE: Well data Freq. W/L meas: Field aquifer char:

Hyd. lab. data: _____

Qual. water data; type: USGS 4/72

Freq. sampling: Pumpage inventory: yes no; period: _____

Aperture cards: _____ yes

Log data: _____

1992
38.25

WELL-DESCRIPTION CARD

SAME AS ON MASTER CARD Depth well: 357 ft Meas. rept 6

Depth cased: _____ ft Casing type: _____; Diam. 18.10 in

Finish: porous concrete, gravel w. (perf.), gravel w. (screen), horiz. gallery, open end, other S

Method: (A) air bored, (B) cable, (C) dug, (D) hyd jetted, (E) air rot., (F) percussion, (G) rotary, (H) reverse trenching, (I) driven, (J) wash, (K) other H

Date Drilled: 9.5.4 Pump intake setting: _____ ft

Driller: Loyne C name address _____

Lift (type): (A) air, (B) bucket, (C) cent, (D) jet, (E) multiple, (F) multiple, (G) none, (H) piston, (I) rot, (J) submerg, (K) turb, (L) other T Deep Shallow

Power (type): diesel, elec, gas, gasoline, hand, gas, wind; H.P. 15 Trans. or meter no. U

Descrip. MP 235 ft above LSD, Alt. MP _____

Alt. LSD: 240 Accuracy: (source) 6

Water Level: _____ ft above MP; _____ ft below LSD Accuracy: next

Date meas: 5.4 Yield: _____ gpm Method determined: _____

Drawdown: _____ ft Accuracy: _____ Pumping period: _____ hrs

QUALITY OF WATER DATA: Iron _____ ppm Sulfate _____ ppm Chloride _____ ppm Hard. _____ ppm

Sp. Conduct 120 K x 10⁶ Temp. °F 17.0 Date sampled 4.7.2

Taste, color, etc. pH = 6.7

Well No.

08

Well No. C8

Latitude-longitude _____
d m s d m s

STEP 2-1-1000

HYDROGEOLOGIC CARD

SAME AS ON MASTER CARD **Physiographic Province:** 03 Section: _____

Drainage Basin: D 3L Subbasin: _____

Topo of well site: (D) depression, stream channel, dunes, flat, hilltop, sink, swamp, (P) offshore, pediment, hillside, terrace, undulating, valley flat Terrace, Tomlinson R.

MAJOR AQUIFER: system _____ series K3 aquifer, formation, group 297'-357' G-D

Lithology: U.S. Origin: 2 Aquifer Thickness: _____ ft

Length of well open to: _____ ft Depth to top of: _____ ft

MINOR AQUIFER: system _____ series _____ aquifer, formation, group _____

Lithology: _____ Origin: _____ Aquifer Thickness: _____ ft

Length of well open to: _____ ft Depth to top of: _____ ft

Intervals Screened:

Depth to consolidated rock: _____ ft Source of data: _____

Depth to basement: _____ ft Source of data: _____

Surficial material: _____ Infiltration characteristics: _____

Coefficient Trans: _____ gpd/ft Coefficient Storage: _____

Coefficient Perm: _____ gpd/ft; Spec cap: _____ gpm/ft; Number of geologic cards: _____

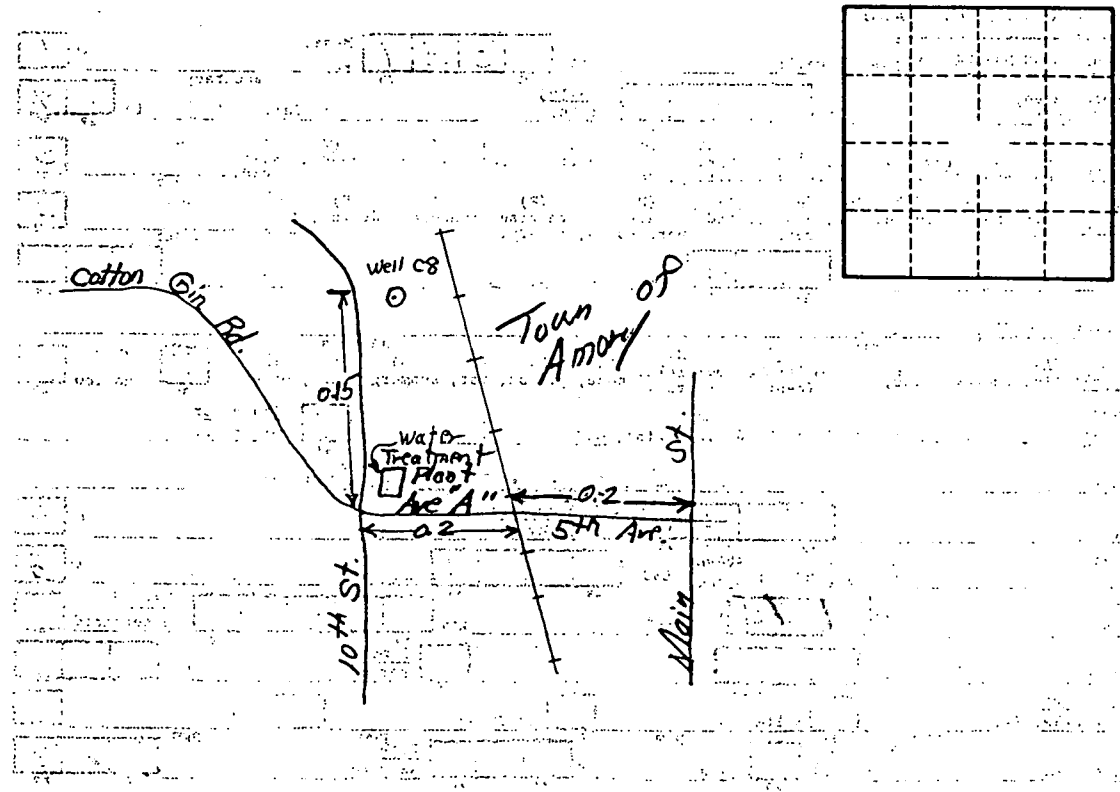

Well No. _____

C8

HP# 480002-02

6W07360

932953
335933

✓ go
#2

Analogue

NOV 14 1972

FORM 9-1642
(1-68)

Well No. 28

WELL SCHEDULE

U. S. DEPT. OF THE INTERIOR

GEOLOGICAL SURVEY

WATER RESOURCES DIVISION

PUNCHED

MASTER CARD

Record by MSmith Source of data files Date 7/70 Map County

State 3 2 8 County (or town) Monroe 52 4 8

Latitude: 3 3 5 9 3 0 N Longitude: 0 8 8 2 9 4 3 Sequential number: 1

Lat-long accuracy: 3 T. 12 0 R. 19 0, Sec. 26, T. NE, S. SE

Local well number: C 0 0 8 A D 2 6 1 7 5 1 9 W Other number: B & M

Local use: 0 6 4 Owner or name: City of Amory

Owner or name: AMORY Address: _____

Ownership: County, Fed Gov't, City, Corp or Co, Private, State Agency, Water Dist M

Use of water: (A) Air cond, (B) Bottling, (C) Comm, (D) Dewater, (E) Power, (F) Fire, (G) Dom, (H) Irr, (I) Med, (J) P S, (K) Rec, (L) Stock, (M) Inact, (N) Unused, (O) Repressure, (P) Recharge, (Q) Desal-P S, (R) Desal-other, (S) Other P

Use of well: (A) Anode, (B) Drain, (C) Seismic, (D) Heat Res, (E) Obs, (F) Oil-gas, (G) Recharge, (H) Test, (I) Unused, (J) Withdraw, (K) Waste, (L) Destroyed W

DATA AVAILABLE: Well data Freq. W/L meas.: Field aquifer char.

Hyd. lab. data: _____

Qual. water data: type: USGS 4/72

Freq. sampling: Pumpage inventory: yes no period: _____

Aperture cards: _____

Log data: _____

9-5-91
50.00 NOG
- 4.00 CUT
- 46.00
- 1.80 MP
44.20

WELL-DESCRIPTION CARD

SAME AS ON MASTER CARD Depth well: 3 5 7 Meas. 6

Depth cased: _____ Casing type: _____ Diam. 18 10 in 1 8

Finish: (C) porous concrete, (F) gravel w. (H) gravel w. (I) horiz. open perf., (J) screen, (K) sd. pt., (L) shored, (M) open hole, (N) other S

Method Drilled: (A) air bored, (B) cable, (C) dug, (D) hyd jetted, (E) air rot., (F) reverse percussion, (G) rotary, (H) trenching, (I) driven, (J) drive wash, (K) other H

Date Drilled: 9 5 4 Pump intake setting: _____ ft 3 0

Driller: Layne C

Lift (type): (A) air, (B) bucket, (C) cent, (D) jet, (E) multiple, (F) multiple, (G) none, (H) piston, (I) rot, (J) submerg, (K) turb, (L) other T Deep Shallow

Power (type): diesel, elec, gas, gasoline, hand, gas, wind, H.P. 15 Trans. or meter no. 4

Descrip. MP 275 above 275 ft below LSD. Alt. MP _____

Alt. LSD: 2 4 0 Accuracy: 6

Water Level: _____ above _____ below MP; Ft. below LSD 4 Accuracy: NW Method G

Date meas: 5 4 Yield: 5 0 0 ppm 5 0 0 Method determined 6 1

Drawdown: _____ ft _____ Accuracy: _____ Pumping period _____ hrs _____

QUALITY OF WATER DATA: Iron _____ Sulfate _____ Chloride _____ Hard. _____

Sp. Conduct 120 K x 10⁶ 1 7 0 Temp. 7 7 0 Date sampled 4 7 2

Taste, color, etc. pH = 6.7

WELL NO.

28

9-185
(October 1950)

UNITED STATES *In use 1955*
DEPARTMENT OF THE INTERIOR *S.W.P.C.*
GEOLOGICAL SURVEY
WATER RESOURCES DIVISION

WELL SCHEDULE

Date 8-4, 1954 Field No. A-9
Record by E.H. Baswell Office No. ~~2278~~
Source of data U.T. Thornton C-8

1. Location: State Miss County Monroe

Map CO.
NE 1/4 SE 1/4 sec. 26 T 12 NR 19 SV

2. Owner: City of Amary Address Miss

Tenant _____ Address _____

Driller Layne Central? Address _____

3. Topography Terrace, Tombigbee R.

4. Elevation 240 ft. ^{above} MSL (app.) _{below}

5. Type: Dug, drilled, driven, bored, jettied 1954?

6. Depth: Rept. 357 ft. Meas. _____ ft.

7. Casing: Diam. 18 in., to 10 in., Type _____

Depth _____ ft., Finish 60' 10" screen

8. Chief Aquifer Tuscaloosa From 297 ft. to 357 ft.

Others _____

9. Water level - 4.0 ft. rept. when drilled 19 ^{above} _{below}

Surface which is _____ ft. ^{above} _{below} surface

10. Pump: Type Turbine Capacity 500 G. M.

Power: Kind Elec. Horsepower 15

11. Yield: Flow _____ G. M., Pump 500 G. M., Meas., Rept. Est. _____

Drawdown _____ ft. after _____ hours pumping _____ G. M.

12. Use: Dom., Stock, PS, RR., Ind., Irr., Obs. _____

Adequacy, permanence _____

13. Quality TS 42 TH 17 Temp _____ °F.

Taste, odor, color _____ Sample Yes 1954

Unfit for _____ No 1906

14. Remarks: (Log, Analyses, etc.) located about 150' west

of water works SAMPLES

*Test pumping 2.4' above top of tap in
Office 5" orifice on 6" pipe*

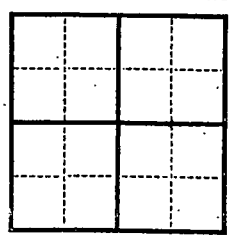

UNITED STATES
DEPARTMENT OF THE INTERIOR
GEOLOGICAL SURVEY
WATER RESOURCES DIVISION

9-122
(October 1950)

WELL SCHEDULE

Date: _____
Name: _____
Source of data: _____

1. Location State _____
County _____
T _____ S _____ W _____
Address _____
Address _____
Date _____

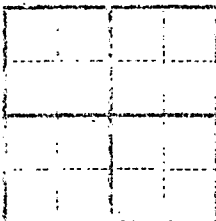

2. Topography _____
3. Type: Dug drilled, driven, bored, jetted, _____
4. Depth: _____
5. General diam. in. to _____
6. _____
7. _____
8. _____
9. _____
10. _____
11. _____
12. _____
13. _____
14. _____

Use + 3.00 bsd from MP
+ .03

below aibline
hole before
pump test Jan 58

Feb. 19, 1958

3222 U.S. (NETTLETON)

Amory Quad NE

UNITED STATES
DEPARTMENT OF THE INTERIOR
GEOLOGICAL SURVEY

88° 30' 34° 00' 362000m.E. 25 FULTON 22 MI. SMITHVILLE 8 MI. R. 19 W. R. 18 W. 364 365 27' 30"

NETTLETON 10 MI. BIGBEE 1.6 MI.
NETTLETON 13 MI. 7 MI. TO U.S. 45
3762000m.N.
C-114
C-110
C-107
C-106
C-105
C-104
C-103
C-102
C-101
C-100
C-99
C-98
C-97
C-96
C-95
C-94
C-93
C-92
C-91
C-90
C-89
C-88
C-87
C-86
C-85
C-84
C-83
C-82
C-81
C-80
C-79
C-78
C-77
C-76
C-75
C-74
C-73
C-72
C-71
C-70
C-69
C-68
C-67
C-66
C-65
C-64
C-63
C-62
C-61
C-60
C-59
C-58
C-57
C-56
C-55
C-54
C-53
C-52
C-51
C-50
C-49
C-48
C-47
C-46
C-45
C-44
C-43
C-42
C-41
C-40
C-39
C-38
C-37
C-36
C-35
C-34
C-33
C-32
C-31
C-30
C-29
C-28
C-27
C-26
C-25
C-24
C-23
C-22
C-21
C-20
C-19
C-18
C-17
C-16
C-15
C-14
C-13
C-12
C-11
C-10
C-9
C-8
C-7
C-6
C-5
C-4
C-3
C-2
C-1
C-0

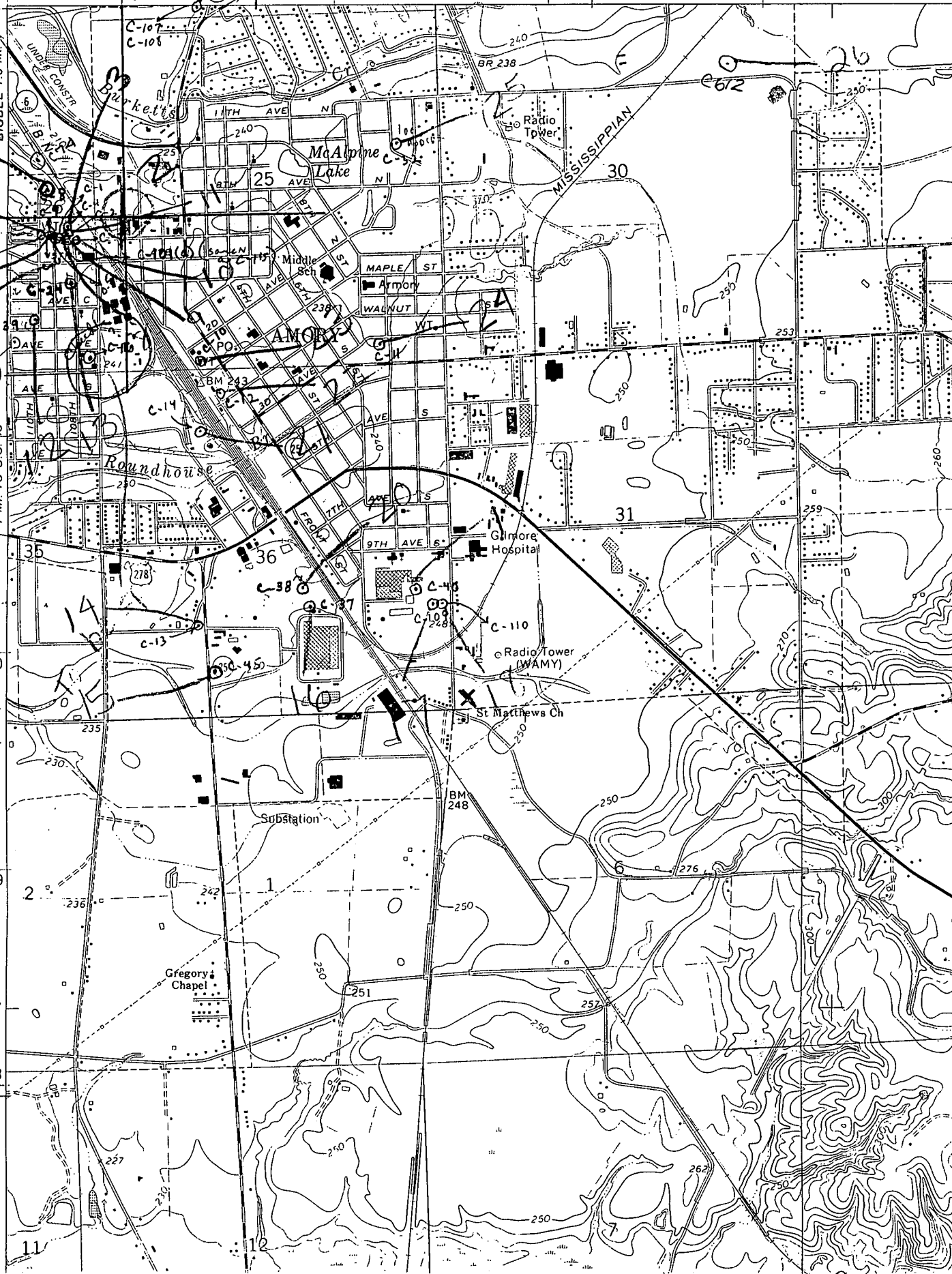

T. 12 S.
T. 13 S.

3759

57' 30"

3758

11

12