

Netleton

FORM 9-1642  
(1-68)

Well No. B44

WELL SCHEDULE

PUNCHED

U. S. DEPT. OF THE INTERIOR

GEOLOGICAL SURVEY

WATER RESOURCES DIVISION

MASTER CARD

MAR 11 1973

Record by B.D. Source of data Bowc Date 3-72 Map \_\_\_\_\_

State 22 County (or town) Monroe 48

Latitude: 340454 N S Longitude: 0883536 Sequential number: 1

Lat-long accuracy: 10 T 11 S R 7 E W, Sec 32 NE 1 NW 5 SW 7

Local well number: 047 Other number: \_\_\_\_\_ B & M

Local use: 047 Owner or name: L. V. BARNES Address: 1 Netleton

Ownership: County, Fed Gov't, City, Corp or Co, Private, State Agency, Water Dist \_\_\_\_\_ P

Use of water: (A) Air cond, Bottling, Comm, Dewater, Power, Fire, Dom, Irr, Med, Ind, P S, Rec, Stock, Inatit, Unused, Répressure, Recharge, Desal-P.S, Desal-other, Other \_\_\_\_\_ H

Use of well: (A) Anode, Drain, Seismic, Heat Res, Obs, Oil-gas, Recharge, Test, Unused, Withdraw, Waste, Destroyed. \_\_\_\_\_ W

DATA AVAILABLE: Well data  Freq. W/L meas.: \_\_\_\_\_ Field aquifer char. \_\_\_\_\_

Hyd. lab. data: \_\_\_\_\_

Qual. water data; type: \_\_\_\_\_

Freq. sampling: \_\_\_\_\_ Pumpage inventory: yes \_\_\_\_\_ no \_\_\_\_\_ period: \_\_\_\_\_

Aperture cards: \_\_\_\_\_ yes \_\_\_\_\_

Log data: \_\_\_\_\_

WELL-DESCRIPTION CARD

SAME AS ON MASTER CARD Depth well: \_\_\_\_\_ ft 226 Meas. rept accuracy \_\_\_\_\_ 3

Depth cased; (first perf.) \_\_\_\_\_ ft 19 Casing type: \_\_\_\_\_; Diam. \_\_\_\_\_ in \_\_\_\_\_

Finish: (C) porous concrete, (F) gravel w. (perf.), (G) gravel w. (screen), (H) horiz. gallery, (I) open end, (J) open perf., (K) screen, (L) sd. pt., (M) shored, (N) open hole, (O) other \_\_\_\_\_ X

Method Drilled: (A) air rot, (B) bored, (C) cable, (D) dug, (E) hyd jetted, (F) air rot., (G) percussion, (H) reverse, (I) rotary, (J) air percussion, (K) reverse, (L) trenching, (M) driven, (N) drive wash, (O) other \_\_\_\_\_ H

Date Drilled: 9-6-71 Pump intake setting: \_\_\_\_\_ ft \_\_\_\_\_

Driller: Sammy Gasco name address \_\_\_\_\_

Lift (type): (A) air, (B) bucket, (C) cent., (D) jet, (E) multiple, (F) multiple, (G) none, (H) piston, (I) rot., (J) submerg., (K) turb., (L) other \_\_\_\_\_ Deep \_\_\_\_\_ Shallow \_\_\_\_\_

Power (type): (A) diesel, (B) elec, (C) gas, (D) gasoline, (E) hand, (F) gas, (G) wind, (H) H.P. \_\_\_\_\_ Trans. or meter no. \_\_\_\_\_

Descrip. MP \_\_\_\_\_ ft above \_\_\_\_\_ below LSD, Alt. MP \_\_\_\_\_

Alt. LSD: \_\_\_\_\_ ft 270 Accuracy: (source) \_\_\_\_\_ 4

Water Level \_\_\_\_\_ ft above \_\_\_\_\_ below MP; Ft above \_\_\_\_\_ below LSD \_\_\_\_\_ Accuracy: \_\_\_\_\_

Date mea.: 5-6-71 Yield: \_\_\_\_\_ gpm \_\_\_\_\_ Method determined \_\_\_\_\_

Drawdown: \_\_\_\_\_ ft \_\_\_\_\_ Accuracy: \_\_\_\_\_ Pumping period \_\_\_\_\_ hrs \_\_\_\_\_

QUALITY OF WATER DATA: Iron \_\_\_\_\_ ppm Sulfate \_\_\_\_\_ ppm Chloride \_\_\_\_\_ ppm Hard. \_\_\_\_\_ ppm

Sp. Conduct \_\_\_\_\_ K x 10<sup>6</sup> \_\_\_\_\_ Temp. \_\_\_\_\_ °F \_\_\_\_\_ Date sampled \_\_\_\_\_

Taste, color, etc. \_\_\_\_\_

Well No.

B44

Latitude-longitude \_\_\_\_\_ N \_\_\_\_\_ S \_\_\_\_\_ d \_\_\_\_\_ m \_\_\_\_\_ s \_\_\_\_\_

**HYDROLOGIC CARD**

SAME AS ON MASTER CARD

Physiographic Province: \_\_\_\_\_

03

Section: \_\_\_\_\_

D

Drainage Basin: \_\_\_\_\_

13C

Subbasin: \_\_\_\_\_

Topo of depression, stream channel, dunes, flat, hilltop, sink, swamp, well site: (C) (E) (F) (H) (K) (L) (O) (P) (S) (T) (U) (V) offshore, pediment, hillside, terrace, undulating, valley flat

MAJOR AQUIFER:

53

E2

Lithology: \_\_\_\_\_

US

Origin: \_\_\_\_\_

6

Aquifer Thickness: \_\_\_\_\_ ft

Length of well open to: \_\_\_\_\_ ft

Depth to top of: \_\_\_\_\_ ft

MINOR AQUIFER:

Lithology: \_\_\_\_\_

Origin: \_\_\_\_\_

Aquifer Thickness: \_\_\_\_\_ ft

Length of well open to: \_\_\_\_\_ ft

Depth to top of: \_\_\_\_\_ ft

Intervals Screened: \_\_\_\_\_

Depth to consolidated rock: \_\_\_\_\_ ft

Source of data: \_\_\_\_\_

Depth to basement: \_\_\_\_\_ ft

Source of data: \_\_\_\_\_

Surficial material: \_\_\_\_\_

Infiltration characteristics: \_\_\_\_\_

Coefficient Trans: \_\_\_\_\_ gpd/ft

Coefficient Storage: \_\_\_\_\_

Coefficient Perm: \_\_\_\_\_ gpd/ft<sup>2</sup>; Spec cap: \_\_\_\_\_ gpm/ft; Number of geologic cards: \_\_\_\_\_

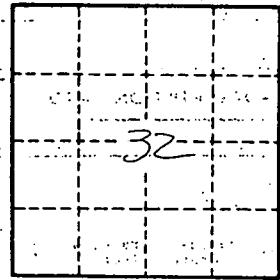

Well No.

B44

**MONROE, MISSISSIPPI BOARD OF WATER COMMISSIONERS**

**B44**  
5-18-61

**WATER WELL DRILLERS LOG CODED**

Date: 5-18, 1961, Driller: Erving Gas Co County Monroe

173-12

		Description & Color of Materials Sand, Clay, Red Clay, Shell, etc.	Thick- ness Feet	Depth Feet
(1) Owner of Land:	<u>L. V. Barnes</u> (Name)			
	<u>Nettleton</u> (Address)			
(2) Location:	<u>NE NW SW</u> <u>1/4, 1/4, Sec. 32 T11 R 7,</u>			
	_____ miles _____ of _____ (distance) (direction) (Nearest Town)			
(3) Topography:	(Hilly) _____ (Flat) _____ (Level) _____			
(4) Purpose of Well:	<u>Household</u> (Domestic Irrigation Municipal, Industrial, Other)			

Information upon completion of well:

- (1) Diameter 4 inches.
- (2) Total Depth 226 feet.
- (3) Water Level \_\_\_\_\_ feet below top of ground.
- (4) Cased to 19 ft Size 4"
- (5) Screen: Size \_\_\_\_\_, Length \_\_\_\_\_.
- (6) Were any formations sealed against pollution?  
 yes, \_\_\_\_\_ no.

If YES depth of formation 19 ft

Why \_\_\_\_\_

Drillers Remarks: \_\_\_\_\_

**CODED**

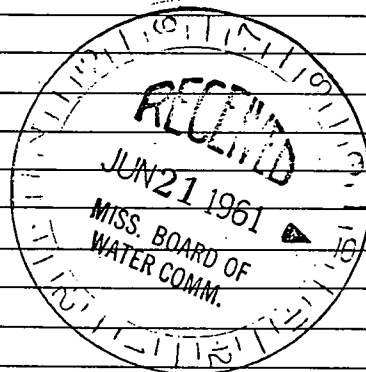

Well No.

(Use Back Side)

Mail this copy to Board of Water Commissioners 429 Miss. St. Jackson, Miss.

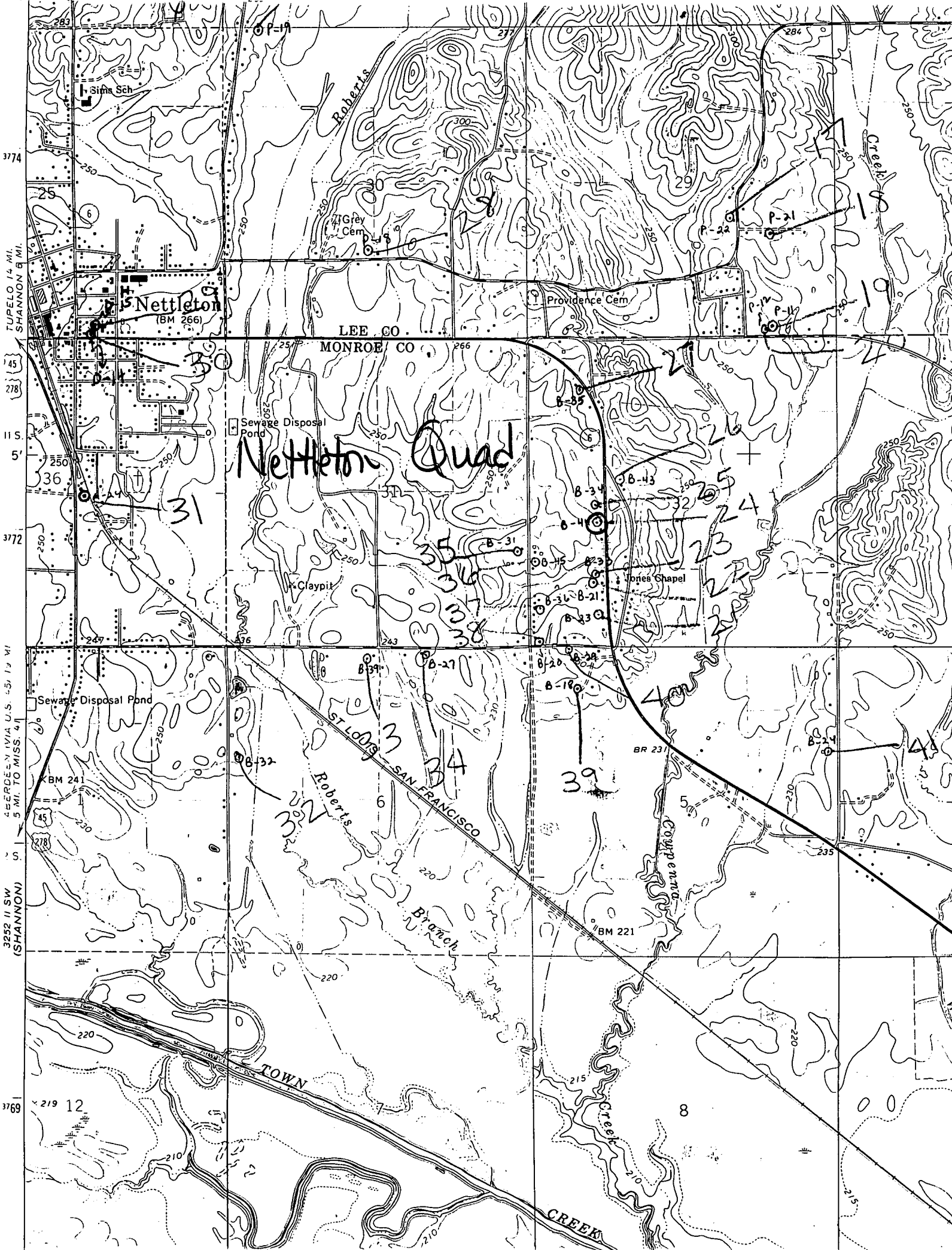

3774

TUPELO 14 MI.  
SHANNON 9 MI.

45  
278

11 S.

5'

3772

44 DEGREE 51' VIA U.S. 51 5 MI. TO MISS. 41'

3252 11 SW  
(SHANNON)

3769

219 12

LEE CO.  
MONROE CO

Nettleton Quad

ST. LOUIS BRANCH SAN FRANCISCO

TOWN

CREEK

215