

Nettleton

FORM 9-1642 (1-68)

Well No. B43

WELL SCHEDULE

PUNCHED

U. S. DEPT. OF THE INTERIOR

GEOLOGICAL SURVEY

WATER RESOURCES DIVISION

MASTER CARD

MAR 11 1973

Record by B.D. Source of data BOWIC Date 3-73 Map _____

State 28 County (or town) Nettleton 48

Latitude: 34° 05' 00" N Longitude: 088° 35' 15" W Sequential number: 1

Lat-long accuracy: 6 T. 11 N. R. 7 W. Sec 32 SW, 15 SW, SE E, NW E

Local well number: 043DB3271507E Other number: _____ B & H

Local use: 021 Owner or name: _____

Owner or name: MILLARD MILLS Address: Nettleton

Ownership: County, Fed Gov't, City, Corp or Co, Private, State Agency, Water Dist D

Use of water: (A) Air cond, Bottling, Comm, Dewater, Power, Fire, Dom, Irr, Med, Ind, P S, Rec, (B) Stock, Instit, Unused, Repressure, Recharge, Desal-P S, Desal-other, Other H

Use of well: (A) Anode, Drain, Seismic, Heat Res, Obs, Oil-gas, Recharge, Test, Unused, Withdraw, Waste, Destroyed. (D) _____ (G) _____ (H) _____ (I) _____ (J) _____ (K) _____ (L) _____ (M) _____ (N) _____ (O) _____ (P) _____ (Q) _____ (R) _____ (S) _____ (T) _____ (U) _____ (V) _____ (W) _____ (X) _____ (Y) _____ (Z) _____ W

DATA AVAILABLE: Well data Freq. W/L meas.: Field aquifer char.

Hyd. lab. data: _____

Qual. water data; type: _____

Freq. sampling: _____ Pumpage inventory: yes no period: _____

Aperture cards: _____ yes no

Log data: D

WELL-DESCRIPTION CARD

SAME AS ON MASTER CARD Depth well: 200 ft Meas. 3

Depth cased: _____ ft Casing type: 23; Diam. 4 in

Finish: (C) porous concrete, (F) gravel w. (perf.), (H) gravel w. (screen), (I) horz. gallery, (J) open end, (K) open hole, (L) other X

Method: (A) air rot, (B) bored, (C) cable, (D) dug, (H) hyd rot., (J) jetted, (K) air percussion, (L) reverse, (M) trenching, (N) driven, (O) drive wash, (P) other 17

Date Drilled: 7-6-7 Pump intake setting: _____ ft

Driller: Heurden - Ho

Lift (type): (A) air, (B) bucket, (C) cent, (J) multiple, (L) multiple, (M) multiple, (N) none, (P) piston, (R) rot, (S) submerg, (T) turb, (U) other J Deep Shallow

Power (type): diesel, elec, gas, gasoline, hand, gas, wind; H.P. 3/4 Trans. or meter no. 5

Descrip. MP _____ ft above _____ ft below LSD, Alt. MP _____

Alt. LSD: 28.5 Accuracy: 4

Water Level: 35 ft above MP; 8.5 ft below LSD Accuracy: D

Date meas: 5-6-7 Yield: _____ gpm Method determined: _____

Drawdown: _____ ft Accuracy: _____ Pumping period: _____ hrs

QUALITY OF WATER DATA: Iron _____ ppm Sulfate _____ ppm Chloride _____ ppm Hard. _____ ppm

Sp. Conduct _____ K x 10⁶ Temp. _____ °F Date sampled _____

Taste, color, etc. _____

Well No. B43

Latitude-longitude

N
S

REPRODUCED

PHYSIOGRAPHIC CARD
SAME AS ON MASTER CARD

Physiographic Province: _____

03
20 21

Section: _____

D

Drainage Basin: _____

13C
23 25

Subbasin: _____

ETER I I'RAM

Topo of well site: (C) (E) (F) (H) (K) (L) depression, stream channel, dunes, flat, hilltop, sink, swamp
(O) (P) (S) (T) (U) (V) offshore, pediment, hillside, terrace, undulating, valley flat

MAJOR AQUIFER:

system _____

series _____

K3
28 29

aquifer, formation, group _____

E2
30 31

Lithology: _____

US
32 33

Origin: _____

6
34

Aquifer

Thickness: _____

110 ft

Length of well open to: _____ ft

Depth to top of: _____ ft

90
41 43

MINOR AQUIFER:

system _____

series _____

aquifer, formation, group _____

Lithology: _____

Origin: _____

Aquifer

Thickness: _____

ft

Length of well open to: _____ ft

Depth to top of: _____ ft

Intervals Screened:

Depth to consolidated rock: _____ ft

Source of data: _____

Depth to basement: _____ ft

Source of data: _____

Surficial material: _____

Infiltration

Characteristics: _____

Coefficient Trans: _____ gpd/ft

Coefficient Storage: _____

Coefficient Perm: _____ gpd/ft²; Spec cap: _____

gpm/ft; Number of geologic cards: _____

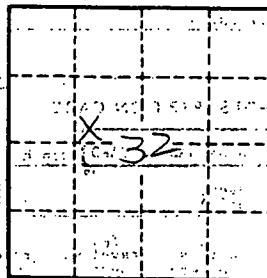

Well No. _____

MONROE

AB43

5-67

MISSISSIPPI BOARD OF WATER COMMISSION

CODED

WATER WELL DRILLERS LOG

Date: 5-2, 1967, Driller: Horndon-Homan Well & Supply, Inc.
(When well drilled) STANTON, MISSISSIPPI 39688 County MONROE
(Where well is located)

		Description & Color of Materials Sand, Clay, Red Clay, Shell, etc.	Thick- ness Feet	Depth Feet
(1) Owner of Land:	<u>Millard Mills</u> (Name)			
	<u>Nettleow, Miss.</u> (Address)	<u>surface sand clay</u>	<u>0-20</u>	
(2) Location:	<u>SW SE NW 32</u> <u>1/4, 1/4, Sec. 11, T11S, R10E</u>	<u>blue clay</u>	<u>20-90</u>	
	<u>1</u> miles <u>S</u> , of <u>Nettleow</u> (distance) (direction) (Nearest Town)	<u>sand</u>	<u>90-200</u>	
(3) Topography:	<u>Flat</u> (Hills) (Flat) (Level)	<u>bottom</u>	<u>200</u>	
(4) Purpose of Well:	<u>Home</u> Domestic Irrigation Municipal, Industrial, Other			

Information upon completion of well:

- (1) Diameter 4 inches.
- (2) Total Depth 200 feet.
- (3) Water Level 85 feet below top of ground.
- (4) Cased to 23', Size 4"
- (5) Screen: Size 10A2, Length _____
- (6) Were any formations sealed against pollution?
 yes, _____ no.

If YES depth of formation 20'

Why surface sand

Drillers Remarks: _____

Yield in gpm: 5

Size pump: 3/4 1/2 hp

Type power: electric

Retain this copy for your office files.

CODED

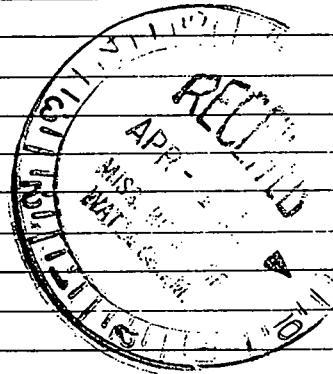

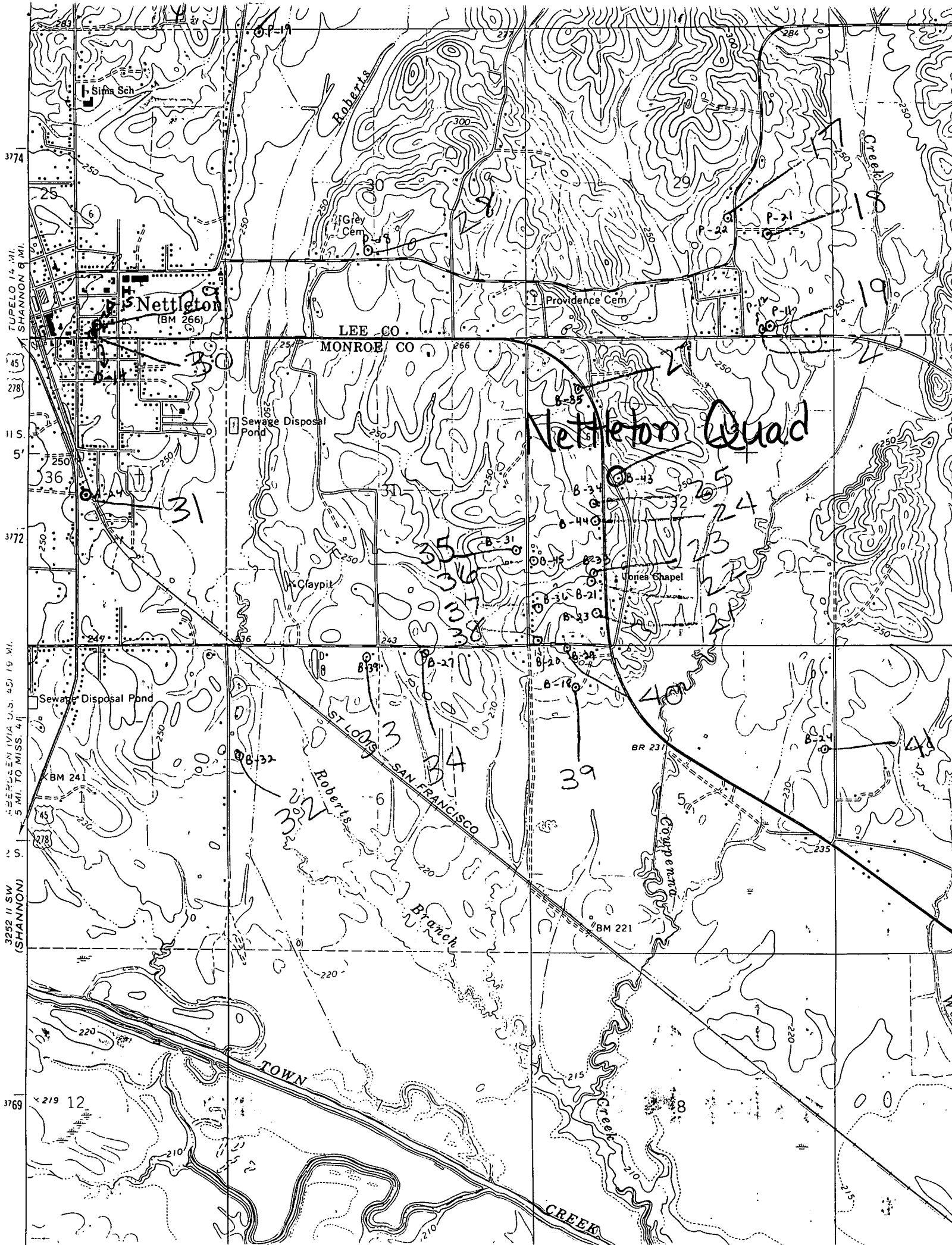

3774
TUPELO 14 MI.
SHANNON 8 MI.
45
278
11 S.
5'
3772
5
3259 II SW
(SHANNON)
3769

Nettleton Quad

LEE CO.
MONROE CO

Nettleton
(BM 266)

B-31
B-32
B-33
B-34
B-35
B-36
B-37
B-38
B-39
B-40
B-41
B-42

Sewage Disposal Pond

Claypit

Jones Chapel

ST. LOUIS
BRANCH
SAN FRANCISCO

Roberts

Couper Creek

TOWN

CREEK