

Nettleton

FORM 9-1642 (1-68)

Well No. B39

WELL SCHEDULE

U. S. DEPT. OF THE INTERIOR

GEOLOGICAL SURVEY

PUNCHED WATER RESOURCES DIVISION

PUNCHED

MASTER CARD

Record by JCM Source of data BOWC Date 2-72 Map MAR 11 1973

State 28 County Monroe 48

Latitude: 34° 03' 55" N Longitude: 088° 30' 28" W Sequential number: 1

Lat-long accuracy: 3 T 120 R 70 Sec 6 NE 1/4 NE 1/4 NW 1/4

Local well number: B039 A B 061 2507 E Other number: B & M

Local use: 021 Owner or name: JIM SULLIVAN Address: Nettleton

Ownership: County, Fed Gov't, City, Corp or Co, Private, State Agency, Water Dist P

Use of water: Air cond, Bottling, Comm, Dewater, Power, Fire, Dom, Irr, Med, Ind, P S, Rec, Stock, Instit, Unused, Repressure, Recharge, Desal-P S, Desal-other, Other H

Use of well: Anode, Drain, Seismic, Heat Res, Obs, Oil-gas, Recharge, Test, Unused, Withdraw, Waste, Destroyed W

DATA AVAILABLE: Well data  Freq. W/L meas:  Field aquifer char.

Hyd. lab. data:

Qual. water data; type:

Freq. sampling:  Pumpage inventory:  yes no; period:

Aperture cards:  yes

Log data:

WELL-DESCRIPTION CARD

SAME AS ON MASTER CARD Depth well: 180 Meas. 3

Depth cased: 45 Casing Type: Steel ; Diam. 5 in

Finish: porous concrete, gravel w. (perf.), gravel w. (screen), gravel w. gallery, horiz. open end, open perf., screen, sd. pc., shored, open hole, other X

Method: air bored, cable, dug, hyd jetted, air rot., percussion, rotary, reverse trenching, driven, drive wash, other H

Date Drilled: 9-7-72 Pump intake setting: 36 ft

Driller: Herdon-Herman

Lift (type): air, bucket, cent, jet, multiple, multiple, none, piston, rot, submerg, turb, other  Deep  Shallow

Power (type): diesel, gas, gasoline, hand, gas, wind, H.P. 1/2 5 Trans. or meter no. 5

Descrip. MP 245 Accuracy: 29 ft below LSD, Alt. MP 5

Alt. LSD: 245 Accuracy: 29 ft below MP; Ft. below LSD 29 Accuracy: 5

Water Level Date meas: 1-7-72 Yield: 5 gpm Method determined 5

Drawdown: 1-7-72 Accuracy: 5 Pumping period 5 hrs

QUALITY OF WATER DATA: Iron 5 Sulfate 5 Chloride 5 Hard. 5

Sp. Conduct 5 K x 10<sup>6</sup> Temp. 5 °F Date sampled 5

Taste, color, etc. 5

Well No.

B39

Latitude-longitude \_\_\_\_\_  
d m a S d m s

HYDROGEOLOGIC CARD

Physiographic Province: 0.3 Section: \_\_\_\_\_  
 Drainage Basin: D Subbasin: 13C

Top of well: (D) (C) (E) (F) (H) (K) (L) \_\_\_\_\_  
 (O) (S) (T) (U) (V) \_\_\_\_\_  
 offshore, pediment, hillside, terrace, undulating, valley flat

MAJOR AQUIFER: system \_\_\_\_\_ series K3 aquifer, formation, group E7U

Lithology: U.S. Origin: 6 Aquifer Thickness: 120 ft

Length of well open to: \_\_\_\_\_ ft 120 Depth to top of: \_\_\_\_\_ ft 60

MINOR AQUIFER: system \_\_\_\_\_ series \_\_\_\_\_ aquifer, formation, group \_\_\_\_\_

Lithology: \_\_\_\_\_ Origin: \_\_\_\_\_ Aquifer Thickness: \_\_\_\_\_ ft

Length of well open to: \_\_\_\_\_ ft \_\_\_\_\_ Depth to top of: \_\_\_\_\_ ft \_\_\_\_\_

Intervals Screened: None

Depth to consolidated rock: \_\_\_\_\_ ft \_\_\_\_\_ Source of data: \_\_\_\_\_

Depth to basement: \_\_\_\_\_ ft \_\_\_\_\_ Source of data: \_\_\_\_\_

Surficial material: \_\_\_\_\_ Infiltration characteristics: \_\_\_\_\_

Coefficient Trans: \_\_\_\_\_ gpd/ft<sup>2</sup> \_\_\_\_\_ Coefficient Storage: \_\_\_\_\_

Coefficient Perm: \_\_\_\_\_ gpd/ft<sup>2</sup>; Spec cap: \_\_\_\_\_ gpm/ft; Number of geologic cards: \_\_\_\_\_

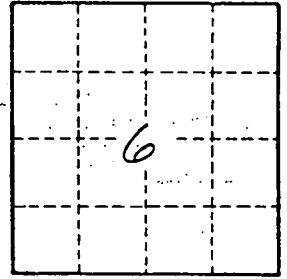

Well No. B39

**MONROE**  
**B 39**  
**1-25-72**

**CODED**

MISSISSIPPI  
 BOARD OF WATER COMMISSIONERS  
 416 North State Street  
 Jackson, Mississippi 39201

FEB 14 1972

**WATER WELL DRILLERS LOG**

Herndon-Horsan Well & Supply, Inc.

1-25 1972  
 date well completed

P. O. Box 42

Monroe

BEAUNTON, MISSISSIPPI 38868 county well located

LANDOWNER:	description of formations encountered	from	to
Jimmy Sullivan Nottetown Miss. (mailing address)			
WELL LOCATION:			
sec. <u>6</u> T. <del>7</del> R. <u>7</u> <u>120</u> 1/2 miles SE of Nottetown (distance) (direction) (nearest town)			
WELL PURPOSE:			
Home (home, irrigation, municipal, industrial)			
WELL COMPLETION DATA:			
(1) diameter (inches) <u>5"</u>	<b>CODED</b>		
(2) total depth (feet) <u>180'</u>			
(3) static water level (feet) <u>29'</u> below top of ground			
(4) casing <u>steel</u> <u>45'</u> (material) (depth)			
<u>5'</u> if telescope see back. (size)			
(5) screen <u>NO</u> (length) (depth to top)			
(size) (material)			
(6) pump <u>1/2</u> <u>5"</u> (HP) (yield gpm) <u>electric</u> (type power)			
(7) electric log <u>NO</u> (yes or no)			
(organization running log)			
(8) how well bottom plugged <u>open</u>			
DRILLERS REMARKS:			

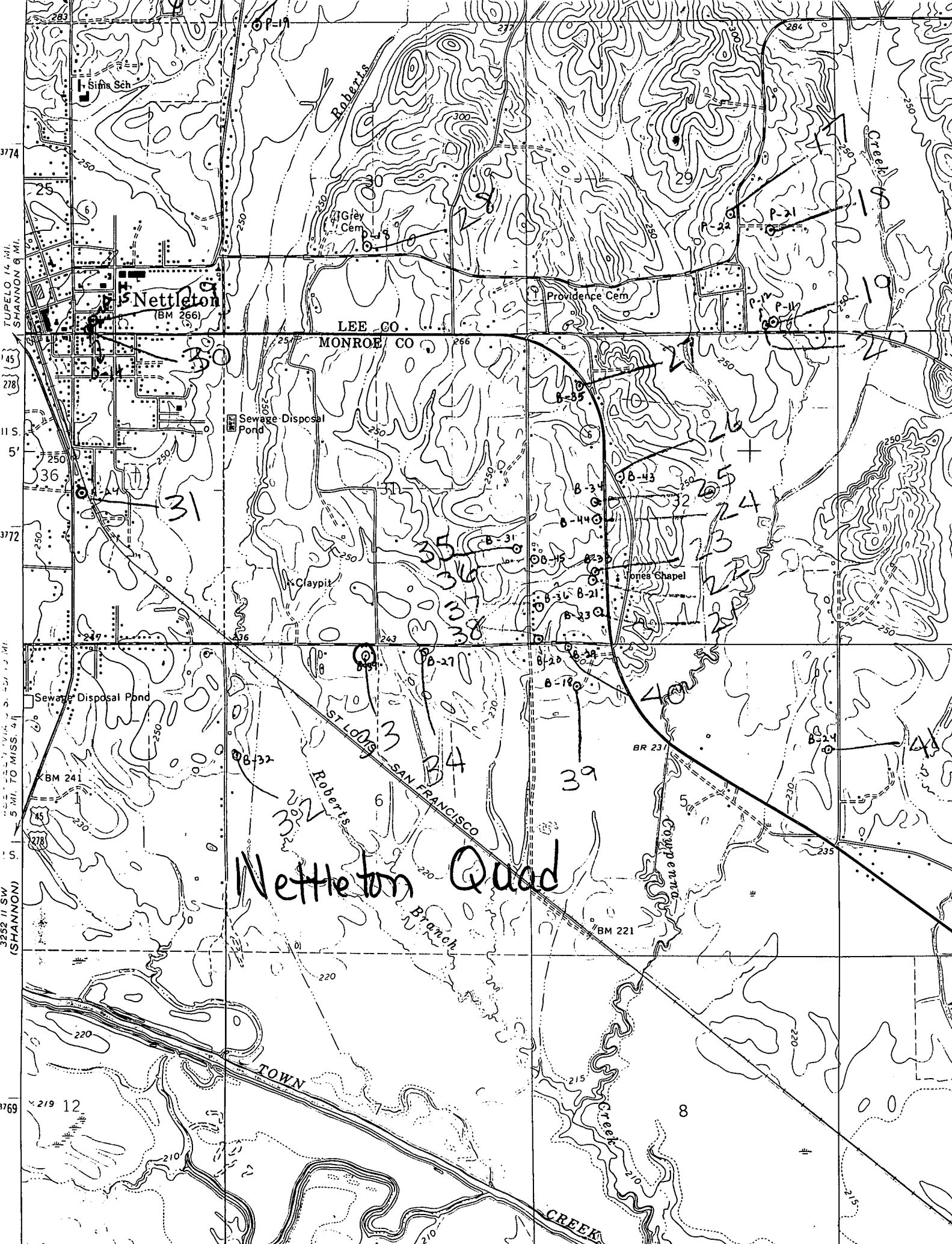

374  
TUPELO 14 MI.  
SHANNON 9 MI.  
11 S.  
5'  
372  
5 MI. TO MISS. 41  
3252 11 SW (SHANNON)  
3769

Nettleton Quad

LEE CO.  
MONROE CO

Nettleton  
(BM 266)

Providence Cem

Sewage Disposal Pond

Jones Chapel

Sewage Disposal Pond

ST. LOUIS  
SAN FRANCISCO  
Branch

BR 23

BM 221

Roberts

Compens

TOWN

CREEK