

Nettleton

FORM 9-1642 (1-68)

Well No. B36

WELL SCHEDULE  
GEOLOGICAL SURVEY

**PUNCHED**

U. S. DEPT. OF THE INTERIOR

WATER RESOURCES DIVISION

MASTER CARD

Record by B. D. Source of data Bowling Date 3-72 Map MAR 11 1973

State 28 County (or town) Marion 48

Latitude: 34° 04' 30" N Longitude: 088° 35' 33" W Sequential number: 1

Lat-long accuracy: 1 T. 11 N. 7 E. Sec 32 NW SW SW SW

Local well number: B030CC321507E Other number: B & M

Local use: 021 Owner or name: RUSSELL JACKSON Address: Nettleton

Ownership: County, Fed Gov't, City, Corp or Co, Private, State Agency, Water Dist P

Use of water: (A) Air cond, Bottling, Comm, Dewater, Power, Fire, Dom, Irr, Med, Ind, P S, Rec, (S) Stock, Instit, Unused, Repressure, Recharge, Desal-P S, Desal-other, Other H

Use of well: (A) Anode, Drain, Seismic, Heat Res, Obs, Oil-gas, Recharge, Test, Unused, Withdraw, Waste, Destroyed. W

DATA AVAILABLE: Well data  Freq. W/L meas.:  Field aquifer char.

Hyd. lab. data:

Qual. water data; type:

Freq. sampling:  Pumpage inventory:  no. period:

Aperture cards:  yes

Log data: D

WELL-DESCRIPTION CARD

SAME AS ON MASTER CARD Depth well: 180 Meas. 3

Depth cased: 66' 5" Casing type: 6.6 ; Diam. 4

Finish: (C) porous concrete, (F) gravel w. concrete, (H) gravel w. (screen), (H) horiz. gallery, (O) open end, (P) perf., (S) screen, (T) sd. pt., (W) shored, (X) open hole, (Z) other X

Method: (A) air rot, (B) bored, (C) cable, (D) dug, (H) hyd rot., (J) jetted, (P) air percussion, (R) reverse, (T) trenching, (V) driven, (W) drive wash, (Z) other H

Date Drilled: 9-65 Pump intake setting: ft

Driller: Heurdon - Ho.

Lift (type): (A) air, (B) bucket, (C) cent, (J) multiple, (L) multiple, (M) multiple, (N) none, (P) piston, (R) rot, (S) submerg, (T) turb, other  Deep  Shallow

Power (type): diesel, elec, gas, gasoline, hand, gas, wind; H.P.  Trans. or meter no.

Descrip. MP ft above ft below LSD, Alt. MP ft

Alt. LSD: 260 Accuracy: 4

Water Level: 55 ft above 55 ft below MP; 55 ft below LSD Accuracy: D

Date meas: 2.6.5 Yield: gpm Method determined 61

Drawdown: ft Accuracy: 65 Pumping period hrs

QUALITY OF WATER DATA: Iron ppm Sulfate ppm Chloride ppm Hard. 72

Sp. Conduct K x 10<sup>6</sup> Temp. °F Date sampled 77 79

Taste, color, etc.

Well No. B36

Latitude-longitude \_\_\_\_\_ N \_\_\_\_\_ S \_\_\_\_\_ d \_\_\_\_\_ m \_\_\_\_\_ s \_\_\_\_\_

HYDROLOGIC REGION **036**

SAME AS ON MASTER CARD

Physiographic Province: \_\_\_\_\_

03

Section: \_\_\_\_\_

D

Drainage Basin: \_\_\_\_\_

13C

Subbasin: \_\_\_\_\_

Topo of well site: (C) (E) (F) (H) (K) (L) (M) (N) (O) (P) (S) (T) (U) (V) \_\_\_\_\_  
depression, stream channel, dunes, flat, hilltop, sink, swamp, offshore, pediment, hillside, terrace, undulating, valley flat

MAJOR AQUIFER: \_\_\_\_\_

K3

aquifer, formation, group \_\_\_\_\_

EZ

Lithology: \_\_\_\_\_

US

Origin: \_\_\_\_\_

G

Aquifer Thickness: \_\_\_\_\_

100 ft

100 Length of well open to: \_\_\_\_\_ ft

Depth to top of: \_\_\_\_\_ ft

3.0

MINOR AQUIFER: \_\_\_\_\_

Lithology: \_\_\_\_\_

Origin: \_\_\_\_\_

Aquifer Thickness: \_\_\_\_\_

Length of well open to: \_\_\_\_\_ ft

Depth to top of: \_\_\_\_\_ ft

Intervals Screened: \_\_\_\_\_

Depth to consolidated rock: \_\_\_\_\_ ft

Source of data: \_\_\_\_\_

Depth to basement: \_\_\_\_\_ ft

Source of data: \_\_\_\_\_

Surficial material: \_\_\_\_\_

Infiltration characteristics: \_\_\_\_\_

Coefficient Trans: \_\_\_\_\_ gpd/ft

Coefficient Storage: \_\_\_\_\_

Coefficient Perm: \_\_\_\_\_ gpd/ft<sup>2</sup>

Spec cap: \_\_\_\_\_

gpm/ft; Number of geologic cards: \_\_\_\_\_

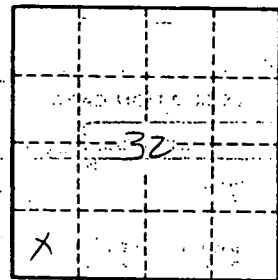

Well No. \_\_\_\_\_

036

MONROE MISSISSIPPI BOARD OF WATER COMMISSIONERS

B36

2-11-65

WATER WELL DRILLERS LOG

**CODED**

Herdon-Homan Well & Supply, Inc.  
P. O. Box 42

Date: April, 1965, Driller: SHANNON, MISSISSIPPI 38 County Monroe  
(Name)

		Description & Color of Materials Sand, Clay, Red Clay, Shell, etc.	Thick- ness Feet	Depth Feet
(1) Owner of Land:	<u>Russell Jackson</u> (Name)			
	<u>Nettleton, Miss</u> (Address)	<u>surface sand +</u>	<u>0-20</u>	
(2) Location:	<u>SW 1/4, SW 1/4, Sec 32 T11 S1 E1</u>	<u>blue clay sand</u>	<u>20-62</u>	
	<u>1 miles SE</u> of <u>Nettleton</u> (distance) (direction) (Nearest Town)	<u>blue clay</u>	<u>62-80</u>	
		<u>sand</u>	<u>80-180</u>	
		<u>bottom</u>	<u>180</u>	
(3) Topography:	<u>Flat</u> (Hilly) (Flat) (Level)			
(4) Purpose of Well:	<u>Domestic</u> (Domestic Irrigation Municipal, Industrial, Other)			

Information upon completion of well:

- (1) Diameter 4 inches.
- (2) Total Depth 180 feet.
- (3) Water Level 55 feet below top of ground.
- (4) Cased to 66'5", Size 4"
- (5) Screen: Size —, Length —
- (6) Were any formations sealed against pollution?  
 yes,  no.

If YES depth of formation 62'

Why surface sand

Drillers Remarks:

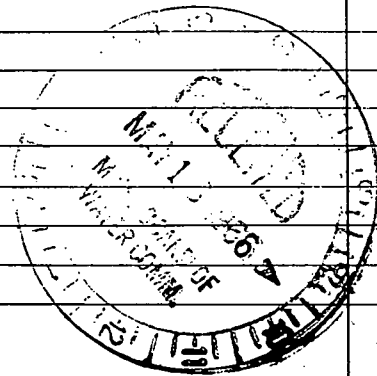

(Use Back Side)

Well No.

Retain this copy for your office files.

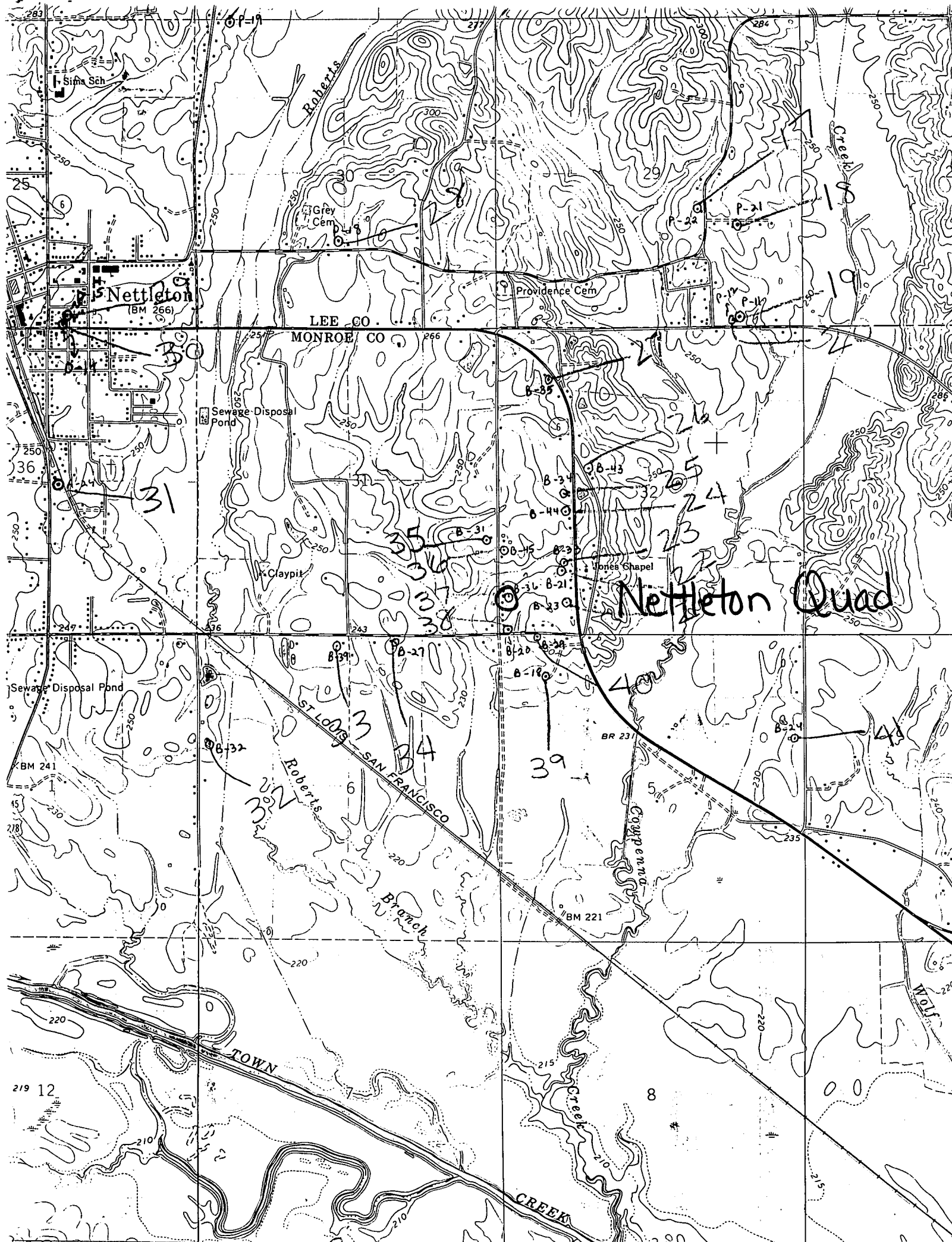

Nettleton  
(BM 266)

LEE CO.  
MONROE CO.

Nettleton Quad

Sewage Disposal Pond

Sewage Disposal Pond

Claypit

Jones Chapel

BM 241

BM 221

219 12

TOWN

CREEK